

VEVOR 5C180750-T5LS06P8-US

VEVOR 5-Tier Plant Shelf with Grow Lights (Model: 5C180750-T5LS06P8-US) Instruction Manual

INTRODUCTION

This manual provides detailed instructions for the assembly, operation, and maintenance of your VEVOR 5-Tier Plant Shelf with Grow Lights. Designed for indoor plant cultivation, this unit offers a versatile solution for growing seedlings, flowers, microgreens, and vegetables. Please read this manual thoroughly before use to ensure safe and efficient operation.

The VEVOR 5-Tier Plant Shelf measures 71 inches tall and features 5 spacious shelves. It includes 8 full-spectrum 36W T5 LED grow lights, each with an independent switch. An automatic timer with 4, 9, and 14-hour settings helps maintain a consistent day/night cycle for your plants. Constructed with heavy-duty 0.9 mm iron tubes, it supports up to 275 lbs and is powder-coated for rust resistance. Leak-proof PP trays protect against water spills, and heavy-duty swivel casters provide easy mobility.

71 in Tall 5-Tier Plant Stand with Grow Lights

Creates ideal conditions for indoor plant growth

80W (10W x 8)
Provides Ample
Light for Plants

Image: Fully assembled VEVOR 5-Tier Plant Shelf with various plants under grow lights.

SAFETY PRECAUTIONS

- Ensure all connections are secure before use.
- Do not overload shelves beyond the maximum weight capacity of 275 lbs.
- Keep electrical components away from water to prevent electric shock.
- Use only the provided power cable and accessories.
- Place the plant shelf on a stable, level surface.

- Supervise children and pets around the unit.

WHAT'S IN THE BOX

Verify that all components are present before beginning assembly:

- 8 x LED Light Tubes
- 5 x Metal Shelves
- 12 x Support Poles
- 5 x PP Mats
- 20 x Sets of Pole Clamps
- 4 x 100 cm 2-Core Extension Cords
- 3 x 30 cm 2-Core Extension Cords
- 1 x 1.5 m AC Power Cable (US 2-Prong)
- 8 x Packs (2020T Type)
- 24 x Black Nylon Zip Ties
- 1 x Roll of Tearable Hook & Loop Strap
- 4 x 2 in Swivel Rubber Casters
- 16 x S-Hook Chains with Buckle
- Instruction Manual

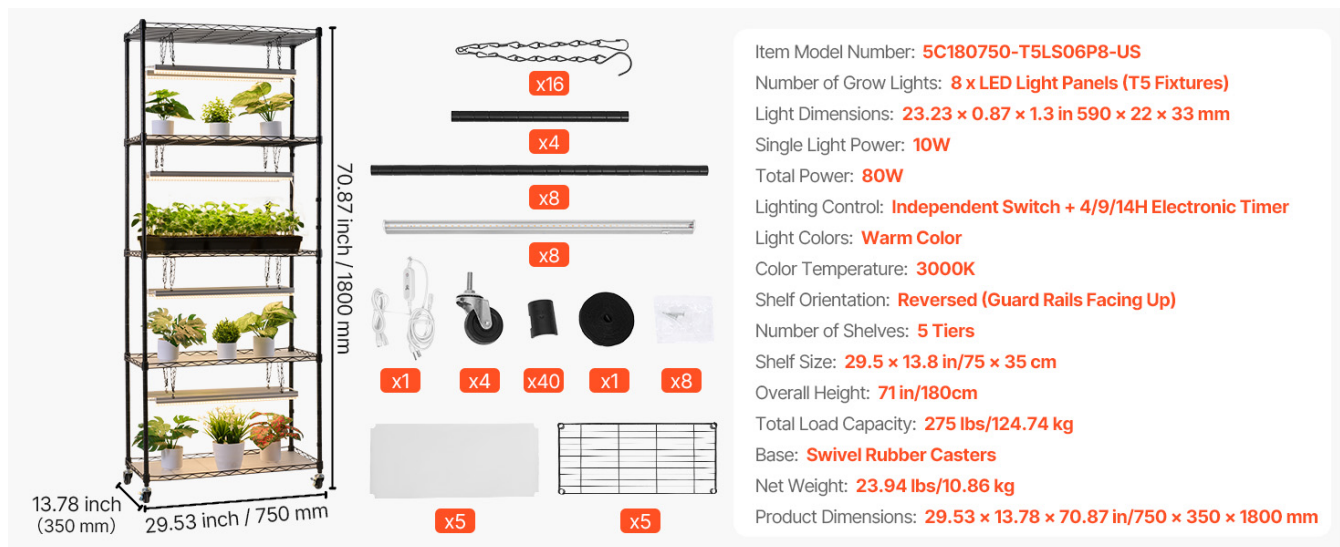

Image: Detailed diagram of all components included in the VEVOR plant shelf package.

SETUP AND ASSEMBLY

The VEVOR Plant Shelf is designed for tool-free assembly, making setup quick and straightforward. Follow these steps for proper installation:

1. **Attach the support poles to the casters:** Screw the bottom block into the bottom of four long poles. Insert the rubber casters into the bottom block.
2. **Connect the support poles to the bottom shelf:** Snap the plastic clips onto the desired height on the poles. Ensure the arrow on the plastic clips points upwards. Slide the bottom shelf over the poles until it rests securely on the clips.
3. **Install subsequent shelves:** Continue adding pole sections and shelves, securing each shelf with plastic clips at your desired height. The shelves are adjustable to accommodate different plant sizes.

4. **Install LED Grow Lights:** The grow lights can be mounted in two ways: directly clipped to the underside of the shelves or hung using the provided S-hook chains. Insert the aluminum reflectors along the card slots on both sides of the grow light. Connect the lights in series using the provided connecting cords. Each light has an independent switch.
5. **Place PP Mats:** Lay the leak-proof PP mats on each shelf to protect against water runoff.
6. **Secure Wiring:** Use the black nylon zip ties and tearable hook & loop straps to manage and secure the power cables and connecting cords, ensuring a tidy and safe setup.

Tool-Free Easy Assembly



2 Mounting Options for Grow Lights

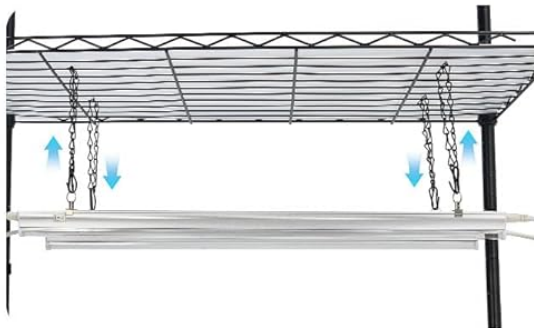

Adjustable Grow Light Height



Threaded Support Components



Adjustable Shelf Height



Swivel Rubber Casters

Image: Visual guide for tool-free assembly, showing adjustable shelves and grow light installation.

Quick Assembly in Just 6 Steps

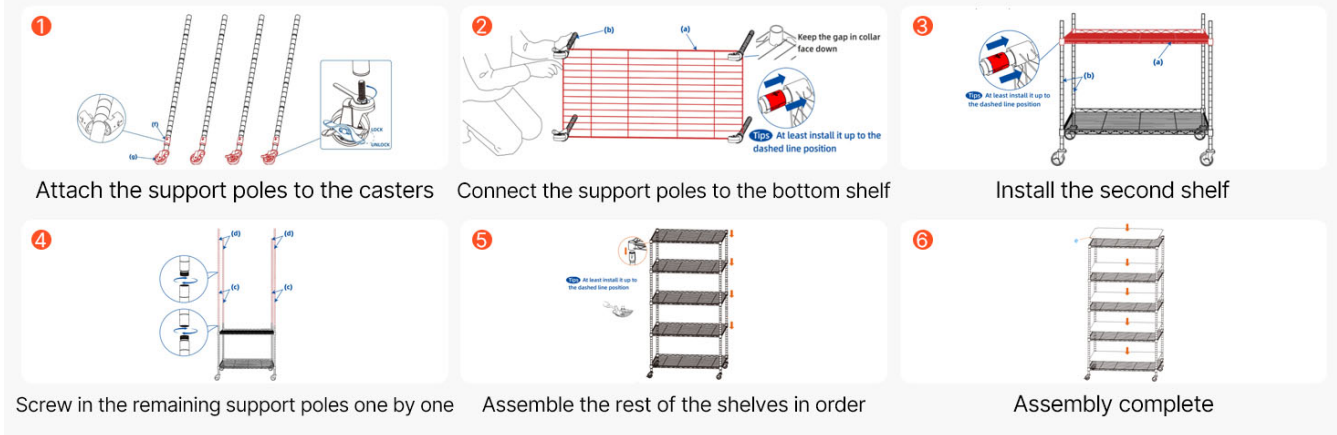

Image: Step-by-step visual instructions for quick assembly of the plant shelf.

Assembly Videos

Video: Demonstrates the quick and easy setup of the plant shelf, highlighting its tool-free assembly.

Video: Shows the unboxing and initial assembly process, emphasizing the secure packaging and components.

Video: Provides an overview of the VEVOR plant stand, including its assembly and features.

OPERATING INSTRUCTIONS

Your VEVOR Plant Shelf is equipped with full-spectrum LED grow lights and an automatic timer to provide optimal conditions for your plants.

Grow Light Operation

- Each of the 8 LED light tubes features an independent ON/OFF switch, allowing you to customize lighting for specific shelves or plants.
- The lights are full-spectrum, providing the necessary wavelengths for all stages of plant growth.

Enhanced Light Intensity for Robust Plant Growth

10W full-spectrum LED grow lights



Image: Close-up of a grow light, illustrating light intensity and individual switch.

Automatic Timer Settings

The integrated timer allows for automated light cycles:

- Select from 4, 9, or 14-hour timer settings to match your plants' needs.
- The timer ensures a consistent day/night cycle, beneficial for plant health and growth, even when you are away.

4H/9H/14H 3-Level Timer Options

Set light duration as you prefer



Image: Detailed view of the timer control unit with options for 4, 9, and 14 hours.

Operation Videos

Video: Demonstrates the features and operation of the 5-tier plant stand with grow lights.

Video: Shows the plant shelf in use, highlighting its functionality for growing plants indoors.

MAINTENANCE

- **Cleaning:** Regularly wipe down shelves and grow lights with a damp cloth to remove dust and debris. Ensure

the unit is unplugged before cleaning electrical components.

- **Tray Care:** The PP mats are leak-proof and can be easily removed for cleaning. Wash with mild soap and water as needed.
- **Cable Management:** Periodically check that all cables are securely fastened with the provided zip ties and hook & loop straps to prevent tangling or damage.
- **Caster Maintenance:** Ensure the swivel casters are clean and free of obstructions for smooth movement.

TROUBLESHOOTING

- **Lights Not Turning On:**
 - Check if the main power cable is securely plugged into a working outlet.
 - Ensure all connecting cords between the LED tubes are properly seated.
 - Verify that the individual ON/OFF switch on each light is in the 'ON' position.
 - If using the timer, ensure it is set correctly and not in an 'OFF' cycle.
- **Shelf Instability:**
 - Confirm that all pole clamps are securely fastened and properly aligned.
 - Ensure the unit is placed on a flat, level surface.
 - Distribute weight evenly across the shelves, avoiding overloading any single section.
- **Difficulty Moving Unit:**
 - Check casters for any debris or hair that might be obstructing movement.
 - Ensure the caster locks (if present) are disengaged.

SPECIFICATIONS

Item Model Number	5C180750-T5LS06P8-US
Number of Grow Lights	8 x LED Light Panels (T5 Fixtures)
Light Dimensions	23.23 x 0.87 x 1.3 inches (590 x 22 x 33 mm)
Single Light Power	10W
Total Power	80W
Lighting Control	Independent Switch + 4/9/14H Electronic Timer
Light Colors	Warm Color
Color Temperature	3000K
Shelf Orientation	Reversed (Guard Rails Facing Up)
Number of Shelves	5 Tiers
Overall Height	71 inches / 180 cm
Shelf Size	29.5 x 13.8 inches (75 x 35 cm)
Base	Swivel Rubber Casters

Total Load Capacity	275 lbs / 124.74 kg
Net Weight	23.94 lbs / 10.86 kg
Product Dimensions	29.53 x 13.78 x 70.87 inches (750 x 350 x 1800 mm)
Material	Iron
Finish Type	Powder Coated



Item Model Number: **5C180750-T5LS06P8-US**

Number of Grow Lights: **8 x LED Light Panels (T5 Fixtures)**

Light Dimensions: **23.23 x 0.87 x 1.3 in 590 x 22 x 33 mm**

Single Light Power: **10W**

Total Power: **80W**

Lighting Control: **Independent Switch + 4/9/14H Electronic Timer**

Light Colors: **Warm Color**

Color Temperature: **3000K**

Shelf Orientation: **Reversed (Guard Rails Facing Up)**

Number of Shelves: **5 Tiers**

Shelf Size: **29.5 x 13.8 in/75 x 35 cm**

Overall Height: **71 in/180cm**

Total Load Capacity: **275 lbs/124.74 kg**

Base: **Swivel Rubber Casters**

Net Weight: **23.94 lbs/10.86 kg**

Product Dimensions: **29.53 x 13.78 x 70.87 in/750 x 350 x 1800 mm**

Image: Visual representation of the plant shelf's dimensions and technical specifications.

WARRANTY AND SUPPORT

For technical support or warranty information, please visit the official VEVOR support website at www.vevor.com/support. VEVOR is committed to providing quality tools and competitive prices. Please refer to your purchase documentation for specific warranty terms and conditions.