

Reyke S10

Reyke Android Smart Tag Tracker (Model S10) Instruction Manual

Model: S10 | Brand: Reyke

INTRODUCTION

The Reyke Android Smart Tag Tracker is a compact and efficient device designed to help you keep track of your valuable items. Fully compatible with the Google Find My Device network, it allows Android users to locate misplaced belongings such as keys, wallets, bags, and luggage with ease. This manual provides detailed instructions for setting up, operating, and maintaining your Smart Tag Tracker.

PRODUCT OVERVIEW

The Reyke Smart Tag Tracker utilizes Bluetooth technology to connect to your Android device and leverage the Google Find My Device network. Its durable design and long-lasting replaceable battery ensure reliable performance.

Works with Google Find My Device

Easily locate your items with the Google Find My Device on your Android phone, supported by the Google system

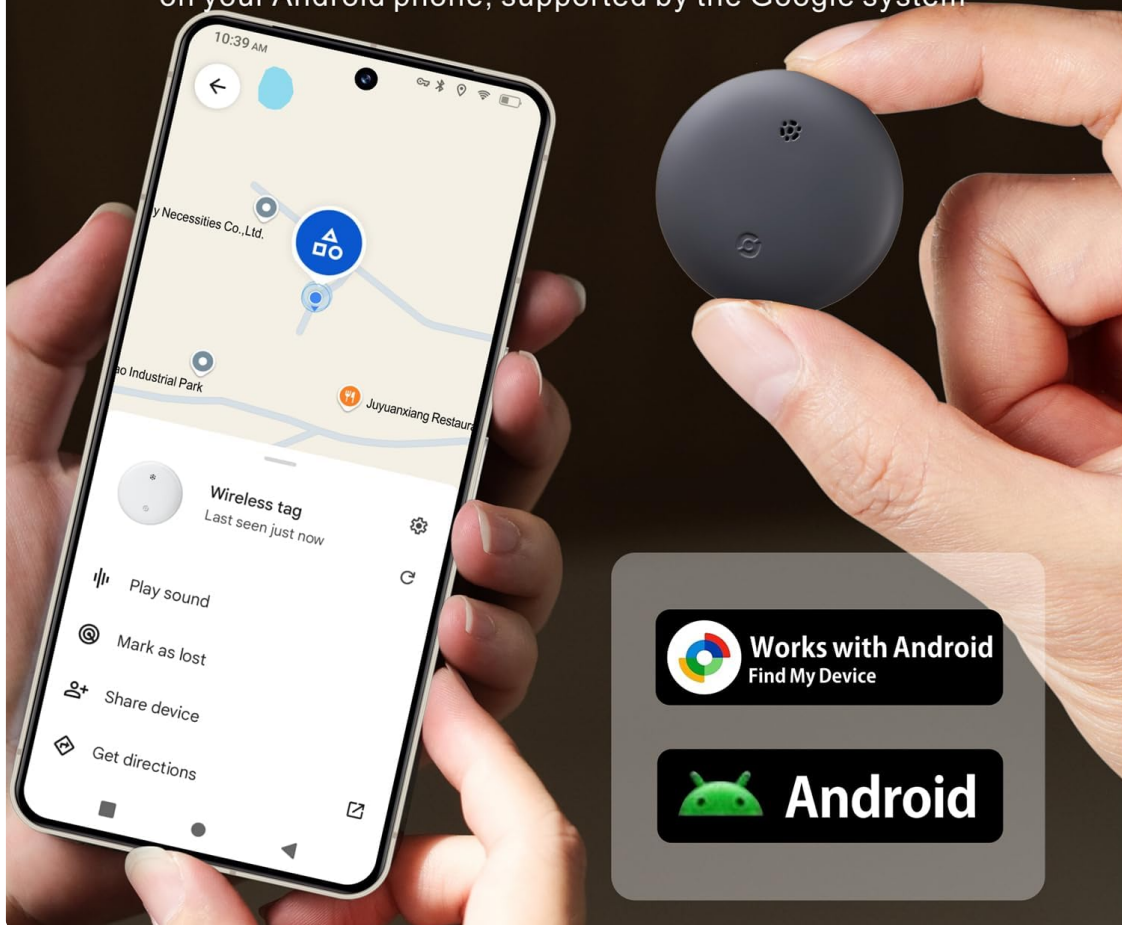

Image: The Reyke Smart Tag Tracker shown alongside an Android phone displaying the Google Find My Device interface, indicating its compatibility and functionality.

Key Features:

- **Google Find My Device Compatibility:** Seamlessly integrates with the Google Find My Device network for broad tracking capabilities (Android only).
- **Loud Audible Alert:** Emits a loud beep (90-105dB) to help locate items nearby.
- **Extended Bluetooth Range:** Offers a Bluetooth range of up to 160 feet (50 meters).
- **Waterproof Design:** IPX6 waterproof rating ensures protection against water splashes and rain.
- **Replaceable Battery:** Powered by a replaceable lithium metal battery with a life of approximately 365 days.

SETUP INSTRUCTIONS

1. **Prepare Your Android Device:** Ensure your Android smartphone or tablet has Bluetooth enabled and the Google Find My Device app installed and updated.
2. **Activate the Smart Tag:** The Reyke Smart Tag comes with a pre-installed battery. To activate, simply press the button on the tag. You may hear a short chime indicating it's ready for pairing.
3. **Pair with Google Find My Device:**

- Open the Google Find My Device app on your Android device.
 - The app should automatically detect nearby Reyke Smart Tags. Follow the on-screen prompts to add the tag to your account.
 - If not automatically detected, navigate to the "Add new device" or similar option within the app settings and follow the pairing instructions.
4. **Name Your Tag:** Assign a descriptive name to your Smart Tag (e.g., "Keys," "Wallet," "Luggage") within the Google Find My Device app for easy identification.
 5. **Attach to Item:** Securely attach the Reyke Smart Tag to the item you wish to track using the included keychain or by placing it inside a bag or wallet.

OPERATING INSTRUCTIONS

Locating a Lost Item

1. **Using Google Find My Device App:**
 - Open the Google Find My Device app on your Android smartphone or tablet.
 - Select the Reyke Smart Tag associated with the item you are looking for.
 - The app will display the last known location of your item on a map.
2. **Playing a Sound:**
 - If your item is within Bluetooth range, tap the "Play sound" option in the app.
 - The Reyke Smart Tag will emit a loud beep (up to 105dB) to help you pinpoint its exact location.

Locate Item with Sound

Crystal-Clear Audibility and Impressive Tracking Range
Up to 105dB loud beep
Up to 180ft. Bluetooth range



Image: An illustration of the "Play sound" feature within the Google Find My Device app, showing the Reyke Smart Tag emitting an audible alert to help locate it, even when hidden.

Sharing Your Device

The Reyke Smart Tag allows you to share its location tracking capabilities with trusted friends or family members through the Google Find My Device app. This is useful for shared items or for ensuring someone else can help locate your belongings if needed.

1. In the Google Find My Device app, select the Reyke Smart Tag you wish to share.
2. Look for a "Share device" or similar option.
3. Follow the prompts to send a sharing link via a messaging app. The recipient will need to accept the invitation to view the tag's location.

Share Device in Google Find My

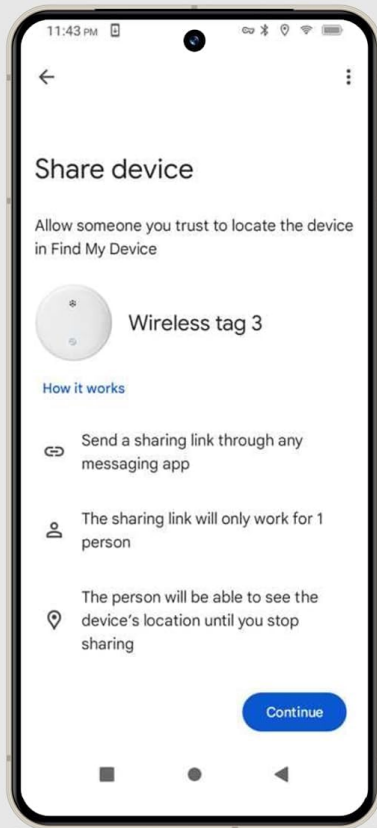

With Google Find My Device, easily share your Tag with friends and family for seamless tracking and finding. Up to 4 borrowers can be shared in addition to yourself.



Image: The "Share device" interface within the Google Find My Device app, demonstrating how to share access to your Reyke Smart Tag with others for collaborative tracking.

MAINTENANCE

Battery Replacement

The Reyke Smart Tag is powered by a replaceable lithium metal battery (CR2032, typically). The battery life is approximately 365 days. When the battery is low, you may receive a notification from the Google Find My Device app, or the tag's performance may diminish.

1. Locate the battery compartment on the back of the Reyke Smart Tag.
2. Carefully open the compartment using a small tool or by twisting the cover (refer to product packaging for specific instructions if needed).
3. Remove the old battery and insert a new CR2032 lithium metal battery, ensuring correct polarity (+ side up).
4. Close the battery compartment securely.

Note: Dispose of old batteries responsibly according to local regulations.

Cleaning

Wipe the Reyke Smart Tag with a soft, dry cloth. Avoid using harsh chemicals or abrasive materials, as these can damage the device.

Water Resistance

The Reyke Smart Tag has an IPX6 waterproof rating, meaning it is protected against powerful water jets. It is suitable for outdoor use and can withstand rain or splashes, but it is not designed for submersion in water.



Image: The Reyke Smart Tag, shown with water droplets, highlighting its IPX6 waterproof capability, making it suitable for various environments.

TROUBLESHOOTING

- **Tag not connecting to phone:**
 - Ensure Bluetooth is enabled on your Android device.
 - Make sure the Reyke Smart Tag is within Bluetooth range of your phone.
 - Check the battery level of the Smart Tag. Replace if necessary.
 - Restart your phone and try pairing again.
- **Cannot hear the sound alert:**
 - Ensure the Smart Tag is within Bluetooth range.
 - Check the battery level. A low battery might result in a weaker sound.
 - Ensure there are no obstructions heavily muffling the sound.
- **Location not updating:**
 - The location displayed is the last known location where the tag was in range of an

Android device on the Google Find My network.

- Ensure your Android device has an active internet connection (Wi-Fi or mobile data) for location updates.
- Verify that location services are enabled for the Google Find My Device app on your phone.

SPECIFICATIONS

Model Number:	S10
Brand:	Reyke
Connectivity Technology:	Bluetooth
Compatible Devices:	Google Find My Device, Android Smartphones, Tablets
Control Method:	Application (Google Find My Device)
Battery Type:	Lithium Metal (CR2032)
Battery Life:	Approximately 365 days
Battery Replaceability:	Yes
Sound Level:	90-105 dB
Bluetooth Range:	Up to 160 ft (50 m)
Waterproof Rating:	IPX6
Material:	Plastic
Dimensions (Diameter x Thickness):	1.26 in (32 mm) x 0.31 in (7.9 mm)
Country of Origin:	China
UPC:	725414507883



Image: A visual representation of the Reyke Smart Tag's dimensions and key technical specifications, including sound level, Bluetooth range, waterproof rating, and battery type.

WARRANTY INFORMATION

Specific warranty information for the Reyke Android Smart Tag Tracker is not provided in the product details. Please refer to the product packaging or contact Reyke customer support for warranty terms and conditions.

CUSTOMER SUPPORT

For further assistance, technical support, or inquiries regarding your Reyke Android Smart Tag Tracker, please refer to the contact information provided on the product packaging or visit the official Reyke website. You can also check the Google Find My Device app's help section for app-specific support.

USAGE SCENARIOS

The Reyke Smart Tag is versatile and can be used to track a variety of personal items:

- **Keys:** Attach to your house keys, car keys, or office keys.
- **Wallets:** Place inside your wallet or purse.
- **Luggage:** Secure to suitcases or carry-on bags when traveling.

- **Backpacks:** Ideal for school bags, hiking backpacks, or everyday carry bags.
- **Bicycles:** Discreetly attach to your bicycle for tracking.



Image: A collage illustrating various practical applications for the Reyke Smart Tag, including attachment to keys, placement in a wallet, and securing to luggage, bicycles, and backpacks.