

Gamrombo Wireless Controller

Gamrombo Wireless Controller Instruction Manual

Model: Wireless Controller

1. PRODUCT OVERVIEW

The Gamrombo Wireless Controller is designed for a versatile gaming experience across multiple platforms. It features 8 adjustable RGB lighting modes, dual vibration motors, a 360° joystick, and programmable function keys to enhance gameplay.

**MILLIONS OF GAMES TO CHOOSE FROM,
PRECISE OPERATION, AND
MORE FUN!**

The image features a black Gamrombo Wireless Controller with glowing buttons and joysticks. Above the controller are icons for Wi-Fi and Bluetooth connectivity. The background is a collage of various video game covers. Below the controller, five icons represent compatibility with different platforms: Xbox One X/S, Xbox Series X/S, PC, Android/iOS, and Steam.

For Xbox One X/S For Xbox Series X/S For PC For Android/iOS For Steam

!!! Note: If official authorization is required connect to Xbox consoles, you need to connect to the computer to update manually
Please contact us after ordering for updated information or download the upgrade process from "Product guides and documents"

Figure 1: Gamrombo Wireless Controller and its multi-platform compatibility.

2. CONTROLLER LAYOUT

Familiarize yourself with the buttons and ports on your Gamrombo Wireless Controller.



Figure 2: Front and rear view of the controller with labeled components.

- **Home Button:** Powers on/off the controller and accesses system menus.
- **View Button:** Accesses in-game maps or menus.
- **Menu Button:** Accesses game or app menus.
- **A/B/X/Y Buttons:** Standard action buttons.
- **Left Stick/L3:** Movement and L3 press function.
- **Right Stick/R3:** Camera control and R3 press function.
- **Cross Key (D-pad):** Directional input.
- **LB/RB:** Left and Right Bumper buttons.
- **LT/RT:** Left and Right Trigger buttons.
- **Turbo Button:** Activates turbo function for rapid input.
- **Type-C Interface:** For charging and wired connection.
- **Pairing Button:** Initiates wireless pairing.
- **PR/PL Buttons:** Programmable rear paddle buttons.

- **Set Button:** Used for programming functions.
- **3.5mm Headphone Jack:** For audio output.

3. SETUP AND CONNECTION

3.1 Charging the Controller

Connect the included Type-C charging cable to the controller's Type-C interface and plug the other end into a USB power source (e.g., console, PC, USB wall adapter). The controller's indicator lights will show charging status.

3.2 Wireless Connection (Xbox Consoles)

1. Ensure your Xbox console (Xbox One, Xbox Series X|S) is powered on.
2. Press the pairing key on your Xbox console.
3. Press and hold the **HOME** button on the controller for 1 second.
4. Press and hold the **Pairing Button** on the controller for 1 second.

The HOME indicator on the controller will remain on once pairing is successful.

3.3 Wireless Connection (PC/iOS/Android)

1. Press and hold the **HOME** button on the controller for 1 second.
2. Press and hold the **Pairing Button** on the controller for 1 second.
3. On your PC/iOS/Android device, turn on Bluetooth and search for "Xbox Wireless Controller". Select it to pair. (Note: iOS systems must be version 13.0 or above).



Figure 3: Wireless connection instructions for various platforms.

The controller supports Bluetooth, WiFi, and wired connections. For optimal performance, ensure the controller is within 32 feet (approximately 10 meters) of the connected device for wireless operation.

3.4 Wired Connection

Connect the controller to your console or PC using the Type-C charging cable for a direct wired connection. This method bypasses wireless pairing and provides a stable connection.

4. OPERATING INSTRUCTIONS

4.1 RGB Lighting Modes

The controller features 8 adjustable RGB lighting modes. To adjust the lighting:

1. When the controller is powered on, press and hold **L3 + R3** for 3 seconds. The controller will vibrate.
2. Press **L3** to switch between different lighting modes (e.g., Colorful Glitter, Colorful Mode, Function Keys Glow, Partial Area Glows, The Middle Area Glows, Regional Light, Color Cycle, Colorful).
3. Press **R3** to lock the current lighting mode.



Figure 4: Examples of RGB lighting modes and adjustment steps.

4.2 Turbo Function

The Turbo function allows for rapid, repeated input of a button press. To activate:

1. Press and hold any function key (A/B/X/Y/LB/RB/LT/RT).
2. While holding the function key, press the **Turbo Button**. The function key will now rapidly repeat its input when held.

There are 3 adjustable Turbo speeds: 5/s, 12/s, and 20/s. To adjust the speed, press the Turbo button and then press the D-pad Up or Down.



Figure 5: Turbo function activation and speed adjustment.

4.3 Programming Function Keys (Macro)

The PR and PL keys on the back of the controller can be programmed to perform a sequence of up to 16 combined function keys.

1. Press the **"Set"** key.
2. Press any function key (A/B/X/Y/LB/RB/LT/RT/Cross Key/PL/PR) you wish to program.
3. Input the sequence of up to 16 key values.
4. Press the **"Set"** key again to save the macro.



Figure 6: Programming the PR/PL function keys.

4.4 Dual Vibration and 6-Axis Gyro

The controller features dual vibration motors for realistic feedback during gameplay and a sensitive 6-axis gyro for enhanced motion control in supported games.

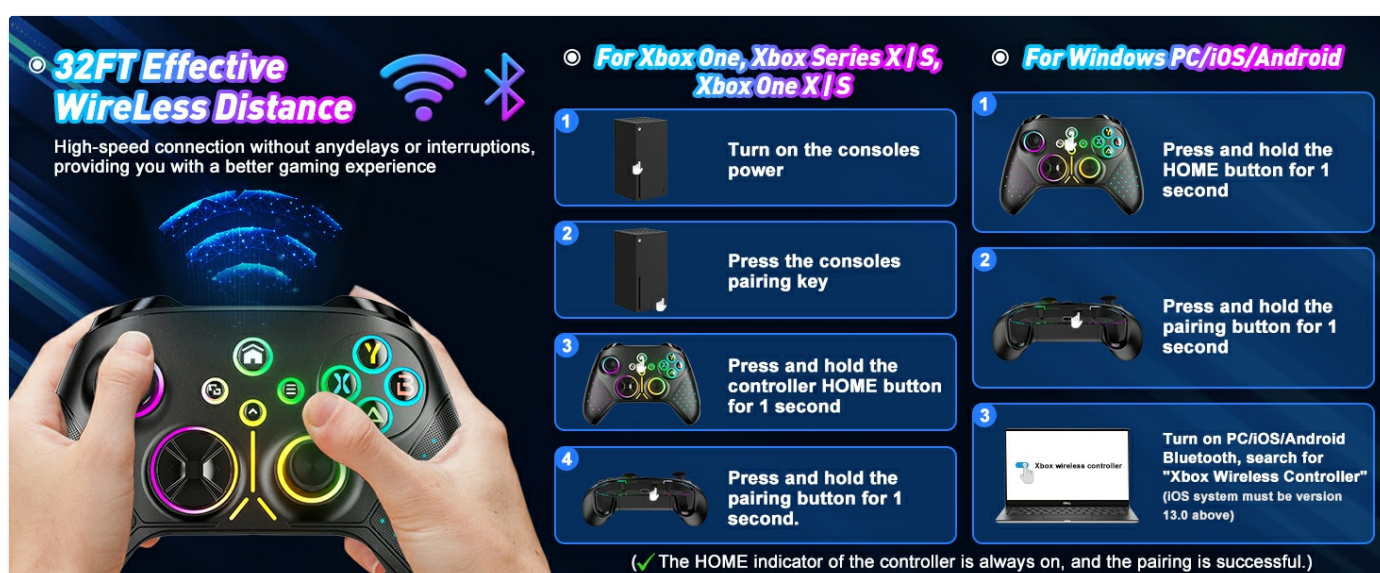

Figure 7: Dual vibration and 6-axis gyro features.

5. MAINTENANCE

Proper maintenance ensures the longevity and optimal performance of your controller.

- **Cleaning:** Use a soft, dry cloth to wipe the controller. For stubborn dirt, slightly dampen the cloth with water or a mild cleaning solution. Avoid harsh chemicals or abrasive materials.
- **Storage:** Store the controller in a cool, dry place away from direct sunlight and extreme temperatures.
- **Battery Care:** Avoid fully discharging the battery frequently. Charge the controller regularly, even if not in use for extended periods, to maintain battery health.
- **Cable Care:** Handle the Type-C charging cable carefully. Avoid bending or twisting it excessively to prevent damage.

6. TROUBLESHOOTING

Problem	Possible Cause	Solution
Controller does not power on.	Low battery or no charge.	Connect the controller to a power source using the Type-C cable and allow it to charge.
Controller does not connect wirelessly.	Not paired correctly, out of range, or interference.	Ensure the controller is fully charged. Repeat the pairing steps (Section 3.2 or 3.3). Move closer to the console/device. Ensure no other Bluetooth devices are causing interference. Try a wired connection to confirm controller functionality.
Buttons or joystick are unresponsive/delayed.	Software glitch, physical obstruction, or wear.	Restart the controller and the connected device. Ensure the controller's firmware is up to date (refer to manufacturer's website for updates). Clean around the buttons/joystick to remove any debris. If a specific button (e.g., D-pad) is consistently unresponsive, it may indicate a hardware issue.
RGB lights are not working or stuck.	Incorrect setting or temporary software issue.	Repeat the RGB lighting adjustment steps (Section 4.1). Power cycle the controller.

7. SPECIFICATIONS

- **Model:** Gamrombo Wireless Controller
- **Connectivity:** Bluetooth, WiFi, Wired (Type-C)
- **Compatibility:** Xbox One, Xbox Series X|S, Xbox One S|X, PC, Android, iOS (version 13.0+), Windows 11/10/8/7
- **Wireless Range:** Up to 32 feet (approximately 10 meters)
- **Features:** 8 Adjustable RGB Lighting Modes, Dual Vibration Motors, 360° Joystick, Programmable Macro Keys (PR/PL), Turbo Function, 6-Axis Gyro, 3.5mm Headphone Jack
- **Dimensions:** Approximately 6.85 x 4.8 x 2.83 inches
- **Weight:** Approximately 10.5 ounces
- **Charging Port:** USB Type-C

8. WARRANTY AND SUPPORT

This product includes an Instruction Manual & Warranty Card. Please refer to this card for detailed warranty information and terms.

For any questions, technical support, or warranty claims regarding your Gamrombo Wireless Controller, please contact Gamrombo customer service directly. Contact information can typically be found on the warranty card or the official Gamrombo website.



