



[Manuals.plus](#) /

> [FLUENTPOWER](#) /

> FLUENTPOWER FSP65035DWB 5000GPH Sewage Effluent Pump Instruction Manual

FLUENTPOWER FSP65035DWB

FLUENTPOWER FSP65035DWB Sewage Effluent Pump Instruction Manual

Model: FSP65035DWB | Brand: FLUENTPOWER

1. PRODUCT OVERVIEW

The FLUENTPOWER FSP65035DWB is a robust 3/4 HP submersible sewage effluent pump designed for efficient water transfer in residential applications. Constructed from durable cast iron, this pump features a non-clogging vortex impeller capable of handling solids up to 1.4 inches. It includes an automatic vertical float switch for reliable operation and is suitable for use in basements, septic basins, outdoor storage tanks, and sewers.



Image 1.1: FLUENTPOWER FSP65035DWB Sewage Effluent Pump.

2. SAFETY INFORMATION

Read and understand all safety instructions before operating the pump. Failure to follow these instructions may result in electric shock, fire, or serious injury.

- **Electrical Safety:** Always connect the pump to a grounded outlet. A Ground Fault Circuit Interrupter (GFCI) outlet is strongly recommended for enhanced safety. Ensure the power cord is free from damage.
- **Submersion:** The pump must be fully immersed in water during operation to prevent overheating and damage. Do not allow the pump to run dry.
- **Liquid Compatibility:** Do not pump flammable or explosive liquids such as oil, gasoline, kerosene, or ethanol. This pump is designed for water and sewage effluent only.
- **Handling:** Do not lift the pump by the power cord. Use the integrated metal ring and the provided nylon rope for lifting and lowering the pump.
- **Maintenance:** Do not dismantle the motor casing. This can lead to oil leaks or hazardous electrical wiring issues. Refer to qualified personnel for internal repairs.

- **Float Switch Clearance:** Ensure there is sufficient space for the float switch to move freely, allowing for proper automatic operation.

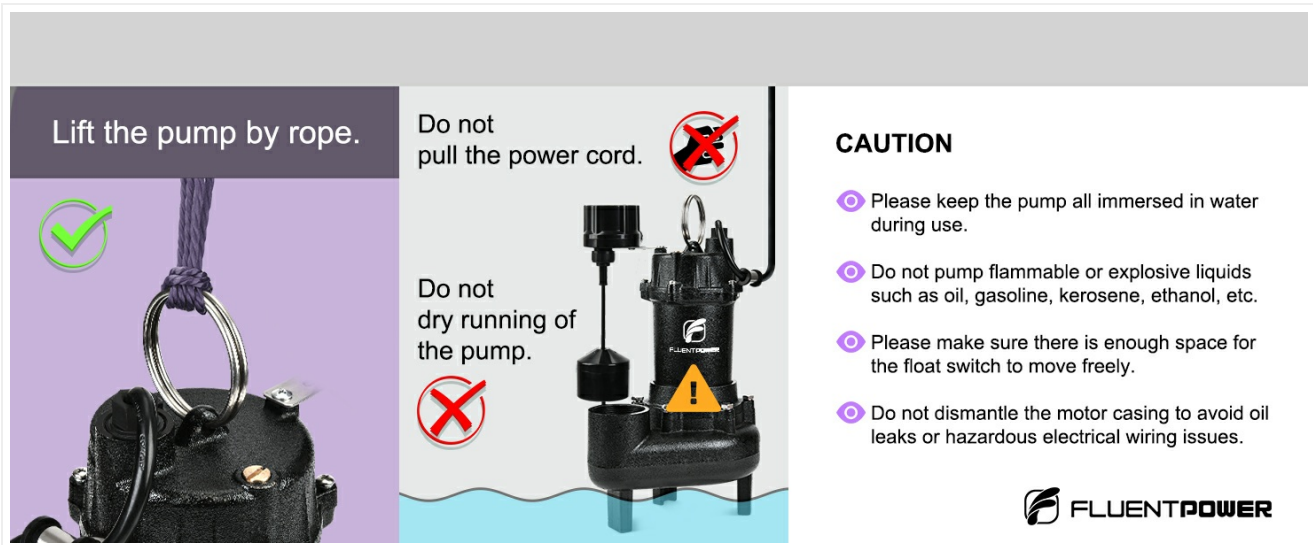

Image 2.1: Visual safety guidelines for pump usage.

3. PRODUCT FEATURES

- **Powerful Motor:** Equipped with a 3/4 HP motor, ensuring efficient water transfer up to 5000 GPH.
- **Durable Construction:** Features a full corrosion-resistant rugged cast iron casing for extended durability.
- **Non-Clogging Impeller:** Reinforced engineered vortex impeller designed to pass solids up to 1.4 inches without clogging.
- **Thermal Overload Protection:** Built-in automatic thermal overload protection prevents motor burnout. The pump will automatically restart after cooling down if triggered.
- **Automatic & Manual Operation:** Can operate automatically via the vertical float switch or manually by plugging/unplugging the pump directly.
- **Vertical Float Switch:** External mechanical float switch automatically turns the pump on and off based on water levels.

4. TECHNICAL SPECIFICATIONS



Technical Specification

POWER: 3/4 HP
Flow Rate: 5000 GPH
Power Cord: 10 FT

AMP: 6.4 A
Weight: 25 Pounds
Max Solid: 1.4 Inch

Discharge NPT	GPH OF WATER @ TOTAL FT. OF HEAD					Max. Head
	3'	6'	10'	13'	16'	
51mm (2")	4700	4100	3600	3000	1800	21 FT

Image 4.1: Technical specifications of the pump.

Specification	Value
Model Number	FSP65035DWB
Power	3/4 HP
Maximum Flow Rate	5000 GPH (84 Gallons Per Minute)
Maximum Lifting Height	21 Feet
Maximum Solid Size	1.4 Inches
Material	Cast Iron
Discharge Size	2" NPT
Power Source	Corded Electric
Voltage	110 Volts
Item Weight	25 Pounds

Product Dimensions (L x W x H)	10.8" x 8.5" x 17.1"
Power Cord Length	10 Feet
Operating Water Temperature	32-95°F

5. INCLUDED COMPONENTS

The FLUENTPOWER FSP65035DWB pump package includes the following items:

- FLUENTPOWER Sewage Effluent Pump
- Vertical Mechanical Float Switch with Piggy-back Plug
- 10 ft UL Power Cable
- Hose Fitting (2" to 1.5" adapter)
- 26 ft Nylon Rope for lifting
- Tread Seal Tape
- Mounting Bracket for Float Switch (for pump and pipe mounting)
- Four Screws for mounting

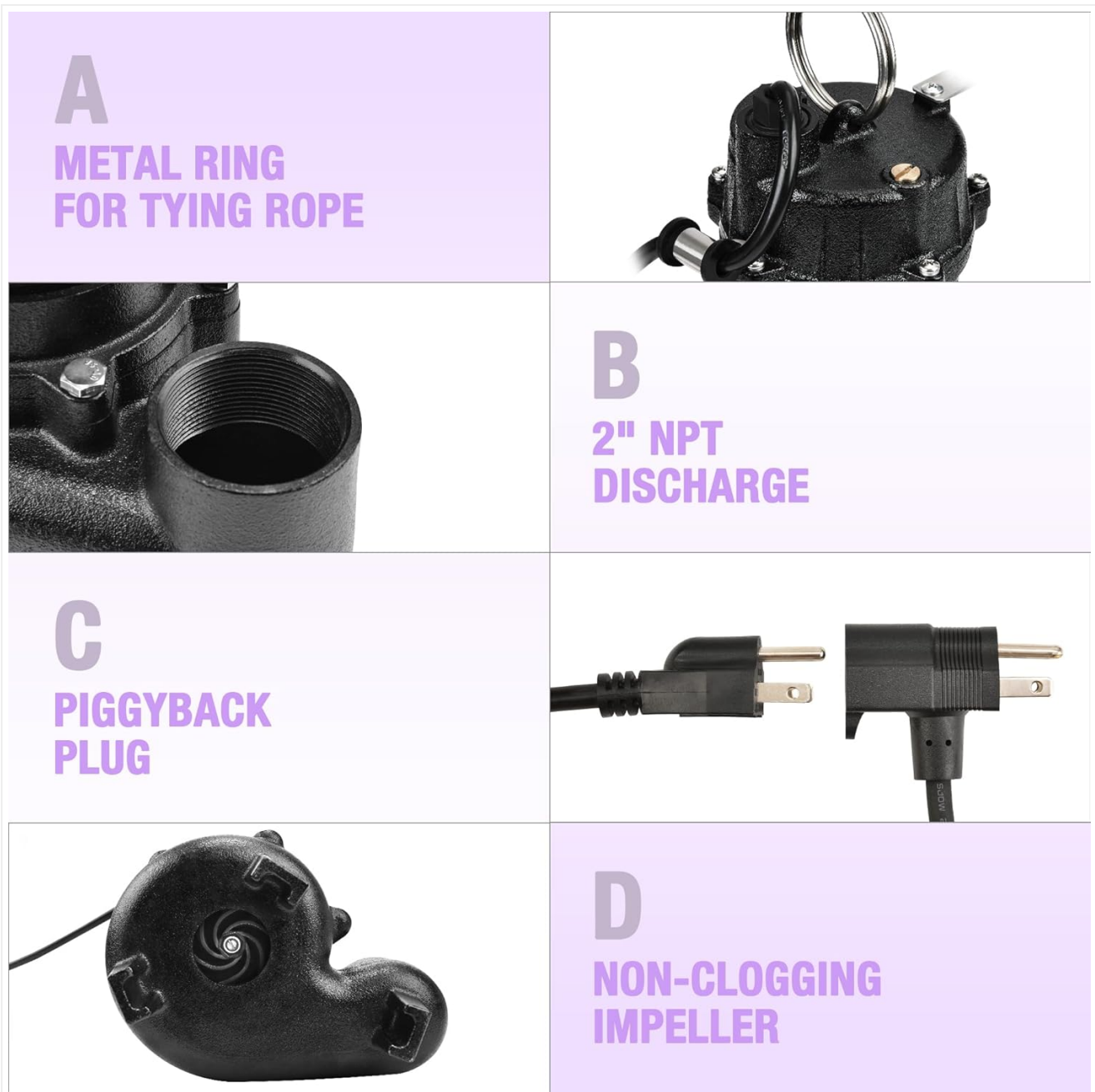

Image 5.1: Included components.

6. SETUP AND INSTALLATION

Follow these steps for proper installation of your FLUENTPOWER sewage effluent pump:

- 1. Prepare the Sump Pit:** Ensure the sump pit has a minimum diameter of 13 inches to allow for proper pump and float switch operation. The maximum operating depth is 8 feet.
- 2. Attach Discharge Pipe:** Select the appropriate adapter (2" NPT or 1.5" with adapter) and securely attach your discharge hose or PVC pipe to the pump's outlet. Use the provided tread seal tape for a watertight connection.
- 3. Install Check Valve:** It is recommended to install a check valve (not included) at the outlet pipe to prevent backflow of water into the sump pit.
- 4. Float Switch Installation:** The vertical float switch can be fixed on the pump or on the discharge pipe using the provided mounting brackets. Adjust the float switch to your desired ON/OFF water levels. Ensure the float switch can move freely without obstruction.
- 5. Lower the Pump:** Carefully lower the pump into the sump pit using the 26 ft nylon rope attached to the metal

ring on top of the pump. Ensure the pump rests on a stable, level surface at the bottom of the pit. Do not use the power cord to lower or retrieve the pump.

6. **Electrical Connection:** Plug the pump's power cord into the piggy-back plug of the float switch. Then, plug the float switch's plug into a grounded GFCI outlet.

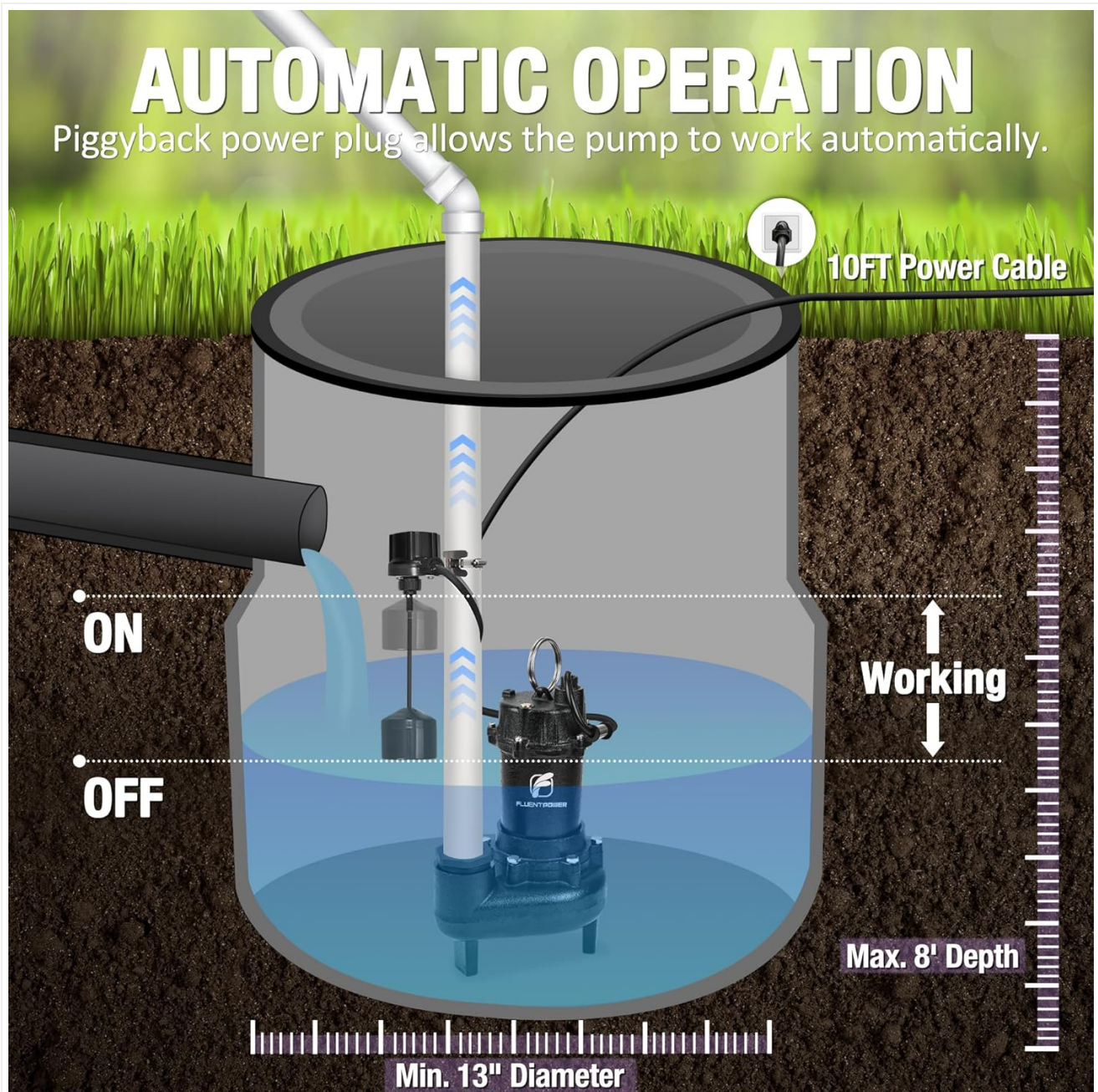

Image 6.1: Automatic operation setup in a sump pit.

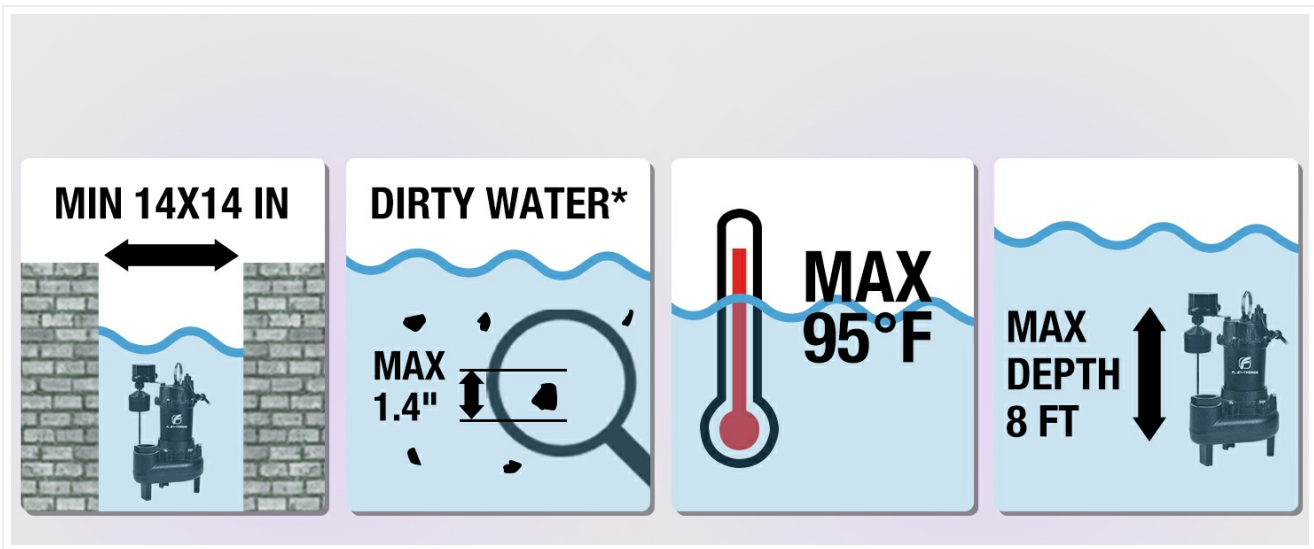

Image 6.2: Connection, submersion, and power-on steps.

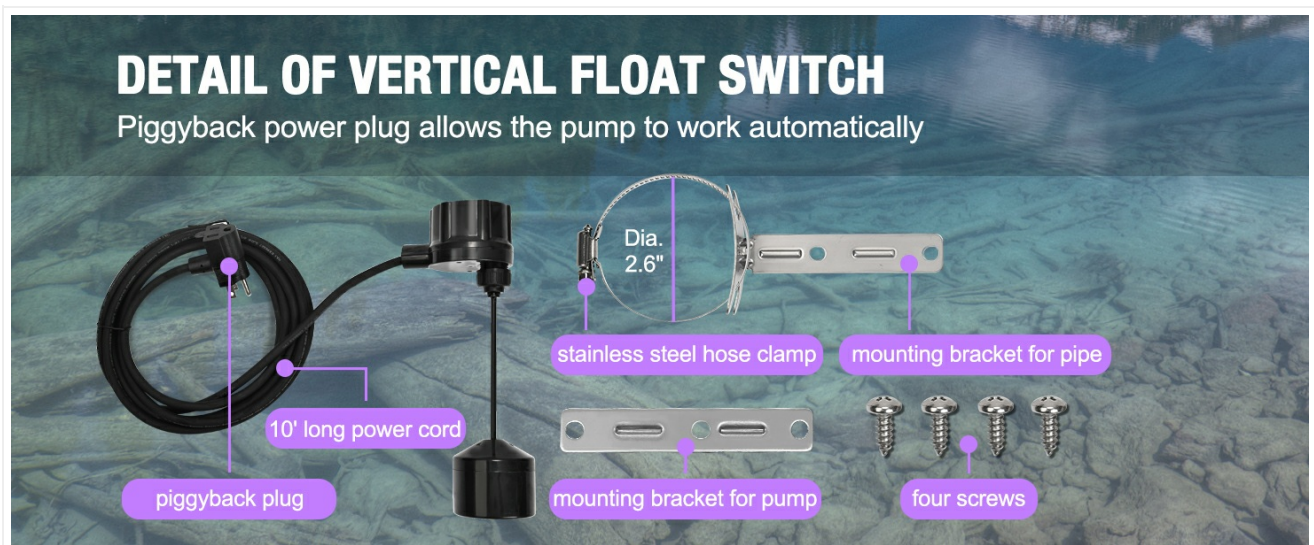

Image 6.3: Vertical float switch details.

Your browser does not support the video tag.

Video 6.1: Demonstration of the FLUENTPOWER Cast Iron Sewage Effluent Pump with its float switch.

Your browser does not support the video tag.

Video 6.2: Installation and testing of the FLUENTPOWER 3/4HP 5000GPH Sewage Effluent Cast Iron Pump.

7. OPERATING INSTRUCTIONS

The FLUENTPOWER FSP65035DWB pump offers both automatic and manual operation modes:

- **Automatic Operation:** When the pump is connected via the piggy-back plug to the vertical float switch, it will automatically turn on when the water level rises and lifts the float switch. It will turn off when the water level drops and the float switch returns to its lower position.
- **Manual Operation:** To operate the pump manually, unplug the pump's power cord from the float switch's piggy-back plug and plug the pump's power cord directly into a grounded GFCI outlet. The pump will run continuously until unplugged. **Caution:** Do not allow the pump to run dry in manual mode.

TWO WAYS OF INSTALLATION

Fixed on the pump

Low water level regulating switch

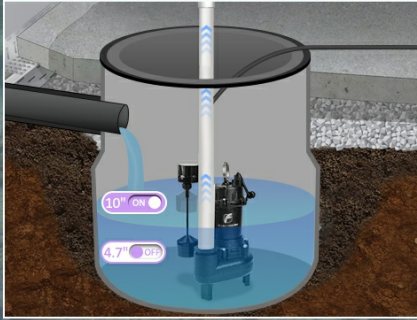

Fixed on the pipe

High water level regulating switch



Image 7.1: Applicable scenarios for the sewage effluent pump.

8. MAINTENANCE

Regular maintenance ensures the longevity and optimal performance of your pump:

- **Regular Inspection:** Periodically inspect the pump, power cord, and float switch for any signs of damage, wear, or debris accumulation.
- **Clean Impeller:** If the pump's performance decreases, disconnect power and inspect the impeller for any obstructions. Clear any debris carefully.
- **Keep Submerged:** Always ensure the pump remains fully submerged in water during operation to prevent motor damage from overheating.
- **Winterization:** In freezing climates, remove the pump from the pit before winter to prevent ice damage. Clean and store it in a dry, frost-free location.

9. TROUBLESHOOTING

Before attempting any troubleshooting, always disconnect the pump from the power source.

Problem	Possible Cause	Solution
Pump does not start	No power; Float switch stuck; Thermal overload activated; Clogged impeller.	Check power supply/GFCI; Ensure float switch moves freely; Allow pump to cool down; Inspect and clear impeller.
Pump runs but no water is discharged	Air lock; Clogged discharge pipe; Impeller damaged.	Ensure pump is fully submerged; Check for kinks or blockages in the discharge pipe; Inspect impeller for damage.
Pump cycles too frequently	Float switch adjustment; Check valve issue; Water backflowing.	Adjust float switch settings; Inspect or install a check valve; Check for leaks in the discharge system.

10. WARRANTY AND SUPPORT

FLUENTPOWER provides a 1-year warranty for this product, ensuring quality and reliability. We are committed to

offering lifelong professional technical consultation and 24-hour customer service to assist you with any inquiries or issues.

For technical support or warranty claims, please contact FLUENTPOWER customer service through the retailer where the product was purchased or visit the official FLUENTPOWER website.