



Manuals.plus /

› Sacnahe /

› Sacnahe M8 Wireless Tattoo Stencil Printer User Manual

Sacnahe M8

Sacnahe M8 Wireless Tattoo Stencil Printer User Manual

Model: M8 | Brand: Sacnahe

1. INTRODUCTION

This manual provides detailed instructions for the safe and efficient operation of your Sacnahe M8 Wireless Tattoo Stencil Printer. Please read this manual thoroughly before use and retain it for future reference. This device is designed to create high-quality thermal tattoo stencils from digital designs, offering portability and ease of use.

2. SAFETY INFORMATION

To ensure safe operation and prevent damage to the device or injury, please observe the following safety guidelines:

- Always operate the printer in a well-ventilated area.
- Do not expose the printer to water, excessive moisture, or extreme temperatures.
- Avoid disassembling the device. Refer all servicing to qualified personnel.
- Keep the printer and its accessories out of reach of children.
- Use only the specified thermal stencil paper for this printer.
- Ensure the power adapter and cable are undamaged before connecting to a power source.

3. PACKAGE CONTENTS

Please check the package contents upon unboxing. If any items are missing or damaged, contact customer support immediately.

- Sacnahe M8 Wireless Tattoo Stencil Printer
- USB-C Charging Cable
- 10 x Thermal Tattoo Stencil Papers
- User Manual (this document)

4. PRODUCT OVERVIEW

The Sacnahe M8 is a compact, wireless thermal printer designed for creating tattoo stencils. It features a lightweight design, app control for custom sizing, and broad compatibility with various devices.

Key Features:

- **Ultra-Portable & Wireless Design:** Weighing approximately 1.08 lbs, it's ideal for mobile use.
- **App-Controlled Custom Sizing:** Select any stencil size up to A4 via the dedicated app.
- **Precision Portrait Printing:** Capable of high-resolution output for detailed designs.
- **Smart App Control:** Intuitive app with drag-and-drop editing, real-time size adjustments, and preset templates.
- **Universal Device Compatibility:** Connects seamlessly with Android, iOS, Windows devices via Bluetooth or USB.
- **Inkless Printing:** Utilizes advanced thermal technology, eliminating the need for ink cartridges.

Printer Components:

Familiarize yourself with the main parts of your printer:



Image: The Sacnahe M8 printer shown with various tattoo stencil designs being printed and displayed, along with mobile devices demonstrating the app interface.

- **Power Button:** Located on the side, used to turn the printer on/off.
- **Open Cover Button:** Releases the top cover for paper loading.
- **Paper Limiter Button:** Helps align paper correctly.
- **Paper Input Slot:** Where thermal stencil paper is inserted.
- **USB-C Port:** For charging and wired connection to PC.

5. SETUP

5.1 Charging the Printer

Before initial use, ensure the printer is fully charged.

1. Connect the provided USB-C cable to the printer's charging port.
2. Connect the other end of the cable to a compatible USB power adapter (not included) or a computer's USB port.

3. The indicator light will show charging status (refer to device for specific light behavior).
4. Once fully charged, disconnect the cable.

5.2 App Download and Installation

The Sacnahe M8 printer requires a dedicated app for mobile device operation.



Image: A visual guide showing the steps to download the app, connect the printer, select a pattern, and start printing.

1. For mobile devices (iOS/Android), search for the 'Sacnahe' app in your respective app store.
2. Alternatively, visit the official download page: <https://www.xmwycloud.com/M8/download.html>
3. For PC (Windows), download the necessary drivers from:
https://www.xmwycloud.com/service/service_en.html?lfddriver
4. Install the app/drivers on your device.

5.3 Connecting the Printer

The printer supports both Bluetooth (for mobile) and USB (for PC) connections.

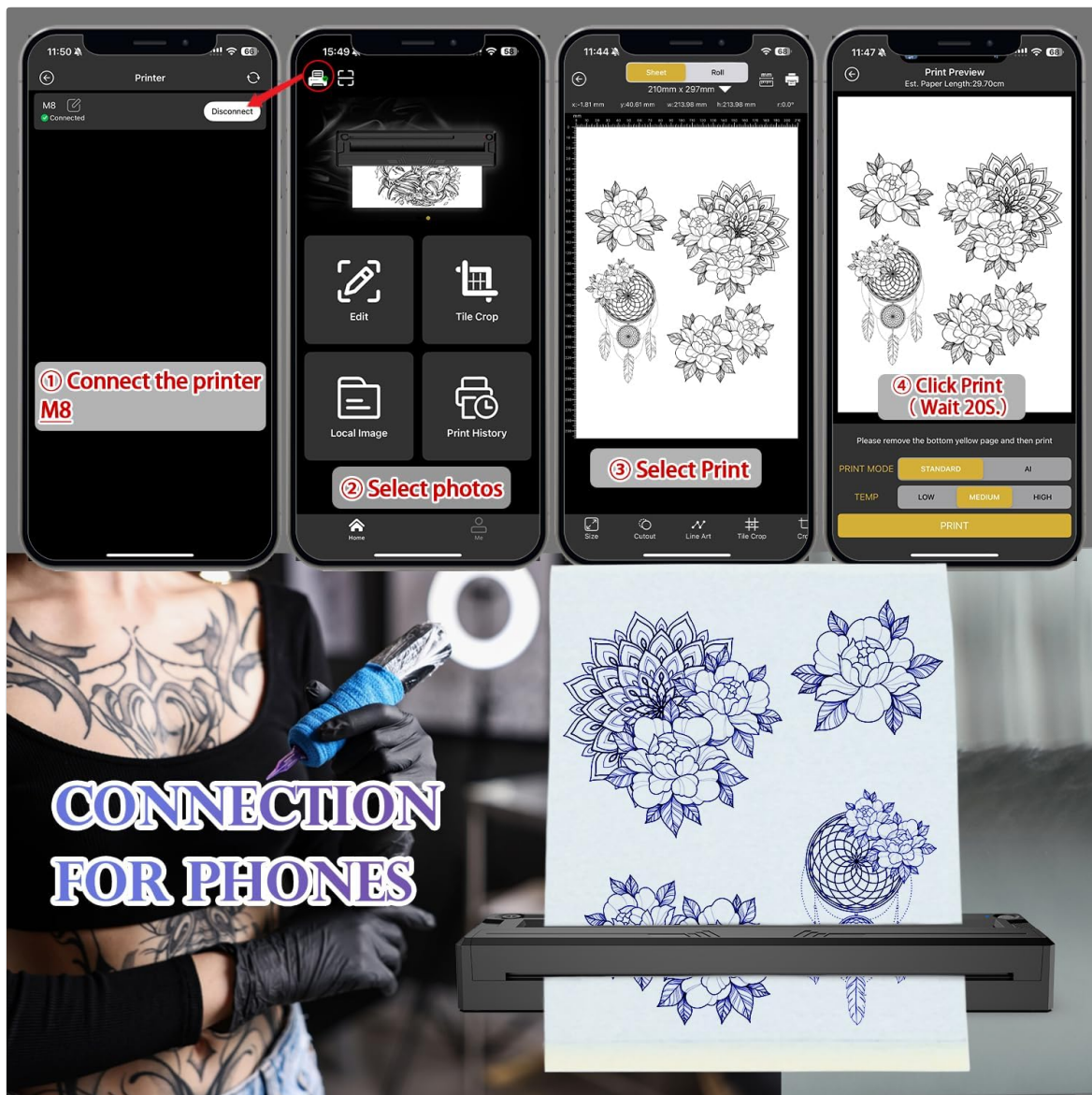

Image: Screenshots of the mobile app demonstrating how to connect the printer and navigate through options like editing, local images, and print history.

Bluetooth Connection (Mobile Devices):

1. Turn on the printer by pressing the power button.
2. Enable Bluetooth on your smartphone or tablet.
3. Open the Sacnahe app.
4. Within the app, navigate to the 'Printer' or 'Connect Device' section.
5. Select 'M8' from the list of available devices to pair.

USB Connection (PC):

1. Ensure the necessary drivers are installed on your PC.
2. Connect the printer to your PC using the USB-C cable.
3. The printer should be recognized by your computer's operating system.

6. OPERATING INSTRUCTIONS

6.1 Loading Stencil Paper

Correct paper loading is crucial for optimal print quality.



Image: A visual sequence demonstrating how to turn on the printer, open the cover, prepare the stencil paper by tearing off protective layers, and insert it white side up.

1. Turn on the printer.
2. Press the 'Open Cover' button to open the printer's top cover.
3. Prepare your thermal stencil paper by tearing off the transparent and yellow protective sheets, leaving the white transfer sheet.
4. Insert the white transfer sheet into the paper input slot with the white side facing up. Ensure it is aligned straight.
5. Use the paper limiter button to help guide the paper to the far right to prevent printing errors.
6. Close the top cover. The printer will automatically feed the paper slightly.

6.2 Printing Process

Once connected and paper is loaded, you can proceed with printing your stencil.



Image: Screenshots of the app showing how to select an image, preview the print, and adjust print mode (Standard, Low, Medium, High) and temperature before printing.

1. Open the Sacnahe app on your connected device.
2. Select the image or design you wish to print from your device's gallery or the app's templates.
3. Utilize the app's editing features to adjust the image as needed (e.g., rotate, crop, invert).
4. Proceed to the print preview screen.

5. Adjust print settings such as 'Print Mode' (Standard, Low, Medium, High) and 'Temp' (temperature) for desired stencil darkness.
6. Tap the 'Print' button. The printer will begin transferring the design to the stencil paper.
7. Wait for the printing process to complete before removing the stencil paper.

6.3 Adjusting Print Settings and Paper Size

The app allows for flexible control over print output and paper dimensions.



Image: A detailed view of the app's interface showing options to select preset paper sizes (e.g., 210mm x 297mm for A4) or enter custom print dimensions, along with image editing and print style/temperature settings.

- **Custom Paper Size:** In the app, you can select from preset paper sizes (e.g., A4) or manually enter custom dimensions (width and length in mm) to match your stencil paper.
- **Image Scaling:** Adjust the image size within the app to fit your selected paper dimensions.
- **Print Style & Temperature:** Experiment with different print styles and temperature settings to achieve the desired stencil clarity and darkness. Higher temperatures generally result in darker prints.

7. MAINTENANCE

7.1 Cleaning the Printer

Regular cleaning helps maintain print quality and extends the life of your printer.

- **Exterior:** Use a soft, dry, lint-free cloth to wipe the exterior of the printer. Do not use abrasive cleaners, solvents, or harsh chemicals.
- **Thermal Print Head:** If print quality degrades (e.g., lines or faded areas appear), the thermal print head may need cleaning. Gently wipe the print head with an alcohol swab. Ensure the printer is turned off and cooled down before cleaning.
- **Paper Path:** Occasionally inspect the paper path for any dust or debris and remove it carefully.

7.2 Battery Care

Proper battery care ensures long-term performance.

- To prolong battery life, avoid fully discharging the battery frequently.
- If storing the printer for an extended period, charge it to approximately 50-70% and store in a

cool, dry place. Recharge every few months to prevent deep discharge.

- Use only the original or certified compatible charging cable.

8. TROUBLESHOOTING

If you encounter issues with your Sacnahe M8 printer, refer to the following common problems and solutions:

Problem	Possible Cause	Solution
Printer does not turn on	Low battery; Power button not pressed correctly	Charge the printer fully. Press and hold the power button for a few seconds.
Cannot connect via Bluetooth	Bluetooth off; Printer not in pairing mode; App permissions	Ensure Bluetooth is enabled on your device. Restart the printer and app. Check app permissions for Bluetooth access.
Poor print quality (faded, lines)	Incorrect paper loading; Dirty print head; Low print temperature	Ensure paper is loaded white side up and straight. Clean the thermal print head with an alcohol swab. Increase print temperature in the app settings.
Paper jam	Paper inserted incorrectly; Wrinkled paper	Turn off the printer. Carefully remove any jammed paper. Ensure paper is flat and inserted straight.
Printer not recognized by PC	Missing drivers; Faulty USB cable/port	Install the latest PC drivers from the official website. Try a different USB cable or port.

If the problem persists after trying these solutions, please contact customer support.

9. SPECIFICATIONS

Feature	Detail
Brand	Sacnahe
Model Number	M8
Operation Mode	Automatic
Item Weight	0.72 Kilograms (1.59 pounds)
Print Media	Thermal Paper
Connectivity	Bluetooth, USB-C
Compatible OS	Android, iOS, Windows
Batteries	1 Lithium Polymer battery (included)
Package Dimensions	12.48 x 4.09 x 2.91 inches

10. WARRANTY AND SUPPORT

For technical support, warranty claims, or further assistance with your Sacnahe M8 Wireless Tattoo Stencil Printer, please contact Sacnahe customer service through your purchase platform or the official Sacnahe website. Please have your purchase details and model number (M8) ready when contacting support.