

GONEO D2E-E16EU-5M

GONEO Portable EV Charger Type 2 Schuko Monophasic 16A 3.68kW 5M User Manual

1. INTRODUCTION

This manual provides essential information for the safe and efficient operation of your GONEO Portable EV Charger. Please read these instructions carefully before using the product and retain them for future reference. This charger is designed for electric vehicles (EVs) and plug-in hybrid electric vehicles (PHEVs) equipped with a Type 2 connector.

2. SAFETY INFORMATION

Your safety is paramount. This charger incorporates multiple safety features to ensure reliable operation. Always adhere to local electrical safety regulations.

- **Intelligent Temperature Control:** The charger's Schuko plug and control box are equipped with NTC temperature sensors. If the temperature exceeds 65°C, the charging current automatically reduces to 6A. If the temperature rises above 70°C, charging stops to prevent overheating.
- **Advanced AC+DC Leakage Protection:** Features double leakage detection (AC 30mA + DC 6mA) to immediately cut power in case of leakage, preventing electrical shocks, fires, and battery damage.
- **Automatic Ground Detection:** Each connection initiates an automatic ground check. A red light indicates a connection fault, ensuring safe charging without technical expertise.
- **Correct Schuko Plug Selection:** Domestic Schuko plugs have different maximum amperages. Ensure you select the correct type (e.g., max 16A for 3.68kW, max 10A for 2.3kW) to match your charger's capabilities and prevent overheating or safety risks.
- **Multiple Integrated Safety Protections:** Includes protection against overvoltage, undervoltage, overcurrent, short circuits, leakage, overheating, static electricity, relay sticking, ignition, ground fault, communication failure (EV Type 2), and Type 2 disconnection.



CARGADOR EV TIPO 2 PORTÁTIL - ENCHUFE SCHUKO

230 V
Voltaje doméstico

MAX. 3.68 kW
Potencia de carga

MAX. 16 A
Corriente ajustable

MAX. 8 HORAS
Carga programada



Image: NTC Temperature Sensors for Safe Charging.

Protección diferencial RCD 30mA AC + 6mA DC

Con doble detección de fugas (AC 30mA + DC 6mA), el sistema corta la energía de inmediato en caso de fuga, evitando eficazmente descargas eléctricas, incendios y daños a la batería.

⚠ Sin esta protección, la carga puede ser peligrosa y representar graves riesgos para los usuarios y los vehículos.



Image: RCD 30mA AC + 6mA DC Differential Protection.

Sensores de temperatura NTC integrados en el enchufe Schuko y el cargador EV

Para garantizar una carga segura, tanto el enchufe Schuko como la Wallbox están equipados con sensores de temperatura NTC integrados.

Cuando la temperatura supera los 65°C, la corriente de carga se reduce automáticamente a 6A.

Si la temperatura sube por encima de 70°C, la carga se detiene automáticamente para prevenir el sobrecalentamiento y garantizar la seguridad del vehículo.

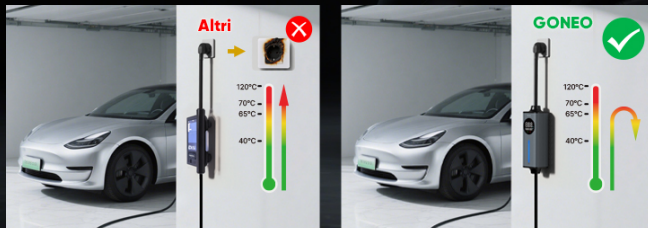

Image: Automatic Ground Detection for Safer Charging.

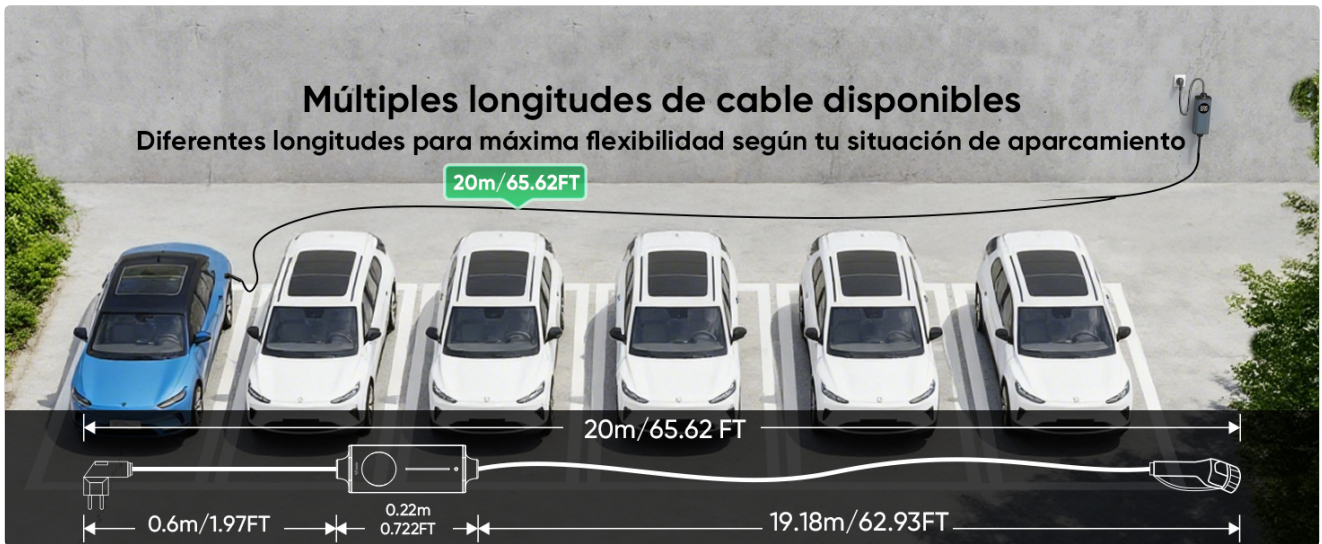

Image: Multi-Protection Features of the Portable EV Charger.

3. WHAT'S IN THE BOX

Upon unpacking, please verify that all items are present and in good condition:

- Portable EV Charger (with integrated cable and connectors)
- User Manual
- Expansion Screws (for wall mounting)
- Carrying Bag

4. PRODUCT OVERVIEW

The GONEO Portable EV Charger is a robust and reliable charging solution. It features a durable TPU reinforced cable, silver-plated connectors, and flame-retardant, UV-resistant materials.

4.1 Components

- **Control Box:** Houses the intelligent control system and LED display.
- **Type 2 Charging Connector:** Connects to your electric vehicle.
- **Schuko Plug:** Connects to a standard domestic power outlet.
- **Cable:** 5-meter TPU reinforced cable.

4.2 LED Display and Controls

The clear LED screen displays real-time current, voltage, temperature, and charging time. The control button allows for adjustments.

Conozca más sobre la pantalla LED del cargador EV portátil



Image: LED Display Information.

- **Main Interface:** Shows charged capacity, voltage, real-time current, casing temperature, Schuko plug temperature, and current adjustment.
- **Sub-interface (Hold button for ~10 seconds):** Displays voltage, Schuko plug temperature, and control box temperature.
- **Light Strip Indicators:**
 - Green (solid): Normal operation, standby.
 - Blue (breathing): Charging in progress.
 - Green (solid): Charging complete.
 - Red (solid): Fault warning.

5. SETUP

Before first use, ensure the charger is properly installed and connected.

5.1 Wall Mounting (Optional)

You can use the included expansion screws to mount the control box on a wall for convenience.

El cargador EV portátil con detección automática de tierra para una carga más segura

El cargador EV portátil GONEO cuenta con detección de tierra integrada. Solo comenzará a cargar cuando el enchufe Schuko esté correctamente puesto a tierra, garantizando el cumplimiento de las últimas regulaciones de seguridad. Esta función proporciona una capa esencial de protección para el usuario y el vehículo eléctrico.

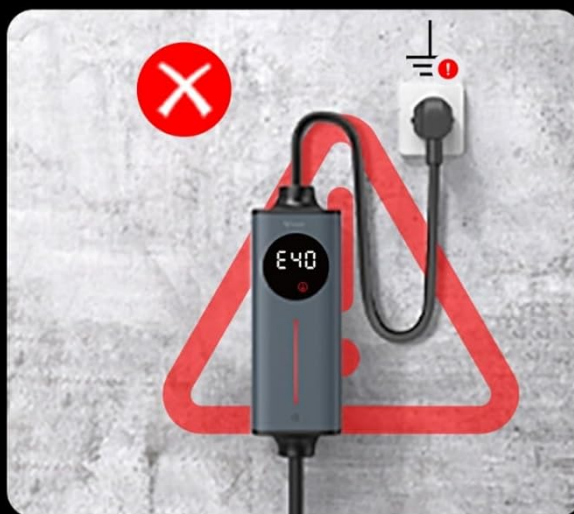
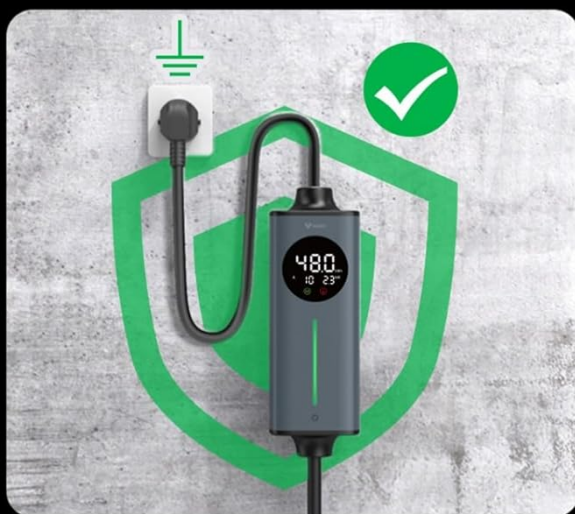

Advertencia: Usar un cargador EV sin detección de tierra puede crear un riesgo de seguridad grave para usted y su VE.

Image: Wall Mounting Points and Screws.

5.2 Power Connection

Connect the Schuko plug to a suitable domestic power outlet. The charger's screen will illuminate and enter the default standby mode. Ensure the outlet provides proper grounding; the charger will not operate without it.

El cargador EV portátil con detección automática de tierra para una carga más segura

El cargador EV portátil GONEO cuenta con detección de tierra integrada. Solo comenzará a cargar cuando el enchufe Schuko esté correctamente puesto a tierra, garantizando el cumplimiento de las últimas regulaciones de seguridad. Esta función proporciona una capa esencial de protección para el usuario y el vehículo eléctrico.



Advertencia:

Usar un cargador EV sin detección de tierra puede crear un riesgo de seguridad grave para usted y su VE.

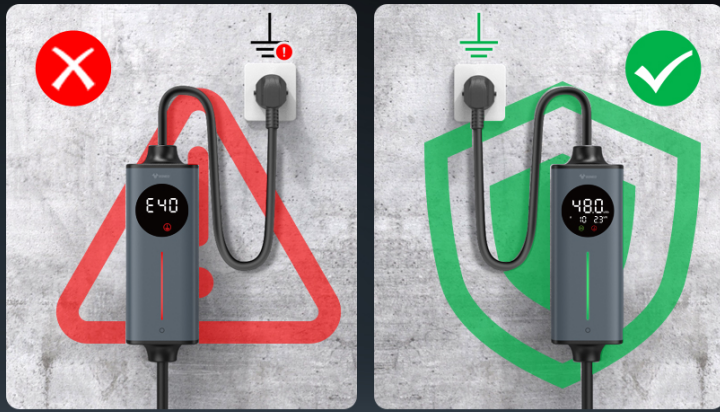

Image: Selecting the Correct Schuko Plug.

6. OPERATING INSTRUCTIONS

Follow these steps to charge your electric vehicle.

6.1 Basic Charging Steps

1. Connect the Schuko plug to a properly grounded domestic outlet.
2. Configure the desired charging current (see section 6.2).
3. Plug the Type 2 charging cable into your EV.

Pasos sencillos para cargar tu vehículo eléctrico



Image: Simple Steps to Charge Your EV.

6.2 Adjusting Current and Delay Time

The charger allows you to select current settings (6A/8A/10A/13A/16A) and program delay timers (1H/2H/4H/8H).

1. **Access New Interface:** Press and hold the start button for 3-7 seconds until the light strip flashes green. Release the button.
2. **Adjust Current:** Briefly press the start button repeatedly to cycle through desired current values. The number in the indicator area will flash.
3. **Adjust Delay Time:** Press and hold the start button for 3-5 seconds until the light strip flashes cyan. Briefly press the start button repeatedly to cycle through desired delay times. The number will flash.

4. **Automatic Save:** Wait for the number to stop flashing (approx. 7 seconds) to confirm settings. You can now connect to your EV.

Cómo configurar la corriente y el tiempo de retardo

PASO 1: Nueva interfaz
Mantenga pulsado 3-7 segundos en la interfaz P2, la tira de luz cambia a verde parpadeante P1 (nueva interfaz), luego suelte.

PASO 2: Ajustar corriente
Pulse de nuevo ligeramente, ajuste la corriente deseada → número parpadeante.

PASO 3: Ajustar tiempo (retardo)
Mantenga pulsado de nuevo 3-5 segundos, la tira parpadea en cian, luego ajuste el tiempo de carga retardada → número

PASO 4: Guardado automático
Espere a que el número deje de parpadear (≈7 s) para confirmar. Ahora puede conectar un EV Tipo 2.

Vídeo y PDF disponibles.

Image: How to Configure Current and Delay Time.

The charger automatically saves your last current configuration for instant startup.

Guardado automático de la última configuración de corriente

Utiliza automáticamente tu última configuración de corriente de carga para un inicio instantáneo

Image: Automatic Saving of Last Current Configuration.

6.3 Scheduled Charging

Utilize the programmable timer to charge your EV during off-peak hours, saving energy costs.



Image: Smart Scheduled Charging for Cost Savings.

7. MAINTENANCE

To ensure the longevity and optimal performance of your charger, follow these maintenance guidelines:

- Regularly inspect the cable and connectors for any signs of damage, wear, or corrosion. Do not use if damaged.
- Keep the control box and connectors clean and free from dust, dirt, and moisture. Use a dry, soft cloth for cleaning.
- Store the charger in a dry, well-ventilated area when not in use, preferably in its carrying bag.
- Avoid exposing the charger to extreme temperatures or direct sunlight for prolonged periods.

8. TROUBLESHOOTING

If you encounter issues with your GONEO Portable EV Charger, refer to the following common problems and solutions:

- **Charger not turning on:** Ensure the Schuko plug is fully inserted into a live, grounded outlet. Check the household circuit breaker.
- **Red light indicator (E40 error):** This indicates a grounding fault. Ensure the power outlet is properly grounded. Do not use the charger if this error persists.
- **Charging stops unexpectedly:** Check for overheating (temperature sensors may have triggered a shutdown). Ensure the vehicle's charging port is clean and the Type 2 connector is securely plugged in. Verify the selected current is appropriate for your electrical installation.
- **Cannot adjust current/timer:** Ensure you are following the correct button press sequence as described in section 6.2.

For persistent issues, please contact GONEO customer support.

9. SPECIFICATIONS

Feature	Specification
---------	---------------

Feature	Specification
Brand	GONEO
Model Number	D2E-E16EU-5M
Charging Type	Type 2 (IEC 62196-2) to Schuko
Maximum Current	16A
Power Output	3.68 kW
Cable Length	5 meters
Input Voltage	230V AC
Leakage Protection	AC 30mA + DC 6mA
Temperature Sensors	Integrated in plug and control box
Durability (Connect/Disconnect)	10,000+ cycles tested
Durability (Cable Bending)	20,000+ cycles tested
Operating Temperature	-30°C to +50°C
Ingress Protection (IP) Rating	IP55
Certifications	CE, TUV, RoHS, Reach, PAHS
Product Weight	2.25 kg
Package Dimensions	41.4 x 30.7 x 14.5 cm

Probado para durabilidad y seguridad a largo plazo

Cada componente está fabricado con materiales de alta calidad y rigurosamente probado para garantizar confiabilidad, seguridad y resistencia al desgaste y al calor.

Caja de control



Carcasa UL94 V-0
prueba hilo incandescente
960°C superada

Puerto de carga Type 2



10,000+
ciclos de conexión/
desconexión probados

Cable de carga TPU



20,000+
ciclos de doblado construidos

Enchufe Schuko



**Sensores de temperatura
NTC integrados**

Image: Durability and Safety Testing.

Adecuado para uso en diversos entornos

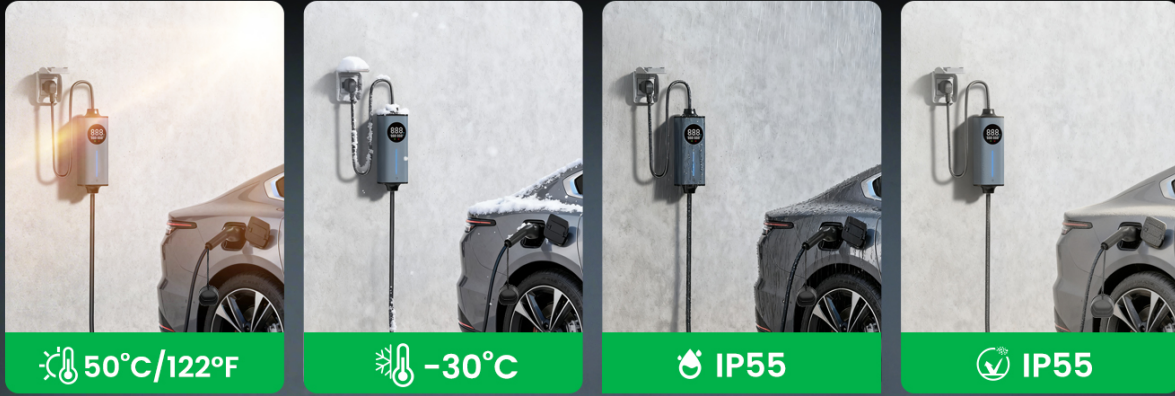

Image: Suitable for Diverse Environments.

Compatible con todos los vehículos eléctricos Tipo 2 [IEC 62196-2]

Funciona con todos los coches eléctricos, híbridos enchufables y otros vehículos eléctricos

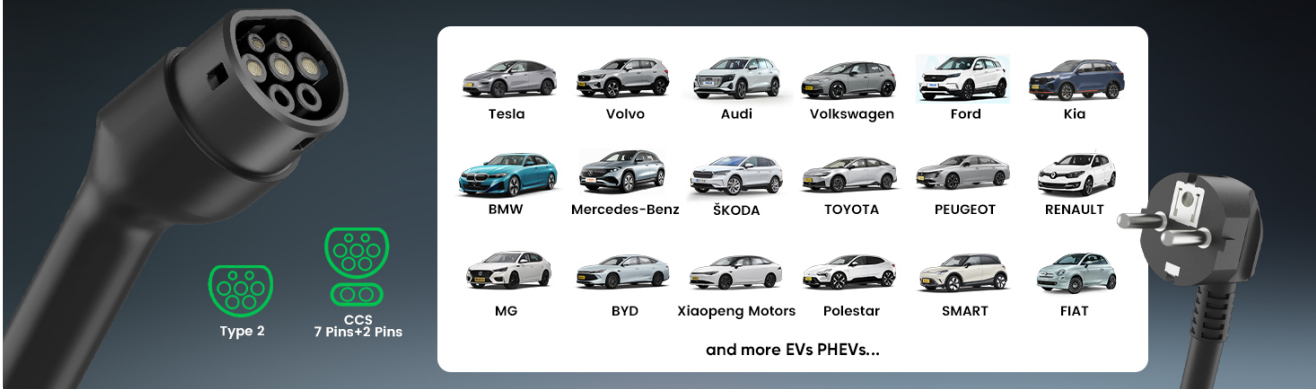

Image: Universal Compatibility with Type 2 EVs.

10. WARRANTY AND SUPPORT

GONEO products are manufactured to high-quality standards. For warranty information or technical support, please refer to the contact details provided with your purchase or visit the official GONEO website. Keep your purchase receipt as proof of purchase.