

Jonsbo D200

JONSBO D200 Micro ATX PC Case Instruction Manual

Model: D200

1. INTRODUCTION

This manual provides comprehensive instructions for the installation, operation, and maintenance of your JONSBO D200 Micro ATX PC Case. Please read this manual thoroughly before beginning assembly to ensure correct setup and optimal performance. Keep this manual for future reference.

2. PRODUCT OVERVIEW

The JONSBO D200 is a Micro ATX PC case designed for enthusiasts seeking a blend of aesthetics and functionality. It features a unique curved one-piece tempered glass panel for an ultra-wide view of internal components and includes a digital screen for real-time temperature monitoring.



Image 2.1: JONSBO D200 Micro ATX PC Case overview.

Key Features:

- **Curved One-piece Glass:** Offers a 270° ultra-wide view of your PC hardware without obstructive pillars.

- **Digital Display Temperature Indication:** Monitors and displays CPU temperature in real-time, aiding in heat dissipation performance assessment.
- **Convenient Disassembly Design:** Facilitates easier PC building and maintenance with quick-release panels.
- **Optimized Component Support:** Accommodates Micro-ATX/ITX motherboards, GPUs up to 410mm, and CPU coolers up to 171mm.
- **Flexible Cooling System:** Supports up to 7 fan positions and 240mm AIO liquid coolers for efficient thermal management.
- **Dedicated PSU Compartment:** Features a brushed metal texture surface and supports PSUs up to 170mm (with bottom HDD) or 235mm (without bottom HDD).

Product Overview

The JONSBO D200 case continues to use the popular curved one-piece bent tempered glass design, providing users with an ultra-wide hardware display visual effect. On this basis, it adds a digital screen as an embellishment, highlighting the unique design taste under the minimalist appearance of the case, allowing users to easily and in real-time monitor temperature changes inside the case. The large mesh panel combined with multiple fan positions effectively enhances the product's heat dissipation capacity. Within the limited exterior dimensions, the case accommodates diverse choices for both air cooling and water cooling users, easily accommodating long graphics card solutions. The overall appearance frame of the product adopts a beveled edge, with elegant and complete visual lines, supplemented by a brushed texture design on the power supply compartment panel in an esports style, combined with subsequent ARGB lighting equipment, the case can provide a comprehensive visual effect that combines movement and stillness.



Image 2.2: The 270° ultra-wide view provided by the curved tempered glass panel.

Curved One-piece Glass 270° Ultra-wide View

The curved tempered glass design without pillars provides a better and wider hardware display angle

* The glass surface has no fixed screws, it uses a snap-on mechanism for installation and removal



Image 2.3: Detail of the digital temperature display and the brushed metal texture of the power supply compartment.

3. PACKAGE CONTENTS

Please verify that all components are present in the package before proceeding with installation:

- JONSBO D200 Micro ATX PC Case
- Accessory Box (screws, standoffs, cable ties)
- Adjustable GPU Bracket
- User Manual (this document)

Panels Quick Release

Convenient Disassembly Design Easy to maintain and manage the interior of the case at any time

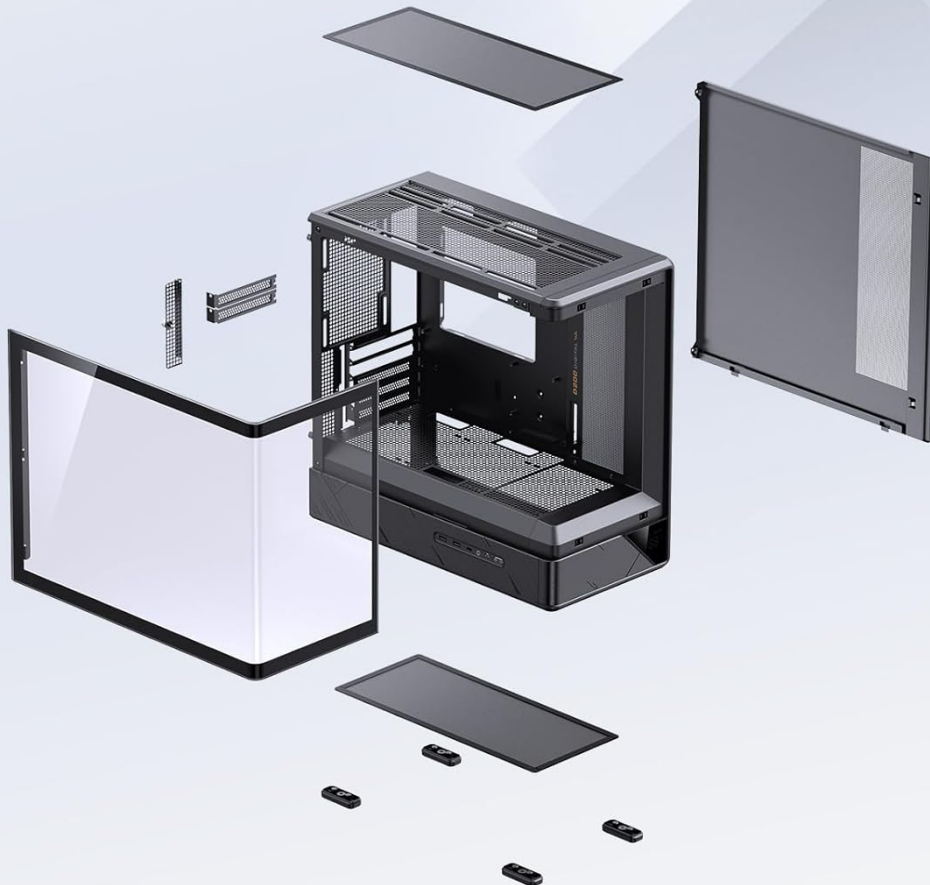

Image 3.1: Exploded view demonstrating the convenient disassembly of panels for easy access.

4. SETUP AND INSTALLATION

Follow these steps carefully to install your PC components into the JONSBO D200 case.

4.1. Preparing the Case

1. Place the case on a stable, flat surface.
2. Gently remove the side panels and top panel by disengaging their snap mechanisms. The curved glass panel is pressure-mounted for easy removal.
3. Identify the motherboard tray, PSU compartment, and drive bays.

4.2. Motherboard Installation

The JONSBO D200 supports Micro-ATX and Mini-ITX motherboards.

1. Install the CPU, CPU cooler (if air cooler, ensure it fits within 171mm height), and RAM onto your motherboard

before placing it in the case.

2. Align the motherboard with the standoffs in the case.
3. Secure the motherboard using the provided screws.

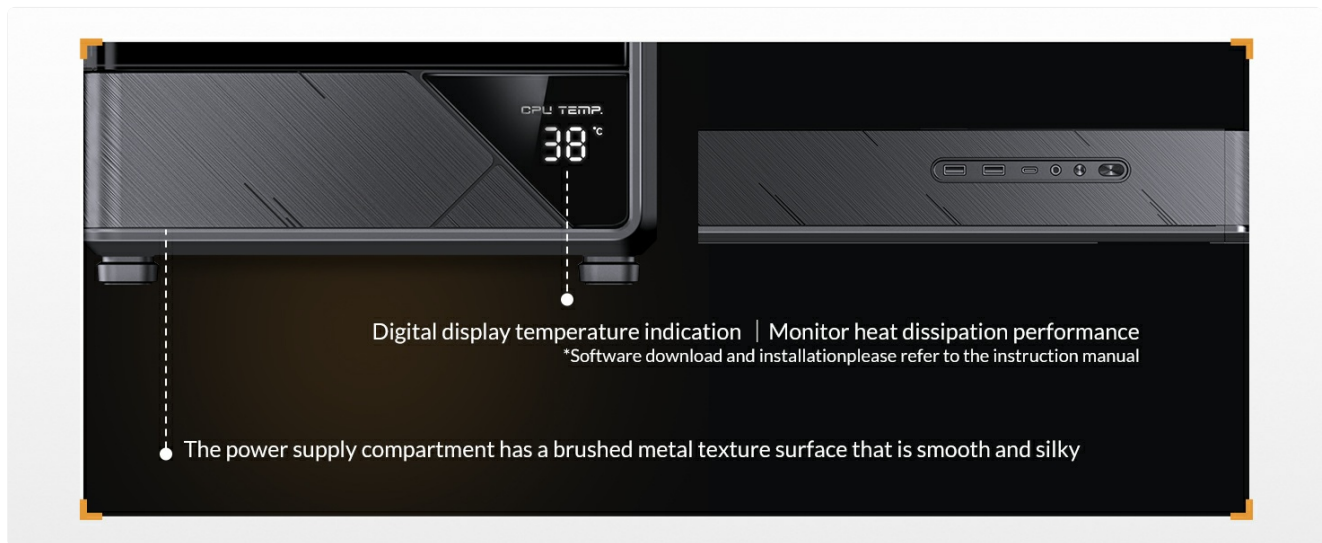

Image 4.1: Internal layout showing compatibility with M-ATX motherboards and partitioned cable management space.

4.3. Graphics Card (GPU) Installation

The case supports GPUs up to 410mm in length.

1. Insert your GPU into the appropriate PCIe slot on the motherboard.
2. Secure the GPU with screws to the rear expansion slots.
3. Utilize the included adjustable GPU bracket to prevent sag and provide additional support for heavier graphics cards.

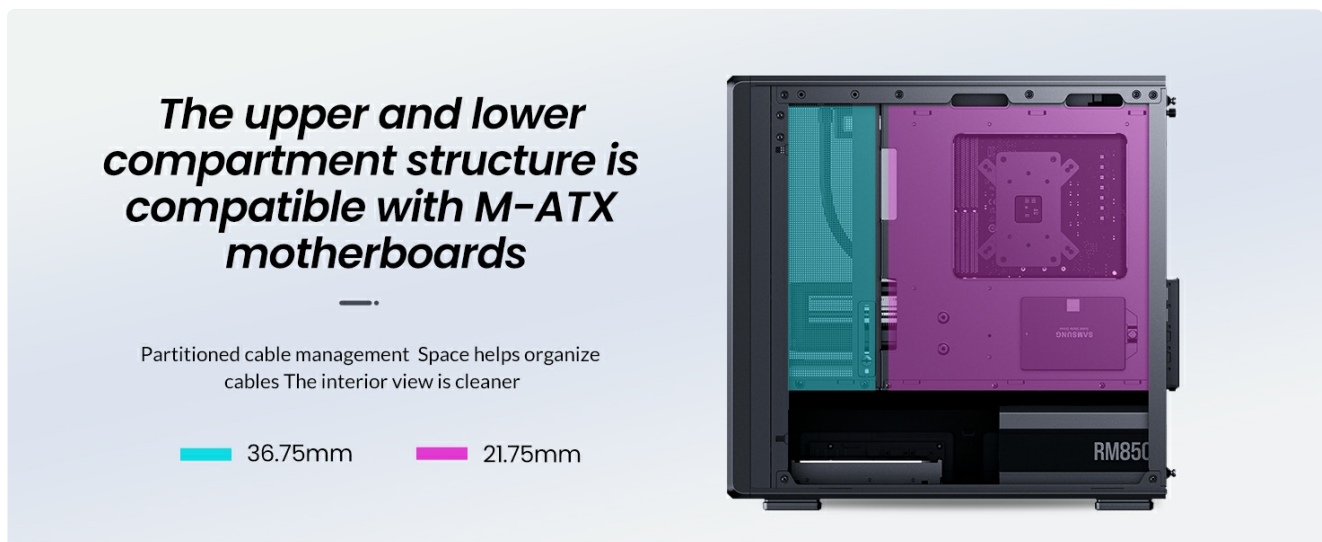

Image 4.2: Diagram illustrating the maximum GPU length of 410mm.

4.4. Power Supply Unit (PSU) Installation

The PSU compartment is located at the bottom of the case.

1. Slide the ATX power supply into its designated compartment.
2. Secure the PSU with screws from the rear of the case.
3. Ensure PSU length does not exceed 170mm if a 3.5" HDD is installed at the bottom, or 235mm if no HDD is

present in that location.

7 Fan Positions Effectively assist in heat dissipation

Top: 120mm*3 / 140mm*2 (OPTIONAL)
240mm*1 AIO (OPTIONAL)

Rear: 120mm*1(OPTIONAL)

PSU Compartment: 120mm*3(OPTIONAL)

*Install selectively based on the thickness of the graphics card



Image 4.3: View of the bottom-mounted power supply compartment.

4.5. Drive Installation

The case supports the following drive configurations:

- Back of motherboard tray: 1x 2.5" SSD
- PSU Compartment: 1x 3.5" HDD or 1x 2.5" SSD

1. Mount your 2.5" SSD(s) or 3.5" HDD(s) into the designated brackets.
2. Secure the brackets to the case using the provided screws.



Image 4.4: Locations for 2.5" SSD and 3.5" HDD installation.

4.6. Cooling System Installation

The D200 offers versatile cooling options:

- **Top:** 3x 120mm fans or 2x 140mm fans (optional), or 1x 240mm AIO liquid cooler (optional).
- **Bottom:** 3x 120mm fans (optional).
- **Rear:** 1x 120mm fan (optional).

1. Mount fans or AIO radiators to the specified locations using appropriate screws.
2. Connect fan and AIO pump cables to your motherboard headers.

Optimizing 50 series graphics cards

5 PCI slots Ample space for graphics card installation

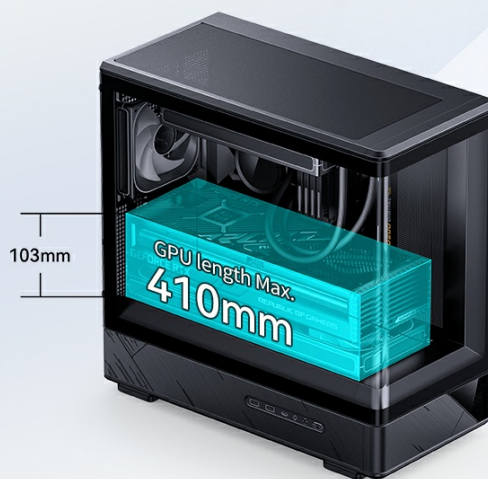
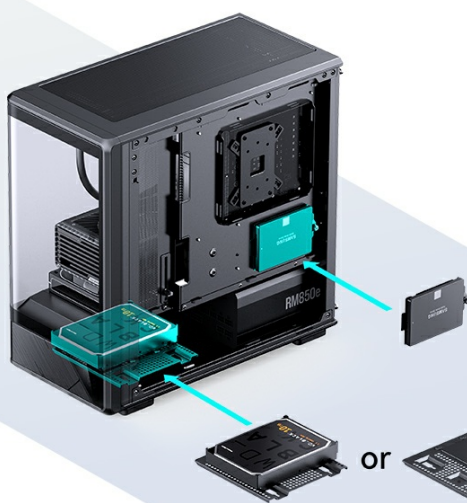

Image 4.5: Diagram showing the 7 fan positions and potential airflow paths for effective heat dissipation.



Hard drive support

Back: 2.5"SSD*1

PSU Compartment: 3.5"HDD*1 or 2.5"SSD*1

Image 4.6: Recommendations for water cooling (240mm AIO) and air cooling (171mm single/dual tower air cooler).

4.7. Cable Management

Utilize the partitioned cable management space behind the motherboard tray to route and secure cables. This improves airflow and maintains a clean interior aesthetic.

4.8. Digital Screen Setup

The digital screen requires specific software for full functionality and temperature display. Please refer to the manufacturer's website for software download and installation instructions.

5. OPERATING INSTRUCTIONS

Once all components are installed and the case is closed, connect your peripherals and power cable. The digital screen on the front panel will automatically display the CPU temperature after the necessary software is installed and configured.

Your browser does not support the video tag.

Video 5.1: An official JONSBO video showcasing the D200 case features, including the integrated folding curved glass, real-time temperature display, and component compatibility for AIO and GPU installations. This video demonstrates the aesthetic and functional aspects of the case.

6. MAINTENANCE

Regular maintenance helps ensure the longevity and optimal performance of your PC case.

- **Dust Filters:** Periodically clean the dust filters to maintain good airflow and prevent dust buildup inside the case.
- **Exterior Cleaning:** Use a soft, damp cloth to clean the exterior surfaces, including the glass panel. Avoid abrasive cleaners.
- **Internal Cleaning:** With the system powered off and unplugged, use compressed air to remove dust from internal components and fan blades.

7. TROUBLESHOOTING

If you encounter issues during or after assembly, consider the following common troubleshooting steps:

- **No Power:** Ensure all power cables (24-pin ATX, 8-pin CPU, PCIe, SATA) are securely connected. Verify the PSU switch is in the 'ON' position.
- **No Display:** Check that the GPU is correctly seated in its PCIe slot and that the display cable is securely connected to both the GPU and monitor.
- **High Temperatures:** Confirm all fans are spinning and correctly oriented for airflow. Ensure CPU cooler is properly mounted and making good contact with the CPU. Check thermal paste application.
- **Digital Screen Not Working:** Verify the internal USB header connection for the digital screen. Ensure the required software is installed and running.
- **Loose Components:** Double-check all screws and connections for components like the motherboard, GPU, and drives.

8. SPECIFICATIONS

Detailed technical specifications for the JONSBO D200 PC Case:

Feature	Specification
Brand	Jonsbo
Model Name	D200
Item Weight	16.72 pounds
Product Dimensions (LxWxH)	17.2 x 8.5 x 16.5 inches (437mm x 216mm x 419mm)
Color	Black
Material	Metal, Tempered Glass, ABS
Motherboard Compatibility	Micro ATX, Mini ITX
Case Type	Mid Tower

Feature	Specification
Max GPU Length	410mm / 16.14 inches
Max CPU Cooler Height	171mm / 6.73 inches
PSU Support	ATX, ≤170mm (with bottom HDD) / ≤235mm (without bottom HDD)
Drive Bays	Back: 1x 2.5" SSD; PSU Compartment: 1x 3.5" HDD or 1x 2.5" SSD
Cooling System (Optional)	Top: 3x 120mm / 2x 140mm fans or 1x 240mm AIO; Bottom: 3x 120mm fans; Rear: 1x 120mm fan
Front I/O	USB3.2 Gen2 Type-C*1 / USB3.0*2 / AUDIO+MIC*1 (2IN1)



Image 8.1: Detailed dimensions and specifications of the JONSBO D200 case.

9. WARRANTY AND SUPPORT

JONSBO products are manufactured to high-quality standards. For warranty information, technical support, or service inquiries, please refer to the official JONSBO website or contact your local retailer. Keep your proof of purchase for warranty claims.