

DANFI AUDIO DF CD-001

DANFI AUDIO DF CD-001 Portable CD Player User Manual

Your guide to operating and maintaining your DANFI AUDIO DF CD-001 Portable CD Player.

1. INTRODUCTION

Thank you for purchasing the DANFI AUDIO DF CD-001 Portable CD Player. This device combines multiple audio functions in a compact, vintage-inspired design. It features CD playback, Bluetooth 5.0 input/output, USB music playback, and 3.5mm AUX audio input/output. Please read this manual carefully to ensure proper use and optimal performance.

2. SAFETY INFORMATION

- Do not expose the device to rain, moisture, or extreme temperatures.
- Avoid disassembling the unit. Refer all servicing to qualified personnel.
- Keep the device away from strong magnetic fields.
- Use only the provided USB Type-C charging cable.
- Ensure proper ventilation; do not block any ventilation openings.
- The laser component inside the CD player is capable of emitting harmful radiation. Do not look directly into the laser lens.

3. PACKAGE CONTENTS

- 1x Vintage CD Player
- 1x Type-C Charging Cable
- 1x User Manual

4. PRODUCT OVERVIEW

Familiarize yourself with the various parts and controls of your CD player.

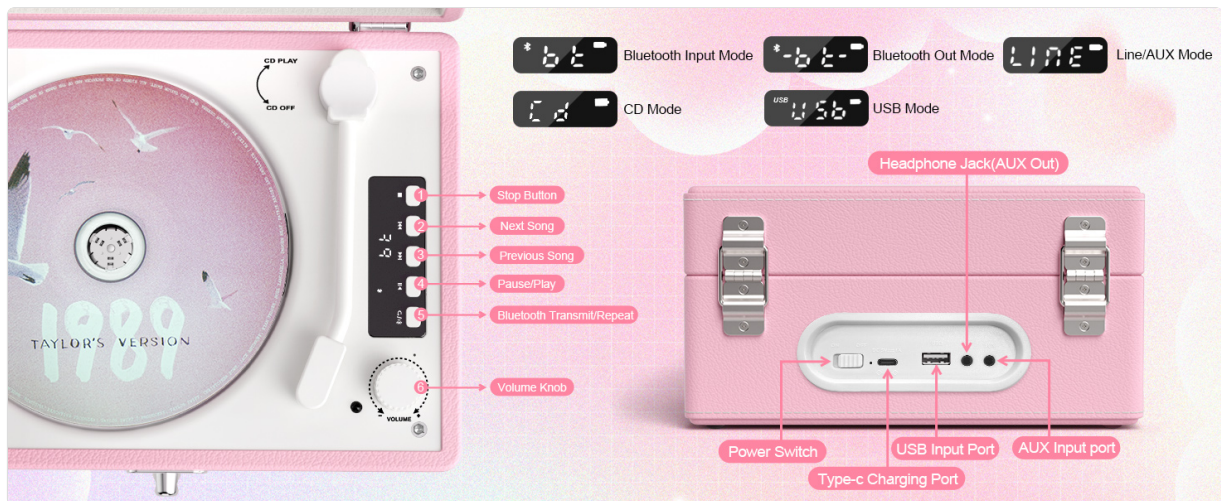

Figure 1: Front and Rear View of the CD Player with labeled controls and ports. The front shows the CD tray, playback buttons (Stop, Next, Previous, Play/Pause, Bluetooth Transmit/Repeat), and Volume knob. The rear panel includes the Power Switch, USB Input Port, Type-C Charging Port, and AUX Input Port/Headphone Jack.

5. SETUP

5.1 Charging the Device

The CD player has a built-in 2000mAh rechargeable battery, providing 5-7 hours of playtime when fully charged.

1. Connect the provided USB Type-C cable to the charging port on the rear of the device.
2. Connect the other end of the USB cable to a compatible USB power source (e.g., power bank, car charger, computer laptop, or wall adapter).
3. The LED display will indicate charging status. A full charge typically takes a few hours.

MULTIPL-FUNCTION CD PLAYER

8-IN-1



CD



Bluetooth in & out



LED Display



HI-FI Sound



AUX Input/Output



Remote Control



Type-C Port



USB Input

Figure 2: Charging the portable CD player using the USB Type-C port.

5.2 Powering On/Off

1. Locate the Power Switch on the rear panel of the device.
2. Slide the switch to the 'ON' position to power on the CD player. The LED display will light up.
3. To power off, slide the switch to the 'OFF' position.

Warm Tip: The device features an auto power-off function after 15 minutes of inactivity to conserve battery. To restart, turn the unit OFF for 5 seconds, then ON again.

6. OPERATING INSTRUCTIONS

6.1 CD Playback

The CD player supports CD, CD-R, CD-RW, MP3, and WMA formats.

1. Open the top lid of the CD player.
2. Carefully place a CD onto the spindle in the CD tray.
3. Close the top lid. The device will automatically detect the CD and begin playback or display track information.
4. Use the playback control buttons (Play/Pause, Next Song, Previous Song, Stop) on the front panel to manage your music.
5. Adjust the volume using the 'VOLUME' knob.

Built-in 2000mah Rechargeable Battery

Covenient to use indor or outdoor



Power Bank



Car Charger



Computer Laptop



Warm Tips:

Enter shutdown standby mode in 15 mins of inactivity, reboot by turning OFF for 5 seconds.

 2000MAH

Figure 3: Inserting a CD into the player. Ensure the CD is properly seated on the spindle.

6.2 Bluetooth Input (Speaker Mode)

Use the CD player as a Bluetooth speaker for your smartphone, tablet, or PC.

1. Power on the CD player.
2. Press the 'Bluetooth Transmit/Repeat' button until the LED display shows 'BT IN' (Bluetooth Input mode).
3. On your external device (e.g., smartphone), enable Bluetooth and search for available devices.
4. Select 'ACD-001' from the list to pair. Once paired, you can stream audio from your device to the CD player's speakers.

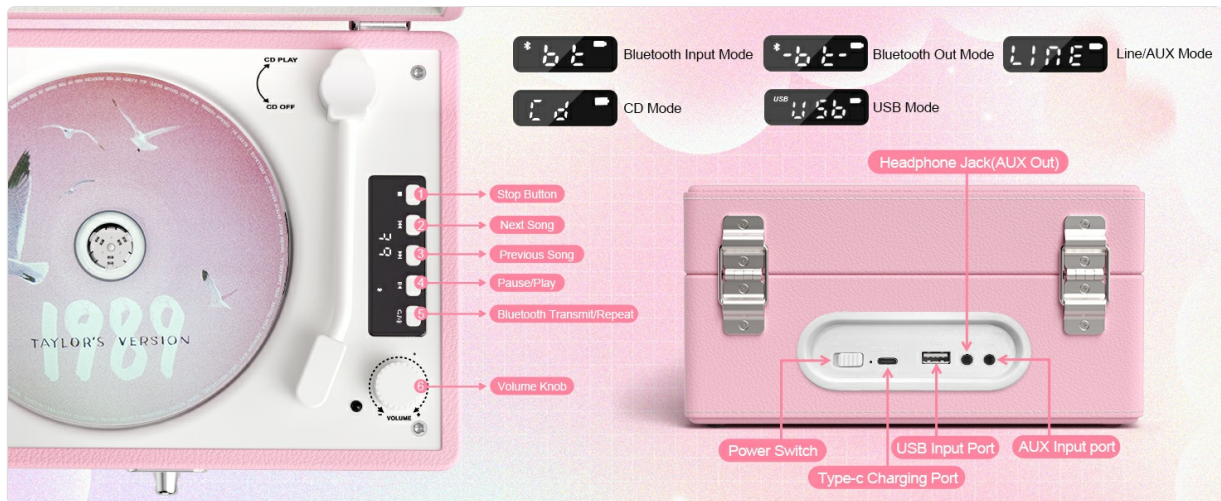

Figure 4: Connecting your smartphone to the CD player via Bluetooth to use it as a speaker.

6.3 Bluetooth Output (Transmitter Mode)

Stream your CD music wirelessly to Bluetooth headphones or external Bluetooth speakers.

1. Power on the CD player and ensure a CD is playing.
2. Press and hold the 'Bluetooth Transmit/Repeat' button until the LED display shows 'BT OUT' (Bluetooth Output mode). The device will start searching for nearby Bluetooth receiving devices.
3. Put your Bluetooth headphones or speaker into pairing mode.
4. The CD player will automatically connect to the nearest available device. Once connected, audio from the CD will play through your external Bluetooth device.



Figure 5: Transmitting CD audio to Bluetooth headphones or an external Bluetooth speaker.

6.4 USB Music Playback

Play music directly from a USB flash drive.

1. Insert a USB flash drive into the USB Input Port on the rear of the device.
2. Press the 'Bluetooth Transmit/Repeat' button until the LED display shows 'USB' (USB mode).
3. The device will automatically begin playing music files from the USB drive.
4. Use the playback control buttons to manage your music.



Figure 6: Playing music directly from a USB flash drive.

6.5 AUX Input/Output

Connect external audio devices using the 3.5mm AUX jack.

1. **AUX Input:** Connect an external audio source (e.g., MP3 player, smartphone without Bluetooth) to the AUX Input Port on the rear using a 3.5mm audio cable. Press the 'Bluetooth Transmit/Repeat' button until the LED display shows 'LINE' (AUX mode).
2. **AUX Output (Headphone Jack):** Connect headphones to the AUX Input Port to enjoy private listening. The internal speakers will mute automatically.
3. **AUX Output (External Speakers):** Connect the AUX Input Port to external wired speakers using a 3.5mm audio cable for a larger sound experience.

CD PLAYER MODE

Support wide format:



CD



CD-R



CD-RW



MP3



WMA



Figure 7: Using the 3.5mm AUX port for private listening with headphones or connecting to external speakers.

6.6 Remote Control

The included remote control allows for convenient operation from a distance. Functions include power on/off, mode selection, volume control, and playback controls (play, pause, skip tracks).

7. MAINTENANCE

- **Cleaning:** Use a soft, dry cloth to clean the exterior of the device. Do not use abrasive cleaners or solvents.
- **CD Care:** Handle CDs by their edges. Keep them free from dust, scratches, and fingerprints. Use a soft, lint-free cloth to clean CDs from the center outwards.

- **Storage:** When not in use, store the CD player in a cool, dry place away from direct sunlight and extreme temperatures. Ensure the unit is powered off.

8. TROUBLESHOOTING

Problem	Possible Cause	Solution
Device does not power on.	Low battery or power switch is off.	Charge the device using the Type-C cable. Ensure the power switch is in the 'ON' position.
CD does not play or skips.	CD is dirty, scratched, or inserted incorrectly.	Clean the CD. Ensure the CD is placed correctly on the spindle. Try another CD.
No sound from speakers.	Volume is too low, device is in AUX output mode, or Bluetooth headphones/speakers are connected.	Increase volume. Disconnect headphones/external speakers. Ensure Bluetooth output is off if not desired.
Cannot connect via Bluetooth.	Device not in correct Bluetooth mode or too far from external device.	Ensure the CD player is in 'BT IN' mode for receiving or 'BT OUT' for transmitting. Keep devices within 10 meters.

9. SPECIFICATIONS

Feature	Detail
Brand	DANFI AUDIO DF
Model Name	CD-001
Color	Light Pink
Connectivity Technology	Bluetooth
Special Features	Auto Power-Off, Battery Level Indicator, Bluetooth in/out, LED Display, Rechargeable Battery
Number Of Discs	1
Supported Audio Format	MP3
Connector Type	3.5mm Jack, RCA
Specific Uses For Product	Home
Number of Channels	2
Media Format Type	Audio CD
Compatible Devices	Headphone, Smartphone, Speaker

Feature	Detail
Headphones Jack	3.5mm Jack
MP3 player	Yes
Number of Batteries	1 Nonstandard Battery (included)
Item Dimensions L x W x H	8.07"L x 6.1"W x 4.13"H
Item Weight	2.2 Pounds

10. WARRANTY AND SUPPORT

For warranty information and customer support, please refer to the documentation included with your product or contact DANFI AUDIO DF customer service directly. Keep your purchase receipt as proof of purchase.

11. OFFICIAL PRODUCT VIDEO

Watch this official product video from DANFI AUDIO LLC for a visual guide on the CD player's features and operation.

Your browser does not support the video tag.

Video 1: A short demonstration of the pink CD player, highlighting its speakers and Bluetooth capabilities. This video provides a quick overview of the product's design and primary functions.