



[Manuals.plus](#) /

> [DOGOITM](#) /

> DOGOITM GPS Wireless Dog Fence System Instruction Manual

DOGOITM B0FP554VHH

DOGOITM GPS Wireless Dog Fence System Instruction Manual

Model: B0FP554VHH

1. INTRODUCTION

Thank you for choosing the DOGOITM GPS Wireless Dog Fence System. This system is designed to provide a safe and reliable containment solution for your pet using advanced GPS technology. Please read this manual thoroughly before operating the device to ensure proper use and to maximize its effectiveness and your pet's safety.

2. PRODUCT OVERVIEW

The DOGOITM GPS Wireless Dog Fence System utilizes a U-BLOX chip for accurate and real-time positioning, creating a customizable wireless boundary for your dog. It features multiple correction modes and is built to withstand outdoor conditions.



Figure 2.1: The DOGOITM GPS Wireless Dog Fence System collar, showing its connection to a satellite for boundary tracking.



Figure 2.2: Illustration of the wireless boundary, depicting the safe zone, wireless fence boundary, and correction zone around a GPS center point.

3. PACKAGE CONTENTS

Please verify that all items listed below are included in your package:

- GPS wireless dog fence training device (1 Pcs)
- Collar (1 Pcs)
- Charging cable (1 Pcs)
- Electric shock test light (1 Pcs)
- Contact points (3 pairs)
- Silicone covers (3 pairs)
- User manual (1 set)

4. KEY FEATURES

- **Accurate GPS Wireless Boundary:** Equipped with a U-BLOX chip for strong anti-interference, ultra-low power consumption, and high sensitivity. Connects to multiple satellites for precise positioning and real-time signal reception, ensuring accurate boundary enforcement.
- **Ultra Long Control Range:** Adjustable radius from 65 feet (minimum) to 3290 feet (maximum), adjustable in 10-foot increments. Ideal for various activity ranges. *Note: Not suitable for small yards (less than 0.3 acres).*

Adjustable Radius Range
from 65-3290ft

3290_{FT}



Figure 4.1: The system allows for a wide range of adjustable boundary sizes, from 65 to 3290 feet.

- **Three Adjustable Correction Modes:** Features Beep (0-1 level), Vibration (0-5 levels), and Shock (0-10 levels) modes. Intensity can be adjusted to suit your dog's temperament. Corrections activate when the dog exits the set boundary.

3 Warning Modes

Choose the proper mode for your dogs



Beep



Shock



Vibration



Figure 4.2: The three adjustable correction modes: Beep, Vibration, and Static Shock, with their respective intensity levels.

- **Rechargeable and Waterproof Pet Containment System:** Equipped with a rechargeable battery providing up to 50 hours of continuous operation. IPX6 waterproof design ensures functionality in humid environments and during water activities.

IPX6 Waterproof

Play freely in water

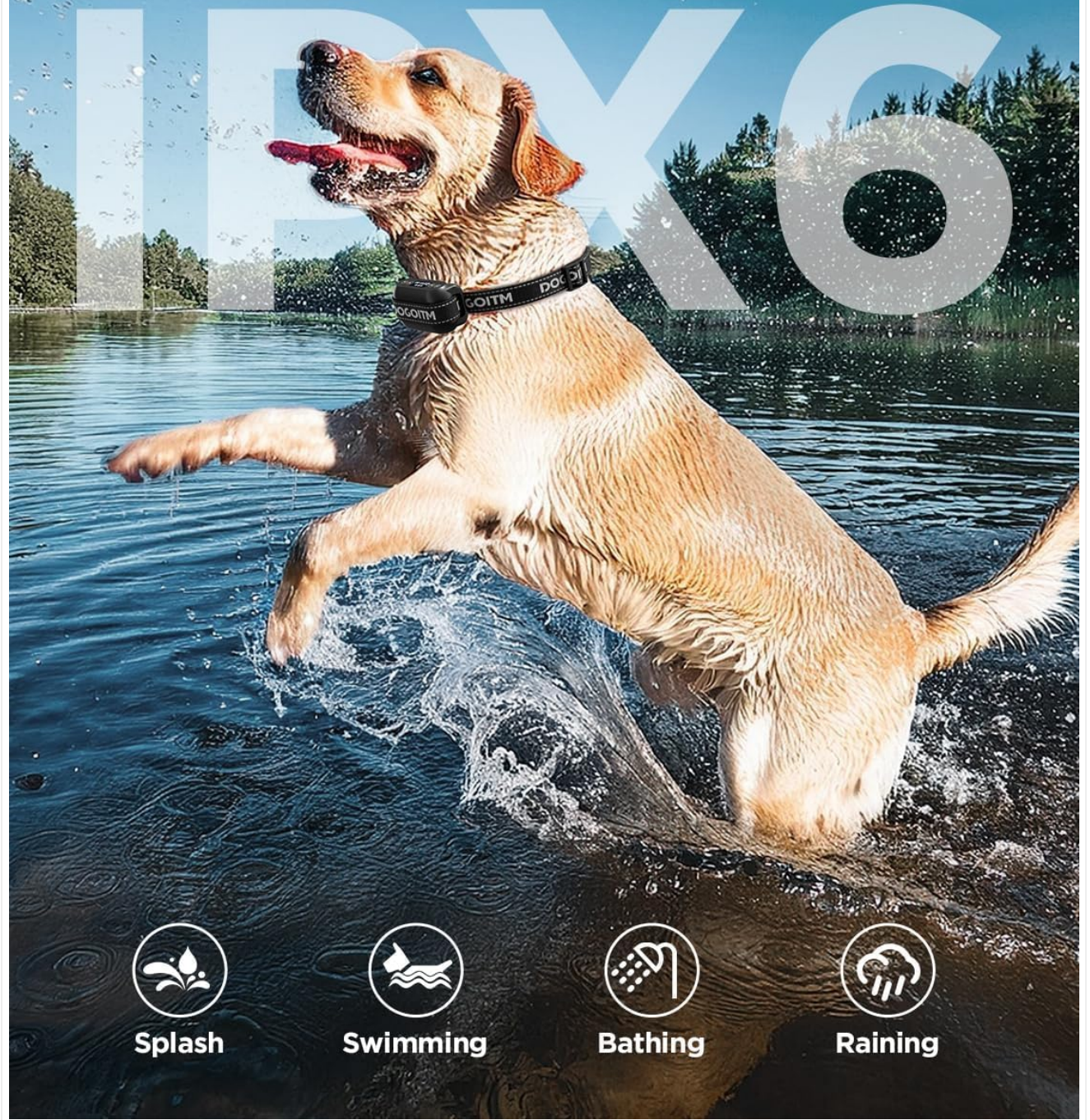

Figure 4.3: The device is IPX6 waterproof, allowing your dog to play freely in various water conditions.

LONG

Battery Life



 **5Hours** Charge

 **50Hours** Use

Figure 4.4: The collar features a long-lasting rechargeable battery, providing up to 50 hours of use on a 5-hour charge.

- **Easy to Set Up:** Utilizes GPS technology, eliminating the need for a separate transmitter, app downloads, subscription fees, or digging. Simplifies installation significantly.

2025 Newest

GPS Wireless Dog Fence



Easy to Use

No App

No Subscription Fee

No Traditional Fence

No Transmitter

No Wire

Figure 4.5: The system is designed for ease of use, requiring no app, subscription, or complex installation.

- **Suitable for Most Dogs:** Device size is 2.75*1.77*1.37 inches, weighing 0.27 lbs. The adjustable collar fits dogs weighing 10-120 lbs with neck sizes of 10-28 inches.

Adjustable Collar for Most of Dogs

20-120LBS



Cut and burned  

Figure 4.6: The adjustable collar accommodates a wide range of dog sizes and breeds.

5. SETUP GUIDE

5.1 Setting Up the Collar

Follow these steps to properly attach the collar to the device and adjust its length:

How to Set Up the Collar

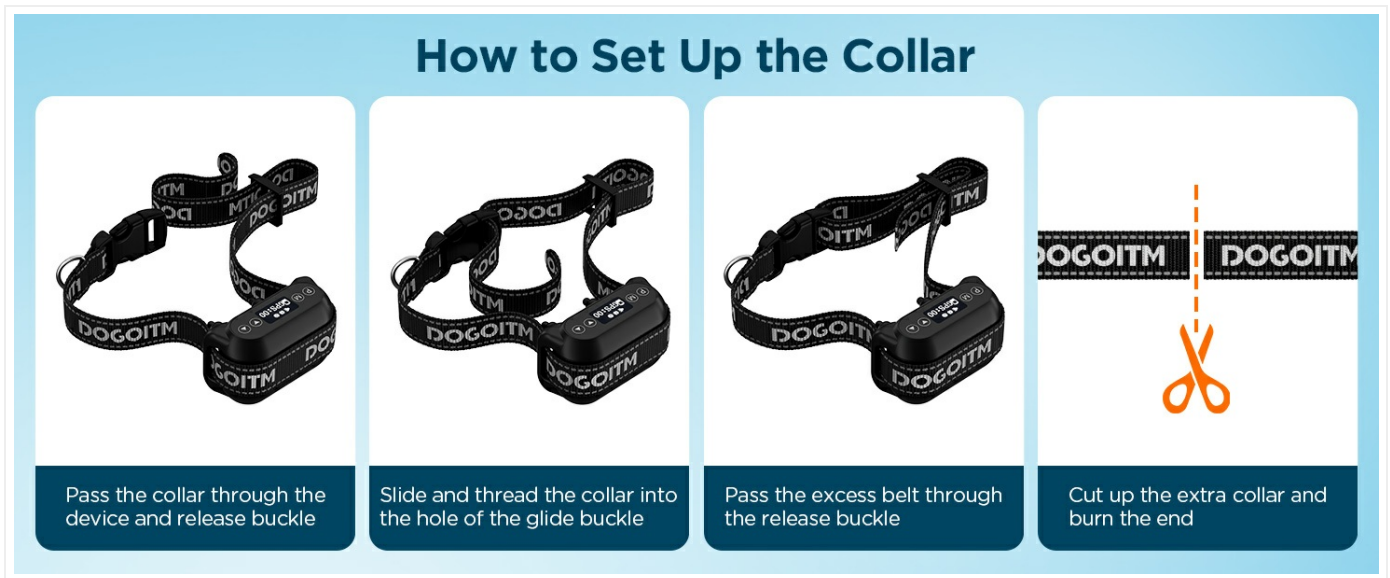

Figure 5.1: Step-by-step instructions for assembling and adjusting the collar.

1. Pass the collar through the device and release buckle.
2. Slide and thread the collar into the hole of the glide buckle.
3. Pass the excess belt through the release buckle.
4. Cut off any excess collar material and carefully burn the end to prevent fraying.

5.2 Setting Up the GPS Device

Prepare the GPS device for operation by installing contact points and setting the boundary:



Figure 5.2: Step-by-step instructions for configuring the GPS device.

1. **Install the Contact Points:** Securely attach the appropriate contact points to the device.
2. **Turn on the Device and Positioning:** Power on the device. It will begin acquiring GPS signals for positioning.
3. **Set Distance:** Press the 'M' key to enter the distance setting mode. Use the up and down keys to adjust the boundary radius to your desired value (65-3290 feet).
4. **Set Warning Mode:** Press the 'M' key again to enter the warning mode setting. Use the up and down keys to adjust the intensity level for Beep, Vibration, and Shock modes.
5. **Use the Tool to Test the Electric Shock:** Before placing on your dog, use the provided test light to verify the shock function.
6. **Wear the Device:** Once configured, place the device on your dog. Your dog can now play freely within the defined

safe boundary.

6. OPERATING INSTRUCTIONS

6.1 Understanding the Boundary System

The system establishes a circular boundary around a central GPS point. As your dog approaches the boundary, the device will activate the selected warning modes:

- **Safe Zone:** Within this area, your dog can roam freely without any corrections.
- **Wireless Fence Boundary:** As your dog approaches this line, the device will initiate the first level of warning (e.g., beep).
- **Correction Zone:** If your dog continues past the boundary, the device will escalate the correction (e.g., vibration, then static shock) to encourage them to return to the safe zone.

6.2 Testing the Electric Shock Function

To ensure the static shock function is working correctly, use the provided test light:

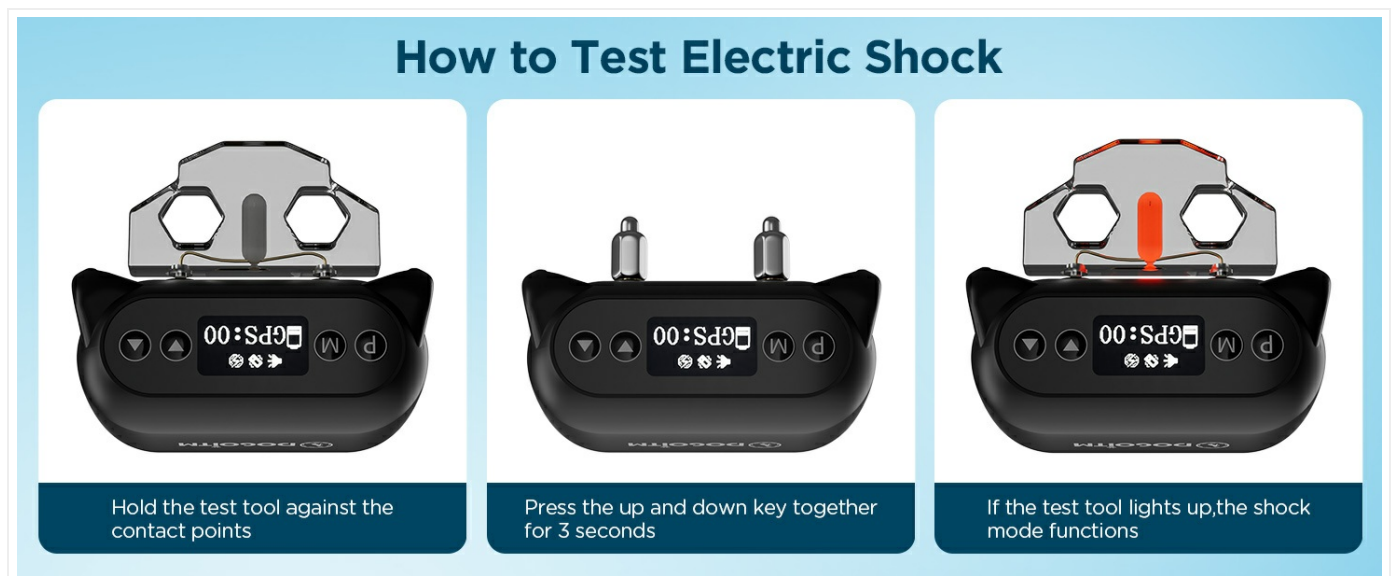

Figure 6.1: Instructions for testing the static shock feature using the provided test light.

1. Hold the test tool against the contact points on the device.
2. Press the up and down keys together for 3 seconds.
3. If the test tool lights up, the shock mode is functioning correctly.

7. MAINTENANCE

- **Cleaning:** Regularly wipe the device and collar with a damp cloth. Ensure contact points are clean and free of debris. Do not use harsh chemicals.
- **Charging:** Recharge the device when the battery indicator is low. Use only the provided charging cable.
- **Storage:** When not in use for extended periods, store the device in a cool, dry place. Ensure it is fully charged before storage and periodically recharge it to maintain battery health.
- **Contact Points:** Periodically check the contact points for wear and tear. Replace if necessary to ensure effective correction.

8. TROUBLESHOOTING

Problem	Possible Cause	Solution
Device not turning on.	Low battery.	Charge the device fully.
Inconsistent boundary or corrections.	Poor GPS signal; dense tree cover; large buildings; device not properly positioned on dog.	Ensure clear line of sight to sky; test in an open area; adjust collar fit.
No static shock output during test.	Test light not properly placed; shock mode not activated; low battery.	Ensure test light touches both contact points; activate shock mode (refer to setup); charge device.
Dog not responding to corrections.	Collar too loose; contact points not making proper skin contact; correction intensity too low.	Tighten collar (two fingers snug); ensure contact points are appropriate length for dog's fur; increase correction intensity.
Device not holding charge.	Battery degradation; faulty charging cable.	Contact customer support for battery replacement or warranty claim; try a different charging cable.

9. SPECIFICATIONS

Feature	Detail
Brand	DOGOITM
Model Number (ASIN)	B0FP554VHH
Item Weight	10.2 ounces (device)
Product Dimensions (LxWxH)	5.4 x 3.9 x 1.9 inches
Battery Type	1 Lithium Ion battery (included)
Battery Life	Up to 50 hours continuous use
Waterproof Rating	IPX6
Control Range Radius	65 - 3290 feet (adjustable in 10 ft increments)
Correction Modes	Beep (0-1), Vibration (0-5), Shock (0-10)
Collar Adjustable Range	10 - 30 inches
Suitable Dog Weight	10 - 120 lbs
Color	Beige

10. WARRANTY AND SUPPORT

DOGOITM provides comprehensive after-sales support for your GPS Wireless Dog Fence System:

- **Warranty:** 2 Year Manufacturer Warranty.
- **Free Replacement:** Within one year of purchase.
- **Free Maintenance:** Within two years of purchase.

- **Customer Support:** Our pet product experts are available to assist you with any questions or issues. Please contact us for support, and we will endeavor to solve your problem within 24 hours.

For warranty claims or technical assistance, please refer to the contact information provided on the product packaging or the official DOGOITM website.