

EMEET Remote Control

EMEET Wireless Remote Control Instruction Manual

For PIXY, Piko+, and Piko 4K Webcams

INTRODUCTION

The EMEET Wireless Remote Control is designed to enhance your experience with EMEET P-Series 4K webcams, including PIXY, Piko+, and Piko. This controller provides convenient access to key webcam functions such as AI tracking, pan, tilt, zoom, image adjustments, and privacy mode, allowing for effortless operation during streaming, meetings, or content creation. For full functionality, ensure you have the EMEETSTUDIO software installed on your computer.

WHAT'S IN THE BOX



- 1** EMEET Remote Control R2
- 2** USB Receiver **3** User Manual

*By default, the **EMEET remote control and its USB wireless receiver are paired for one-to-one use**. Please ensure the safe keeping of the USB receiver.

Image: Contents of the EMEET Remote Control R2 box.

Your EMEET Remote Control package includes:

- EMEET Remote Control R2
- USB Receiver
- User Manual

By default, the EMEET remote control and its USB wireless receiver are pre-paired for one-to-one use. Please ensure the safe keeping of the USB receiver.

PRODUCT OVERVIEW: REMOTE CONTROL FUNCTIONS



Image: EMEET Remote Control button layout and functions.

- **Status Indicator Light:** Displays the remote's status.
- **Restore Default:** Reset the current device and image parameters to default settings.
- **Rotate 90°:** Rotate 90 degrees clockwise.
- **Horizontal Flip:** Enable/Disable image horizontal flip.
- **Reset:** Initialize device gimbal/screen size.
- **Privacy Switch:** Enable/Disable screen preview.
- **Recording Switch:** Enable/Disable video recording.
- **Zoom In:** Adjust screen magnification.
- **Zoom Out:** Adjust screen reduction.
- **Device 1-4:** Switch between connected devices (1-4).
- **Pan-tilt Switch:** Pan-tilt devices switch to the preset position of the EMEET STUDIO; non-pan-tilt devices switch to the next device in the list.
- **Vertical Flip:** Enable/Disable image vertical flip.
- **Up, Down, Left, Right:** Control the gimbal/zoom the image up, down, left, right.
- **Mute Switch:** Enable/Disable microphone mute.
- **Brightness+:** Increase screen brightness.
- **Brightness-:** Decrease screen brightness.
- **Autofocus Switch:** Turn on/off screen autofocus.

SETUP INSTRUCTIONS

Follow these steps to set up your EMEET Remote Control with your EMEET P-Series webcam:

1. **Install Batteries:** Please install 2 AAA batteries into the remote control. Ensure correct polarity (follow the positive and negative marks). Batteries are not included and need to be purchased separately.
2. **Plug in USB Receiver:** Plug the USB receiver into an available USB port on your computer.
3. **Connect Webcam:** Connect your EMEET PIXY, Piko+, or Piko 4K Webcam to your computer.
4. **Launch EMEET Studio:** Open the EMEET Studio software on your computer.
5. **Start Operating:** You can now start operating your device effortlessly via the remote control. Keep the remote within 32.8 ft (10 meters) for best performance.

Before You Use

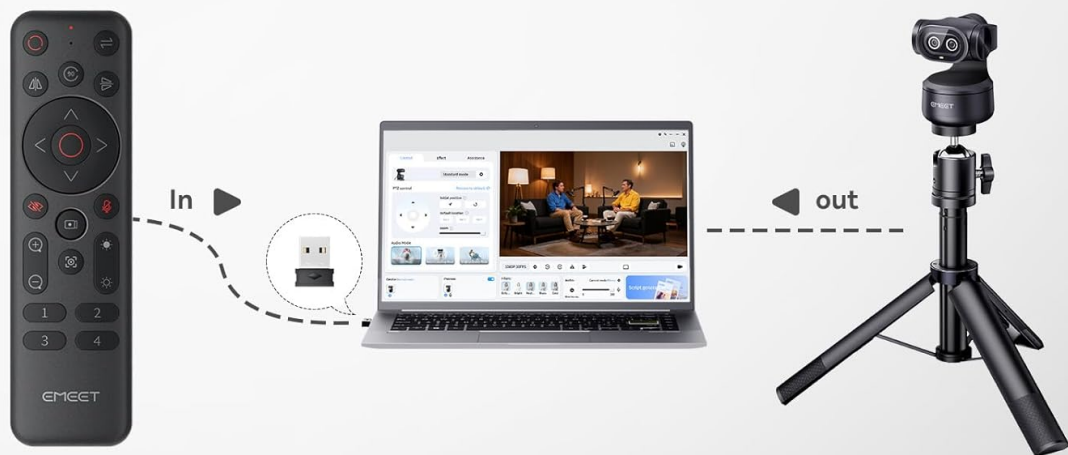

Step 1: Please install 2pcs AAA batteries.

(according to the positive and negative marks.

batteries not included and need to be purchased separately)

Step 2: Plug the USB receiver into your computer.

(*Make sure the remote control is within 32.8 ft (10meters)

Step 3: Connect EMEET PIXY to your computer.

Step 4: Open EMEET Studio software, Now you can start operating the device via the remote control.

Setup for EMEET PIXY

Before You Use



Step 1: Please install 2pcs AAA batteries.

(according to the positive and negative marks.

batteries not included and need to be purchased separately)

Step 2: Plug the USB receiver into your computer.

(*Make sure the remote control is within 32.8 ft (10meters)

Step 3: Connect EMEET PIKO to your computer.

Step 4: Open EMEET Studio software, Now you can start operating the device via the remote control.

Setup for EMEET Piko

Before You Use



Step 1: Please install 2pcs AAA batteries.

(according to the positive and negative marks.

batteries not included and need to be purchased separately)

Step 2: Plug the USB receiver into your computer.

(*Make sure the remote control is within 32.8 ft (10meters)

Step 3: Connect EMEET PIKO+ to your computer.

Step 4: Open EMEET Studio software, Now you can start operating the device via the remote control.

Setup for EMEET Piko+

OPERATING INSTRUCTIONS

Precision PTZ Control (for PIXY)

Instantly adjust pan, tilt, and zoom for your PIXY webcam with one click using the remote. This feature is designed for streamers, educators, and professionals who require fast, stable, and accurate framing adjustments on the fly.

Remote Control for Piko+

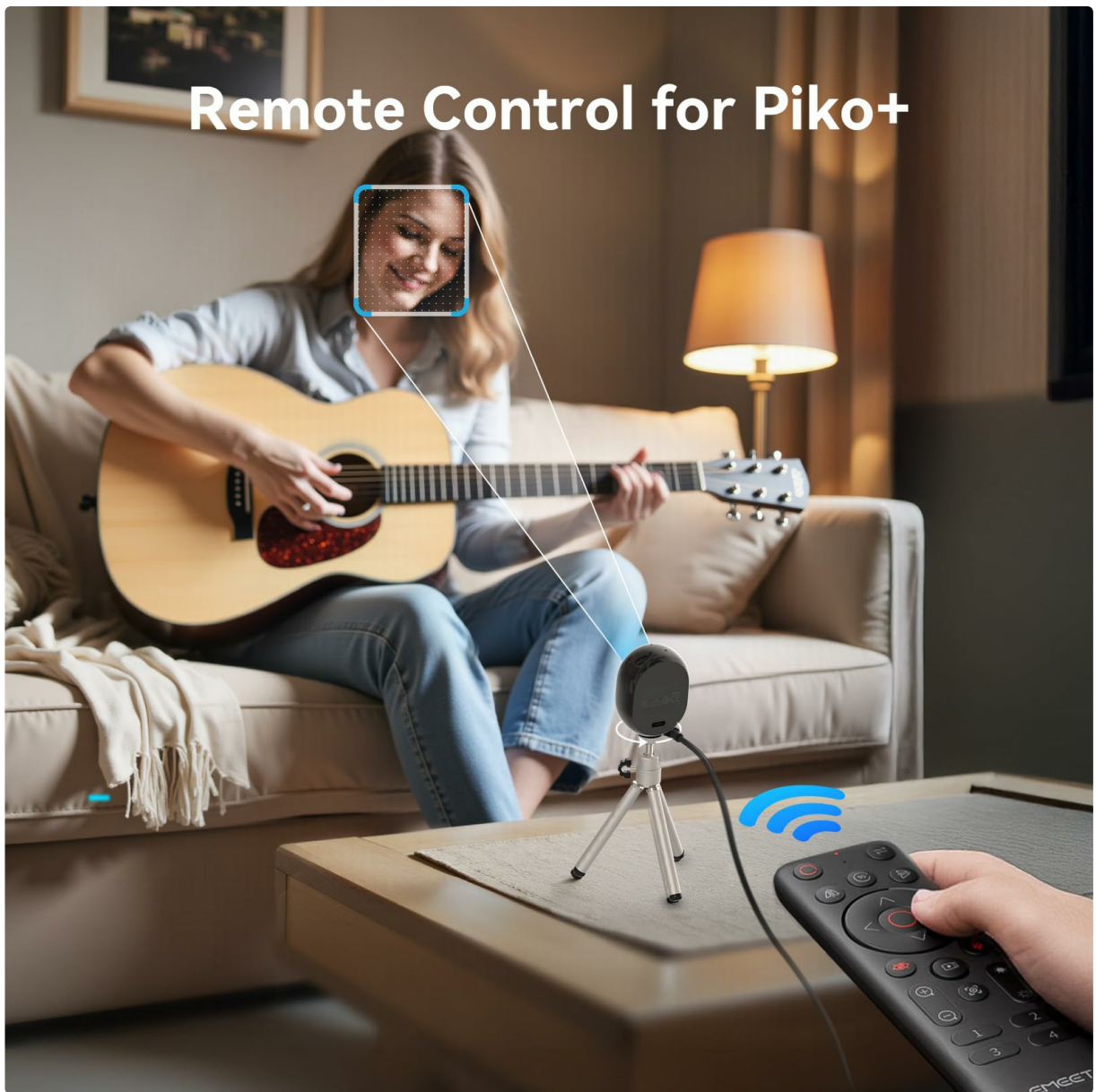

Remote Control for PIXY

Remote Control for PIXY



Remote Control for Piko+

Remote Control for Piko



Remote Control for Piko

AI Tracking & Preset Access (for PIXY)

Activate auto-tracking or switch between preset views during live sessions for PIXY without needing to reach for your mouse. This allows for seamless scene switching, boosting production value.

Basic Image Adjustment

Control brightness, zoom level, mirroring, and flip functions directly via the remote. Fine-tune your visuals in real time without touching software controls.

Privacy Mode

Utilize the one-tap privacy mode to protect your space. Whether you're pausing a call or stepping away, simply tilt to hide the lens via the remote for a secure, silent, and quick privacy solution.

COMPATIBILITY

The EMEET Remote Control is fully compatible with all EMEET 4K dual-camera streaming webcams in the P-Series family, specifically PIXY, Piko, and Piko+. Full function access requires the EMEETSTUDIO software.

SPECIFICATIONS

Feature	Detail
Brand	EMEET
Item Weight	2.88 ounces
Package Dimensions	6.1 x 1.83 x 0.94 inches
Special Features	Lightweight
Connectivity Technology	Radio Frequency
Compatible Devices	EMEET PIXY, Piko+, Piko 4K Webcams

TROUBLESHOOTING

- **Remote Not Responding:** Ensure fresh AAA batteries are correctly installed. Check that the USB receiver is securely plugged into your computer. Verify the remote is within the 32.8 ft (10 meters) operating range of the webcam.
- **Functions Not Working:** Make sure the EMEET Studio software is running and your webcam is properly connected and recognized by the software. Check for any available software or firmware updates for your webcam and remote control within EMEET Studio.
- **Pairing Issues:** The remote and receiver are pre-paired. If issues persist, consult the full user manual for specific re-pairing instructions if available.

WARRANTY AND SUPPORT

EMEET is committed to providing excellent customer service and product reliability. We offer a **2-year exclusive warranty** for your EMEET Remote Control. For any technical assistance or inquiries, our professional technical team provides **lifetime support**. You can expect a quick reply to your queries, typically within **24 hours**. For further support, please refer to the contact information provided in your user manual or visit the official EMEET website.