

Manuals+

[Q & A](#) | [Deep Search](#) | [Upload](#)

manuals.plus /

- › [Lordear](#) /
- › [Lordear 33-Inch White Fireclay Farmhouse Workstation Sink Instruction Manual](#)

Lordear LAWS332010D2S-LB

Lordear 33-Inch White Fireclay Farmhouse Workstation Sink Instruction Manual

Model: LAWS332010D2S-LB

1. PRODUCT OVERVIEW

This manual provides instructions for the installation, operation, and maintenance of your Lordear 33-inch white fireclay farmhouse workstation sink. This single-bowl sink is designed for durability and functionality in a kitchen environment.



Image 1.1: The Lordear 33-inch white fireclay farmhouse workstation sink with included accessories.

Key Features:

- **Exceptional Durability:** Crafted from premium fireclay, fired at 2900°F, offering resistance to chips, abrasions, scratches, and discoloration.
- **Easy to Clean:** Smooth, glossy white finish is resistant to stains and easy to maintain.
- **Spacious Design:** 33" L x 20" W x 10" H external dimensions provide ample space for large cookware.
- **Efficient Drainage:** Sloped basin design ensures rapid water drainage, preventing pooling.
- **Workstation Functionality:** Includes a natural wood cutting board, stainless steel protective grid, and a roll-up rack to enhance utility.

2. SAFETY INFORMATION

Please read all instructions carefully before installation and use. Failure to follow these guidelines may result in injury or product damage.

- Always wear appropriate personal protective equipment (PPE) during installation, including safety glasses and

gloves.

- The sink is heavy (approximately 89 pounds). Ensure adequate support is built into the cabinet base to prevent structural damage.
- Handle the sink with care to avoid chipping or cracking the fireclay material during transport and installation.
- Ensure all plumbing connections are secure and leak-free after installation.
- Do not use abrasive cleaners or harsh chemicals on the sink surface, as this may damage the finish.

3. PACKAGE CONTENTS

Verify that all components are present before beginning installation:

- Fireclay Farmhouse Sink
- Natural Wood Cutting Board
- Stainless Steel Protective Grid (Bottom Grid)
- Roll-up Rack
- Updated Stainless Steel Pop-up Drain Assembly
- Instruction Manual

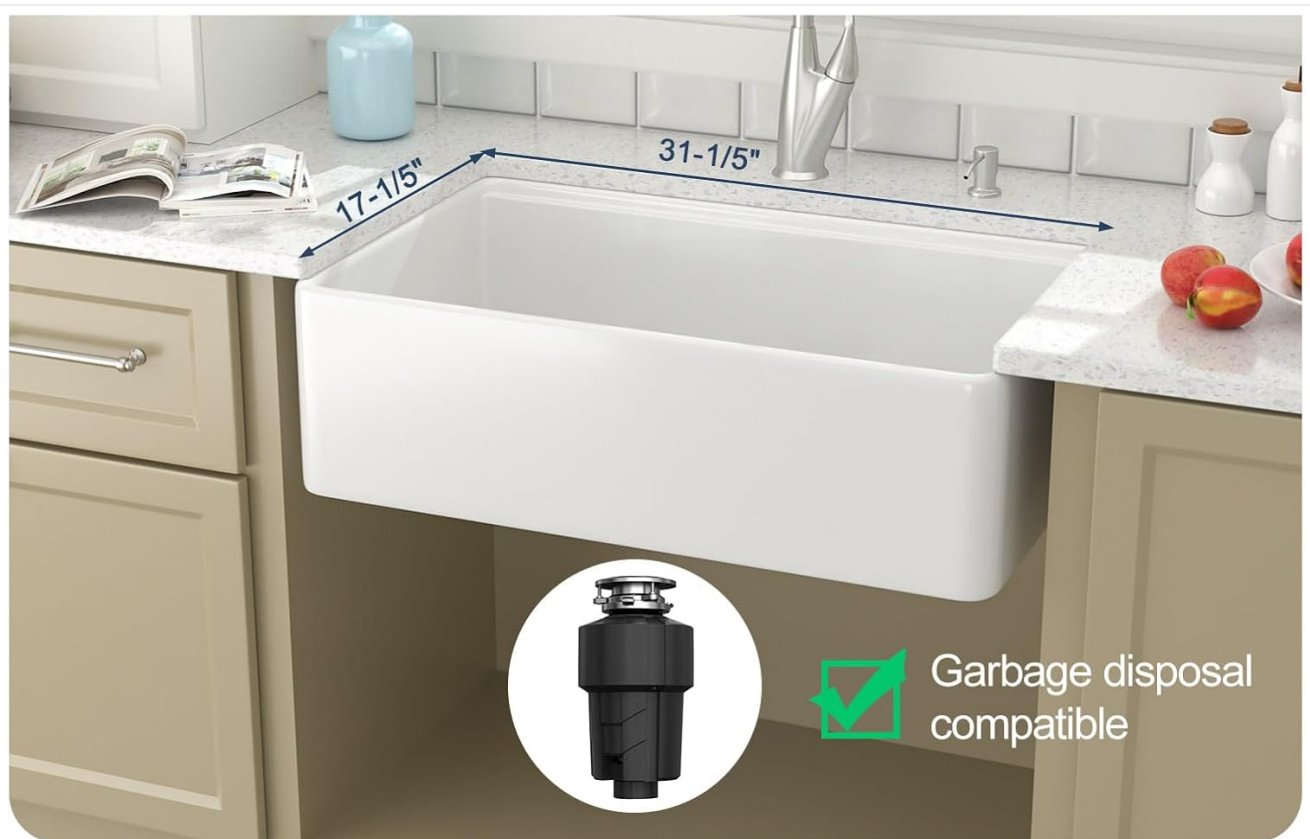

KITCHEN SINK DIMENSION

External Dimension: 33"Wx20"Dx10"H

Internal Dimensions: 31-1/5"Wx17-1/5"D

Recommend Base Cabinet : 36 inch wide

Standard Drainage Hole: 3.5 inch

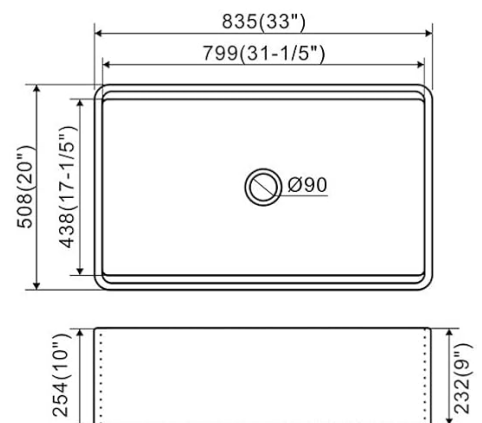

4. SETUP AND INSTALLATION

Professional installation is recommended for optimal results. Ensure your cabinet is prepared according to the dimensions provided.

Dimensions and Cabinet Requirements:

- **External Sink Dimensions:** 33" L x 20" W x 10" H
- **Internal Sink Dimensions:** 31-1/5" L x 17-1/5" W x 9" D
- **Minimum Cabinet Base Size Required:** 36 inches (ensure the cabinet base is at least 3 inches wider than the sink width for proper installation).
- **Standard Drainage Hole:** 3.5 inches.



Image 4.1: Kitchen sink dimensions and garbage disposal compatibility.

*** Please make cutout after getting the package, Thank You.**

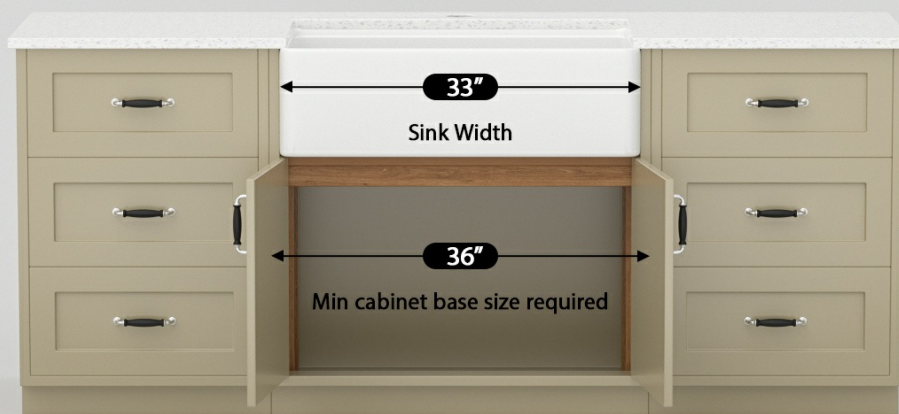

Image 4.2: Cabinet base size requirement for sink installation.

Installation Steps (General Guide):

1. **Prepare Cabinet:** Ensure the cabinet base is properly sized and reinforced to support the sink's weight. A custom frame may be necessary.
2. **Create Cutout:** After receiving the sink, use the actual sink to create the precise countertop cutout. Do not rely solely on template dimensions.
3. **Install Sink:** Carefully place the sink into the prepared cabinet opening. Ensure it is level and properly aligned.
4. **Secure Sink:** Use appropriate mounting hardware (not included, typically provided with countertop installation) to secure the sink to the countertop and cabinet.
5. **Connect Plumbing:** Install the drain assembly and connect to your plumbing system. If installing a garbage disposal, an extended flange may be required due to the fireclay sink's thickness.
6. **Seal Edges:** Apply a silicone sealant around the edges of the sink where it meets the countertop to prevent water infiltration.

5. OPERATING INSTRUCTIONS

Your Lordear workstation sink is designed for versatile use with its integrated accessories.

Using Workstation Accessories:

- **Cutting Board:** Place the natural wood cutting board over the sink's integrated track to create an additional workspace for food preparation.
- **Roll-up Rack:** Position the roll-up rack over the sink to use as a drying rack for dishes or produce, or as a trivet for hot pots.
- **Bottom Grid:** Place the stainless steel protective grid at the bottom of the sink to protect the fireclay surface from scratches and impacts from dishes and cookware.



Image 5.1: The sink configured with cutting board and roll-up rack for workstation functionality.

6. MAINTENANCE

Proper care will ensure the longevity and appearance of your fireclay sink.

Daily Cleaning:

- Wipe the sink clean with a soft cloth and mild soap or a non-abrasive cleaner after each use.
- Rinse thoroughly with water to remove any soap residue.
- Dry the sink with a soft cloth to prevent water spots.



Image 6.1: The fireclay surface is easy to clean.

Preventing Damage:

- Avoid dropping heavy or sharp objects into the sink, even with the bottom grid in place, to prevent potential chipping or cracking.
- Do not use abrasive pads, steel wool, or harsh chemical cleaners (e.g., bleach, acid-based cleaners) as these can damage the glossy finish.
- The fireclay material is highly resistant to high temperatures, but extreme thermal shock should be avoided.
- The sink surface is designed to be scratch-resistant.



Image 6.2: The sink features a durable scratch-resistant coating.

7. TROUBLESHOOTING

This section addresses common issues you might encounter.

Drainage Issues:

- **Problem:** Water pooling or slow drainage.
- **Solution:** The sink features a sloped basin design for efficient drainage. Ensure the drain assembly is clear of debris. If the issue persists, check plumbing for clogs.



Image 7.1: The sloped design ensures excellent water drainage.

Garbage Disposal Installation:

- **Problem:** Standard garbage disposal flange does not fit.
- **Solution:** Due to the thickness of the fireclay, an extended flange is typically required for garbage disposal installation. These can be purchased separately.

Sink-to-Countertop Gap:

- **Problem:** A gap exists between the back of the sink and the countertop.
- **Solution:** This can occur due to variations in sink manufacturing or countertop installation. Apply a high-quality silicone sealant to fill any gaps and prevent water intrusion.

Video: Product Features and Drainage



Video 7.2: This video demonstrates the fine fireclay material, smooth gloss surface, ease of cleaning, and excellent water drainage features of the Lordear White Farmhouse Kitchen Sink.

8. SPECIFICATIONS

Feature	Specification
Brand	Lordear
Model Number	LAWS332010D2S-LB
Color	White-Workstation
Material	Fireclay
External Product Dimensions	33"W x 20"D x 10"H
Installation Type	Undermount
Finish Type	Glossy
Shape	Rectangular
Drain Type	Touch (Pop-up Drain Assembly)
Item Weight	89 Pounds
Minimum Base Cabinet Width	36 Inches
Hole Count	3 (for faucet, soap dispenser, etc.)
Included Components	Cutting board, drain assembly, bottom grid, roll-up rack, instruction manual

9. WARRANTY AND SUPPORT

Lordear offers the following support for your product:

- **Returns:** 3 months from the date of purchase.
- **After-Sales Service:** 1 year of service for product concerns.

For any questions or concerns regarding your Lordear sink, please contact customer support. Your satisfaction is our priority.

