

## B4U B0FNMYQC4D

# B4U 9-Inch Android 12 Car Radio User Manual for Honda Civic (2012-2015)

Model: B0FNMYQC4D

## 1. PRODUCT OVERVIEW

---

This B4U car stereo is designed for Honda Civic models from 2012 to 2015. It features an Android 12 operating system, a 9-inch HD IPS touch screen, 4GB RAM, and 64GB ROM. Key functionalities include offline and online GPS navigation, WiFi connectivity, FM radio, and support for both wired and wireless CarPlay and Android Auto. The unit also integrates with steering wheel controls and includes a waterproof HD rear view camera.



Image 1.1: The B4U 9-inch Android 12 Car Radio seamlessly integrated into a Honda Civic dashboard, displaying its intuitive main interface.

## 2. PACKAGE CONTENTS

---

Verify that all components are present in the package before beginning installation:

- 9-inch Android 12 Car Stereo Unit
- Power Cable
- RCA Cable
- Reversing Input Cable
- 2 USB Cables
- GPS Antenna
- Backup Camera
- External Microphone
- User Manual (this document)

# Backup Camera

When you put on reverse gear, the screen of the Tundra stereo will automatically switch to the reverse image. Very safe and convenient when you are reversing.



# Steering Wheel Control

Through it you can control the functions you need by steering wheel, more convenient.



Image 2.1: All components included with the B4U car radio, detailing the main unit, various cables, and accessories.

## 3. INSTALLATION GUIDE

Professional installation is recommended for this car stereo. Ensure the vehicle's power is disconnected before starting. This unit is specifically designed for Honda Civic models 2012-2015. Confirm the shape and size of your car's center console matches the unit before installation.

### 3.1 General Steps

1. Carefully remove the original car radio and trim panels.
2. Connect the provided power cable to the car's wiring harness.
3. Connect the RCA cables for audio output and auxiliary input.
4. Install the GPS antenna in a location with clear sky view.
5. Route and connect the backup camera cable to the rear of the vehicle and the stereo unit.
6. Connect the external microphone for improved call quality.
7. Mount the new car stereo unit securely into the dashboard.
8. Reconnect the vehicle's power and test all functions.

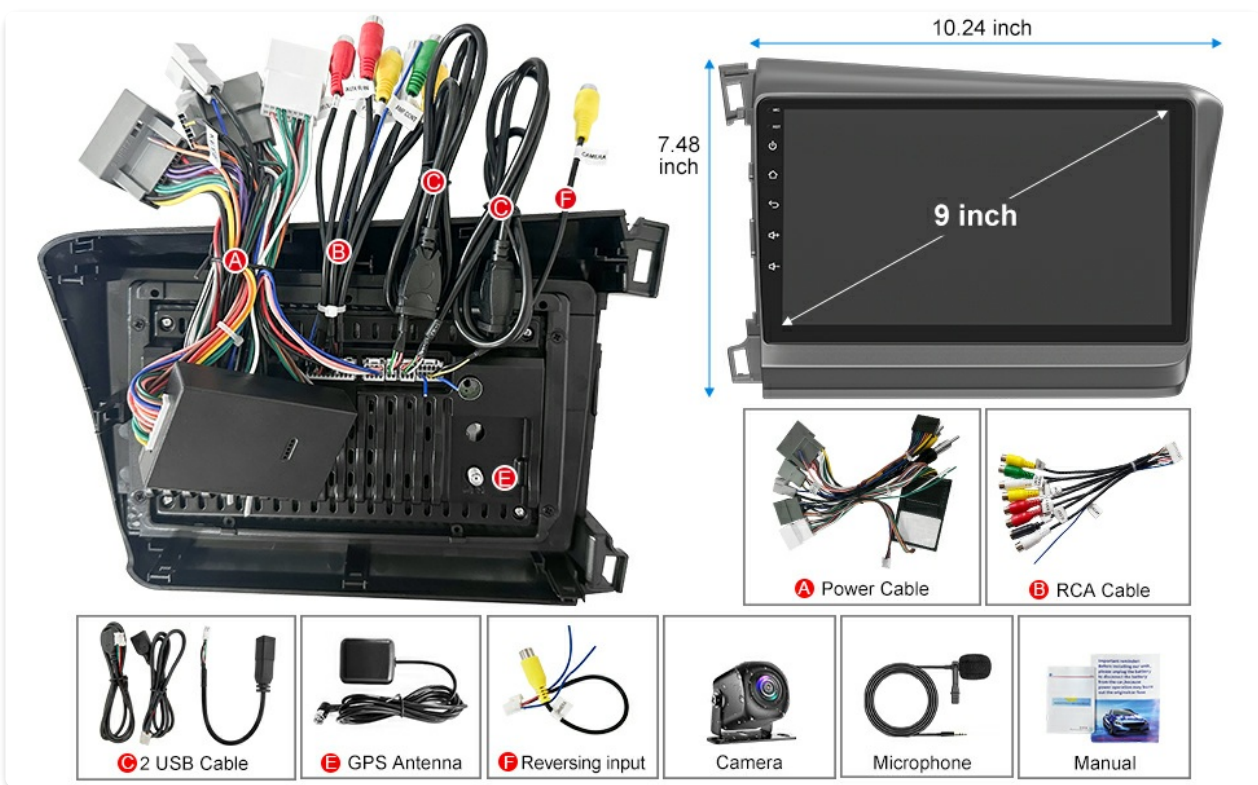

Image 3.1: Visual comparison of the car's dashboard before and after the installation of the B4U Android 12 car radio.

## 4. OPERATING INSTRUCTIONS

### 4.1 System Interface and Touch Screen

The unit features a 9-inch capacitive IPS touch screen with a resolution of 1024\*600. Navigate through menus and applications by tapping, swiping, and pinching. The Android 12 operating system provides a user-friendly interface with customizable layouts.



Image 4.1: Demonstrating touch screen interaction on the 9-inch IPS display.

### 4.2 Wireless CarPlay & Android Auto

Connect your Android or iOS smartphone wirelessly to access features like music, GPS navigation, calls, and messages directly on the car stereo's screen. Voice-activated control is supported for safe operation while driving.

- Ensure Bluetooth and Wi-Fi are enabled on your smartphone.
- On the car stereo, select the CarPlay or Android Auto application.

- Follow the on-screen prompts to pair your device.



Image 4.2: Wireless CarPlay interface displayed on the car stereo, enabling seamless smartphone integration.

### 4.3 GPS Navigation

The unit includes a built-in GPS receiver and supports both offline and online navigation. Connect to WiFi to download offline maps or use online mapping applications.

- Access the navigation app from the main menu.
- For online maps, ensure the unit is connected to WiFi.
- Download desired offline maps for navigation without an internet connection.

# WiFi Connection

Connected the network via phone's hotspot or wifi device, you can surf on the Internet and download any app you like on this 10inch big IPS Touch screen.

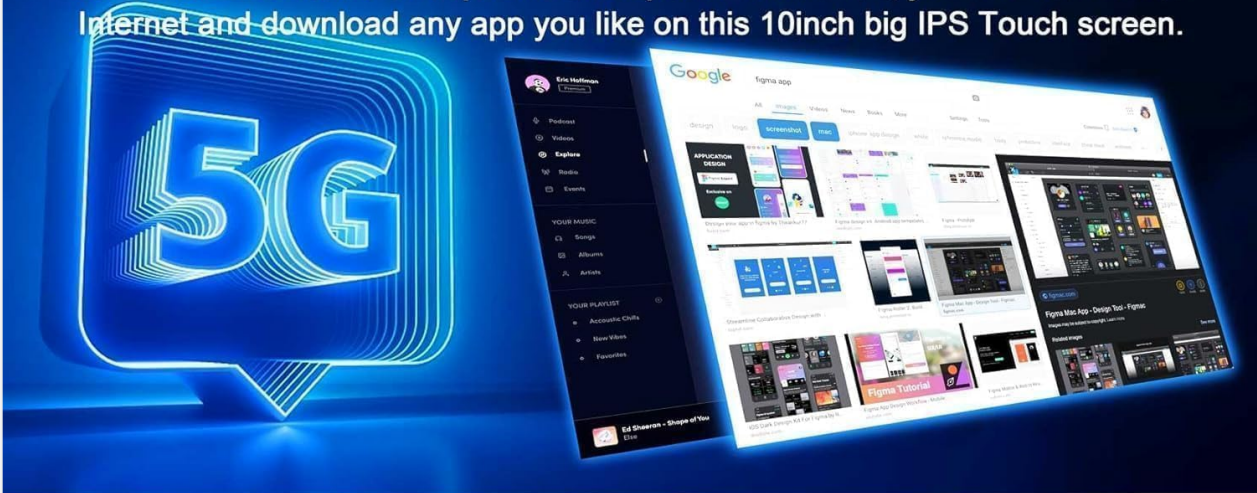

## Support On-line & Off-line GPS Navigation

The stereo comes with GPS antenna and off-line map file. You also can use on-line GPS navi such as google map via wifi.

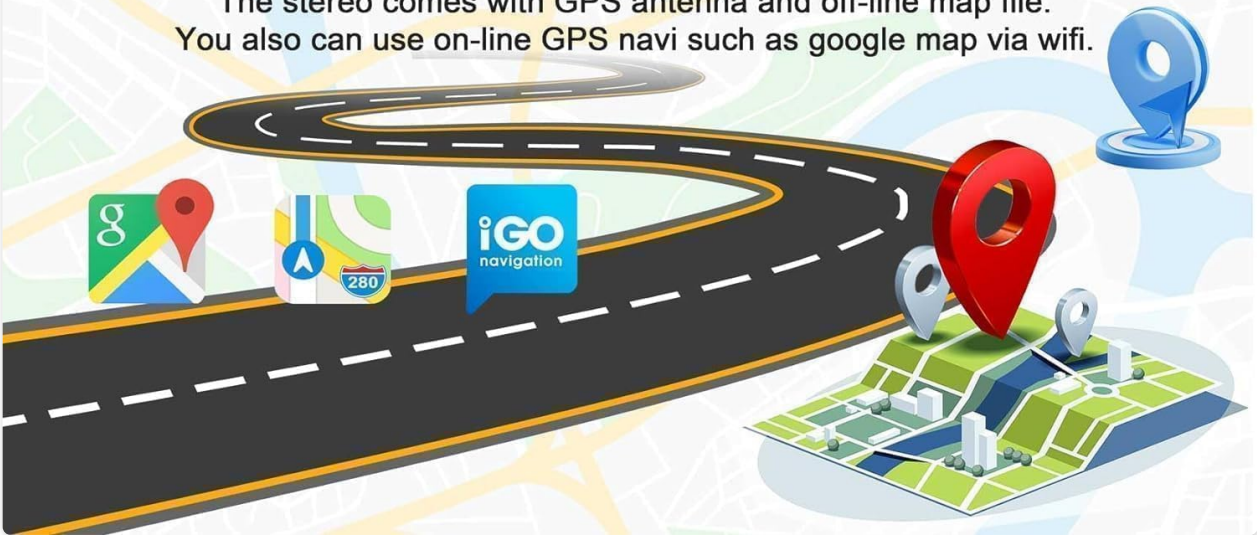

Image 4.3: GPS navigation in action on the car stereo, providing clear route guidance.

### 4.4 Bluetooth 5.2 and FM Radio

Bluetooth 5.2 allows for hands-free calling and wireless audio streaming. The FM radio provides stable reception with unlimited preset stations.

- **Bluetooth:** Pair your phone via Bluetooth settings for calls and music. The unit has a built-in microphone and an external mic jack.
- **FM Radio:** Select the FM Radio app. Use manual or automatic search to find stations and save them as presets.

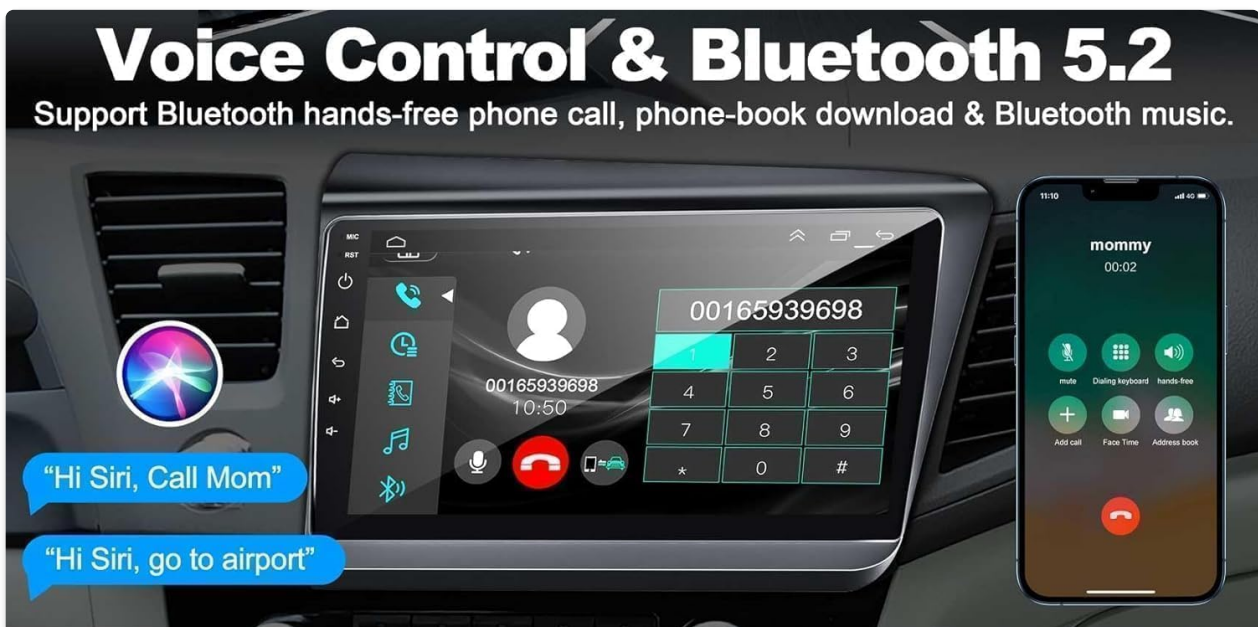

Image 4.4: Bluetooth call screen and FM radio interface on the car stereo.

## 4.5 Backup Camera Input & Steering Wheel Control

The stereo supports a rear view camera input, automatically displaying the image when the vehicle is in reverse. Steering wheel controls can be configured to manage audio functions.

- **Backup Camera:** When the vehicle is shifted into reverse, the screen will automatically switch to the backup camera view. The included camera offers a 170-degree ultra-wide angle and waterproof design.
- **Steering Wheel Control:** Access the 'Steering Learn' option in the settings to program your vehicle's steering wheel buttons to control the car stereo's functions (e.g., volume, track skip, source).



Image 4.5: Backup camera display and steering wheel control configuration options.

## 4.6 WiFi Connection

Connect the car stereo to a WiFi network via your phone's hotspot or a dedicated WiFi device to access online features, download apps, and stream content.

- Go to 'Settings' and then 'Network & Internet'.
- Enable Wi-Fi and select your desired network.
- Enter the password if prompted.



Image 4.6: Visual representation of the car radio's WiFi connectivity feature.

## 4.7 HiFi Audio and EQ Settings

The unit features built-in Hi-Fi audio and supports subwoofer output. Adjust sound effects using the integrated equalizer (EQ) settings to customize your listening experience.

- Access the 'DSP Equalizer' app from the main menu.
- Choose from preset sound modes (e.g., Hi-Fi, Bass, Voice, Rock, Classical, Jazz, Pop) or customize the frequency bands manually.

## 5. MAINTENANCE

To ensure optimal performance and longevity of your car stereo, follow these maintenance guidelines:

- **Screen Cleaning:** Use a soft, lint-free cloth to gently wipe the touch screen. For stubborn smudges, slightly dampen the cloth with water or a screen-safe cleaner. Avoid harsh chemicals or abrasive materials.
- **Software Updates:** Periodically check for available software updates through the system settings to ensure you have the latest features and bug fixes. Connect to a stable WiFi network for updates.
- **General Care:** Avoid exposing the unit to extreme temperatures, direct sunlight for prolonged periods, or excessive moisture.

## 6. TROUBLESHOOTING

If you encounter issues with your B4U car radio, refer to the following common problems and solutions:

- **No Power:** Check all power connections and fuses. Ensure the vehicle's ignition is on.
- **No Sound:** Verify speaker connections. Check volume levels and EQ settings. Ensure the correct audio source is selected.
- **GPS Not Working:** Ensure the GPS antenna is properly installed and has a clear view of the sky. Check GPS settings in the system.
- **Bluetooth Connection Issues:** Ensure Bluetooth is enabled on both the stereo and your phone. Delete previous pairings and try reconnecting.
- **Backup Camera Not Displaying:** Check the camera's power and video connections. Ensure the vehicle is in reverse gear.
- **Touch Screen Unresponsive:** Try restarting the unit. If the issue persists, a factory reset might be necessary (note: this will erase all user data).

For persistent issues, contact B4U customer support.

## 7. SPECIFICATIONS

Feature	Specification
Brand	B4U
Vehicle Service Type	Car (Honda Civic 2012-2015)
Screen Size	9 Inches
Operating System	Android 12
Memory Storage Capacity	64 GB
RAM	4 GB
Connectivity Technology	Bluetooth 5.2, WiFi
Special Features	FM radio, EQ Settings, GPS Navigation, HD Backup Camera, Wired/Wireless CarPlay & Android Auto, Steering Wheel Control
Map Type	Worldwide (Offline/Online)
Included Components	Back-up Camera, Microphone
Audio Output Mode	Stereo
Touch Screen Type	Capacitive
Display Type	LCD
Item Weight	3.1 Pounds

## 8. WARRANTY AND SUPPORT

This B4U car radio comes with a **1-Year Warranty** from the manufacturer. For warranty claims or technical assistance, please contact B4U customer support directly.

Additional protection plans may be available for purchase from third-party providers, offering extended coverage beyond the manufacturer's warranty. These plans typically cover product malfunctions and accidental damage.

- 2-Year Protection Plan (one-time purchase)
- 3-Year Protection Plan (one-time purchase)
- Complete Protect (monthly billing)

For details on these protection plans, refer to the retailer's offerings at the time of purchase.

© 2026 B4U. All rights reserved.