

## TERUNSOU Multi-Size Hardwire Kit

# TERUNSOU Multi-Size Hardwire Kit for Dash Camera - Instruction Manual

Brand: TERUNSOU | Model: Multi-Size Hardwire Kit

## 1. INTRODUCTION

This instruction manual provides detailed guidance for the installation and operation of your TERUNSOU Multi-Size Hardwire Kit. This kit is designed to provide continuous power to your dash camera, enabling features such as 24-hour parking monitoring and low voltage protection for your vehicle's battery. Please read all instructions carefully before installation and use.

## 2. WHAT'S IN THE BOX

The TERUNSOU Multi-Size Hardwire Kit package includes the following components:

- Hardwire Kit (with integrated voltage indicator)
- Installation Tool
- 8 x Piggyback Fuse Taps (4 pairs) with cables
- 4 x 2 Fuse Type
- 1 x Fuse Puller Tool
- User Manual

# BOX CONTENTS

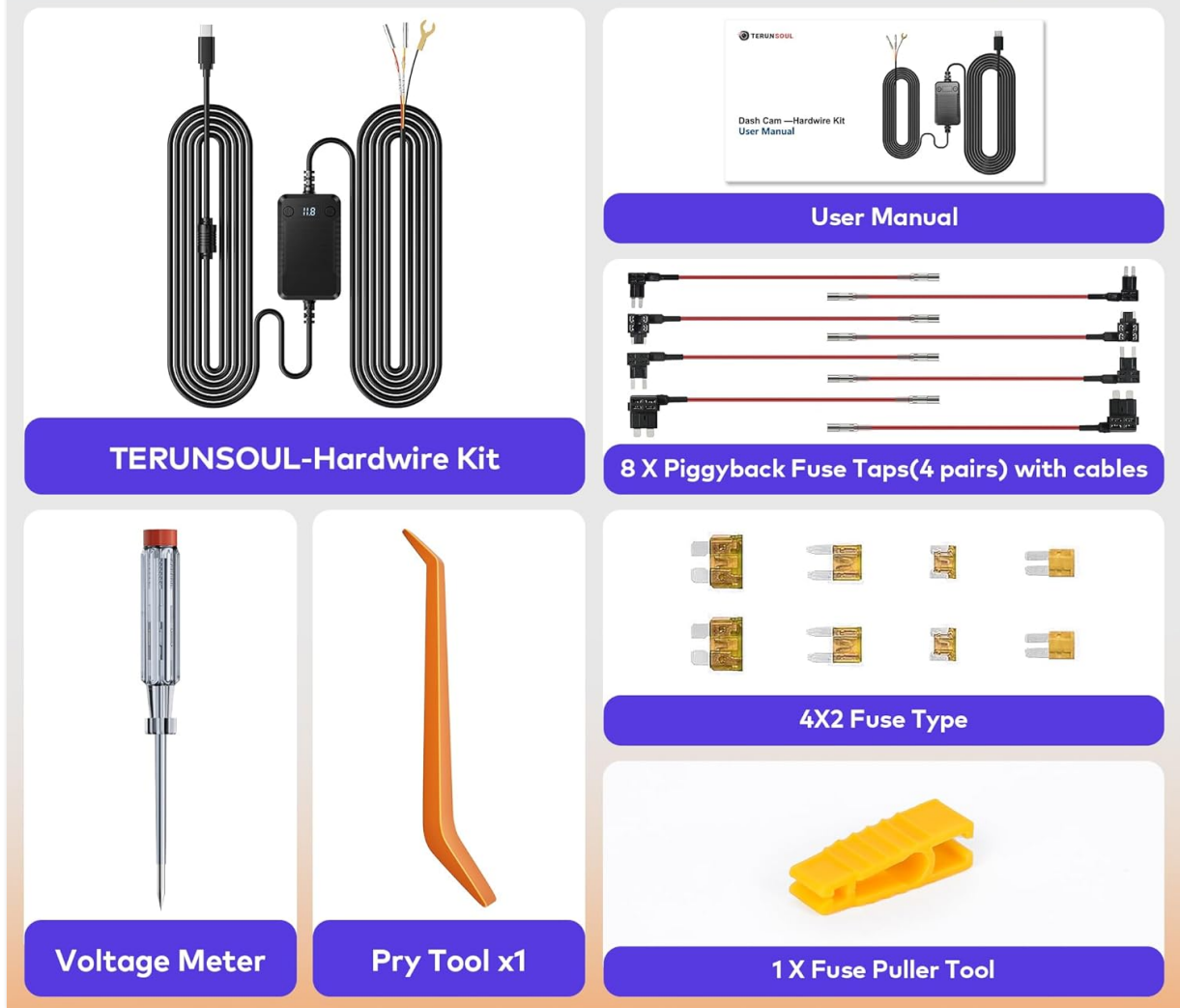

Figure 1: Contents of the TERUNSOUL Multi-Size Hardwire Kit. This image displays the hardwire kit, various fuse taps, a fuse puller, a voltage meter, a pry tool, and the user manual.

## 3. SAFETY INFORMATION

- **Professional Installation Recommended:** If you are unfamiliar with vehicle electrical systems or fuse boxes, professional installation is strongly recommended. Incorrect installation may damage vehicle fuses or electrical components.
- **Wiring Connections:**
  - **Black Wire:** Attach to the vehicle's grounding point.
  - **Red Wire:** Connect to an ACC (Accessory) power source in the fuse box. This provides power only when the vehicle's ignition is on.
  - **Yellow Wire:** Connect to a constant power source in the fuse box. This provides continuous power, even when the vehicle's ignition is off.
- **Connection Order:** Always connect the black ground wire first. Then, connect the yellow (constant power) and red (ACC power) wires last.
- **Battery Drain Warning:** Connecting the red (ACC power) wire to a constant power source by mistake may lead to your car battery draining.

## 4. PRODUCT FEATURES

- **Voltage Indicator:** The hardwire kit includes a voltage indicator to monitor your vehicle's battery status.
- **Low Voltage Protection:** The kit will automatically cut off power to the dash camera if the vehicle's battery voltage drops below a configured value. This prevents complete battery drain, ensuring your car can still start. Suggested minimum cut-off is 11.8VDC for a 12VDC battery and 23.6VDC for a 24VDC battery.
- **Surge Protection:** Built-in surge protection system detects abnormal over-voltage and cuts off power to prevent damage to your dash camera and vehicle.
- **24-Hour Parking Monitor:** Provides continuous power to your dash camera from your car's battery via the fuse box, allowing it to operate in parking mode (collision detection, time-lapse surveillance) even when the engine is off.
- **USB Type-C Compatibility:** The hardwire kit is compatible with dash cameras that use a USB Type-C power input.
- **Compatible Devices:** Specifically designed for TERUNSOU D016 and FW983A dash cameras.



Figure 2: Illustration of the 24-Hour Parking Monitor feature, showing collision detection and time-lapse surveillance capabilities.

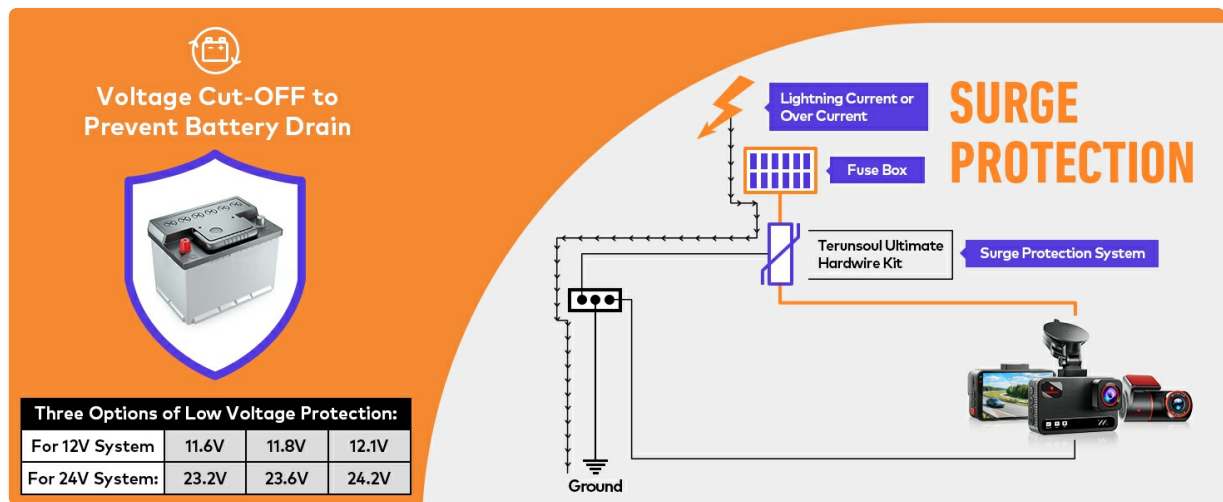

Figure 3: Diagram showing the low voltage cut-off to prevent battery drain and the surge protection system integrated with the hardwire kit.



Figure 4: USB Type-C compatibility details and specific compatibility with TERUNSOU D016 and FW983A dash cameras.

## 5. INSTALLATION GUIDE

---

Follow these steps to install your hardwire kit. Professional installation is recommended.

1. **Decide a Perfect Place to Mount Your Dash Cam:** Choose a location on your windshield where the dash cam has a clear view and does not obstruct your driving visibility.
2. **Locate the Vehicle's Fuse Box:** Refer to your vehicle's owner's manual or manufacturer's website to find the fuse box location.
3. **Determine the Correct Fuse Slot for Installation:** You will need to find two fuse slots: one that provides constant power (for the yellow wire) and one that provides ACC power (for the red wire). Use the included voltage meter to test fuse slots.
4. **Install an Add-A-Fuse Tap:** If using a previously identified fuse slot that has an existing fuse, insert that existing fuse into the lower empty slot of the Add-A-Fuse. If there is no existing fuse, install a new fuse into the 2nd fuse slot of the Add-A-Fuse.
5. **Fit the Red & Yellow Fuse Taps to the Respective Slots:**
  - **Red (ACC Power):** Turn your car keys to the ACC position. Touch the voltmeter to the aluminum end of the red Add-A-Fuse. The voltmeter should read the incoming voltage.
  - **Yellow (Constant Power):** Turn off the car. Touch the voltmeter to the end of the yellow Add-A-Fuse. The voltmeter should read the incoming voltage.
6. **Locate a Good Ground Point:** Connect the black ground wire to a metal chassis grounding screw or bolt. Ensure a secure connection for proper power flow.



Figure 5: Easy Installation Steps 1-3: Mounting, Fuse Box Location, and Fuse Slot Determination.



Figure 6: Easy Installation Steps 4-6: Add-A-Fuse Tap, Wire Connections, and Grounding.

Video 1: Installation guide for a 4K Dash Cam, demonstrating the process of hardwiring the device to a vehicle's electrical system.

## 6. OPERATING INSTRUCTIONS (PARKING MODE)

To utilize the 24-hour parking monitor feature:

1. Start your car's engine.
2. Access your dash camera settings and enable the time-lapse recording function.
3. Once your car is turned off, the time-lapse recording mode will automatically activate, providing continuous surveillance.

## 7. TROUBLESHOOTING

- **Dash Cam Not Powering On:** Check all wire connections (Red, Yellow, Black) to ensure they are securely connected to the correct power sources and ground. Verify the fuse taps are properly seated in the fuse box.
- **Car Battery Draining:** Ensure the red (ACC power) wire is connected to a fuse slot that only provides power when the ignition is on. If connected to a constant power source, it will continuously draw power and may drain the battery.
- **Parking Mode Not Activating:** Confirm that the time-lapse recording function is enabled in your dash camera's settings. Ensure the yellow (constant power) wire is correctly connected to a continuous power source.
- **Voltage Indicator Issues:** If the voltage indicator is not displaying correctly, check the ground connection and ensure the hardwire kit is receiving power.

## 8. SPECIFICATIONS





Feature	Detail
Product Dimensions	1 x 1 x 1 inches
Item Weight	9.1 ounces
ASIN	B0FN848PK2
Connectivity Technology	USB
Special Feature	Parking Monitor
Color	Black
Manufacturer	TERUNSOU

Vehicle Service Type	Car
Video Capture Resolution	4K (Dash Cam Dependent)

## 9. WARRANTY AND SUPPORT

For warranty information or technical support, please refer to the contact details provided in the product packaging or visit the official TERUNSOUl website. Keep your purchase receipt for warranty claims.

### Related Documents - Multi-Size Hardwire Kit

 <p>TERUNSOUl USER MANUAL</p>	<p><a href="#">Terunsoul D016 4K Dash Camera User Manual</a></p> <p>User manual for the Terunsoul D016 4K Dash Camera, providing setup, operation, and troubleshooting instructions.</p>
 <p>TERUNSOUl USER MANUAL</p>	<p><a href="#">TERUNSOUl D018 4K 3-Channel Dash Cam User Manual</a></p> <p>Comprehensive user manual for the TERUNSOUl D018 4K+4K+1080P 3-channel dash cam. Learn about installation, features, operation, and troubleshooting for this advanced vehicle recording device with built-in GPS and Wi-Fi 6.</p>
 <p>WIRELESS CarPlay Adapter USER MANUAL</p>	<p><a href="#">TERUNSOUl BY960H Wireless CarPlay Adapter User Manual</a></p> <p>Comprehensive user manual for the TERUNSOUl BY960H Wireless CarPlay Adapter, detailing setup, usage, specifications, and troubleshooting for seamless integration with compatible vehicles and iPhones.</p>
 <p>WIRELESS HEADSET User's Guide</p>	<p><a href="#">TERUNSOUl Sp1 Wireless Bluetooth Headset User Guide</a></p> <p>Comprehensive user guide for the TERUNSOUl Sp1 wireless Bluetooth headset, covering features, setup, usage, maintenance, and safety instructions. Includes details on Bluetooth 5.1 connectivity, 110-hour playtime, and charging.</p>
 <p>ROVE R3 ultimate 3-LEAD HARDWIRE KIT USER MANUAL</p>	<p><a href="#">ROVE R3 Ultimate 3-Lead Hardwire Kit USB Type-C User Manual</a></p> <p>Comprehensive user manual for the ROVE R3 Ultimate 3-Lead Hardwire Kit with USB Type-C. Learn about installation, features like low voltage protection and parking mode, troubleshooting, and specifications.</p>



### [PRUVEEO Smart Acc Hardwire Kit: Dash Cam Installation & Parking Mode Guide](#)

Install your PRUVEEO Smart Acc Hardwire Kit for dash cams. This quick guide covers product overview, safety, installation steps, specifications, and low voltage protection for parking mode. Visit [pruveeo.us](http://pruveeo.us) for support.