

## Manuals+

[Q & A](#) | [Deep Search](#) | [Upload](#)

Manuals.plus /

› [MYMAHDI](#) /

› MYMAHDI M230DRKB-64GB Mini MP3 Player User Manual

## MYMAHDI M230DRKB-64GB

# MYMAHDI M230DRKB-64GB Mini MP3 Player User Manual

Model: M230DRKB-64GB

## 1. INTRODUCTION

---

This manual provides detailed instructions for the operation and maintenance of your MYMAHDI M230DRKB-64GB Mini MP3 Player. Please read this manual thoroughly before using the device to ensure proper functionality and to maximize your user experience. This device is designed for portable audio and video playback, e-book reading, voice recording, and photo viewing.



Image 1: Front and back view of the MYMAHDI M230DRKB-64GB Mini MP3 Player, showing the screen and rear label.

## 2. PRODUCT OVERVIEW

### 2.1 Package Contents

Upon opening the package, please verify that all items listed below are present:

- 1x MYMAHDI M230DRKB-64GB Mini MP3 Player
- 1x 64GB Micro SD Card (pre-installed or separate)
- 1x Earphone
- 1x USB Cable (for charging and data transfer)
- 1x User Manual (this document)
- 1x Card Reader



## What you will get

1x Music Player  
1x USB Cable

1x 64GB SD Card  
1x User Manual

1x Earphone  
1x Card reader

Image 2: All items included in the product package: the MP3 player, 64GB SD card, earphone, USB cable, user manual, and card reader.

## 2.2 Device Layout and Controls

Familiarize yourself with the physical components and controls of your MP3 player:

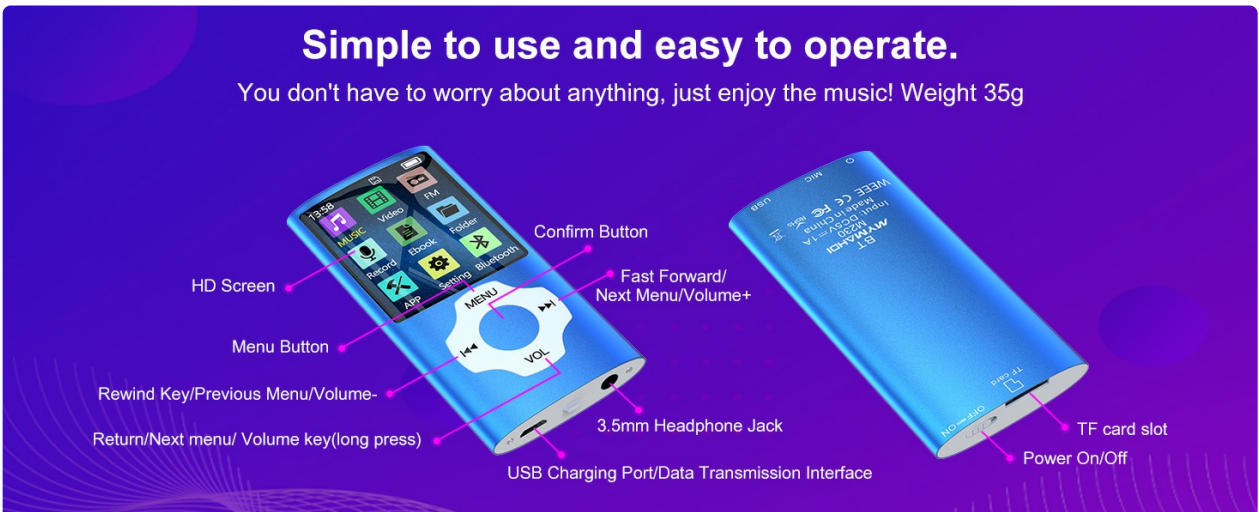

Image 3: Diagram illustrating the various buttons and ports on the MYMAHDI MP3 Player, including the HD screen, Menu button, Rewind/Previous/Volume-, Confirm button, Fast Forward/Next/Volume+, 3.5mm Headphone Jack, USB Charging Port/Data Transmission Interface, TF card slot, and Power On/Off switch.

Component/Control	Description
<b>HD Screen</b>	Displays menus, media content, and device status.
<b>Menu Button</b>	Accesses the main menu or returns to the previous screen.
<b>Rewind Key / Previous Menu / Volume-</b>	Navigates backward, skips to previous track, or decreases volume (long press).
<b>Confirm Button</b>	Selects an option or confirms an action.
<b>Fast Forward Key / Next Menu / Volume+</b>	Navigates forward, skips to next track, or increases volume (long press).
<b>3.5mm Headphone Jack</b>	Connects wired headphones.
<b>USB Charging Port / Data Transmission Interface</b>	Connects to a computer for charging and file transfer.
<b>TF Card Slot</b>	Insert a Micro SD (TF) card to expand storage.
<b>Power On/Off Switch</b>	Slides to turn the device on or off.

## 3. SETUP

---

### 3.1 Charging the Device

Before initial use, fully charge the MP3 player. Connect the device to a computer's USB port or a compatible USB wall adapter (not included) using the provided USB cable. The battery indicator on the screen will show charging status. A full charge typically takes a few hours.

### 3.2 Inserting the Micro SD Card

The device supports Micro SD (TF) cards for expanded storage. Locate the TF card slot on the side of the player. Gently insert the Micro SD card into the slot until it clicks into place. To remove, push the card in slightly until it springs out.

### 3.3 Connecting to a Computer

To transfer files, connect the MP3 player to your computer using the provided USB cable. The device should appear as a removable disk drive on your computer. You can then drag and drop files into the appropriate folders (e.g., 'Music', 'Video', 'Ebook').

## 4. OPERATING INSTRUCTIONS

---

### 4.1 Basic Navigation

Turn on the device using the Power On/Off switch. The main menu will appear. Use the navigation buttons (Rewind, Fast Forward) to move between menu options and the Confirm button to select. The Menu button typically returns to the previous screen or the main menu.

## 4.2 Music Playback

From the main menu, select 'Music'. Navigate through your folders and files to select a song. The player supports MP3, WAV, FLAC, AAC, APE, OGG, M4A, and WMA formats. During playback, use the Rewind/Fast Forward buttons to skip tracks and long-press them to adjust volume.

## 4.3 Video Playback

Select 'Video' from the main menu. The player supports AVI video format. Note that other video formats may require conversion before they can be played on the device. You may need to contact the seller for a conversion tool if your videos are not in AVI format.



Image 4: The MYMAHDI MP3 Player screen displaying a video, demonstrating its video playback capability.

## 4.4 FM Radio

Select 'FM Radio' from the main menu. You may need to connect wired headphones as they often act as an antenna for better reception. Use the navigation buttons to scan for stations or manually tune.

## 4.5 E-Book Reader

Select 'Ebook' from the main menu. The device supports text files for reading. Navigate to your desired e-book

file to open it. Use the navigation buttons to scroll through pages.

## 4.6 Voice Recording

Select 'Record' from the main menu. Follow the on-screen prompts to start, pause, and save voice recordings. The built-in microphone captures audio.

## 4.7 Photo Viewer

Select 'Photo Viewer' from the main menu. Browse through your image files. The device supports common image formats for viewing.

## 4.8 Bluetooth Connection

To connect to Bluetooth headphones or speakers:

1. Ensure your Bluetooth audio device is in pairing mode.
2. On the MP3 player, select 'Bluetooth' from the main menu.
3. The player will scan for available devices. Select your device from the list.
4. Confirm the pairing. Once connected, audio will play through the Bluetooth device.

**Mini Portable Music Player  
with Bluetooth 5.2**

One-click connection

High connection speed

Stable signal, never lose connection

**Bluetooth 5.2**

Image 5: The MYMAHDI MP3 Player wirelessly connected to a Bluetooth speaker, illustrating its Bluetooth 5.2 capability for

one-click connection, high speed, and stable signal.

## 5. FILE MANAGEMENT

### 5.1 Transferring Files

Connect the MP3 player to your computer using the USB cable. The device will appear as a removable drive. Open the drive and navigate to the appropriate folders (e.g., 'Music', 'Video', 'Ebook', 'Photos'). Drag and drop your desired files from your computer into these folders. Ensure files are in supported formats for optimal playback.



**Ultra-Large Capacity MP3 Player**

You can freely replace the memory card, and store more than 10000 songs.

**64GB**

**10000**

Come With 64GB SD Card Together. store more than 10,000 songs.

Image 6: The MYMAHDI MP3 Player alongside a 64GB Micro SD card, symbolizing its large capacity and ability to store over 10,000 songs.

## 6. MAINTENANCE

### 6.1 Cleaning

Use a soft, dry, lint-free cloth to clean the device. Avoid using harsh chemicals, cleaning solvents, or strong detergents, as these may damage the surface or internal components.

## 6.2 Battery Care

To prolong battery life:

- Avoid fully discharging the battery frequently.
- Charge the device regularly, even if not in use for extended periods.
- Store the device in a cool, dry place away from extreme temperatures.



Image 7: Visual representation of the MYMAHDI MP3 Player's battery life, indicating up to 30 days standby, 20 hours of music playback, and 5 hours of video playback.

## 7. TROUBLESHOOTING

If you encounter issues with your MP3 player, refer to the table below for common problems and solutions:

Problem	Possible Cause	Solution
Device does not turn on.	Low battery; device is off.	Charge the device for at least 30 minutes. Ensure the Power On/Off switch is in the 'On' position.

Problem	Possible Cause	Solution
Cannot connect to computer via USB.	Faulty USB cable; loose connection; driver issue.	Try a different USB cable. Ensure the cable is securely connected to both the player and the computer. Try a different USB port on your computer. Restart both devices.
No sound from wired headphones.	Headphones not fully inserted; faulty headphones; volume too low.	Ensure headphones are fully inserted into the 3.5mm jack. Test with another pair of headphones. Increase the volume using the Volume+ button (long press).
Cannot pair with Bluetooth device.	Bluetooth device not in pairing mode; too far from player; interference.	Ensure your Bluetooth headphones/speaker are in pairing mode. Place the devices close to each other. Turn off other Bluetooth devices nearby. Restart the MP3 player's Bluetooth function.
Volume cannot be adjusted.	Incorrect button usage; software glitch.	Ensure you are long-pressing the 'VOL' (Fast Forward/Next or Rewind/Previous) buttons to adjust volume. A short press will skip tracks. If the issue persists, restart the device.
Files are not playing.	Unsupported file format; corrupted file.	Verify that the file format is supported (e.g., MP3 for music, AVI for video). Try playing a different file. Re-transfer the file to the device.

## 8. SPECIFICATIONS

Key technical specifications for the MYMAHDI M230DRKB-64GB Mini MP3 Player:

Feature	Detail
<b>Product Dimensions</b>	0.35 x 1.6 x 3.55 inches
<b>Item Weight</b>	0.634 ounces
<b>Item Model Number</b>	M230DRKB-64GB
<b>Batteries</b>	1 AAA battery required (included) - <i>Note: This contradicts typical rechargeable MP3 players. Assuming internal rechargeable battery based on charging instructions.</i>
<b>Connectivity Technology</b>	Bluetooth, USB
<b>Memory Storage Capacity</b>	64 GB (internal or included SD card)
<b>Color</b>	Blue
<b>Screen Size</b>	1.8 Inches
<b>Compatible Devices</b>	Headphones, Smartphone (for file transfer)

Feature	Detail
Display Technology	LCD
Supported Audio Standards	MP3, AAC, WAV, FLAC, OGG, APE, M4A, WMA
Supported Video Standards	AVI

## 9. WARRANTY AND SUPPORT

---

For warranty information or technical support, please refer to the documentation included with your purchase or contact MYMAHDI customer service directly. Contact details can typically be found on the manufacturer's official website or through your retailer.