

[Manuals.plus](#) /

› [AUTOVIC](#) /

› AUTOVIC Starlink Mini Roof Rack Mount (Model F99W116) Instruction Manual

## AUTOVIC F99W116

# AUTOVIC Starlink Mini Roof Rack Mount Instruction Manual

Model: F99W116

Brand: AUTOVIC

## INTRODUCTION

---

This manual provides detailed instructions for the installation, operation, and maintenance of your AUTOVIC Starlink Mini Roof Rack Mount (Model F99W116). This mount is designed for secure attachment of the Starlink Mini dish to standard T-Track roof racks on various vehicles, including RVs, vans, boats, yachts, and trucks. Please read these instructions carefully before installation and use to ensure proper function and safety.

# Package Included



Image: The AUTOVIC Starlink Mini Roof Rack Mount securely installed on a vehicle's roof rack, demonstrating its low-profile and integrated appearance.

## PRODUCT OVERVIEW

### Components Included

The AUTOVIC Starlink Mini Roof Rack Mount (Model F99W116) package includes the following components:

- 1 x Starlink Mini Roof Rack Mount (consisting of one primary bracket and two auxiliary brackets)

- Stainless steel T-bolts
- Nylon locknuts
- Washers
- Knobs for auxiliary brackets

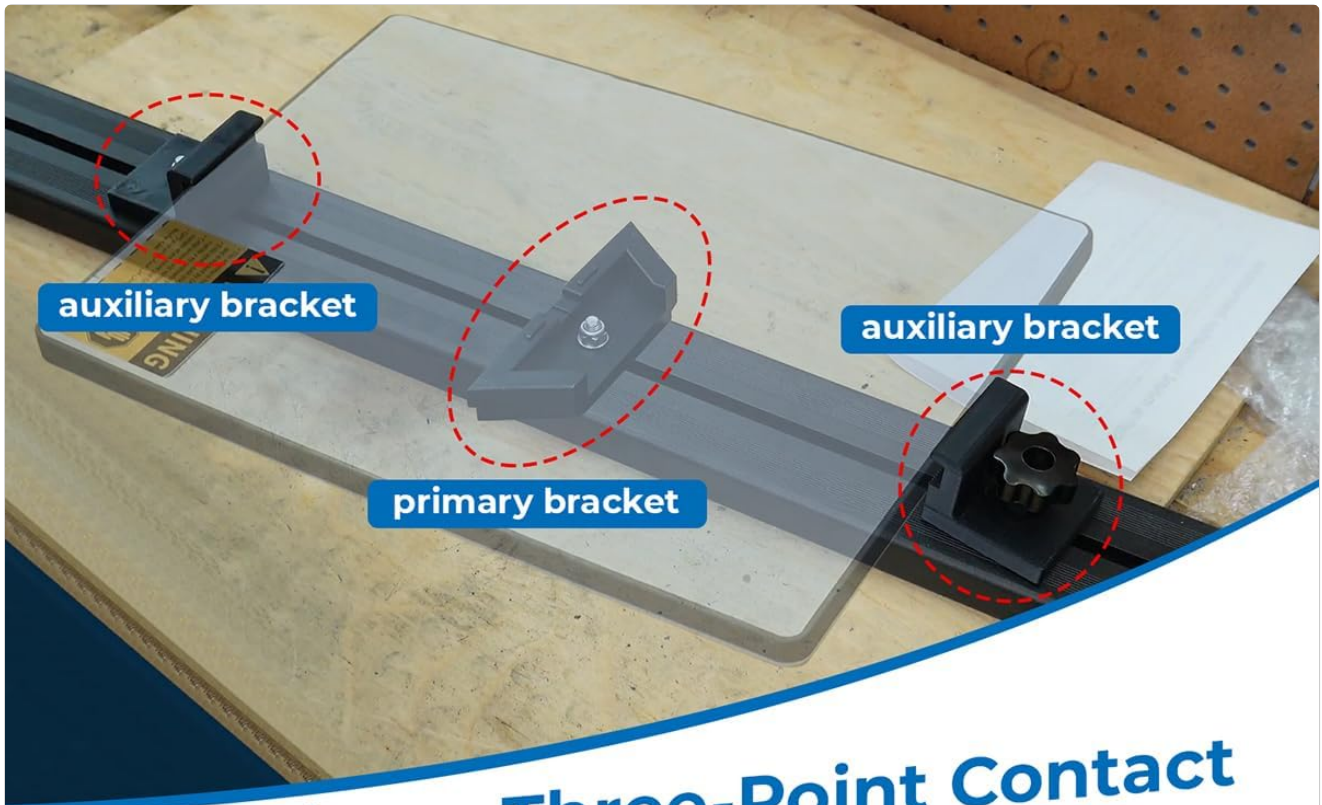

## Adopting a Three-Point Contact System Design



Image: A complete set of components for the AUTOVIC Starlink Mini Roof Rack Mount, including the main bracket, two side brackets, T-bolts, nuts, and washers.

# Why Choose US

## OURS



- ✓ Secure Installation
- ✓ Flexible Adjustment
- ✓ Lightweight Design

## OTHER



- ✗ Poor Weather Resistance
- ✗ Weak Shockproof Performance

Image: A visual representation of the three-point contact system design, highlighting the primary and auxiliary brackets that secure the Starlink Mini dish.

## Key Features

- **Compatibility:** Designed for standard T-Track roof racks.
- **Secure Mounting:** Features a three-point contact system to firmly hold the Starlink Mini dish, minimizing movement and vibrations during travel.
- **Easy Installation & Removal:** Quick installation process with simple loosening of end mounts for removal.
- **Durable Construction:** Made from high-strength ABS material for stable mounting and long-term outdoor use.
- **Compact Design:** Requires approximately 450mm of roof rack length and has a fitted height of 50mm.

## SETUP AND INSTALLATION

Before beginning installation, ensure your roof rack is a standard T-Track system. The mount requires a minimum of 450mm of roof rack length and will add 50mm to the height when fitted.

# Easy to installation

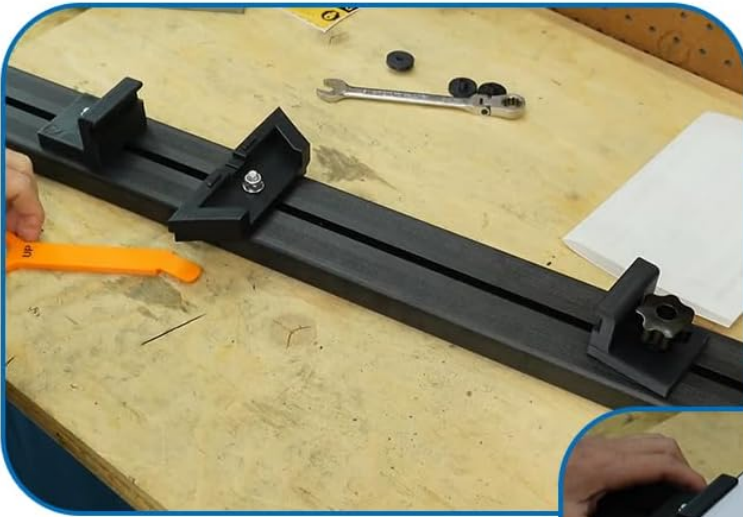

1. Bolt the centre bracket to your T-Slot roof rack using included stainless steel bolts and nylon nuts.

2. Clip the dish onto the mount using its standard method.

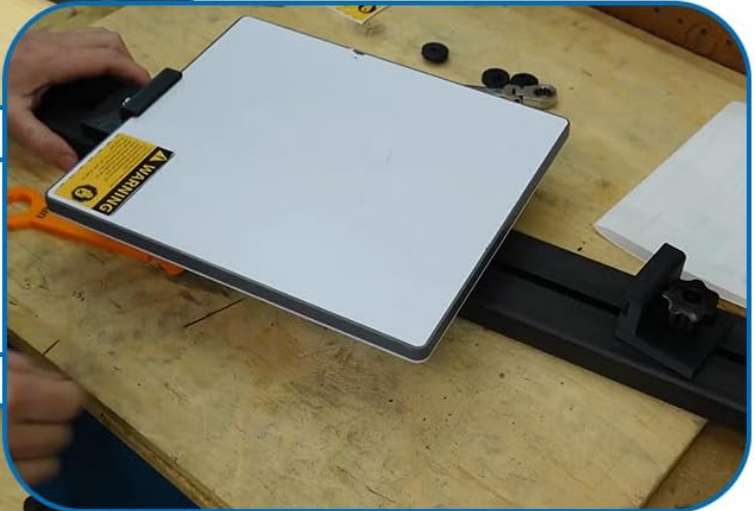

3. Slide support brackets to prevent movement and vibrations.

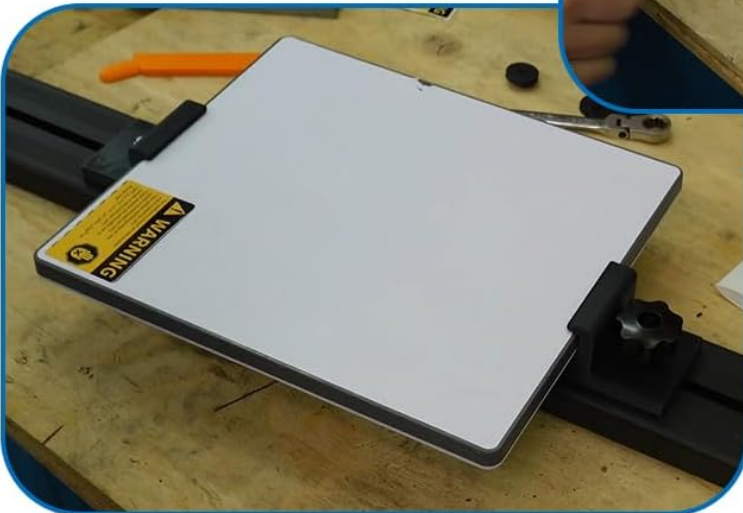

Image: Visual guide illustrating compatibility with standard T-Slot roof racks, the required 450mm roof rack length, and the 50mm fitted height.

## Installation Steps:

1. **Attach Center Bracket:** Bolt the primary (center) bracket to your T-Slot roof rack using the included stainless steel T-bolts and nylon locknuts. Ensure it is securely fastened.
2. **Position Starlink Mini:** Clip the Starlink Mini dish onto the primary mount using its standard attachment method.
3. **Install Auxiliary Brackets:** Slide the two auxiliary support brackets along the T-Track towards the Starlink Mini dish. Position them to prevent movement and vibrations. Secure them using the provided knobs.

# Perfect Fit



Image: A three-panel image demonstrating the installation process: 1. Bolting the center bracket, 2. Clipping the dish, and 3. Sliding and securing the support brackets.

**Important:** Ensure all bolts and nuts are tightened appropriately to prevent loosening from road vibrations. The nylon locknuts are designed to resist loosening, but periodic checks are recommended.

## OPERATING INSTRUCTIONS

Once installed, the AUTOVIC Starlink Mini Roof Rack Mount provides a stable platform for your Starlink Mini. No specific operational steps are required for the mount itself beyond ensuring secure installation.

- **Pre-Travel Check:** Before each journey, verify that the Starlink Mini dish is firmly secured by the mount and that all fasteners (T-bolts, nylon locknuts, and auxiliary bracket knobs) are tight.
- **Removal:** To remove the Starlink Mini, loosen the knobs on the auxiliary brackets, slide them away from the dish, and then unclip the dish from the primary center mount.

## MAINTENANCE

The AUTOVIC Starlink Mini Roof Rack Mount is constructed from durable ABS material and stainless steel components, designed for outdoor use with minimal maintenance.

- **Cleaning:** Clean the mount periodically with mild soap and water to remove dirt and debris. Avoid harsh chemicals that may damage the ABS material.
- **Inspection:** Regularly inspect the mount for any signs of wear, cracks, or damage, especially after long trips or exposure to extreme weather conditions.
- **Fastener Check:** Periodically check the tightness of all bolts, nuts, and knobs to ensure the mount remains secure.

## TROUBLESHOOTING

---

If you encounter issues with your AUTOVIC Starlink Mini Roof Rack Mount, consider the following:

- **Mount Feels Loose:**
  - Ensure all T-bolts and nylon locknuts securing the primary bracket are fully tightened.
  - Verify that the knobs on the auxiliary brackets are securely fastened against the Starlink Mini dish.
  - Inspect the T-Track system on your roof rack for any play or damage.
- **Dish Movement/Vibration:**
  - Confirm that the auxiliary brackets are positioned as close as possible to the Starlink Mini dish to provide maximum support and minimize gaps.
  - Re-check all fasteners for tightness.
- **Material Durability Concerns:**
  - While the mount is made from high-strength ABS, extreme temperatures or prolonged UV exposure can affect plastics. Regular inspection is advised.
  - If any part of the mount appears cracked or compromised, discontinue use and contact AUTOVIC customer service for assistance.

## SPECIFICATIONS

---

Attribute	Detail
Brand	AUTOVIC
Model Number	F99W116
Color	Black
Material	High-strength ABS, Stainless Steel, UV-resistant materials
Item Dimensions (L x W x H)	Approx. 2 x 2 x 2 inches (individual component dimensions may vary)
Item Weight	0.2 Pounds
Fitted Height	50mm (approx. 2 inches)
Required Roof Rack Length	450mm (approx. 17.7 inches)

Included Components	1 x Starlink Mini Roof Rack Mount (primary and auxiliary brackets), T-bolts, nylon locknuts, washers, knobs
---------------------	---

## WARRANTY AND SUPPORT

---

AUTOVIC provides a free return and exchange service for this product. The customer service period is 1 year from the date of purchase if the product is found unsuitable or defective.

For any questions, concerns, or support needs regarding your AUTOVIC Starlink Mini Roof Rack Mount, please contact AUTOVIC customer service. We are committed to assisting you in resolving any issues.

Contact information can typically be found on the AUTOVIC official website or through your purchase platform.