

NEWFAST NF-B912

NEWFAST NF-B912 Point to Point Wireless Bridge Outdoor Wireless Access Points User Manual

Model: NF-B912

1. INTRODUCTION

This manual provides comprehensive instructions for the installation, operation, and maintenance of your NEWFAST NF-B912 Point to Point Wireless Bridge Outdoor Wireless Access Points. Please read this manual carefully before using the device to ensure proper setup and optimal performance. This device is designed to establish a stable and long-range wireless connection between two locations, suitable for outdoor environments.

2. PACKAGE CONTENTS

Verify that all items are present in your package:

- NEWFAST NF-B912 Wireless Access Point (typically two units for a bridge)
- Power over Ethernet (PoE) Injector(s)
- Mounting Kit(s)
- Ethernet Cable(s)

If any items are missing or damaged, please contact NEWFAST customer support.

3. PRODUCT OVERVIEW

The NEWFAST NF-B912 is a robust outdoor wireless access point designed for point-to-point wireless bridging. It features a weatherproof design, making it suitable for various outdoor conditions. The device supports Dual-Band frequency and operates on the 802.11ac wireless communication standard, ensuring reliable and high-speed data transmission. It includes an integrated fixed antenna for focused signal direction.



NEWFAST

Figure 1: Front view of the NEWFAST NF-B912 Wireless Bridge. The device is white with the NEWFAST logo on the front and a series of indicator lights on the left side, indicating power, network activity, and signal strength.

4. SETUP INSTRUCTIONS

Follow these steps to set up your NEWFAST NF-B912 wireless bridge:

1. **Planning:** Determine the optimal locations for the two access points to ensure a clear line of sight for the best wireless link. Consider factors like distance, obstacles, and power availability.
2. **Mounting:** Securely mount each access point using the provided mounting kit. Ensure they are firmly attached and aligned towards each other. The weatherproof design allows for outdoor installation.
3. **Power Connection:** Connect the access point to power, typically via Power over Ethernet (PoE) using an Ethernet cable from a PoE injector or PoE-enabled switch.
4. **Network Connection:** Connect one end of an Ethernet cable from your local network (e.g., router or switch) to the LAN port of the first access point (AP1). For the second access point (AP2), connect an Ethernet cable from its LAN port to the device you wish to provide network access to (e.g., another switch, computer).
5. **Initial Configuration:**
 - Connect a computer directly to one of the access points via Ethernet.
 - Access the device's web-based management interface by entering its default IP address into a web browser. (Refer to the quick start guide for the default IP address and login credentials).
 - Configure one device as the "Access Point" (AP) or "Master" and the other as the "Client" or "Slave" in bridge mode.
 - Set up the wireless network name (SSID), security settings (WPA2/WPA3 recommended), and channel. Ensure both devices are configured to communicate with each other.
 - Adjust antenna alignment for optimal signal strength, monitoring the signal indicator lights on the device or through the web interface.
6. **Testing:** Verify network connectivity and performance between the two locations.

5. OPERATING INSTRUCTIONS

Once properly configured and installed, the NEWFAST NF-B912 operates automatically to maintain a stable wireless bridge connection. The device utilizes Dual-Band frequencies and the 802.11ac standard to provide efficient data transfer.

- **Indicator Lights:** Monitor the LED indicators on the device for status updates. These typically show power, network activity, and signal strength. Refer to the quick start guide for specific LED meanings.
- **Web Interface:** For advanced monitoring and configuration adjustments, access the web-based management interface using a computer connected to the network.
- **Environmental Considerations:** The weatherproof design ensures operation in various outdoor conditions. However, avoid direct exposure to extreme temperatures or prolonged submersion.

6. MAINTENANCE

Regular maintenance helps ensure the longevity and optimal performance of your NEWFAST NF-B912:

- **Physical Inspection:** Periodically check the device and its mounting for any signs of wear, damage, or loose connections, especially after severe weather.

- **Cleaning:** Gently clean the exterior of the device with a soft, damp cloth. Do not use harsh chemicals or abrasive cleaners. Ensure vents are clear of debris.
- **Firmware Updates:** Check the NEWFAST official website for available firmware updates. Keeping the firmware updated can improve performance, security, and add new features.
- **Alignment Check:** If signal strength degrades, re-check the alignment of the access points.

7. TROUBLESHOOTING

If you encounter issues with your NEWFAST NF-B912, refer to the following common problems and solutions:

Problem	Possible Cause	Solution
No Power/LEDs Off	Power adapter or PoE injector not connected, faulty cable, power outage.	Check power connections. Ensure PoE injector is working. Try a different power outlet or Ethernet cable.
No Wireless Link	Misalignment, incorrect configuration, obstacles, excessive distance.	Re-align devices for clear line of sight. Verify AP/Client mode and SSID/security settings. Reduce distance or remove obstacles.
Slow Network Speed	Poor signal strength, interference, network congestion.	Optimize alignment. Check for sources of interference. Ensure firmware is up to date.
Cannot Access Web Interface	Incorrect IP address, network settings on computer, device not powered on.	Verify the device's IP address. Ensure your computer's IP is in the same subnet. Check physical connection and power.

If the problem persists, perform a factory reset (refer to the quick start guide for instructions) and reconfigure the device, or contact NEWFAST customer support.

8. SPECIFICATIONS

- **Model Number:** NF-B912
- **Product Dimensions:** 3.74 x 1.22 x 6.5 inches
- **Item Weight:** 5.4 ounces
- **Wireless Communication Standard:** 802.11ac
- **Frequency Band Class:** Dual-Band
- **Special Feature:** Weatherproof
- **Connectivity Technology:** Ethernet, Wi-Fi
- **Antenna Type:** Fixed
- **Color:** White
- **Compatible Devices:** Smartphone
- **Recommended Uses:** Outdoor Wifi

9. WARRANTY AND SUPPORT



For warranty information and technical support, please refer to the documentation included with your product or visit the official NEWFAST website. You can typically find support resources, FAQs, and contact

information there.

Manufacturer: NEWFAST

Brand Store: [NEWFAST Amazon Store](#)

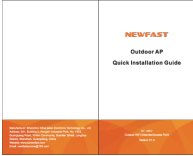
Related Documents - NF-B912

	<p>NEWFAST NF-A882 Outdoor AP Quick Installation Guide</p> <p>A quick installation guide for the NEWFAST NF-A882 Outdoor WiFi Extender/Access Point, covering product installation, device connection, configuration modes (AP, Bridge, Router, Repeater), and troubleshooting.</p>
	<p>NEWFAST Wireless Adapter Quick Installation Guide</p> <p>A quick installation guide for the NEWFAST Wireless Adapter, providing step-by-step instructions for setup and maintenance regulations.</p>



[NF-RE523 Installation Manual by NEWFAST](#)

This document provides a comprehensive installation guide for the NEWFAST NF-RE523 device, including setup instructions, operational guidelines, safety precautions, and troubleshooting tips.



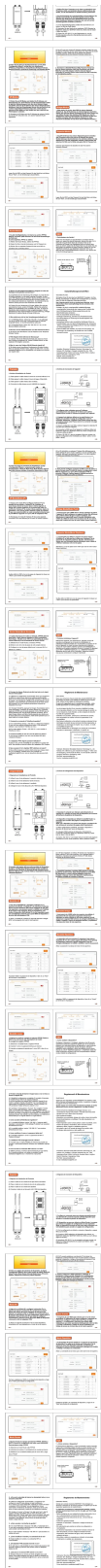

[NEWFAST NF-A882 Installation Manual - Step-by-Step Guide](#)

Comprehensive installation manual for the NEWFAST NF-A882. Includes safety instructions, detailed setup steps, troubleshooting tips, and technical specifications.



[Quick Installation Guide for WiFi Extender/Repeater NF-RE513 V2](#)

A concise guide to installing and setting up the NF-RE513 V2 WiFi Extender/Repeater, including WPS installation and troubleshooting common issues.