

WYZE WYZEC-BC

WYZE Bulb Cam Security Camera Instruction Manual - Model WYZEC-BC

1. INTRODUCTION

The WYZE Bulb Cam is an innovative outdoor security solution that combines smart lighting with a high-definition security camera. Designed for effortless installation into any standard E26 light fixture, it provides comprehensive surveillance and smart home integration without complex wiring. This manual provides essential information for setting up, operating, and maintaining your WYZE Bulb Cam.

Smart Light Bulb with Camera

An all-in-one outdoor security solution, combining smart lighting and a smart security camera, all powered by a single light socket.



Image 1: WYZE Bulb Cam seamlessly integrated into an outdoor light fixture, showcasing its dual functionality as a bright LED bulb and a security camera.

2. WHAT'S IN THE BOX

- WYZE Bulb Cam (Model WYZEC-BC)

3. KEY FEATURES

- **Smart Lighting and Wide 160° View Security Camera:** Motion-activated light and security camera powered by any light fixture for outdoor protection.
- **Clear 2K HD Resolution with WDR and Color Night Vision:** Provides high-definition clarity, evens out darker and lighter spots, and offers color vision in low light.
- **Dimmable 800 Lumen LED Bulb:** Adjustable brightness for optimal lighting via the Wyze app.
- **Telescoping Internal Rod and Manual Adjustable Pan & Tilt:** Extend the camera up to 1.2 inches, pan 360°, and tilt up to 90° to achieve the desired viewing angle.
- **24/7 Local Recording with MicroSD Card*:** Continuous local recording to a microSD card (up to 256 GB,

sold separately) without subscription.

- **Two-Way Audio & Free Detection Alerts:** Communicate with visitors and receive notifications for motion and sound detection directly on your smartphone.
- **AI Notifications and Descriptive Alerts:** Customizable alerts for detection of people, pets, packages, and vehicles (with optional Cam Plus Unlimited subscription).
- **Easy Bluetooth Setup:** Simplifies the setup process without requiring QR code scanning. Works with Alexa, Google Assistant, IFTTT, and Wyze Rules.
- **Group Light Control with Wyze Accessory Bulbs:** Pair up to 5 Accessory Bulbs (sold separately) for synchronized smart lighting coverage.

4. SETUP INSTRUCTIONS

1. **Prepare for Installation:** Before installation, ensure power to your sconce's junction box is shut off at the breaker box.
2. **Check Sconce Type:** The Wyze Bulb Cam is designed for sconces with an open bottom to provide a clear view without glare. Only E26 sockets are compatible.
3. **Install the Bulb Cam:** Screw the WYZE Bulb Cam into a standard E26 light socket.
4. **Adjust Camera Angle:** Manually extend the telescoping rod up to 1.2 inches, rotate 360°, and tilt up to 90° to achieve your desired camera view. This adjustment is manual, not motorized.
5. **Power On:** Restore power at the breaker box. The camera's status light will flash red.
6. **App Setup:** Download the Wyze app on your smartphone. Follow the in-app instructions for Bluetooth setup. The camera will announce "Ready to connect" when it's ready to pair.
7. **Firmware Update:** The app may prompt you to update the firmware. Allow the update to complete; your device will reboot.

Adjusts to Fit Most Light Fixtures

Manually extend, rotate, and tilt the camera to find just the right angle.

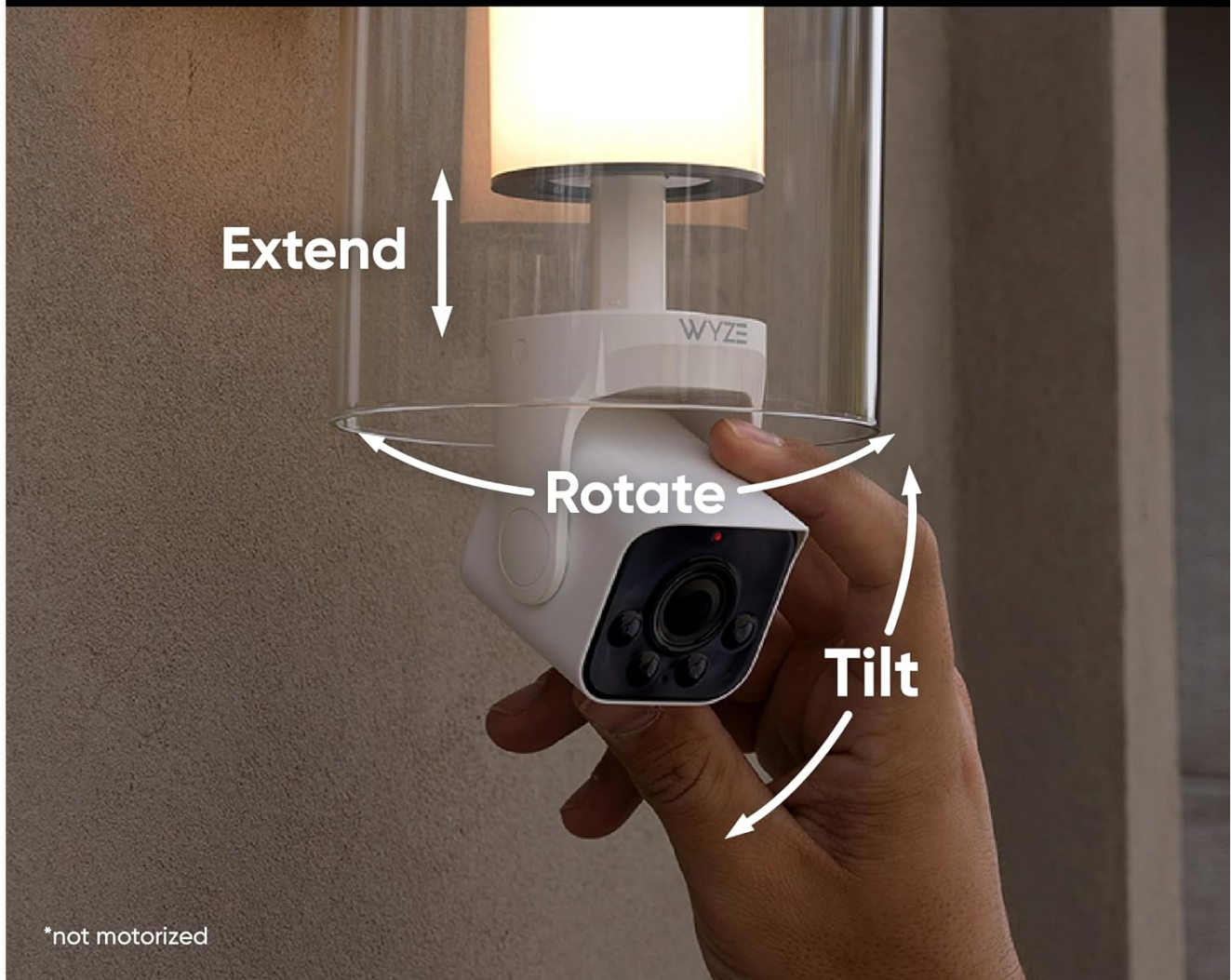

Image 2: Demonstrates the manual adjustment capabilities of the WYZE Bulb Cam, allowing users to extend, rotate, and tilt the camera for optimal positioning within various light fixtures.

Video 1: This video provides a detailed walkthrough of the WYZE Bulb Cam setup process, including unboxing, app pairing, and initial configuration. It also demonstrates how to correct image orientation if the camera is installed upside down.

5. OPERATING INSTRUCTIONS

5.1. Wyze App Control

All primary functions of the WYZE Bulb Cam are controlled through the intuitive Wyze smartphone application. Ensure your camera is connected to your 2.4GHz Wi-Fi network for full functionality.

5.2. Live View and Recording

- Access live 2K HD video stream from anywhere via the Wyze app.
- Utilize the 160° wide-angle view to monitor a broad area.
- Record continuously to a microSD card (sold separately) for 24/7 local storage.
- Benefit from Wide Dynamic Range (WDR) for balanced image exposure in varying light conditions.

See Everything Clearly Day or Night

Protect double the area in greater detail with 2K HD Color Night Vision with 160° field-of-view and Wide Dynamic Range.



Image 3: Illustrates the superior clarity and detail provided by the 2K HD Color Night Vision feature, contrasting it with standard night vision for enhanced outdoor monitoring.

5.3. Smart Lighting Features

- **Dimmable LED:** Adjust the brightness of the 800 Lumen LED bulb directly from the Wyze app.
- **Motion-Activated Light:** Configure the light to turn on automatically when motion is detected.
- **Group Control:** Pair up to 5 Wyze Accessory Bulbs (sold separately) for synchronized lighting control within the app.

800 Lumen Dimmable LED

No need to install a dimmer switch, use the Wyze app to adjust the brightness with just a tap.



Image 4: Highlights the dimmable 800 Lumen LED feature, emphasizing the convenience of adjusting brightness through the Wyze app without needing a physical dimmer switch.

Group Light Control

Auto-connect and link the lighting of up to 5 Wyze Bulb Cameras or Wyze Accessory Bulbs (sold separately) for full coverage smart lighting.



Image 5: Depicts the Group Light Control feature, showing how multiple Wyze Bulb Cameras or Accessory Bulbs can be linked for comprehensive smart lighting coverage.

5.4. Communication and Alerts

- **Two-Way Audio:** Speak and listen through the camera using your smartphone.
- **Motion and Sound Detection:** Receive instant notifications on your smartphone when motion or sound is detected.
- **Siren Alarm:** Activate a siren remotely via the app to deter intruders.
- **AI Notifications:** Customize alerts to detect specific objects like people, pets, packages, and vehicles (requires Cam Plus Unlimited subscription).

24/7 Local Recording with MicroSD

Don't miss a thing with continuous local recording to a microSD card up to 256 GB. No subscription required.

*MicroSD card
sold separately



Image 6: Illustrates the two-way audio functionality, enabling users to communicate with individuals near the camera directly from their smartphone.

Two-Way Audio

Speak to people and pets from anywhere
right from your smartphone.



Image 7: Shows the microSD card slot on the WYZE Bulb Cam, indicating support for 24/7 local recording up to 256 GB without a subscription.

6. MAINTENANCE

- **Cleaning:** Gently wipe the camera lens and bulb surface with a soft, dry cloth. Avoid abrasive cleaners or solvents.
- **Firmware Updates:** Regularly check the Wyze app for firmware updates to ensure optimal performance and security.
- **MicroSD Card:** If using a microSD card, periodically check its status and capacity through the app. Replace if necessary.

7. TROUBLESHOOTING

- **Connectivity Issues:** Ensure your Wi-Fi network is 2.4GHz, as the camera is not compatible with 5GHz networks. Verify strong Wi-Fi signal strength at the installation location.
- **Image Upside Down:** If the live view image appears upside down after installation, navigate to the camera's

settings in the Wyze app, then to 'Advanced Settings', and toggle the 'Rotate Image 180°' option.

- **No Motion Detection:** Check detection settings in the Wyze app to ensure motion detection is enabled and sensitivity is adjusted appropriately. Verify the detection zone covers the desired area.
- **Light Not Functioning:** Ensure the light fixture has continuous power. Check bulb settings in the Wyze app to confirm the light is not manually turned off or scheduled to be off.

8. SPECIFICATIONS

Feature	Detail
Model Name	WYZEC-BC
Connectivity Technology	2.4GHz Wi-Fi (Not 5G Compatible), Bluetooth
Power Source	Light Socket Powering, E26 Socket Powering
Resolution	2K HD
Field of View	160°
Night Vision	Color Night Vision
LED Brightness	800 Lumens (Dimmable)
Local Storage	MicroSD Card up to 256 GB (sold separately)
Two-Way Audio	Yes
Motion Detection	Yes
Siren Alarm	Yes
Smart Home Compatibility	Amazon Alexa, Google Assistant, IFTTT
Material	Acrylonitrile Butadiene Styrene (ABS)
Dimensions (L x W x H)	8.78 x 2.95 x 2.95 inches
Item Weight	13.4 ounces

9. WARRANTY AND SUPPORT

WYZE offers free expert support for your Bulb Cam. For any technical assistance, troubleshooting, or warranty inquiries, please refer to the contact information provided on the official WYZE website or within the Wyze app.