

NEWFAST NF-U353

NEWFAST 5400Mbps USB WiFi Adapter (NF-U353) Instruction Manual

1. PRODUCT OVERVIEW

The NEWFAST 5400Mbps USB WiFi Adapter (Model NF-U353) is designed to provide high-speed wireless connectivity for your PC. It supports the latest WiFi 6E protocol across three frequency bands: 2.4GHz, 5GHz, and 6GHz, offering a combined data transfer rate of up to 5400Mbps. This adapter is suitable for demanding network activities such as 4K video streaming, online gaming, and simultaneous multi-device connections. It incorporates OFDMA and MU-MIMO technologies for stable connections and WPA3 encryption for enhanced network security.



Figure 1: NEWFAST 5400Mbps USB WiFi Adapter with dual adjustable antennas.

2. PACKAGE CONTENTS

- 1 x NEWFAST 5400Mbps USB WiFi Adapter (NF-U353)
- 1 x Quick Installation Guide

3. SETUP GUIDE

3.1 System Requirements

- Operating System: Windows 10 (32-bit / 64-bit), Windows 11 (64-bit)
- USB Port: USB 3.0 (recommended for optimal performance), compatible with USB 2.0

3.2 Driver Installation

The NEWFAST USB WiFi Adapter features a built-in driver, eliminating the need for a CD-ROM or external downloads. The driver will automatically load upon initial connection.

1. Insert the USB WiFi adapter into an available USB port on your computer.
2. Your computer should recognize the adapter as a storage device. Navigate to 'This PC' or 'My Computer' and locate the new drive.
3. Double-click the 'Setup.exe' file within the drive to begin the driver installation. Follow the on-screen

prompts to complete the installation.

4. After successful installation, restart your computer if prompted.



Figure 2: Visual guide for driver installation steps.

3.3 Connecting to a WiFi Network

1. Once the driver is installed and your computer has restarted, click the network icon in the system tray (usually bottom-right corner of the screen).
2. Select the desired WiFi network from the list of available networks.
3. Enter the network security key (password) and click 'Connect'.
4. The network status should change to 'Connected' after a short while.

3.4 Antenna Adjustment

The adapter features two 5dBi high-gain antennas that can be rotated 180 degrees. Adjust the antennas to optimize signal strength and improve reception, especially in complex network environments or when the router is at a distance.

Rotatable Dual 2*5dBi High Gain Antennas

Adjust signal strength, improve signal sensitivity



Figure 3: Rotatable antennas for signal optimization and adapter dimensions.

4. OPERATING MODES

The NEWFAST USB WiFi Adapter supports two primary operating modes:

- **Receive WiFi Mode:** Connects your desktop or laptop to an existing WiFi network, allowing it to access the internet.
- **Launch WiFi Hotspot Mode (AP Mode):** Transforms your computer into a WiFi hotspot, enabling other devices (e.g., smartphones, tablets) to connect to its internet connection. This mode is useful for sharing your internet access.

Multiple Working Modes to Meet Your Needs

Receive WiFi

Connect your desktop/laptop to WiFi



Launch WiFi

Create a WiFi hotspot for sharing



Figure 4: Two working modes: Receive WiFi and Launch WiFi Hotspot.

5. SECURITY FEATURES

The adapter supports advanced WPA3 security features to protect your wireless connections. WPA3 provides stronger encryption and authentication compared to previous standards, safeguarding your data and personal information from unauthorized access.

6. MAINTENANCE

To ensure the longevity and optimal performance of your NEWFAST USB WiFi Adapter, consider the following maintenance tips:

- Keep the adapter clean and free from dust. Use a soft, dry cloth for cleaning.
- Avoid exposing the adapter to extreme temperatures or humidity.
- Handle the adapter carefully to prevent physical damage to the USB connector or antennas.
- Ensure the adapter is securely plugged into the USB port to maintain a stable connection.

7. TROUBLESHOOTING

7.1 No Internet Connection

- **Check Driver Installation:** Verify that the driver is correctly installed. Go to Device Manager (right-click Start button > Device Manager) and check for any yellow exclamation marks next to network adapters. Reinstall the driver if necessary.
- **Verify WiFi Connection:** Ensure you are connected to the correct WiFi network and have entered the password accurately.
- **Router Status:** Check if your router is functioning correctly and broadcasting a WiFi signal.
- **Antenna Position:** Adjust the adapter's antennas to improve signal reception.

7.2 Slow Connection Speed

- **USB 3.0 Port:** Ensure the adapter is plugged into a USB 3.0 port on your computer for maximum speed. USB 2.0 ports will result in lower speeds.
- **Router Compatibility:** For optimal WiFi 6E speeds, ensure your router also supports WiFi 6E (6GHz band).
- **Interference:** Move the adapter away from other electronic devices that might cause interference (e.g., microwaves, cordless phones).
- **Signal Strength:** Adjust antenna orientation to achieve better signal strength.
- **Network Congestion:** If many devices are connected to your network, consider using the 6GHz or 5GHz band for less congestion.

7.3 Adapter Not Recognized

- **Try Different USB Port:** Plug the adapter into a different USB port on your computer.
- **Restart Computer:** A simple restart can often resolve recognition issues.
- **Check Device Manager:** Look for the device in Device Manager. If it appears with an error, try updating or reinstalling the driver.



8. SPECIFICATIONS

Brand	NEWFAST
Model	NF-U353
Data Transfer Rate	Up to 5400 Mbps (2.4GHz: 574Mbps, 5GHz: 2400Mbps, 6GHz: 2400Mbps)
Data Link Protocol	IEEE 802.11ax/ac/a/b/g/n
Hardware Interface	USB 3.0
Compatible Devices	Desktop, Laptop (Windows 10/11 only)
Antennas	2 x 5dBi High Gain Antennas (180° rotatable)
Security	WPA3 Encryption
Dimensions	15 x 9 x 1.9 cm (approximate)
Weight	60 g (approximate)

9. WARRANTY AND SUPPORT

This NEWFAST product comes with a 1-year warranty. For any questions or technical assistance, please contact our professional after-sales service team. We aim to respond to inquiries as soon as possible. Contact information can typically be found on the product packaging or the official NEWFAST website.

Related Documents - NF-U353

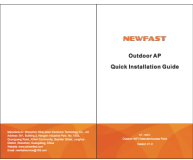
	<p>NEWFAST Wireless Adapter Quick Installation Guide</p> <p>A quick installation guide for the NEWFAST Wireless Adapter, providing step-by-step instructions for setup and maintenance regulations.</p>
	<p>Quick Installation Guide for WiFi Extender/Repeater NF-RE513 V2</p> <p>A concise guide to installing and setting up the NF-RE513 V2 WiFi Extender/Repeater, including WPS installation and troubleshooting common issues.</p>
	<p>NEWFAST NF-A882 Outdoor AP Quick Installation Guide</p> <p>A quick installation guide for the NEWFAST NF-A882 Outdoor WiFi Extender/Access Point, covering product installation, device connection, configuration modes (AP, Bridge, Router, Repeater), and troubleshooting.</p>



[NF-RE523 Installation Manual by NEWFAST](#)

This document provides a comprehensive installation guide for the NEWFAST NF-RE523 device, including setup instructions, operational guidelines, safety precautions, and troubleshooting tips.



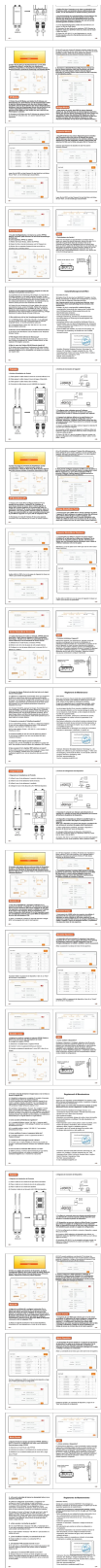

[NEWFAST NF-A882 Installation Manual - Step-by-Step Guide](#)

Comprehensive installation manual for the NEWFAST NF-A882. Includes safety instructions, detailed setup steps, troubleshooting tips, and technical specifications.

