

Chicco Fit360

Chicco Fit360 ClearTex Rotating Convertible Car Seat Instruction Manual

Model: Fit360 | Part Number: 06087216950070

1. INTRODUCTION

The Chicco Fit360 ClearTex Rotating Convertible Car Seat is designed to provide safety and convenience for your child from infancy through toddlerhood. This manual contains essential information for proper installation, use, and maintenance of your car seat. Please read all instructions carefully before using the product and retain this manual for future reference.



Image 1.1: The Chicco Fit360 ClearTex Rotating Convertible Car Seat, showcasing its ergonomic design and integrated base.

2. SAFETY GUIDELINES

Always prioritize your child's safety. Failure to follow these guidelines can result in serious injury or death.

- Never leave a child unattended in the car seat.
- Always secure your child with the harness system, ensuring straps are snug and the chest clip is at armpit level.
- Ensure the car seat is correctly installed in your vehicle according to the instructions provided in this manual.
- Do not use the car seat if it has been involved in a crash, even if there is no visible damage. Replace it immediately.
- Register your car seat with Chicco to receive important safety updates and recall information.

3. PRODUCT COMPONENTS AND FEATURES

The Chicco Fit360 car seat incorporates several features designed for ease of use and child comfort.

- **360° One-Hand Rotation:** Allows the seat to rotate for easy child loading and unloading.
- **Quick Secure Harness System:** Includes a magnetic chest clip, flex-forward buckle, and harness pockets.
- **LeverLock Self-Tensioning Lock System:** Provides secure installation with minimal effort using the vehicle's seat belt.
- **ClearTex Materials:** Flame retardant-free and GREENGUARD Gold Certified for low chemical emissions.
- **Ergonomic Seat Shell:** Supports a natural seated position for enhanced comfort.
- **Advanced Side Impact Protection (ASIP):** Engineered to meet FMVSS 213a standards.
- **ReclineSure Leveling System:** 6 recline positions for optimal vehicle fit and child comfort.
- **RideRight Bubble Level-Indicators:** Visual indicators to confirm correct installation angle.
- **15-Position Easy-Adjust Headrest:** Adjusts simultaneously with the harness height.
- **Removable Body Support:** For newborns weighing 4-11 lbs.



Ergonomic Comfort

Ergonomically designed seat shell and ultra-plush seat pad

Image 3.1: The ergonomic design of the car seat provides comfort for the child.



Image 3.2: The car seat features ClearTex flame retardant-free materials, certified for low chemical emissions.

4. INSTALLATION

4.1. LeverLock Seat Belt Installation

The LeverLock system simplifies secure installation using your vehicle's seat belt.

1. Place the car seat on the vehicle seat.
2. Open the LeverLock door on the car seat base.
3. Route the vehicle's seat belt through the easy-access belt guides.
4. Buckle the vehicle's seat belt.
5. Close and latch the LeverLock door. This action automatically tensions the seat belt, securing the car seat firmly.
6. Verify installation using the RideRight bubble level-indicators to ensure the correct recline angle for rear-facing or forward-facing modes.



LeverLock[®] Seat Belt Install

Image 4.1: Demonstrating the LeverLock seat belt installation for a secure fit.

4.2. Recline Position Adjustment

The car seat features 6 recline positions to ensure proper vehicle fit and child comfort.

- Adjust the recline position using the ReclineSure leveling system before tightening the car seat into the vehicle.
- Consult the RideRight bubble level-indicators to confirm the appropriate recline for your child's age and weight in either rear-facing or forward-facing orientation.

4.3. Newborn Body Support

For infants weighing 4-11 lbs, use the removable body support to ensure proper positioning and comfort.

5. OPERATING INSTRUCTIONS

5.1. 360° Rotation Feature

The 360° one-hand rotation allows for easy access to your child.

1. Ensure the vehicle is stationary and safe to operate the rotation feature.
2. Locate the rotation lever (refer to product diagrams for exact location).
3. Press the lever and rotate the car seat towards you for easy loading or unloading.
4. Once the child is secured or removed, rotate the seat back to the desired rear-facing or forward-facing position until it clicks securely into place.



360° 1-Hand Rotation

Rotate the seat toward you for an easy in-and-out experience

Image 5.1: The 360-degree rotation feature allows for easy child placement.

5.2. Securing Your Child (Quick Secure Harness System)

The Quick Secure Harness System ensures your child is safely restrained.

1. Place your child in the car seat. The flex-forward buckle will stay out of the way for easier loading.
2. Bring the harness straps over your child's shoulders and connect the buckle tongues into the crotch buckle.
3. Connect the magnetic chest clip at armpit level. The magnetic feature allows for quick and easy connection.

4. Pull the harness tightening strap to ensure the harness is snug against your child's body. You should not be able to pinch any excess webbing at the shoulder.
5. Harness pockets keep straps and buckles contained when not in use, preventing them from getting tangled or lost.

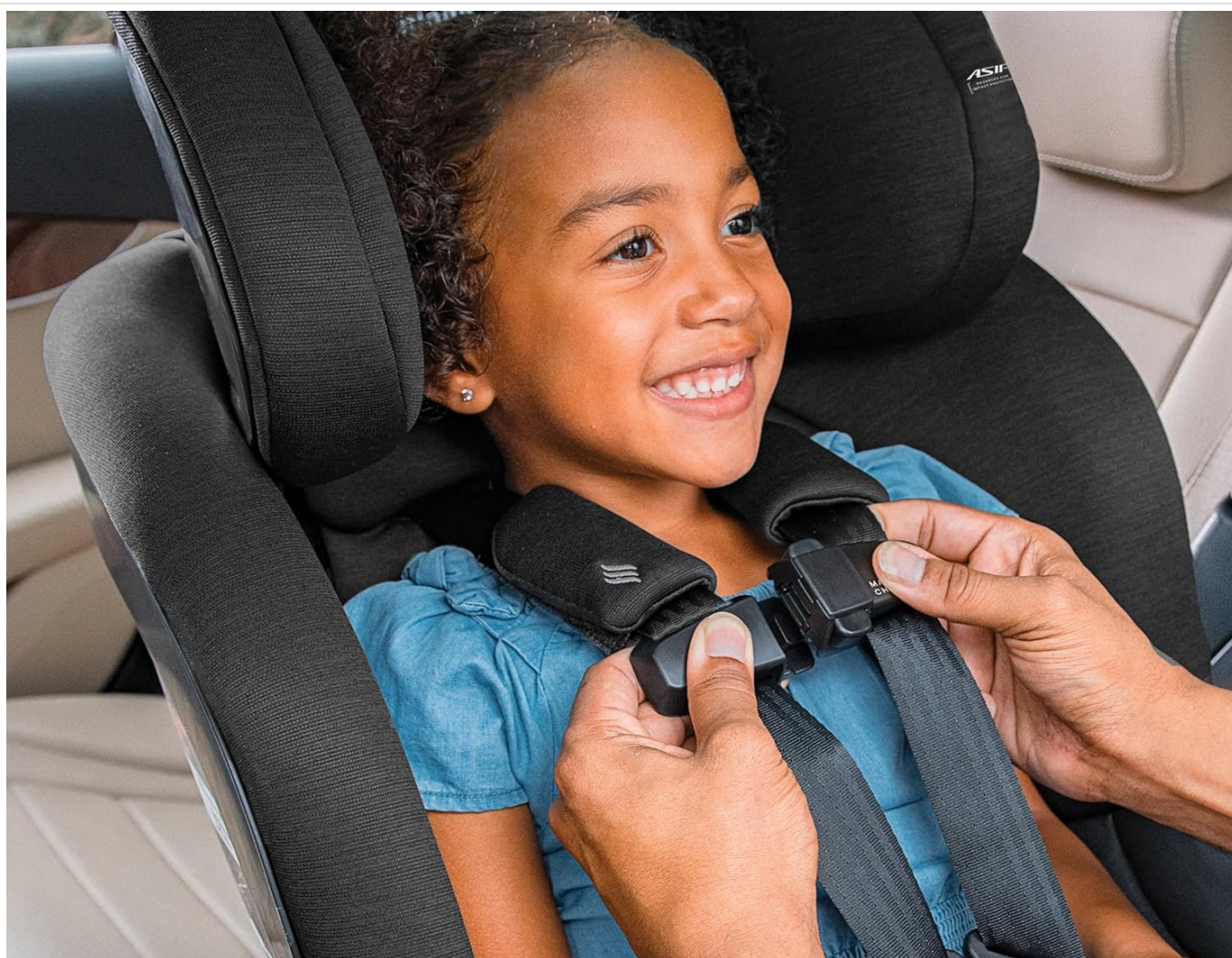

Magnetic Chest Clip

Quick-secure chest clip offers easy in and out

Image 5.2: The magnetic chest clip provides quick and secure fastening.



Quick-Secure Harness System

Image 5.3: The Quick Secure Harness System facilitates easy loading and unloading of the child.

5.3. Headrest and Harness Adjustment

The 15-position easy-adjust headrest simultaneously adjusts the harness height, accommodating your growing child.

- Locate the headrest adjustment lever at the top of the car seat.
- Squeeze the lever and slide the headrest up or down to the desired position.
- Ensure the harness straps are at or just below your child's shoulders for rear-facing, and at or just above for forward-facing.



Room to *Grow*

6 recline positions and a 15-position easy-adjust headrest

Image 5.4: The adjustable headrest and harness system accommodate growing children.

6. CARE AND MAINTENANCE

Proper care ensures the longevity and hygiene of your car seat.

- **Fabrics:** The seat pad and other fabric components are machine-washable. Refer to the care label on the fabric for specific washing instructions. Use mild detergent and cold water on a delicate cycle. Air dry.
- **Cup Holders:** The two flexible cup holders are removable and dishwasher-safe for easy cleaning.
- **Harness System:** Wipe harness straps with a damp cloth. Do not machine wash or submerge harness straps in water, as this may weaken them.
- **Plastic and Metal Parts:** Wipe with a damp cloth and mild soap. Do not use abrasive cleaners or solvents.



Removable *Cup Holders*

Two flexible, dishwasher-safe cup holders

Image 6.1: Removable and dishwasher-safe cup holders for easy cleaning.

7. TROUBLESHOOTING

If you encounter issues with your Chicco Fit360 car seat, refer to the following common solutions.

- **Car Seat Feels Loose After Installation:** Ensure the LeverLock door is fully latched. Re-route the seat belt and apply more pressure when closing the LeverLock. Check the RideRight indicators for correct recline.
- **Harness Straps Are Difficult to Tighten/Loosen:** Check for twists in the harness webbing behind the car seat. Ensure the harness release button is fully depressed when loosening.
- **Seat Does Not Rotate Smoothly:** Ensure no fabric or debris is obstructing the rotation mechanism. The seat must be fully upright and not reclined to rotate.
- **Chest Clip Not Connecting:** Ensure both magnetic pieces are clean and free of obstructions.

For further assistance, please contact Chicco Customer Service.

8. SPECIFICATIONS

Feature	Detail
Product Dimensions	20 x 18.25 x 25.75 inches
Item Model Number	06087216950070
Minimum Weight Recommendation	4 Pounds
Maximum Weight Recommendation	65 Pounds
Maximum Height Recommendation	49 Inches
Material Type	Alloy Steel, Plastic, Polyester
Material Composition	60.6% Plastic, 25.4% Steel, 14% Fabric & Fill
Care Instructions	Machine washable seat pad
Style	Fit360
Number of Reclining Positions	6 (for installation)
Orientation	Rear Facing or Forward Facing
Rear-Facing Minimum Child Weight	4 Pounds
Rear-Facing Maximum Child Weight	40 Pounds
Forward-Facing Minimum Child Weight	26.5 Pounds
Forward-Facing Maximum Child Weight	65 Pounds
Harness Type	5-Point
Item Weight	31.2 pounds
Installation Type	LeverLock Belt-Tensioning Lock Technology or LATCH system
Color	Carbon

9. WARRANTY INFORMATION





Chicco products are covered by a limited warranty. For detailed information regarding the warranty period, coverage, and terms, please refer to the warranty card included with your product or visit the official Chicco website. Retain your proof of purchase for warranty claims.

10. CUSTOMER SUPPORT

If you have any questions, require assistance, or need to report an issue with your Chicco Fit360 ClearTex Rotating Convertible Car Seat, please contact Chicco Customer Service.

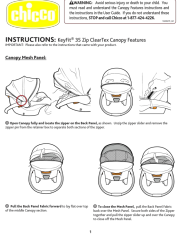
- **Online Support:** Visit the official Chicco USA website for FAQs, product registration, and contact forms.
- **Telephone Support:** Refer to the contact information provided on the Chicco website or your product packaging.

Related Documents - Fit360

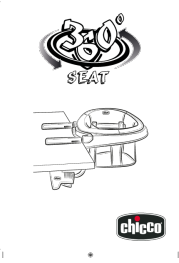
	<p>Chicco NextFit MAX ZIPO Convertible Car Seat User Guide</p> <p>Comprehensive user guide for the Chicco NextFit MAX ZIPO Convertible Car Seat, detailing safe installation, usage instructions, and important safety guidelines for rear-facing and forward-facing modes. Includes maintenance and support information.</p>
	<p>Chicco KeyFit 35 Zip ClearTex Canopy Features and Instructions</p> <p>Detailed instructions for installing, using, and cleaning the Chicco KeyFit 35 Zip ClearTex Canopy. Learn how to attach the mesh panel and privacy shield for your child's comfort and protection.</p>
	<p>Chicco Meraviglia: Manuale d'Uso e Guida Completa</p> <p>Scopri il seggiolone multifunzione Chicco Meraviglia. Istruzioni dettagliate per l'uso, la sicurezza e le diverse configurazioni: da sdraiata a sedia per adulti. Perfetto per ogni fase della crescita.</p>
	<p>Chicco Seat&Go i-Size Car Seat User Manual</p> <p>Detailed user manual for the Chicco Seat&Go i-Size Car Seat, covering installation, safety features, and usage guidelines. This document provides essential information for safe and correct use of the child restraint system.</p>
	<p>Chicco Take-A-Seat 3-in-1 Travel Seat Owner's Manual</p> <p>This owner's manual provides detailed instructions for the assembly, use, and maintenance of the Chicco Take-A-Seat 3-in-1 Travel Seat. It covers chair booster mode, floor seat mode, and toddler chair mode, along with safety warnings and component lists.</p>
	<p>Chicco 360 Seat: Manuale di Istruzioni e Guida all'Uso Sicuro</p> <p>Guida completa alle istruzioni per il seggiolino da tavolo Chicco 360 Seat. Scopri come montare, utilizzare in sicurezza, pulire e mantenere il tuo seggiolino per un'esperienza ottimale con il tuo bambino.</p>



[\[pdf\]](#) Installation Guide Guide Catalog Label Recall

User Guide Chicco USA chiccousa â° car seats C Fit360 Car Seat on demandware static Sites chicco catalog default dw7bd16c28 images products Manuals |||

For future use, store user guide in compartment at front of base. IS0224E_03 08/23 c 2023 Artsana U ... the Child Restraint could increase the child s risk of serious injury or death. 2 To install the **Fit360** to the vehicle, the seat must be removed from the base. The Base can be installed using Lap/S...

lang:en **score:52** filesize: 5.45 M page_count: 64 document date: 2023-10-31

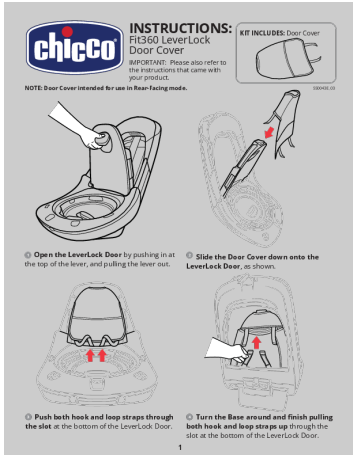

[\[pdf\]](#) User Manual Instructions Catalog

INSTRUCTIONS 10 hours ago — Chicco Fit360 LeverLock Door Cover Product Manual srsItid

AfmBOOpt1UjMPxxY8QXkhp0 lwF5sFRxdfQDz9D o1QhUf8bxMqGfU3L chiccousa on demandware static Sites chicco catalog default dwf333c521 images products Manuals car seats |||

INSTRUCTIONS: **Fit360** LeverLock Door Cover IMPORTANT: Please also refer to the instructions that came with your product. NOTE: Door Cover intended for use in Rear-Facing mode. KIT INCLUDES: Door Cover SS0043E_03 1 Open the LeverLock Door by pushing in at 2 Slide the Door Cover down onto the the top...

lang:en **score:51** filesize: 1.07 M page_count: 2 document date: 2024-06-18

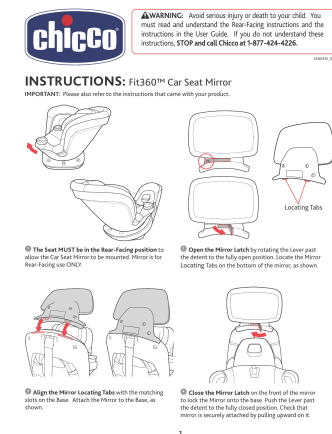

[\[pdf\]](#) Instructions

INSTRUCTIONS Fit360™ Car Seat Mirror ChiccoWARNING Avoid serious injury or death to your child

You must read and understand the Rear Facing instructions in User GuideChicco Fit360 Mirrorchiccousa on demandware static Sites Chicco Library default dw32d5b77a manuals car seats srsItid

AfmBOOpTH2EptoOZp6ROPv4N0tnoSQTi55exCAAR1Bdg0KKmUdOidp0 |||

WARNING: Avoid serious injury or death to your child. You must read and understand the Rear-Facing instructions and the instructions in the User Guide. If you do not understand these instructions, STOP and call Chicco at 1-877-424-4226.

SS0041E_04 INSTRUCTIONS: **Fit360** Car Seat Mirror IMPORTANT: P...

lang:en **score:50** filesize: 571.42 K page_count: 2 document date: 2023-12-19



[\[pdf\]](#) User Manual Installation Guide Guide Catalog Label Recall

Fit360® Zip Rotating Convertible Car Seat 2025Chicco Product Manuals Seats Strollers and moreChicco

Fit360 Manual 2 0chiccousa on demandware static Sites Chicco Library default dw046cc029 manuals car seats ManualChicco moreFit360 ClearTex Jet ChiccoChicco 0Chicco chicco catalog dwfddb0fd0 images products ||| ||| ZIP For future use, store user guide in compartment at front of base. IS0252E_02 04/25 c

2025 Artsana USA, Inc. User Guide If you have any problems with your Chicco Child Restraint, or any questions regarding installation or use, please cal

ZIP For future use, store user guide in compartment at front of base. IS0252E_02 04/25 c 2025 Artsa ... Release Handle Bubble Level Indicator Each Side Ready to Ride Indicator 18 Seat Lock Release **Fit360** Mirror included See **Fit360** Mirror instructions for proper use Shoulder Belt Path LeverLock ...

lang:en **score:50** filesize: 4.92 M page_count: 61 document date: 2025-06-27

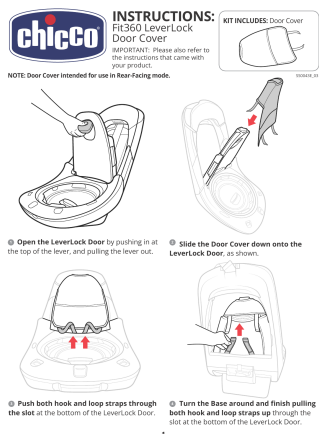

[\[pdf\]](#) User Manual Instructions Accessories Catalog

INSTRUCTIONS Fit360 LeverLock Door Cover ChiccoWARNING DO NOT use in Forward Facing mode

If you have a problem retry these instructions provided AND review your User GuideChicco Product Manualchiccousa on demandware static Sites chicco catalog default dwf333c521 images products Manuals car seats Chicco Manual srsItid AfrmBOOrLBtg2veKOmgZPGDmAHPCgEiZlwyuSIAbiT yyfuoTJyuUrRq ChiccoChicco ManualWARNING GuideFit360 Accessory Black ManualChicco yyfuoTJyuUrRqchiccousa ||| ||| INSTRUCTIONS: Fit360 LeverLock Door Cover IMPORTANT: Please also refer to the instructions that came with your product. NOTE: Door Cover intended for use in Rear-Facing mode. KIT INCLUDES: Door Cover SS0043E_03 1 Open the LeverLock Door by INSTRUCTIONS: **Fit360** LeverLock Door Cover IMPORTANT: Please also refer to the instructions that came with your product. NOTE: Door Cover intended for use in Rear-Facing mode. KIT INCLUDES: Door Cover SS0043E_03 1 Open the LeverLock Door by pushing in at 2 Slide the Door Cover down onto the the top... lang:en score:49 filesize: 1.07 M page_count: 2 document date: 2024-06-18

[\[pdf\]](#) User Manual Installation Guide Guide Label Recall

Fit360® Zip Rotating Convertible Car Seat Product Support Manuals Chicco Fit360 Manual chiccousa on demandware static Sites Library default dw8820825d manuals car seats |||

ZIP For future use, store user guide in compartment at front of base. IS0237E_02 08/24 c 2024 Artsa ... Release Handle Bubble Level Indicator Each Side Ready to Ride Indicator 18 Seat Lock Release **Fit360** Mirror included See **Fit360** Mirror instructions for proper use Shoulder Belt Path LeverLock ... lang:en score:46 filesize: 5.36 M page_count: 64 document date: 2024-11-01

[\[pdf\]](#) Installation Guide Guide Catalog Label Recall

Fit360® Zip Rotating Convertible Car Seat 2025Chicco Product Manuals Seats Strollers and moreChicco Fit360 022025chiccousa on demandware static Sites Chicco Library default dwc56641c5 manuals car seats 022025 ManualChicco moreFit360 ClearTex ChiccoChicco 022025Chicco chicco catalog dwb998025b images products 2025Fit360® ManualUser GuideChicco srsItid AfrmBOoqxGspORFQFhFQziQT8jef Mkl7I76FyEeyoNFqrCmniKJosdQb GuideUser Mkl7I76FyEeyoNFqrCmniKJosdQbchiccousa AfrmBOOpzLrH0cUZ

2YcGf7vhCb17zp7yr9WhfT7gVxu4PQuFkQPoS9aX ||| ||| For future use, store user guide in compartment at front of base. IS0248E_03 02/25 c 2025 Artsana USA, Inc. User Guide If you have any problems with your Chicco Child Restraint, or any questions regarding installation or use, please call: ||| For future use, store user guide in compartment at front of base. IS0248E_03 02/25 c 2025 Artsana USA, Inc. User Guide If you have any problems with your Chicco Child Restraint, or any questions regarding installation or use, please call: ||| For future use, store user guide in compartment at front of base. IS0248E_03 02/25 c 2025 Artsana USA, Inc. User Guide If you have any problems with your Chicco Child Restraint, or any questions regarding installation or use, please call:

For future use, store user guide in compartment at front of base. IS0248E_03 02/25 c 2025 Artsana ... the Child Restraint could increase the child s risk of serious injury or death. 2 To install the **Fit360** to the vehicle, the seat must be removed from the Base. The Base can be installed using Lap/S...

lang:en score:45 filesize: 4.78 M page_count: 60 document date: 2025-03-06





[\[pdf\]](#) Installation Guide Guide Label Recall

Fit360™ Rotating Convertible Car Seat Product Support Manuals Chicco Fit360 chiccoua on demandware static Sites Library default dwa added 696c manuals car seats |||

For future use, store user guide in compartment at front of base. IS0224E_04 02/24 c 2024 Artsana U ... the Child Restraint could increase the child s risk of serious injury or death. 2 To install the **Fit360** to the vehicle, the seat must be removed from the Base. The Base can be installed using Lap/S...

lang:en score:43 filesize: 5.27 M page_count: 63 document date: 2024-04-08

[\[pdf\]](#) Installation Guide Guide Label Recall

User Guide Chicco To install the Fit360 to vehicle seat must be removed from Base The can installed using Lap Shoulder Belt Install LATCH or Lap Chicco Car Seat chiccoua on demandware static Sites Chicco Library default dwd2d46554 manuals car seats Seat srs ltid AfmBOopAUtE242WBTEc9klgeiuejep G2pwGpXNI6EKGKV0laAniJAoh Chicco User Lap With Crotch Strap in Position 1 a forward through Compartment b and pull into 2 c Chicco Seat Chicco G2pwGpXNI6EKGKV0laAniJAoh chiccoua dw8f7e0edb AfmBOop8D03xbBBypfVHQ4 2Mo9tnk88LFSEJxnabSFYIFlzB57mE1FR c Rotate face door then loosen Harness by pressing Release Button front of Child Restraint pulling on Chicco 2Mo9tnk88LFSEJxnabSFYIFlzB57mE1FR chiccoua

AfmBOooZri9kAjGWgrFJg5H91oEhhTCYDB6mVliWRQK6iHs G7dtpP c on The Lock will click when fully pressed Squeeze BOTH Handles lift up remove Set seat Chicco chiccoua AfmBOop rb8NMRxollgy20lvulEfVYc1iDLWXRIsujsNeSBIXgAZDD8Q Fit360® Rotating Convertible 2024 2025 User

Chicco Chicco Product Manuals Seats Strollers more To ||| ||| For future use, store user guide in compartment at front of base. IS0224E_05 02/24 c 2024 Artsana USA, Inc. User Guide If you have any problems with your Chicco Child Restraint, or any questions regarding installation or use, please call: C ||| For future use, store user guide in compartment at front of base. IS0224E_05 02/24 c 2024 Artsana USA, Inc. User Guide If you have any problems with your Chicco Child Restraint, or any questions regarding installation or use, please call: C ||| For future use, store user guide in compartment at front of base.

IS0224E_05 02/24 c 2024 Artsana USA, Inc. User Guide If you have any problems with your Chicco Child Restraint, or any questions regarding installation or use, please call: C ||| For future use, store user guide in compartment at front of base. IS0224E_05 02/24 c 2024 Artsana USA, Inc. User Guide If you have any problems with your Chicco Child Restraint, or any questions regarding installation or use, please call: C For future use, store user guide in compartment at front of base. IS0224E_05 02/24 c 2024 Artsana U ... he Child Restraint could increase the child s risk of serious injury or death. 2 To install the **Fit360** to the vehicle, the seat must be removed from the Base. The Base can be installed using Lap/S...

lang:en score:42 filesize: 4.82 M page_count: 60 document date: 2025-01-10

[\[pdf\]](#) Installation Guide Guide Label Recall

Fit360® Rotating Convertible Car Seat 2025 Chicco Product Manuals Seats Strollers and more Chicco Fit360 022025 chiccoua on demandware static Sites Chicco Library default dwd20b5249 manuals car seats 022025 |||

For future use, store user guide in compartment at front of base. IS0248E_05 02/25 c 2025 Artsan ... he Child Restraint could increase the child s risk of serious injury or death. 2 To install the **Fit360** to the vehicle, the seat must be removed from the Base. The Base can be installed using Lap/S...

lang:en score:42 filesize: 4.78 M page_count: 60 document date: 2025-07-25



[\[pdf\]](#) User Manual Installation Guide Guide Label Recall

User Guide ChiccoNEVERinstall on a rear facing or side vehicle seat the back of folded down
ALWAYSsecure this Child Restraint with s Chicco Fit360 Car SeatChiccousa demandware static Sites
Chicco Library default dwd2d46554 manuals car seats Seat srsItid AfmBOooEJoS
GpfvKGIZqpTqDsJgi1halmRohgrrZRGzO B6bb 1iNet ChiccoUser s Then rotate into Rear Facing
Forward position Make sure Ready to Ride Indicator is GREEN and not RED If to Chicco SeatChicco
1iNetchiccousa AfmBOoofTv7S8 XsjIHlo xWO0F LwsK7 hA5lyyjC XgDyP ULavXq ChiccoManual de
intruccionesNEVERinstall to Fit360 ClearTexChicco Seat06079690950070 manual Manual
intruccionesESchiccousa ULavXqcdn artsana assets chicco 06079690950070 intruccionesES ts
1729617614513 intruccionesUser ClearTexThis for children 4 65 lbs 49 inches less Follow guide ensure
proper installation that child properly secured Your Chicco intruccionesESChicco
1729617614513chiccousa AfmBOorP7QRXfCpwGDbtX8L0pYpvKa7woN3fluuBN5N hTMWdM8p65k4 If
it permitted raise headrest move different seating location Adjust Head Rest its highest Chicco
hTMWdM8p65k4chiccousa AfmBOorHVPceqcO J8B 5hM3Bh7MhLW7VGA941jiROvhc6NC07guAZKq
highest Install using LATCH instead suitable belt type Ensure s Safety When Using NEVER leave Chicco
5hM3Bh7MhLW7VGA941jiROvhc6NC07guAZKqchiccousa AfmBOopSYVAI bTvuCl6CsUbfUdyk
EgvRKfG5vN1PHbZWtY5QRBCbhj leave DO NOTinstall an inflatable The interaction portion can Chicco
EgvRKfG5vN1PHbZWtY5QRBCbhjchiccousa AfmBOop98qV8fp 0r2aComRDy6mevE9SPkMLWS
nEqVLoYGvle6fonD5 USAManual intruccionesFor vehicles air bags refer your owner information restraint
ALWAYS install Child NEVERinstall AfmBOorUPfk3yfVFHbJpxS

XVYHmWTTdH65K7eLKpiSFBvLIAq3t7sGACHiccousa ||| ||| For future use, store user guide in
compartment at front of base. IS0224E_04 02/24 c 2024 Artsana USA, Inc. User Guide If you have any
problems with your Chicco Child Restraint, or any questions regarding installation or use, please call: C |||
For future use, store user guide in compartment at front of base. IS0224E_04 02/24 c 2024 Artsana USA,
Inc. User Guide If you have any problems with your Chicco Child Restraint, or any questions regarding
installation or use, please call: C ||| For future use, store user guide in compartment at front of base.
IS0224E_04 02/24 c 2024 Artsana USA, Inc. User Guide If you have any problems with your Chicco Child
Restraint, or any questions regarding installation or use, please call: C ||| For future use, store user guide
in compartment at front of base. IS0224E_04 02/24 c 2024 Artsana USA, Inc. User Guide If you have any
problems with your Chicco Child Restraint, or any questions regarding installation or use, please call: C |||
For future use, store user guide in compartment at front of base. IS0224E_04 02/24 c 2024 Artsana USA,
Inc. User Guide If you have any problems with your Chicco Child Restraint, or any questions regarding
installation or use, please call: C ||| For future use, store user guide in compartment at front of base.
IS0224E_04 02/24 c 2024 Artsana USA, Inc. User Guide If you have any problems with your Chicco Child
Restraint, or any questions regarding installation or use, please call: C ||| For future use, store user guide
in compartment at front of base. IS0224E_04 02/24 c 2024 Artsana USA, Inc. User Guide If you have any
problems with your Chicco Child Restraint, or any questions regarding installation or use, please call: C
For future use, store user guide in compartment at front of base. IS0224E_04 02/24 c
2024 Artsana U ... the Child Restraint could increase the child s risk of serious injury
or death. 2 To install the **Fit360** to the vehicle, the seat must be removed from the
Base. The Base can be installed using Lap/S...

lang:en score:42 filesize: 5.27 M page_count: 63 document date: 2024-04-08

[\[pdf\]](#) User Manual Catalog

Manual de uso Chicco USA chiccousa aº car seats C Fit360 Car Seat Spanish on demandware static
Sites chicco catalog default dwb19710fc images products Manuals |||
LEA EL MANUAL DE USO antes de utilizar este sistema de seguridad para nios.
Asiento de seguridad co ... recta podra aumentar el riesgo de sufrir lesiones 2 graves
o incluso la muerte. Para instalar el **Fit360** en el vehculo, debe quitar el asiento de la
base. La base se puede instalar con el mtodo de i...

lang:es score:39 filesize: 5.44 M page_count: 64 document date: 2023-12-15



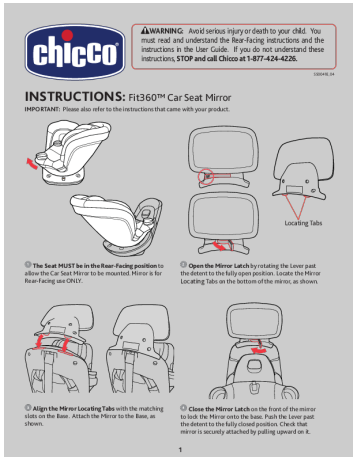

[\[pdf\]](#) Instructions

Fit360™ Car Seat Mirror Product Support Manuals Chicco Fit360 chiccousa on demandware static Sites Library default dwbbd36d00 manuals car seats |||

WARNING: Avoid serious injury or death to your child. You must read and understand the Rear-Facing instructions and the instructions in the User Guide. If you do not understand these instructions, STOP and call Chicco at 1-877-424-4226.

SS0041E_04 INSTRUCTIONS: **Fit360™** Car Seat Mirror IMPORTANT: Pl...

lang:en **score:33** filesize: 571.42 K page_count: 2 document date: 2023-12-19

[\[pdf\]](#) User Manual Catalog

Manual de uso ChiccoPara ajustar el arnés tire lentamente la correa ajuste del hasta que quede presionado sobre niño a Si puede doblar en Chicco Fit360 Car Seat Spanishchiccousa on demandware static Sites chicco catalog default dwb19710fc images products Manuals car seats Chicco Spanish srsItid AfmBOoo13aZft6BbQv8kAkH 7NuBrwykyC0XJ9GfecYcwvMhyiainh8 ChiccoManual en Pase entrepierna por abertura correcta en almohadilla parte inferior asiento y vuelva colocar parte Chicco SpanishChicco 7NuBrwykyC0XJ9GfecYcwvMhyiainh8chiccousa

AfmBOopp20EmABOe4C3EV4BrafloqrXEnlhaGBDvrPiri7Flo7kz4Scg parte Para quitar base ubique presione primero manija liberación como se muestra Gire hacia punto medio y Chicco

AfmBOopp20EmABOe4C3EV4BrafloqrXEnlhaGBDvrPiri7Flo7kz4Scgchiccousa

AfmBOOrKlfp8Oe9snwB2cx8dcxuFba4gad7yMBy9ToVOLziS3Z 0a48u ||| ||| LEA EL MANUAL DE USO

antes de utilizar este sistema de seguridad para nios. Asiento de seguridad convertible giratorio Para uso futuro, guarde este manual de uso en el compartimiento de la parte delantera de la base. IS0224S_04 08/23 c 2023 ||| LEA EL MANUAL DE USO antes de utilizar este sistema de seguridad para nios. Asiento de seguridad convertible giratorio Para uso futuro, guarde este manual de uso en el compartimiento de la parte delantera de la base. IS0224S_04 08/23 c 2023

LEA EL MANUAL DE USO antes de utilizar este sistema de seguridad para nios.

Asiento de seguridad co ... recta podra aumentar el riesgo de sufrir lesiones 2 graves o incluso la muerte. Para instalar el **Fit360** en el vehculo, debe quitar el asiento de la base. La base se puede instalar con el mtodo de i...

lang:es **score:30** filesize: 5.44 M page_count: 64 document date: 2023-12-15

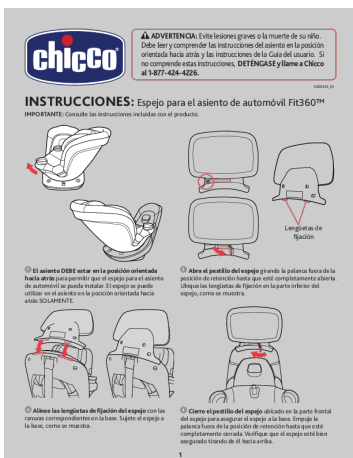

[\[pdf\]](#)

Click here for Spanish version Product Support Manuals Chicco Fit360 Mirror chiccousa on demandware static Sites Library default dwa9fc1cc0 manuals car seats |||

ADVERTENCIA: Evite lesiones graves o la muerte de su nio. Debe leer y comprender las instrucciones d ... SE y llame a Chicco al 1-877-424-4226. SS0041S_01

INSTRUCCIONES: Espejo para el asiento de automvil **Fit360™** IMPORTANTE:

Consulte las instrucciones incluidas con el producto. Lengetas de fijacin 1 E...

lang:es **score:30** filesize: 572.98 K page_count: 2 document date: 2024-10-11



[\[pdf\]](#) User Manual

FIT360 Stand Alone Base Manual Hebrew Arabic 360 פִּיט360 סֵא בִּטִּיחוֹת צִיָּקוּ מִסְתוּבֵּב לִכִּסֵּא בִּטִּיחוֹת

Chicco Fit360 Rotating Convertible Car Seat ClearTex כיסא קלירטקס הרשת עגליס מתפשרת! באיכות בלתי מתפשרת! עגליס

And agalease baby co il 2025 01 המובילה למוצרי תינוקות עגלות לתינוקות חבילות לידה מושבי ריהוט ומשחקים

|||

...

lang:es score:17 filesize: 5.71 M page_count: 32 document date: 2025-01-30