

UNITOPSCI B0FMXTY3S8

UNITOPSCI 8 Core 4G+64G Android 15 Car Stereo User Manual

Model: B0FMXTY3S8 | Brand: UNITOPSCI

1. INTRODUCTION

This manual provides detailed instructions for the installation, operation, and maintenance of your UNITOPSCI 8 Core 4G+64G Android 15 Car Stereo. Please read this manual thoroughly before using the product to ensure proper function and safety. Keep this manual for future reference.

2. SAFETY INFORMATION

- **Professional Installation Recommended:** Installation of this car stereo requires technical knowledge and experience. It is highly recommended to have it installed by a qualified professional.
- **Vehicle Compatibility:** This unit is designed specifically for Honda Civic models from 2013 to 2017. Verify compatibility with your vehicle's center console before installation.
- **Power Supply:** Ensure the vehicle's power supply is disconnected before beginning installation to prevent electrical shock or damage.
- **Wiring:** Follow the provided wiring diagram carefully. Incorrect wiring can cause damage to the unit or vehicle.
- **Operation While Driving:** Do not operate the unit in a manner that distracts you from driving. Always prioritize road safety.
- **Temperature:** Avoid exposing the unit to extreme temperatures or direct sunlight for prolonged periods.

3. PACKAGE CONTENTS

Verify that all items are present in the package:

- 1 x Car Radio
- 1 x Power Cable
- 1 x Car Rear View Camera
- 1 x Installation Tool Set
- 1 x GPS Antenna
- 1 x Rear Camera Input Cable

- 1 x RCA Cable
- 2 x USB Cable
- 1 x User Manual
- 1 x Microphone
- 1 x Original Car USB & Radio Adapter Cable
- 1 x Canbus Decoder



Figure 3.1: Package contents and unit dimensions. The image displays the main unit with dimensions (375mm width, 231mm height, 274mm base width) and an array of accessories including the AHD rear camera, various cables (power, RCA, USB, camera input), GPS antenna, microphone, installation tools, Canbus, and user manual.

4. PRODUCT OVERVIEW

4.1 Key Features

- **Operating System:** Android 15
- **Processor:** Qualcomm 8-Core Chip
- **Memory:** 4GB RAM + 64GB ROM
- **Display:** 9-inch 1280x720P IPS Capacitive Touchscreen
- **Connectivity:** Bluetooth 5.1, Dual-Band WiFi (2.4GHz & 5GHz)

- **Smartphone Integration:** Wireless/Wired Apple CarPlay, Wireless/Wired Android Auto, Mirror Link
- **Audio:** Built-in DSP (Digital Sound Processor)
- **Navigation:** GPS Navigation (supports online and offline maps)
- **Radio:** FM/RDS Radio
- **Camera Support:** AHD Backup Camera (included)
- **Additional Features:** Steering Wheel Control (SWC), Built-in Cooling Fan, Picture-in-Picture, Customizable UI.

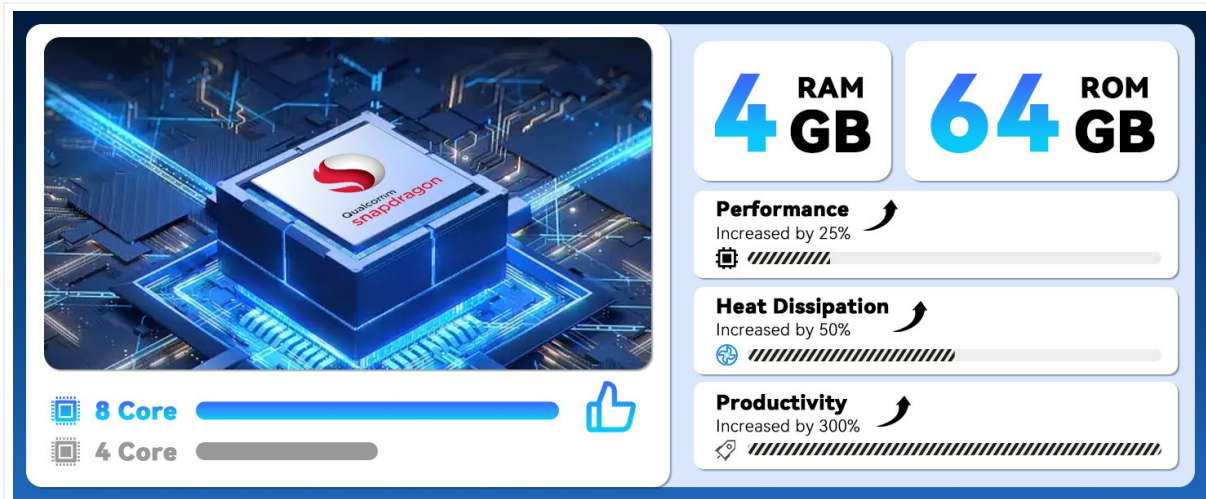

Figure 4.1: Qualcomm 8-Core Chip with 4GB RAM and 64GB ROM. This image illustrates the core processing unit, emphasizing increased performance, improved heat dissipation, and enhanced productivity compared to previous generations.

Android 13

8 Core 4GB+64G

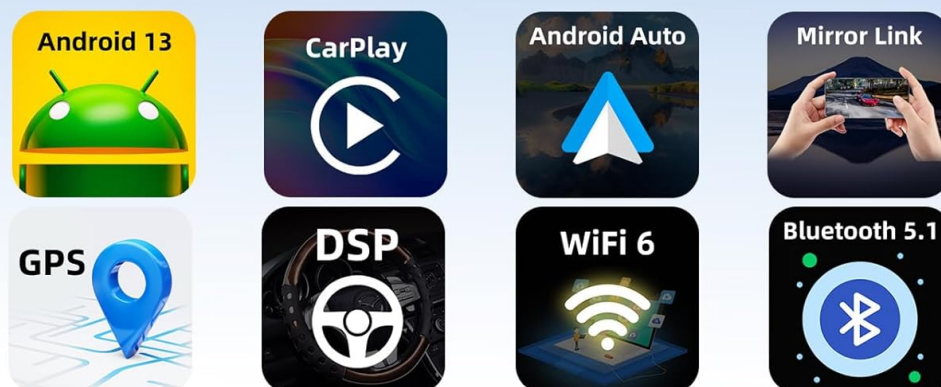

Figure 4.2: Overview of the car stereo's main features. Icons represent Android 15, CarPlay, Android Auto, Mirror Link, GPS, DSP, WiFi 6, and Bluetooth 5.1, indicating the comprehensive capabilities of the unit.

5. INSTALLATION GUIDE

5.1 Pre-Installation Check

Before proceeding with installation, ensure your Honda Civic's center console matches the compatible design. Refer to the image below for guidance.

For Honda Civic 2013-2017

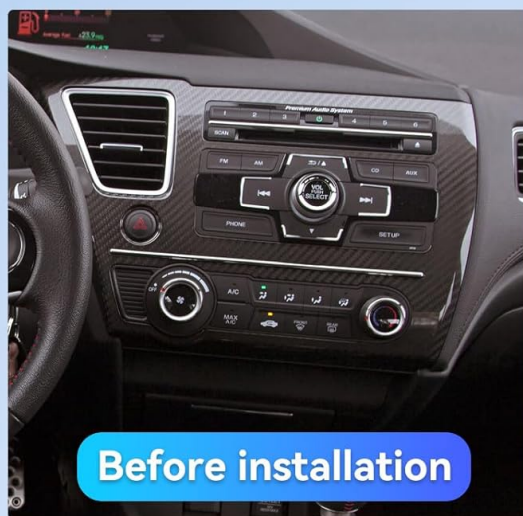

Before purchasing, please select the product based on your original car's central control panel. This product only supports Option A. If you require Option B, please contact our customer service for suitable recommendations.

A: Correct center control panel

B: Wrong center control panel

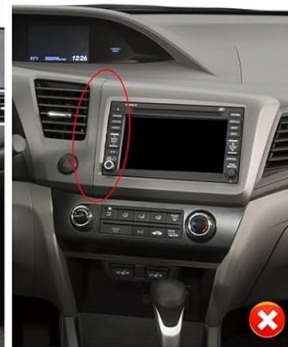

Figure 5.1: Center console compatibility check. This image shows a 'Before installation' view of a Honda Civic dashboard, an 'After installation' view with the new stereo, and a comparison of 'Correct center control panel' (green check) versus 'Wrong center control panel' (red X) to ensure proper fitment.

5.2 Wiring Diagram

A detailed wiring diagram is typically included with your product. Connect the power cable, speaker wires, GPS antenna, USB cables, rear camera input, and other accessories according to the diagram. Ensure all connections are secure to prevent malfunctions.

5.3 Physical Installation

1. Carefully remove the original car stereo and trim panels.
2. Connect the new car stereo's wiring harness to the vehicle's existing harness, matching colors and connectors.
3. Install the GPS antenna in a location with a clear view of the sky.
4. Route the rear camera cable and install the camera (if applicable).
5. Mount the new car stereo securely into the dashboard opening.
6. Reinstall all trim panels.
7. Reconnect the vehicle's power supply.

6. INITIAL SETUP

Upon first power-on, the system may guide you through an initial setup process. This typically includes:

- **Language Selection:** Choose your preferred language.
- **Time and Date:** Set the correct time zone, date, and time.
- **WiFi Connection:** Connect to a stable Wi-Fi network to enable online features and app downloads.
- **GPS Calibration:** Allow the GPS system to acquire satellite signals for accurate positioning.

7. OPERATING INSTRUCTIONS

7.1 User Interface Customization

The car stereo offers various customization options for its user interface.

- **Shaderlab Topics:** Adjust the UI color and font color to your preference.
- **Window Design:** Select from different themes (Card, SplitView, Wallpaper) and layouts for easy operation.
- **3D Car Dynamic Effects:** Customize the displayed 3D car model, including its color and type (Car, MPV, SUV).

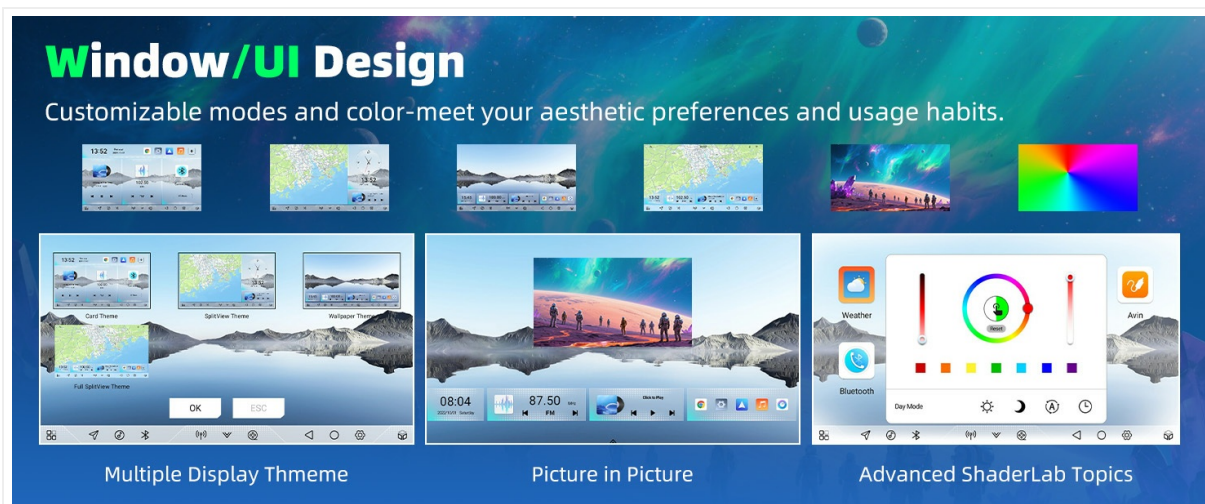

Figure 7.1: User Interface customization options. This image displays multiple UI themes, Picture-in-Picture functionality, and advanced color palette settings for personalizing the display.



Figure 7.2: 3D Car Dynamic Effects. This feature allows users to manually observe a 3D vehicle model from multiple angles and customize its color and type (Car, MPV, SUV) on the screen.

7.2 Bluetooth 5.1

Connect your smartphone via Bluetooth for hands-free calling, music playback, and access to your phone's contacts and call history. Bluetooth 5.1 offers improved range and stability.



Figure 7.3: Bluetooth 5.1 interface. The image shows the Bluetooth calling screen with a dial pad and the music playback interface, alongside other features like FM/RDS radio, WiFi, and GPS navigation.

7.3 FM/RDS Radio

Tune into your favorite radio stations. The RDS (Radio Data System) feature provides additional information such as station name, song title, and traffic updates where available.



Figure 7.4: FM/RDS Radio interface. This image displays the radio tuning screen, along with visual representations of Steering Wheel Control (SWC) functions and fan cooling settings.

7.4 Wireless CarPlay & Android Auto

Connect your iPhone or Android smartphone wirelessly or via USB to access CarPlay or Android Auto. This allows for hands-free calls, navigation, music streaming, and voice commands (Siri or Google Assistant).



Figure 7.5: Wireless CarPlay and Android Auto. This image illustrates the seamless integration of smartphone interfaces, displaying app icons and voice command capabilities for both CarPlay and Android Auto.

Your browser does not support the video tag.

Video 7.1: Wireless CarPlay Radio Operation Guide with Qualcomm Chips. This video demonstrates the setup and usage of the Wireless CarPlay feature on the UNITOPSCI car stereo, highlighting its responsiveness and ease of use.

7.5 Mirror Link

Mirror Link allows you to display your smartphone screen directly onto the car stereo. Android users can also control their phone applications directly from the car's touchscreen.

7.6 GPS Navigation

The unit supports both online and offline navigation. Connect to Wi-Fi for real-time traffic updates and precise route guidance. Pre-installed maps or downloadable map applications can be used.

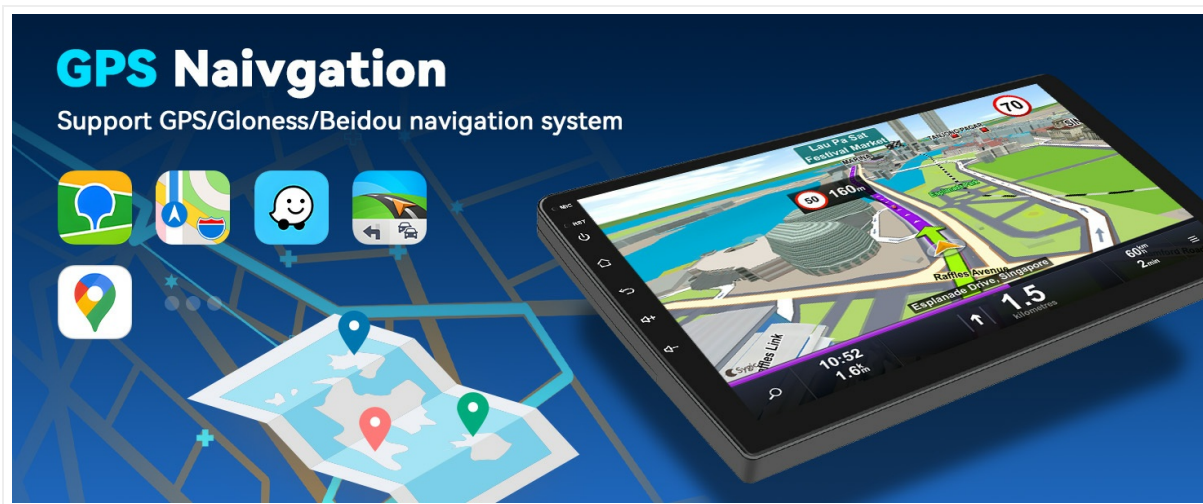

Figure 7.6: GPS Navigation interface. This image shows a navigation map with various map application icons (e.g., Google Maps, Waze), indicating support for multiple navigation systems like GPS, Glonass, and Beidou.

7.7 DSP Audio Processing

The built-in Digital Sound Processor (DSP) allows for advanced audio tuning. Adjust equalization, sound field modes, and speaker settings to achieve strong bass, soft midrange, and clear treble for a personalized audio experience.

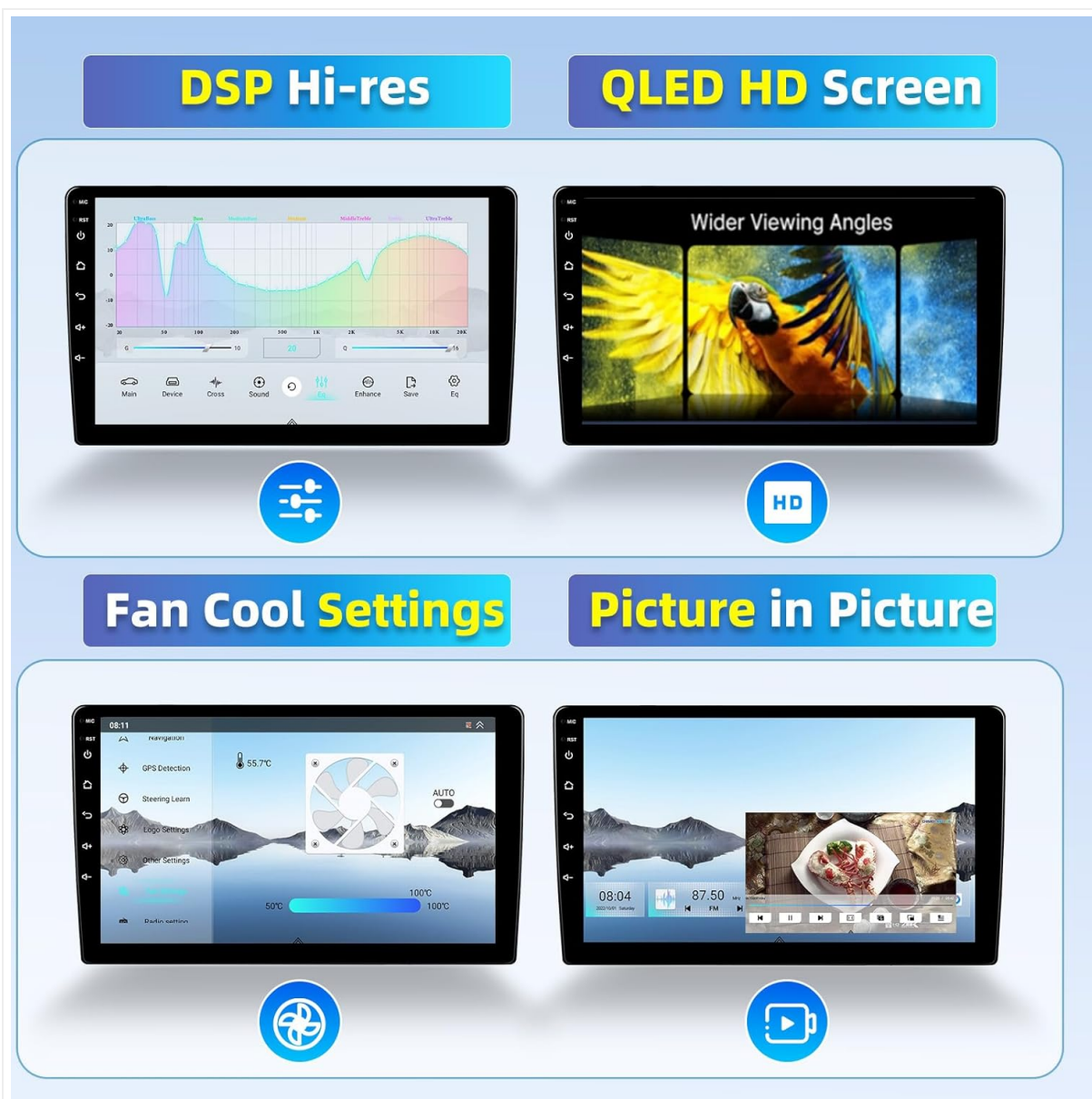

Figure 7.7: DSP Audio Settings. This image displays the DSP interface with various audio adjustment options, including equalization curves, alongside visuals for QLED HD screen, fan cooling, and Picture-in-Picture features.

7.8 Cooling Fan Settings

The integrated cooling fan system helps maintain optimal operating temperature for the radio. You can monitor the temperature and adjust fan settings (e.g., Auto/On) to ensure stable performance.

7.9 Picture-in-Picture (PIP)

The Picture-in-Picture feature allows you to view video content simultaneously while performing other operations, such as navigation or music playback.

7.10 AHD Backup Camera

The included AHD wide-angle backup camera provides clear night vision and is waterproof. It assists with parking by displaying a real-time view of the area behind your vehicle with parking guidelines. *Note: Does not support original car camera.*



Figure 7.8: AHD Rear View Camera features. This image highlights the camera's waterproof design, 170-degree wide angle, HDR capability, and night vision, with an example of parking guidelines on the screen.

7.11 Steering Wheel Control (SWC)

Utilize your vehicle's existing steering wheel buttons to control various functions of the car stereo, such as adjusting volume, changing tracks, and answering calls. This enhances convenience and safety while driving.



Figure 7.9: Steering Wheel Control (SWC) setup. This image illustrates how to map steering wheel buttons to control radio

functions, including call management, volume adjustment, and track navigation.

7.12 Split Screen

The split-screen function allows for simultaneous display of two applications, such as navigation and music, for convenient multitasking.

8. TROUBLESHOOTING

Problem	Possible Cause	Solution
Unit does not power on	Incorrect wiring; Blown fuse; Insufficient power supply.	Check power connections and fuses. Ensure proper voltage. Consult a professional if unsure.
No sound	Speaker wires disconnected; Volume too low; Mute function active.	Verify speaker connections. Increase volume. Deactivate mute. Check DSP settings.
Bluetooth not connecting	Bluetooth off on phone/unit; Device not in pairing mode; Interference.	Ensure Bluetooth is enabled on both devices. Put unit in pairing mode. Try pairing in a different location.
GPS signal lost/inaccurate	GPS antenna obstructed; Antenna faulty; Software issue.	Relocate GPS antenna to a clear area. Check antenna connection. Update navigation software.
Touchscreen unresponsive	System frozen; Screen calibration needed.	Restart the unit. If issue persists, perform a factory reset (refer to settings menu).
Rear camera not displaying	Camera cable disconnected; Camera faulty; Incorrect settings.	Check camera input cable connection. Verify camera power. Ensure reverse gear signal is connected.

9. SPECIFICATIONS

- **Item Weight:** 4.36 pounds
- **Package Dimensions:** 15.35 x 9.65 x 3.35 inches
- **Display Size:** 9 Inches
- **Screen Size:** 9 Inches
- **Operating System:** Android
- **Memory Storage Capacity:** 64 GB
- **Touch Screen Type:** Capacitive
- **Connectivity Technology:** Bluetooth, Wi-Fi
- **Map Type:** North America, Worldwide
- **Audio Output Mode:** Stereo

10. WARRANTY AND SUPPORT

UNITOPSCI offers the following support for this product:

- **Warranty:** 1-Year Manufacturer's Warranty.
- **Money-Back Guarantee:** 30-day money-back service.
- **Replacement Service:** 12-month replacement service.

- **After-Sales Support:** Dedicated 24/7 professional after-sales team available to assist with installation or usage inquiries.

For online support, please contact: UNITOPSCI@126.com