



Manuals.plus /

› Krunia /

› Krunia T93 9.26" Portable Car Display with 4K Dash Cam and HD Backup Camera User Manual

Krunia T93

Krunia T93 9.26" Portable Car Display with 4K Dash Cam and HD Backup Camera User Manual

Model: T93

1. INTRODUCTION

This manual provides comprehensive instructions for the Krunia T93 9.26" Portable Car Display. This device integrates advanced features such as wireless Apple CarPlay and Android Auto, a 4K front dash camera, and an HD backup camera to enhance your driving experience with navigation, communication, and safety functionalities.

2. PACKAGE CONTENTS

Verify that all items listed below are included in your package:

- 9.26" Portable Car Screen with Dash Cam
- Car Charger (3m / 9.84ft)
- AUX Audio Cable (1.5m / 5ft)
- Rear Camera (7.5m / 24.61ft)
- Rear Camera Adhesive (x2)
- Rear Camera Screws (x4)
- Suction Cup Bracket
- Adhesive Bracket
- Installation Accessories
- Wire Clips (x4)
- User Manual

Package Contents



9.26" Portable Car Screen
Car Charger (9.84ft)
AUX Cable(5ft)
Rear Camera(24.61ft)

Adhesive Bracket
Suction Cup Bracket
Rear Camera Adhesive*2
Rear Camera Screws*4

Adhesive Gasket
Screwdriver
User Manual

Image: Krunia T93 Package Contents. This image displays all the items you should find in the product box, including the main screen unit, cameras, cables, and mounting hardware.

3. SETUP AND INSTALLATION

3.1 Mounting the Screen

The Krunia T93 offers flexible mounting options using either a suction cup bracket or an adhesive base. Choose the method that best suits your vehicle and ensures a clear view without obstructing driving.

Adhesive Base Installation:

1. Clean the dashboard surface thoroughly and allow it to dry for 24 hours.
2. The adhesive base is pre-attached to the screen. Peel off the protective film from the adhesive.
3. Press the screen firmly onto the desired dashboard location.



Image: Adhesive Base Installation Steps. This diagram illustrates the process of attaching the screen to the dashboard using the adhesive base.

Suction Cup Bracket Installation:

1. Remove screws and nuts from the adhesive base if it's currently attached to the screen.
2. Install the suction cup base onto the screen using the provided 4 screws and nuts.
3. Clean the windshield or dashboard area where you intend to mount the suction cup.
4. Peel the protective film from the suction cup, press it firmly against the surface, and lock the control lever to secure it.



Image: Suction Cup Installation Steps. This diagram shows how to attach the screen using the adjustable suction cup mount. The suction cup mount features an extendable arm and 360° rotation for optimal positioning and to avoid obstructing your view.

Adjustable & Extendable Suction Mount

Extendable Arm | 360° Rotation | No View Blocking

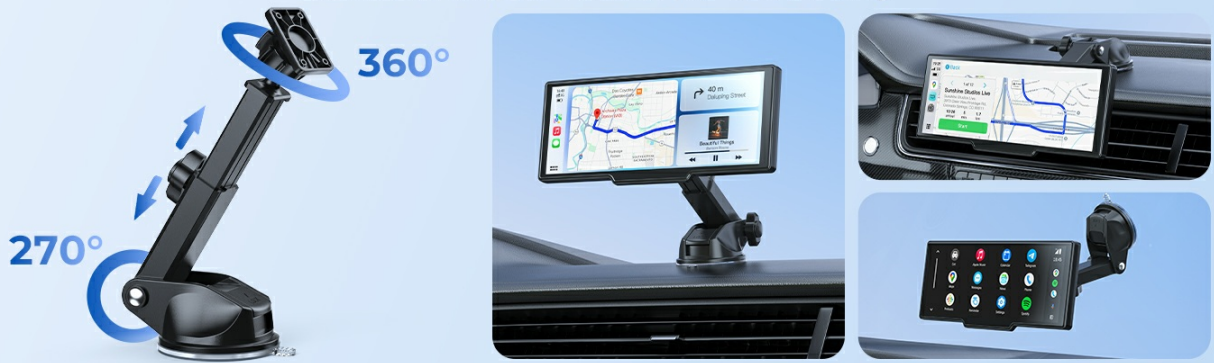

Image: Adjustable Suction Mount. This image highlights the flexibility of the suction cup mount, allowing for various angles and positions.

3.2 Rear Camera Installation

The HD rear camera enhances reversing safety. Connect the rear camera to the smart screen and the reversing light of your vehicle.

1. Connect the rear camera cable to the AV IN port on the smart screen.
2. Route the rear camera cable to the back of your vehicle.
3. Connect the red wire of the rear camera cable to the positive lead of your vehicle's reversing light. This enables automatic display of the rear view when reversing.
4. Mount the rear camera securely at the back of your vehicle using the provided adhesive or screws.

Instant Screen Off & On

One Tap to Save Power and Reduce Distractions



Image: Rear Camera Installation Diagram. This diagram shows the wiring connections for the rear camera to the main screen and the vehicle's reversing light.

3.3 Power Connection

Connect the provided car charger to the Type-C port on the smart screen and plug it into your vehicle's 12-32V power outlet.

4. OPERATING INSTRUCTIONS

4.1 Initial Power On and Screen Control

Once connected to power, the screen will automatically turn on. You can instantly turn the screen off or on with a single tap to save power and reduce distractions.



Image: Instant Screen Off & On. This image demonstrates the quick power control feature of the device.

4.2 Brightness Adjustment

The screen supports both automatic and manual brightness adjustment. An auto-adjusting sensor adapts the brightness to ambient light conditions. You can also use the manual slider for custom brightness settings.



Image: Auto + Manual Brightness Adjustment. This image illustrates the two modes for adjusting screen brightness.

4.3 Audio Output Modes

The Krunia T93 offers four ways to connect to your vehicle's sound system:

- **Built-in Speaker:** For direct audio output from the device.
- **AUX Connection:** Use the provided AUX cable to connect to your car's AUX input.
- **Bluetooth:** Pair the device with your car's Bluetooth system for wireless audio.
- **FM Transmitter:** Transmit audio to your car's FM radio by tuning to a specific frequency.

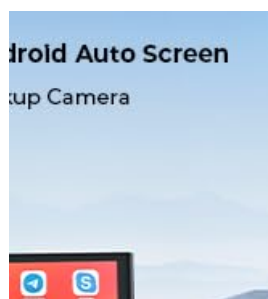

Image: Four Ways to Superior Sound. This image visually explains the various audio connection options available.

4.4 Wireless Apple CarPlay Connection

To use Wireless Apple CarPlay:

1. Ensure your iPhone is running iOS 9 or later.
2. Turn on the microphone and enable Siri on your iPhone for voice control.

3. On the Krunia T93 screen, switch to CarPlay mode.
4. On your iPhone, turn on Wi-Fi and Bluetooth.
5. Select "T93-xxxx" from the Bluetooth devices list on your iPhone and pair it.
6. Confirm "Use CarPlay" when prompted.
7. Connection successful.



Image: Wireless Apple CarPlay Connection Steps. This visual guide outlines the procedure for connecting your iPhone to the display via CarPlay.

4.5 Wireless Android Auto Connection

To use Wireless Android Auto:

1. Ensure your Android phone is running Android 11.0 or newer, or Android 10.0 for Google/Samsung phones, or Android 9.0 for Samsung Galaxy S8, S8+, or Note 8.
2. Update the Android Auto app to the latest version on your phone.
3. On the Krunia T93 screen, switch to Android Auto mode.
4. On your Android phone, turn on Wi-Fi and Bluetooth.
5. Select "T93-xxxx" from the Bluetooth devices list on your Android phone and pair it.
6. Connection successful.



Image: Wireless Android Auto Connection Steps. This visual guide outlines the procedure for connecting your Android phone to the display via Android Auto.

4.6 Wireless Screen Mirroring (AirPlay for iOS / Android Cast)

The device supports wireless screen mirroring for both iOS (AirPlay) and Android (Android Cast).

Wireless AirPlay Mirror Link Steps (iOS):

1. On the Krunia T93 screen, switch to AirPlay mode.
2. On your iPhone, turn on Wi-Fi and connect to the Wi-Fi network named "DY_AP_xxxxxx".
3. Turn on Screen Mirroring on your iPhone and select the device.
4. Connection successful.



Image: Wireless AirPlay Mirror Link Steps. This visual guide outlines the procedure for mirroring your iPhone screen to the display.

Android Cast Connection Steps:

1. On the Krunia T93 screen, switch to Android Cast mode. A QR code will be displayed.
2. Scan the QR code to download the Dylink app on your Android phone.
3. Turn on Wi-Fi on your Android phone.
4. Open the Dylink app and connect to the device named "DY-AP-xxxxxx".
5. Confirm the connection and complete the setup.



Image: Android Cast Connection Steps. This visual guide outlines the procedure for mirroring your Android phone screen to the display.

4.7 Dash Cam and Loop Recording

The Krunia T93 features a 4K front dash cam and an HD rear camera that record simultaneously. The device supports loop recording, ensuring continuous recording by overwriting the oldest footage when the storage card is full. A 64GB card is included, supporting up to 256GB.

- **Segmented Recording:** Footage is saved in segments for easy management.
- **Loop Options:** Choose between 1-minute or 3-minute loop recording intervals.
- **Instant Playback:** Review recorded footage directly on the 9.26" screen.

Wireless Apple CarPlay Connection Steps

Note: 1. Your iPhone must be running iOS 9 or later
2. Turn on the mic and enable Siri to use voice control

1. Switch on CarPlay mode
2. Turn on WiFi and Bluetooth
3. Select "T93-xxxx" and Pair it
4. Select "Use Carplay"
5. Connection successful

Image: Loop Recording. This image illustrates how the loop recording function works, ensuring continuous video capture.

Wireless Android Auto Connection Steps

Note: 1. Any phone running Android 11.0 or newer
2. A Google or Samsung phone with Android 10.0, or a Samsung Galaxy S8, Galaxy S8+, or Note 8 with Android 9.0

1. Switch on Android Auto mode
2. Turn on WiFi and Bluetooth. Update Android Auto app to the latest version
3. Select "T93-xxxx" and Pair it
4. Connection successful

Image: Extended Storage & Instant Playback. This image shows the playback interface and storage capacity information.

4.8 Parking Surveillance (Hardwire Kit Required)

For advanced parking monitoring, connect the device via a hardwire kit (sold separately). This feature enables time-lapse recording to watch over your vehicle when parked.

- Supports 2H, 4H, or 8H time-lapse recording.
- Provides quick review of key events during extended parking periods.

Wireless Screen Mirroring for iOS & Android

Enjoy a cinematic experience on your dashboard



Image: Time-Lapse for Parking Monitoring. This image explains the time-lapse parking surveillance feature.

4.9 Voice Control

Utilize intelligent voice commands for hands-free calls, messages, navigation, and music control. This allows you to stay focused on the road.



Image: Stay in Control with Intelligent Voice Commands. This image demonstrates the voice control features for calls and messages.



Image: Smarter Navigation & Real-Time Traffic Awareness. This image illustrates the voice-controlled navigation features.

4.10 Steering Wheel Control

Maintain full control using your car's existing steering wheel controls to manage volume, tracks, and calls without looking away from the road. This requires your vehicle to have compatible steering wheel controls.

Extended Storage & Instant Playback

Instant Playback on the 9.26" CarPlay Screen
64GB Card Included - Support up to 256GB Card

Recording time varies by scene — more details mean shorter time; simpler scenes last longer



Reach out to us to learn more details on how to get a 256GB Card

Image: Effortless Steering Wheel Control. This image shows how steering wheel controls can be used with the device.

5. MAINTENANCE

5.1 Cleaning the Screen

Use a soft, lint-free cloth to gently wipe the screen. For stubborn smudges, slightly dampen the cloth with water or a screen-safe cleaner. Avoid abrasive materials or harsh chemicals.

5.2 Firmware Updates (OTA)

The Krunia T93 supports Over-The-Air (OTA) updates. These updates automatically deliver the latest firmware, new features, and performance enhancements directly to your device, ensuring it remains current and secure.

Android Cast Connection Steps

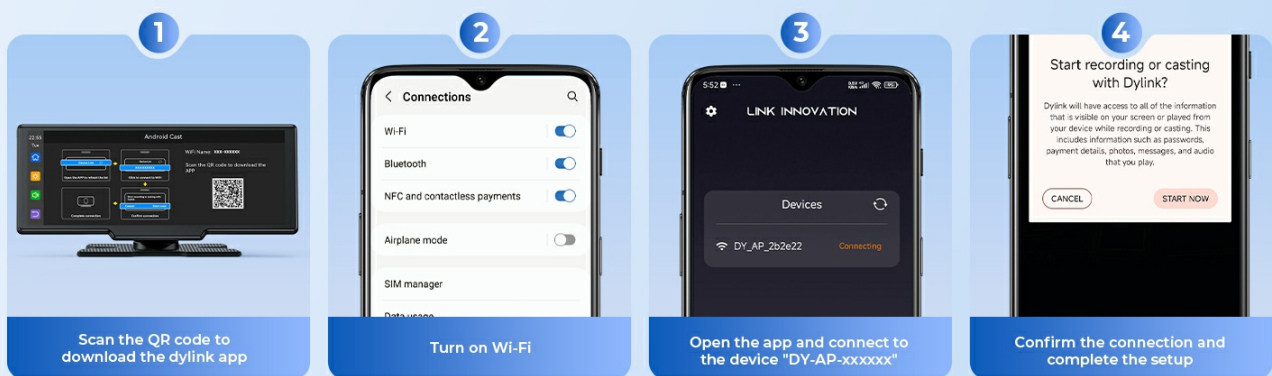

Image: Advanced Screen with OTA Updates. This image highlights the Over-The-Air update capability.

6. TROUBLESHOOTING

Problem	Possible Cause	Solution
Screen does not power on.	No power connection or faulty car charger.	Ensure the car charger is securely plugged into both the screen and the vehicle's power outlet. Check the vehicle's power outlet for functionality.
Wireless CarPlay/Android Auto not connecting.	Incorrect phone settings, Bluetooth/Wi-Fi off, or app not updated.	Verify Wi-Fi and Bluetooth are enabled on your phone. Ensure your phone's OS and CarPlay/Android Auto app are up to date. Follow the connection steps carefully.
No audio or poor audio quality.	Incorrect audio output mode selected, loose AUX cable, or FM interference.	Check the selected audio output mode (Built-in, AUX, Bluetooth, FM). Ensure AUX cable is fully inserted. If using FM, try a different frequency to avoid interference.
Dash cam not recording.	SD card full, faulty SD card, or recording function not activated.	Check if loop recording is enabled. Format the SD card (backup important footage first). Ensure the SD card is properly inserted and functional.
Rear camera not displaying.	Loose connection, incorrect wiring to reversing light, or camera malfunction.	Verify the rear camera cable is securely connected to the AV IN port. Check the wiring to the reversing light. Test the camera connection.

7. SPECIFICATIONS

Feature	Detail
Model Name	T93
Screen Size	9.26 inches
Display Type	IPS Touchscreen
Resolution	1600x600
Brightness	550 cd/m ²
Front Dash Cam	4K (2160p)
Rear Camera	HD
Connectivity	Wireless Apple CarPlay, Wireless Android Auto, Bluetooth 5.0, 5G Wi-Fi, Mirror Link (iOS/Android)
Audio Output Modes	Built-in Speaker, AUX, Bluetooth, FM Transmitter
Storage Support	Up to 256GB (64GB card included)
Operating Temperature	-20°C to 70°C (-4°F to 158°F)
Product Dimensions	0.79 x 9.45 x 4.13 inches
Item Weight	15.9 ounces
Vehicle Compatibility	12-32V vehicles (Cars, SUVs, CRVs, Trucks, Pickups, Mini Vans)

8. WARRANTY AND SUPPORT

8.1 Warranty Information

The Krunia T93 comes with a robust **2-year limited warranty**, ensuring replacement in case of manufacturing defects. Additionally, a **30-day return policy** is available.

8.2 Customer Support

For any inquiries, technical assistance, or support, please contact Krunia customer service. **24/7 online support** is available.

Official Email: service@krunia.com