

Jafānda JF068

Jafānda JF068 Air Purifier Filter Replacement Manual

Model: JF068 | Brand: Jafānda

[Introduction](#)

[Setup](#)

[Operating](#)

[Maintenance](#)

[Specifications](#)

1. INTRODUCTION

This manual provides essential information for the installation, operation, and maintenance of your Jafānda JF068 3-in-1 Air Purifier Filter Replacement. This filter is designed to work with compatible Jafānda air purifiers to enhance indoor air quality by capturing various airborne pollutants.

The JF068 filter features a multi-stage filtration system:

- **Pre-Filter:** Captures large particles such as dust, lint, fibers, hair, and pet fur, extending the life of subsequent filters.
- **True HEPA 13 Filter:** Traps 99.97% of airborne pollutants as small as 0.3 microns, including dust, pollen, and pet dander.
- **Activated Carbon Filter:** Utilizes a catalytic process to effectively absorb household odors, smoke, pet odors, and volatile organic compounds (VOCs).

3-Stage Professional Filtration

HEPA Filter

" Pre-Filter + True HEPA Filter + Activated Carbon Lab-Proven 99.97% Particle Removal")

Pre-Filter

Traps large particles (pet hair, lint) | Can be cleaned with a vacuum cleaner

HEPA Filter

Captures fine particles as small as 0.01 microns (Dust, Pollen, Pet dander)

Activated Carbon Filter

Neutralizes odors (Smoke, VOCs, Pet smells)

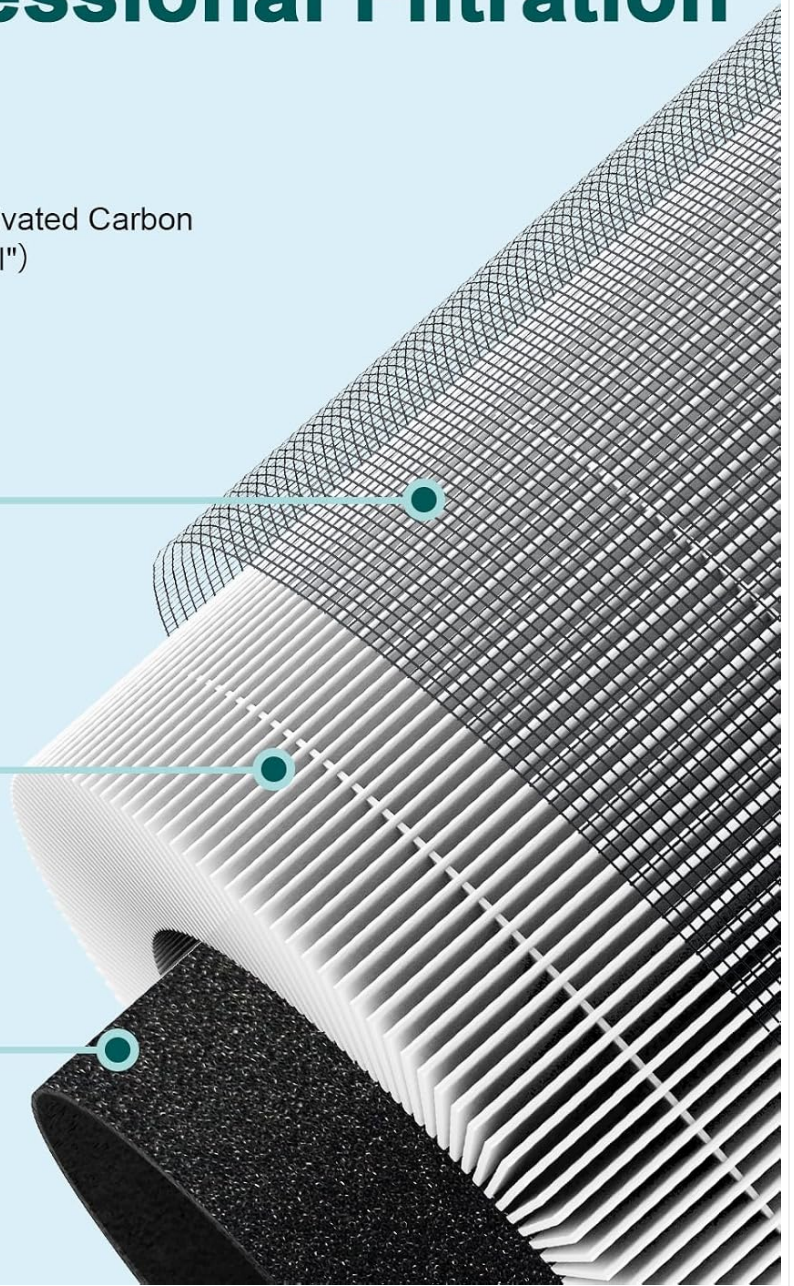

Figure 1: Overview of the 3-Stage Professional Filtration System.

2. SETUP: FILTER INSTALLATION

Follow these steps to correctly install your new Jafānda JF068 filter replacement:

1. **Open the Base:** Gently twist or unlatch the base of your Jafānda air purifier to open it.
2. **Remove Old Filter:** Carefully remove the used filter from the air purifier. It is recommended to wear gloves to avoid contact with accumulated dust and particles.
3. **Discard Plastic Wrap:** Remove all plastic packaging from the new JF068 filter before installation. Failure to do so will prevent proper air circulation and filtration.
4. **Insert New Filter:** Place the new filter into the air purifier, ensuring it is seated correctly and securely.
5. **Tighten the Base:** Close and secure the base of the air purifier.

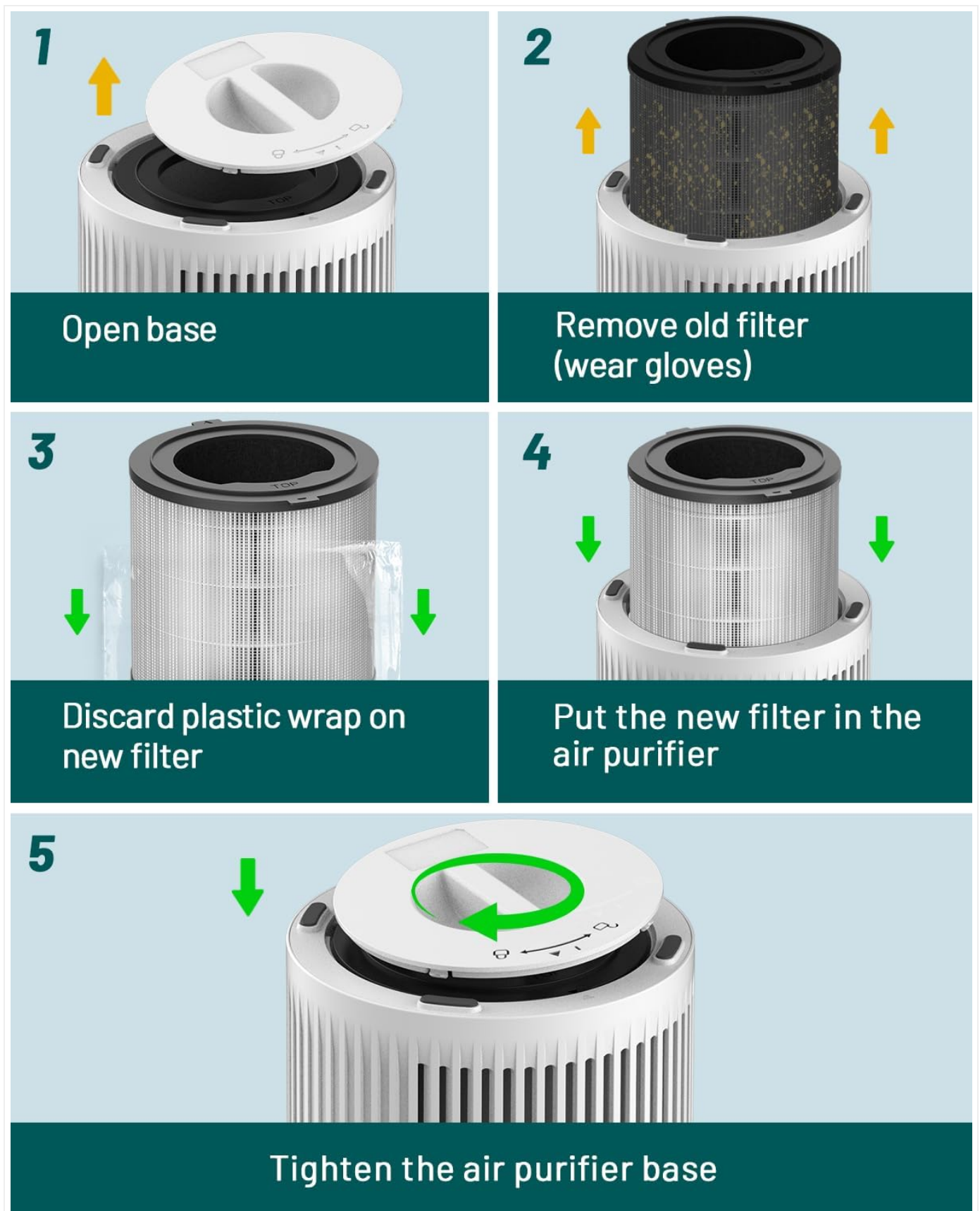

Figure 2: Filter Replacement Steps.

Video 1: Official Jafānda JF068 Air Purifier Filter Installation Guide. This video demonstrates the process of unpacking and installing the JF068 filter into the air purifier, as well as showcasing some of the purifier's features like light settings and fan speeds.

3. OPERATING THE AIR PURIFIER WITH JF068 FILTER

Once the JF068 filter is correctly installed, your Jafānda air purifier is ready for operation. The filter works continuously with the purifier's fan system to circulate and clean the air.

Key Features of the Air Purifier (with JF068 Filter):

- **Fan Speed Settings:** The air purifier typically offers multiple fan speeds (e.g., low, medium, high) to adjust the purification intensity. Select a lower speed for quiet operation, such as during sleep, or a higher speed for faster air cleaning.
- **Night Light/Ambient Lighting:** Many Jafānda air purifiers include a night light feature with multiple color options. This can be used to create a desired ambiance. The light can usually be turned off for undisturbed sleep.
- **Aroma Diffuser:** Some models may include an aroma therapy compartment. You can add essential oils to a pad in this compartment to diffuse scents while the purifier operates.
- **Timer Function:** Set the purifier to operate for a specific duration (e.g., 4, 8, or 12 hours) using the built-in timer.

Genuine JF068 Replacement Filter

Perfect Fit Guaranteed



- ✓ 2,000+ hours lifespan (24/7 use: 4-6 months)
- ✓ Eco-friendly materials
Zero ozone emission
- ✓ 2 filter included per package

Figure 3: Jafānda JF068 Air Purifier with Replacement Filter.

4. MAINTENANCE

Filter Replacement Frequency

For optimal performance and to prevent secondary pollution, replace the Jafānda JF068 filter every **3 to 6 months**. This recommendation is based on laboratory durability tests and assumes 24/7 use. Actual replacement frequency may vary depending

on air quality and usage.

Pre-Filter Cleaning

The pre-filter layer of the JF068 filter can be cleaned periodically to maintain efficiency and extend the life of the entire filter system. Use a soft brush or a vacuum cleaner to remove accumulated large particles like dust and pet fur from the pre-filter surface.

Importance of Genuine Filters

Using genuine Jafānda replacement filters ensures peak airflow efficiency and protects the motor of your air purifier. Counterfeit filters may lead to reduced airflow, overworked motors, and potential secondary pollution due to uncertified materials.

Why Choose Authentic Jafanda Filters?

"Maintain peak airflow efficiency & protect your purifier's motor"

Counterfeit filters may cause:
30%+ airflow reduction → Overworked motor
Uncertified materials → Secondary pollution

New >>> After Use

Figure 4: New vs. Used Filter and Benefits of Authentic Filters.

5. TROUBLESHOOTING

Reduced Airflow or Odors

- **Check Filter Condition:** If you notice a decrease in airflow or persistent odors, the filter may be clogged or saturated.

- **Filter Replacement Indicator:** Your air purifier may have a filter replacement indicator light. If it illuminates or blinks, it's time to replace the filter.
- **Ensure Plastic is Removed:** Double-check that all plastic packaging has been removed from the new filter.

Unusual Noise

- **Filter Seating:** Ensure the filter is correctly seated and the air purifier's base is securely closed. Improper installation can cause vibrations and noise.

6. SPECIFICATIONS

Feature	Detail
Model Number	JF068
Filter Type	3-in-1 (Pre-Filter, True HEPA 13, Activated Carbon)
Product Dimensions	5 x 5 x 9.84 inches (12.7 x 12.7 x 24.99 cm)
Item Weight	10.08 ounces (285.77 grams)
Recommended Replacement	Every 3-6 months (based on 24/7 use)

