

E ECSEM K22, K57 Pro, K55 Charger

E ECSEM Magnetic USB Charging Cable User Manual

For K22, K57 Pro, K55 Military Smart Watches

1. INTRODUCTION

This manual provides instructions for the E ECSEM Magnetic USB Charging Cable, designed as a replacement charger for K22, K57 Pro, and K55 Military Smart Watches. This cable ensures efficient and safe charging for your compatible smartwatch.

Compatibility: This charging cable is specifically designed for the following smartwatches:

- K22 Smart Watch
- K57 Pro Smart Watch
- K55 Military Smart Watch

2. PRODUCT FEATURES

The E ECSEM Magnetic USB Charging Cable incorporates several features for reliable and convenient charging:

- **Magnetic Connection:** Ensures a secure and easy connection to your smartwatch.
- **Durable Material:** Constructed with eco-friendly TPE and TPU materials for flexibility and longevity.
- **Built-in Smart Chip:** Provides multiple protections including over-voltage and over-current protection, contributing to a longer service life for your watch.
- **Stable Performance:** Offers fast charging with small DC ripple and high efficiency.
- **Versatile Power Source:** Can be connected to various USB power sources such as PCs, laptops, power banks, and car chargers.

Multiple Protection



Smart Chip



Light And Portable



Stable Charging



Safe And Efficient



Figure 2.1: Multiple Protection features of the charging cable, including a smart chip for safe and efficient charging.

REINFORCED DESIGN

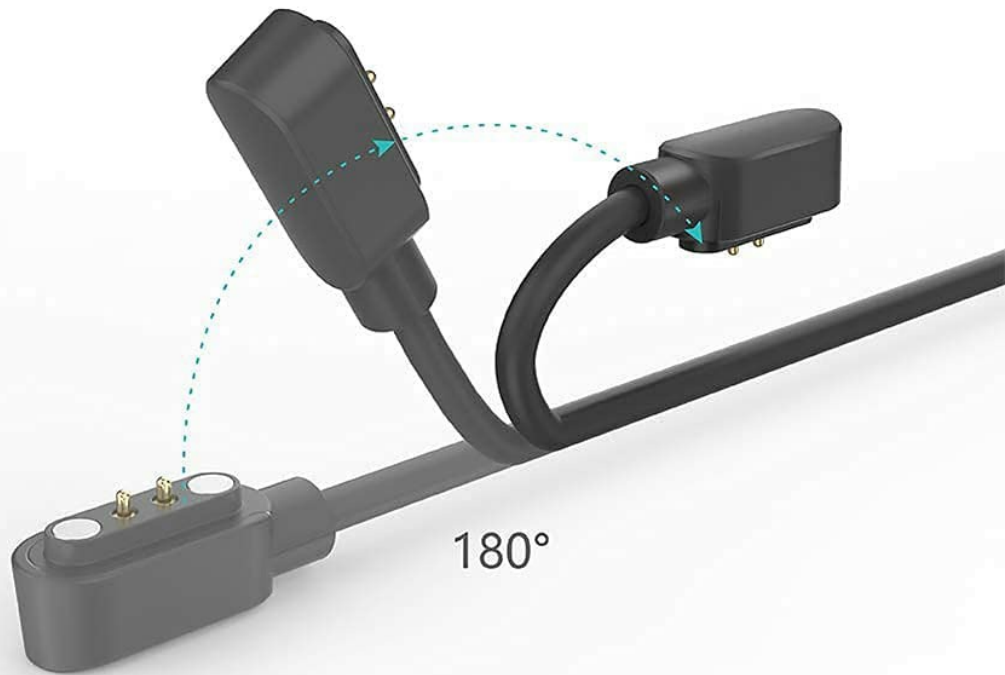

Sturdy Cord



Safe Charging



Figure 2.2: Reinforced design of the cable, highlighting its flexibility and durability against bending.



Ultra Durable

6000+ times bending life

Figure 2.3: The cable is designed for ultra-durability, with a bending life exceeding 6000 cycles.

3. SETUP

To begin charging your smartwatch, follow these steps:

1. Identify the magnetic charging port on your K22, K57 Pro, or K55 Smart Watch.
2. Connect the USB-A end of the charging cable to a compatible USB power source. Recommended sources include:
 - Computer (PC, Mac, Laptop) USB port
 - Power bank

- Car charger
3. Align the magnetic charging pins of the cable with the charging contacts on your smartwatch. The magnetic connection will snap into place.
 4. Ensure the smartwatch display indicates that charging has begun.

Important: Do not use cell phone fast charging adapters. Always connect to a USB power source on a PC, Mac, Laptop, or Notebook for more stable voltage and to protect your watch.

Handy USB Charging

Connect to USB ports on PC, laptop and any USB-enabled devices for stable charging.

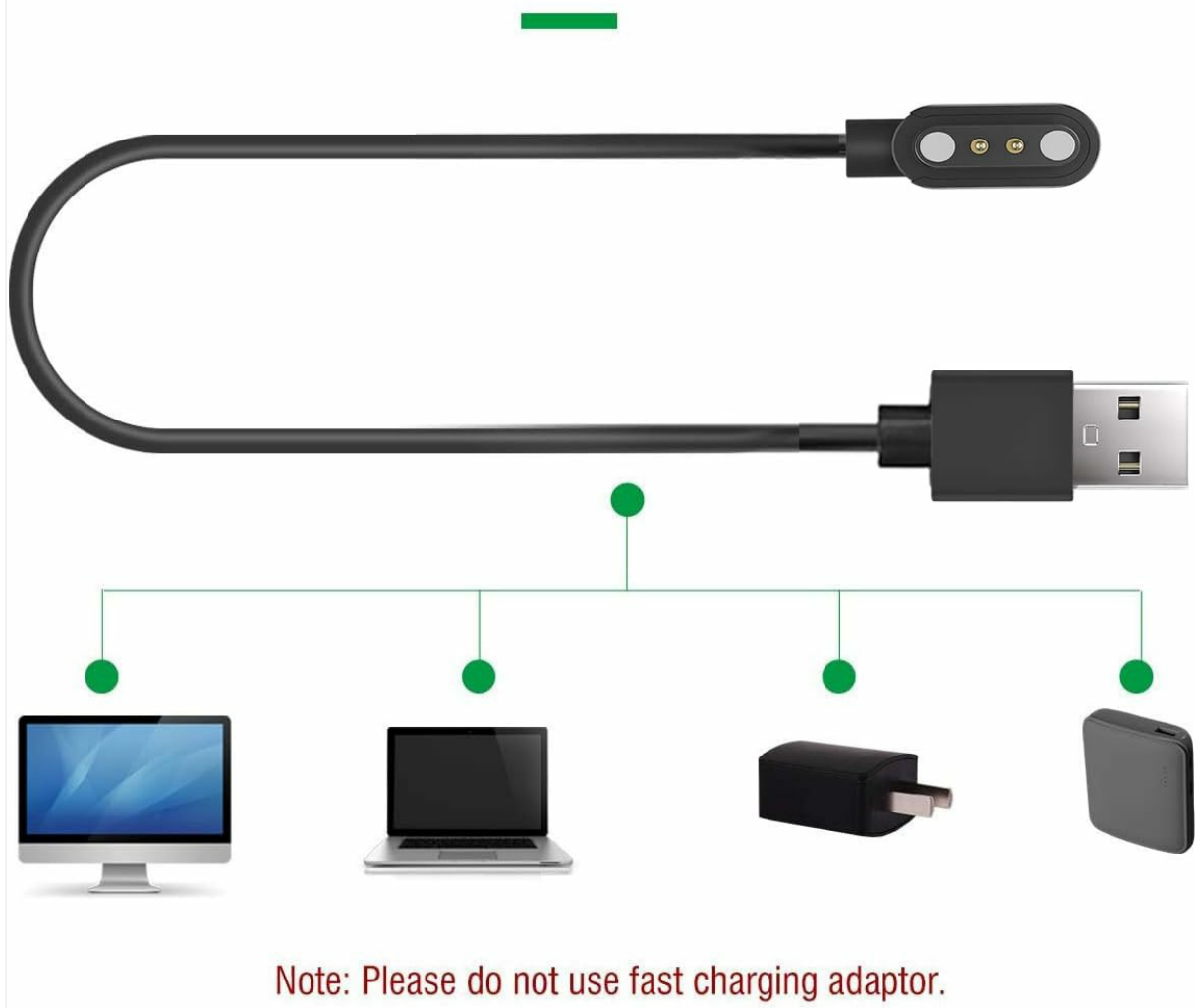

Figure 3.1: Connect the USB end to a compatible USB port for stable charging.

4. OPERATING INSTRUCTIONS

Once connected, your smartwatch will begin charging automatically. Observe the charging indicator on your watch's screen to monitor the charging status.

Tips for Optimal Charging and Watch Protection:

- **Use the Built-in Chip Cable:** The charging cable is equipped with a built-in chip to effectively prolong the service life of your watch by managing power delivery.

- **Limit Recharging Time:** It is recommended to limit recharging time to approximately 80 minutes to prevent overcharging and extend battery health.
- **Charge Before Depletion:** Charge your watch before the battery completely runs down to maintain battery longevity.
- **Avoid Fast Chargers:** Do not use cell phone fast chargers. Always connect to a standard USB power source on a PC, Mac, Laptop, or Notebook for more stable voltage.

5. MAINTENANCE

To ensure the longevity and proper function of your E ECSEM Magnetic USB Charging Cable, follow these maintenance guidelines:

- **Keep Clean:** Periodically wipe the magnetic contacts on both the cable and your smartwatch with a dry, soft cloth to remove dust or debris.
- **Avoid Extreme Conditions:** Do not expose the cable to extreme temperatures, direct sunlight, or excessive moisture.
- **Handle with Care:** While the cable features a reinforced design, avoid sharp bends or excessive pulling on the cable to prevent internal damage.
- **Proper Storage:** When not in use, store the cable in a clean, dry place, away from sharp objects that could damage the insulation.

6. TROUBLESHOOTING

If you encounter issues while charging, consider the following:

- **Watch Not Charging:**
 - Ensure the magnetic connection is secure and properly aligned with the smartwatch's charging contacts.
 - Try a different USB power source (e.g., another USB port on your computer or a different power bank).
 - Check if the charging contacts on both the cable and the watch are clean and free of obstructions.
- **Slow Charging:**
 - Ensure you are using a stable USB power source (PC, laptop). Avoid using wall adapters that may not provide sufficient or stable current.
 - Verify the input current of your USB source is within the recommended range (5V/0.5-1A).
- **Cable Damage:** Inspect the cable for any visible signs of damage, such as frayed wires or bent connectors. If damaged, discontinue use and replace the cable.

7. SPECIFICATIONS

Feature	Specification
Input Voltage/Current	5V / 0.5-1A
Cable Length	60 CM (2 FT)
Connector Type	USB Type-A to Magnetic Pogo Pin

Special Feature	Magnetic Connection, Power Protection (Over-voltage, Over-current)
Material	Eco-friendly TPE and TPU
Compatible Devices	K22, K57 Pro, K55 Military Smart Watch

8. WARRANTY AND SUPPORT

E ECSEM provides the following warranty and support for this product:

- **Money-Back Guarantee:** 30 days from the date of purchase.
- **Warranty Period:** 12 months from the date of purchase.

If you experience any issues with your E ECSEM charging cable, please do not hesitate to contact customer support. We aim to respond to inquiries within 24 hours.