

Manuals+

[Q & A](#) | [Deep Search](#) | [Upload](#)

Manuals.plus /

› [UNITSTAGE](#) /

› UNITSTAGE 10-Tier Tall Shoe Rack with 2 Drawers Instruction Manual

UNITSTAGE 10 Tier

UNITSTAGE 10-Tier Tall Shoe Rack with 2 Drawers Instruction Manual

INTRODUCTION

Thank you for choosing the UNITSTAGE 10-Tier Tall Shoe Rack with 2 Drawers. This manual provides essential information for the safe assembly, proper use, and effective maintenance of your new shoe storage solution. Please read these instructions carefully before beginning assembly and retain them for future reference.

This shoe rack is designed to organize up to 36-40 pairs of shoes and includes two removable fabric drawers for additional storage. Its sturdy metal frame and space-saving design make it suitable for various home environments.



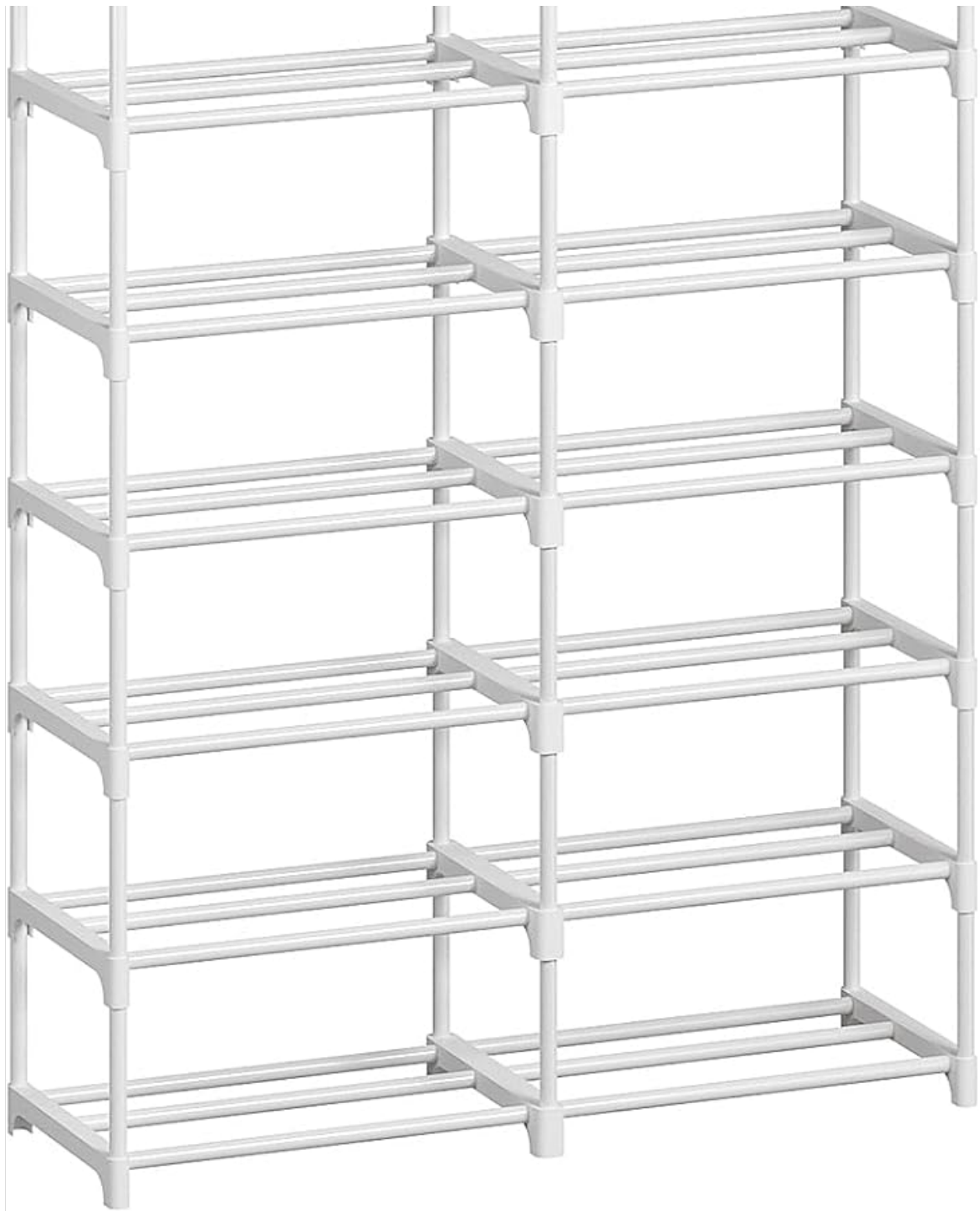

Image: The fully assembled UNITSTAGE 10-Tier Tall Shoe Rack, showcasing its capacity and design.

PRODUCT FEATURES

- **Large Capacity:** Organizes 36-40 pairs of shoes across 10 tiers.
- **Versatile Storage:** Includes 2 removable fabric drawers for accessories, socks, or small items.
- **Durable Construction:** Features a robust powder-coated metal frame and quality plastic connectors for stability.
- **Space-Saving Design:** Tall, compact footprint ideal for entryways, closets, and bedrooms.
- **Customizable Shelves:** Shelves can be removed to accommodate taller footwear like boots.
- **Waterproof Gaskets:** Top PP gaskets provide a waterproof surface, suitable for high heels.
- **Anti-Tip Kit:** Includes an anti-tip kit for enhanced safety and stability.

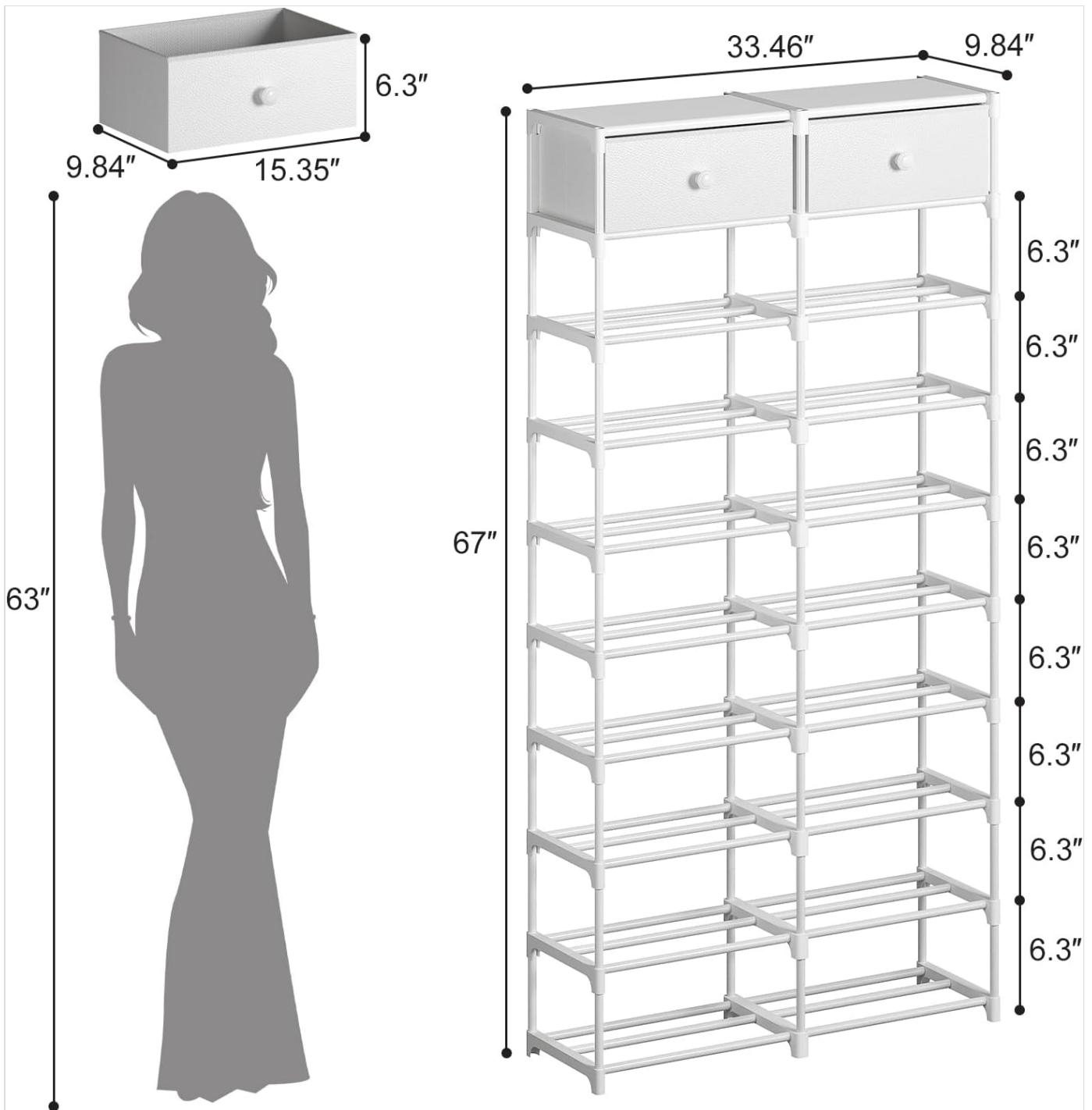

Image: Detailed dimensions of the shoe rack and its drawers.

SETUP INSTRUCTIONS

Assembly is required for this product. Please follow these steps carefully. It is recommended to assemble the unit on a soft, clean surface to prevent scratches.

- 1. Unpack Components:** Carefully remove all parts from the packaging and verify against the parts list (not provided in this manual, refer to your product's included sheet). Ensure all powder-coated metal tubes, plastic connectors, fabric drawers, and the anti-tip kit are present.
- 2. Assemble Frame Sections:** Connect the metal tubes using the plastic connectors to form the vertical and horizontal sections of the rack. Ensure all connections are secure.
- 3. Install Shelves:** Slide the metal shelf bars into the designated slots on the plastic connectors. For taller shoes or boots, you may choose to omit certain shelves during installation.
- 4. Assemble Drawers:** Fold the fabric drawers into shape as shown in the diagram. Insert the bottom panel to secure

the shape.

5. **Place Drawers:** Position the assembled fabric drawers into the top compartments of the shoe rack.
6. **Attach Anti-Tip Kit:** For safety, especially in homes with children or pets, attach the anti-tip kit to the top of the shoe rack and secure it to a wall stud using appropriate hardware (not provided in detail, refer to kit instructions).

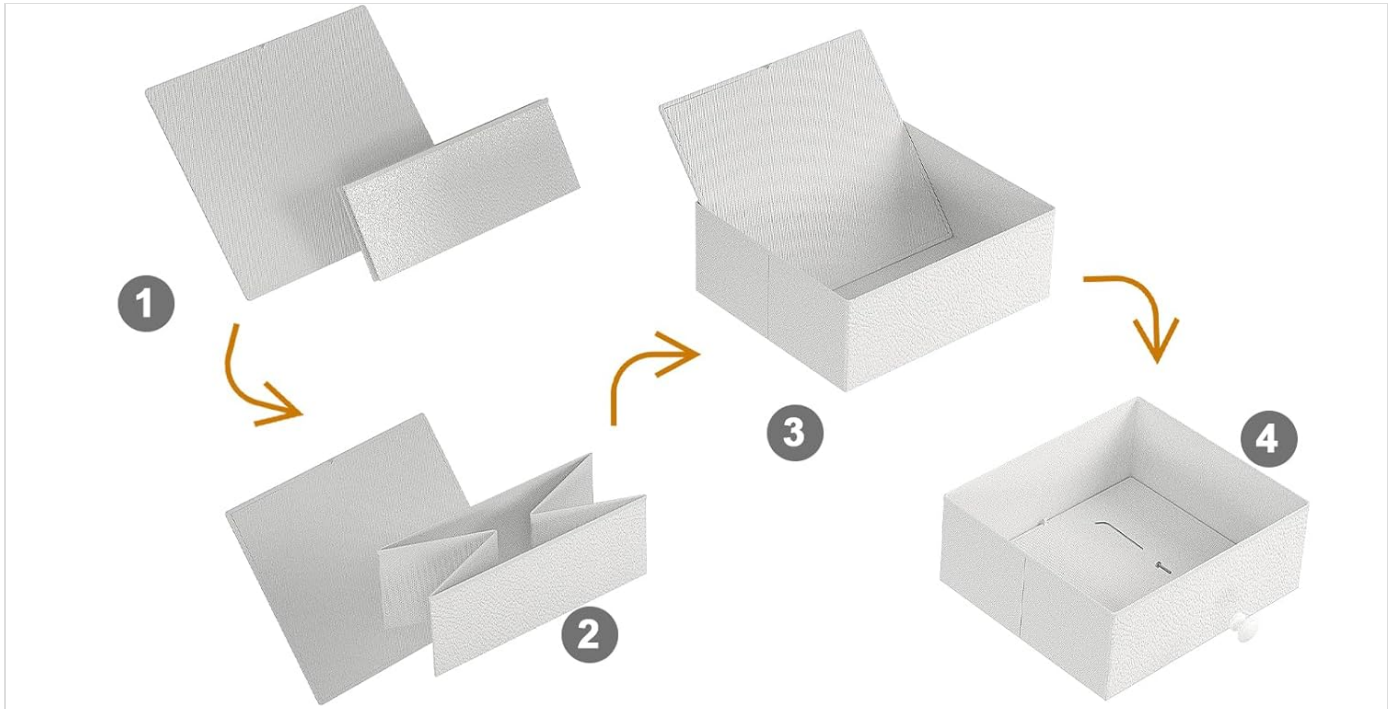

Easy to Assemble

2 Large Fabric Drawers



Image: Visual guide for assembling the fabric drawers.

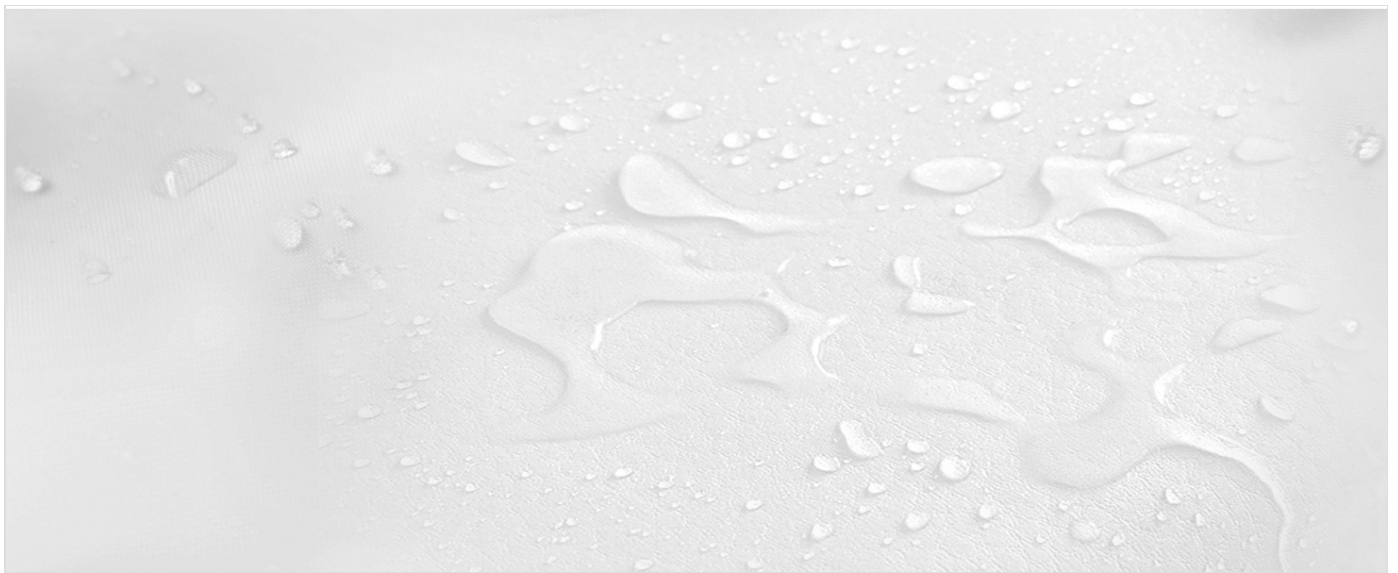

Image: Powder-coated metal tubes, part of the sturdy frame construction.



Image: Quality plastic connectors ensuring stable assembly.



Image: The anti-tip kit for securing the shoe rack to a wall.

OPERATING INSTRUCTIONS

The UNITSTAGE 10-Tier Tall Shoe Rack is designed for straightforward use.

- **Shoe Placement:** Place shoes on the metal shelves. The open design allows for ventilation.
- **Tall Footwear:** If you have tall boots or high-top shoes, remove one or more shelves to create adequate vertical space. The flexible design allows for customization.
- **Drawer Use:** Utilize the two fabric drawers for storing smaller items such as socks, shoe care products, keys, or other accessories. The drawers are removable and can be rearranged as needed.
- **Weight Capacity:** Each shelf is designed to withstand up to 30 pounds. Do not exceed this weight limit to ensure stability and longevity of the unit.



Customizable Storage

Removable shelves to create space for high boots.
Rearrange the 2 large drawers as needed.

Image: Demonstrating customizable storage with removable shelves for boots and flexible drawer placement.

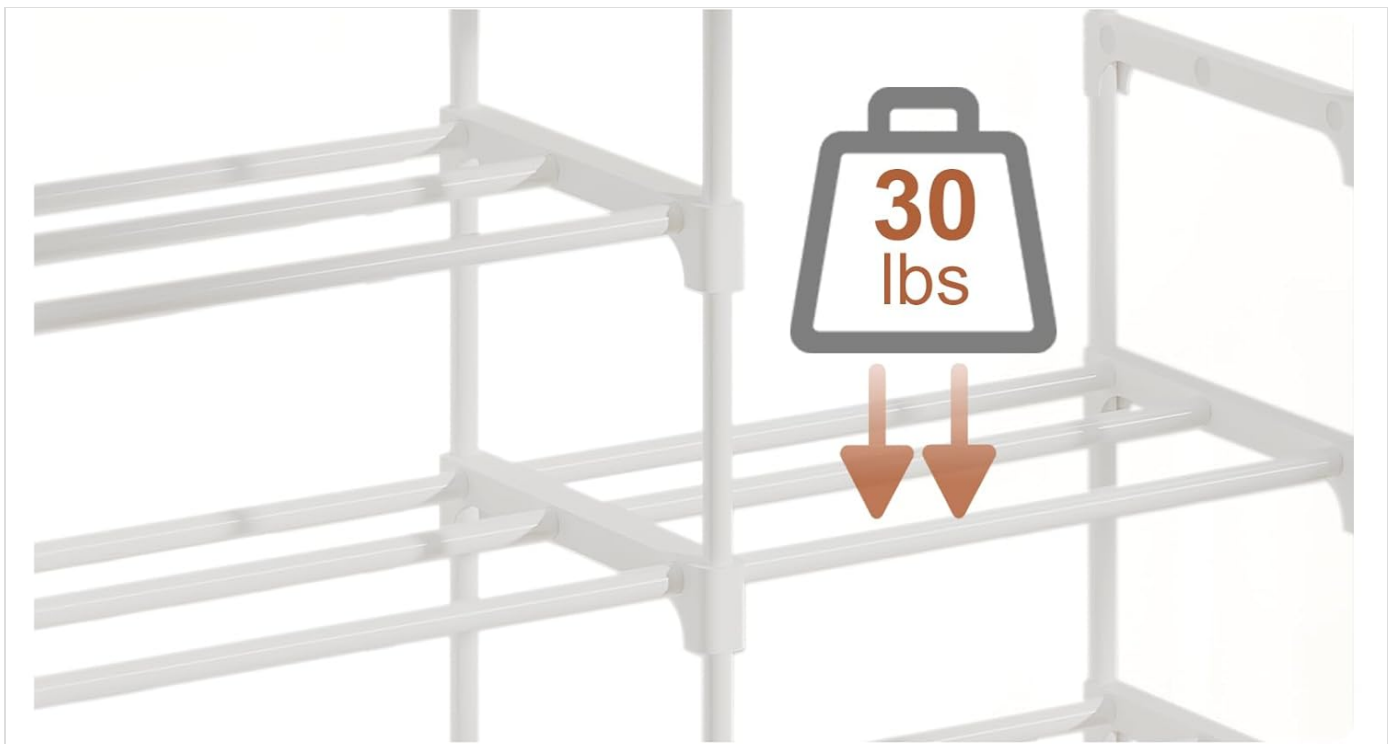

Sturdy and Stable

Each layer can withstand 30 pounds

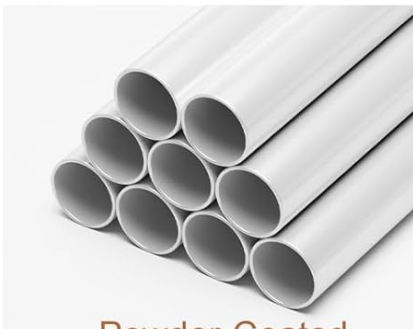

Powder-Coated
Metal Tube



Quality Plastic
Connectors



Anti-Tip Kit

Image: Illustration of the 30-pound weight capacity per shelf, emphasizing stability.

MAINTENANCE

Proper maintenance will extend the life and appearance of your shoe rack.

- **Cleaning the Frame:** Wipe down the powder-coated metal frame with a damp cloth. Avoid abrasive cleaners or harsh chemicals that could damage the finish.
- **Cleaning Drawers:** The non-woven fabric drawers can be spot cleaned with a mild detergent and damp cloth. Allow to air dry completely before reinserting. Do not machine wash.
- **Waterproof Gaskets:** The top PP gaskets are waterproof. Wipe any spills immediately with a dry cloth.
- **Regular Checks:** Periodically check all connections to ensure they remain tight and secure. Re-tighten if necessary.



Top PP Gaskets for high heels

Waterproof PP Gaskets

Image: Waterproof PP gaskets on the top tier, designed for easy cleaning and protection.

TROUBLESHOOTING

Problem	Possible Cause	Solution
Rack feels unstable or wobbly.	Loose connections; uneven floor; anti-tip kit not installed.	Ensure all plastic connectors are fully engaged and tight. Place on a level surface. Install the anti-tip kit as per instructions.
Shoes do not fit on shelves.	Shelf spacing is too small for specific footwear (e.g., boots).	Remove one or more shelves to create additional vertical clearance for taller items.
Drawers do not slide smoothly.	Drawer not assembled correctly; obstruction in the compartment.	Check drawer assembly (ensure bottom panel is secure). Remove any items obstructing the drawer's path.

Problem	Possible Cause	Solution
Missing parts during assembly.	Packaging overlooked; manufacturing error.	Double-check all packaging materials. Contact customer support with your purchase details.

SPECIFICATIONS

Model: 10 Tier

Dimensions (D x W x H): 33.46" x 9.84" x 76.77"

Material: Metal (Powder-Coated), Plastic, Oxford, Non-Woven Fabric

Color: White

Number of Tiers: 10

Drawers: 2 Removable Fabric Drawers

Weight Capacity per Shelf: 30 lbs

Mounting Type: Floor Mount (with optional wall anchor)

Assembly Required: Yes

Care Instructions: Wipe with Damp Cloth

WARRANTY AND SUPPORT

Warranty: This product comes with a standard manufacturer's warranty covering defects in materials and workmanship. Please refer to your purchase documentation for specific warranty terms and duration. Keep your proof of purchase for warranty claims.

Customer Support: For any questions regarding assembly, missing parts, or product issues, please contact UNITSTAGE customer support. Contact information can typically be found on the product packaging or the retailer's website where the product was purchased. When contacting support, please have your model number (10 Tier) and purchase date available.

You can visit the UNITSTAGE store online for more information: [UNITSTAGE Store](#)