

# PSIER Open Ear Ear Buds SP06 User Manual

Model: SP06

## 1. INTRODUCTION

Thank you for choosing the PSIER Open Ear Ear Buds SP06. This manual provides essential information for setting up, operating, and maintaining your new earbuds. Please read it thoroughly before use to ensure optimal performance and longevity of your device.

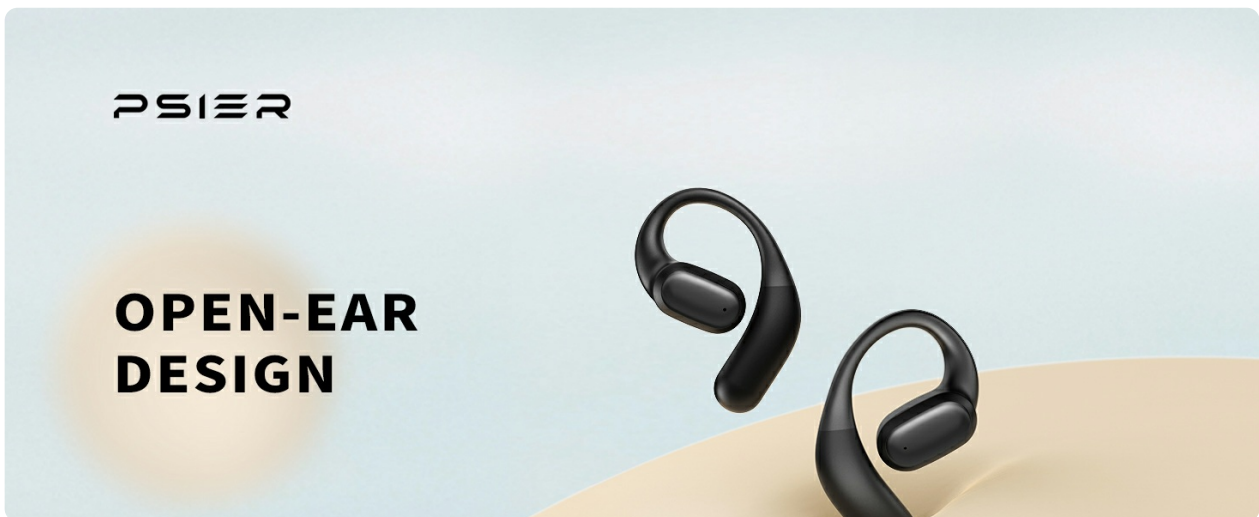

Image: PSIER Open Ear Ear Buds SP06, highlighting their open-ear design.

## 2. PRODUCT OVERVIEW

## 2.1 Package Contents

The following items are included in your PSIER Open Ear Ear Buds SP06 package:

- Open Ear Earbuds x1 (Left and Right)
- User Manual x1
- USB-C Charging Cable x1
- LED Digital Display Charging Case x1

Image: All components included in the product package.

## 2.2 Key Features

- **Open-Ear Design:** Allows awareness of surroundings while listening.
- **Bluetooth 5.3:** Provides stable and low-latency wireless connectivity up to 33 feet.
- **13mm Aluminized LCD Dome Speakers:** Enhanced audio quality with improved diaphragm rigidity.
- **Crystal Clear Calls:** Features 4 built-in noise-canceling microphones and advanced algorithms.
- **Comfortable & Secure Fit:** Ergonomic design with flexible ear hooks for zero pressure and stability during activity.
- **Extended Battery Life:** Up to 10 hours on a single charge, and up to 40 hours total with the charging case.
- **Directional Acoustics Technology:** Unique nozzle design redirects sound waves to the ears, reducing sound leakage.
- **IPX6 Water-Resistant:** Resistant to sweat and splashes, suitable for workouts and outdoor activities.
- **Smart Touch Control:** Intuitive touch controls for calls, music playback, and voice assistant.

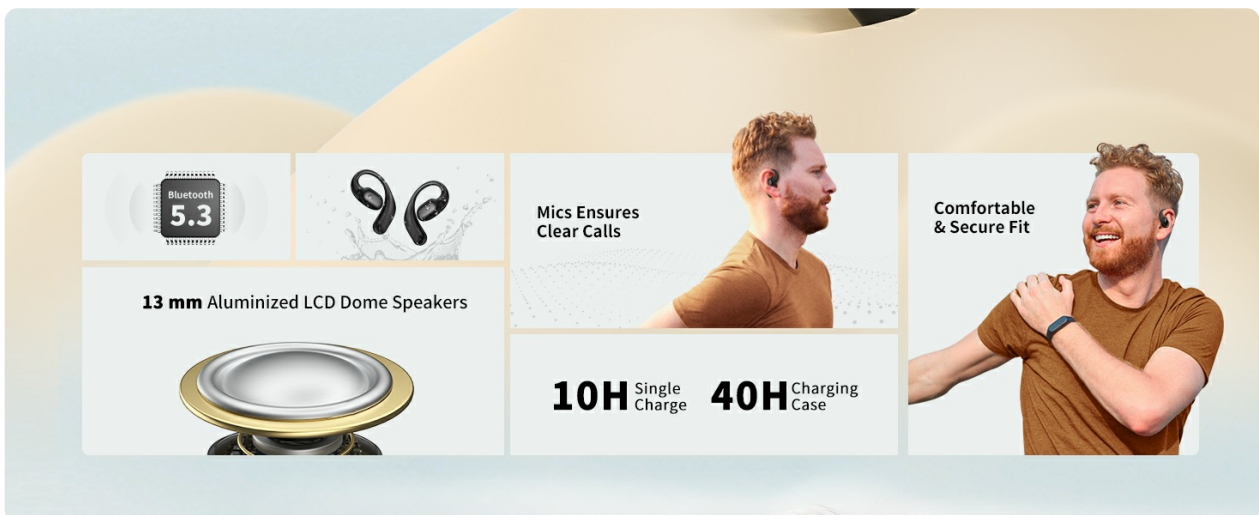

Image: Key features of the PSIER SP06 earbuds.

### 13 MM Aluminized Lcd Dome Speakers

The new aluminum plating process improves the diaphragm's rigidity and stability

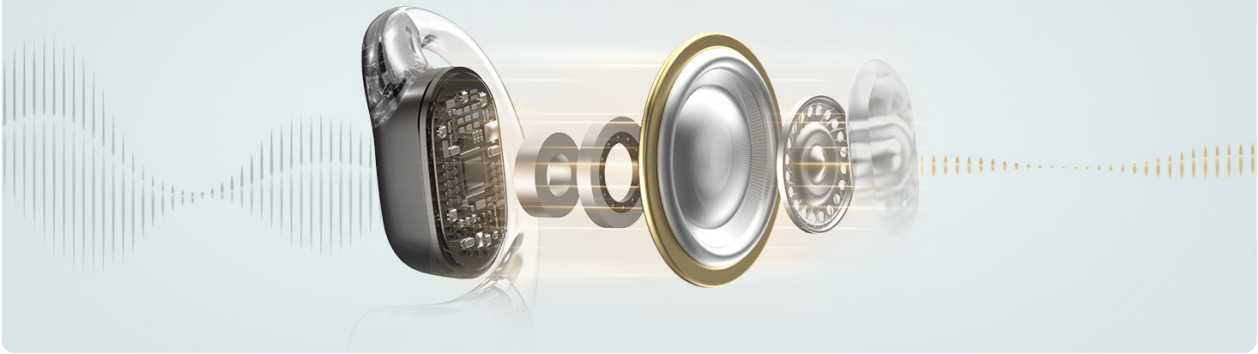

Image: Detailed view of the 13mm Aluminized LCD Dome Speakers.



### Directional Acoustics Technology

Unique nozzle design can accurately redirect sound waves to your ears and reduce sound leakage

Image: Illustration of Directional Acoustics Technology.

## 3. SETUP

### 3.1 Charging the Earbuds and Case

Before first use, fully charge the earbuds and the charging case.

1. Place the earbuds into the charging case.
2. Connect the USB-C charging cable to the charging port on the case and to a power source.
3. The LED digital display on the case will show the charging status. A full charge takes approximately 1.5 hours.

### 3.2 Wearing the Earbuds

Proper fit ensures optimal sound quality and comfort.

1. Hang the end of the earbud on the ear helix.
2. Rotate the earbud backward along the auricle until it sits comfortably.
3. Adjust the ear hook until the headset is worn stably and securely.

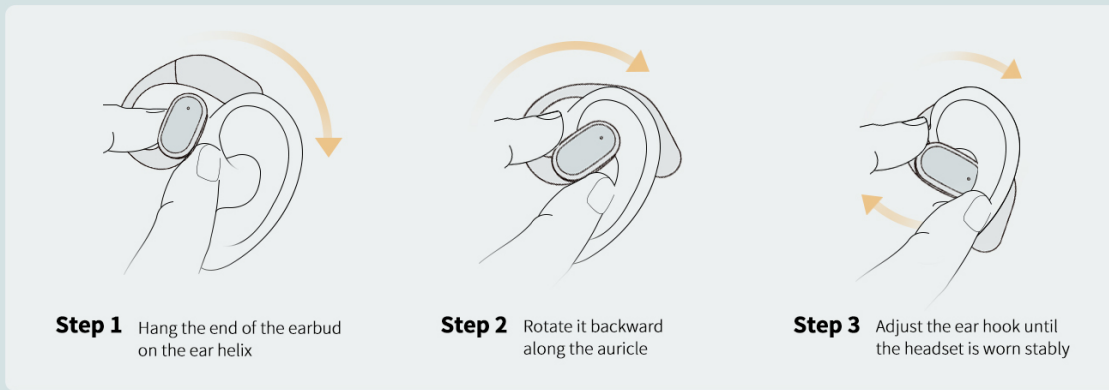

Image: Step-by-step guide for wearing the earbuds.

### 3.3 Bluetooth Pairing

The earbuds will automatically enter pairing mode when removed from the charging case.

1. Open the charging case and remove both earbuds. They will automatically power on and enter pairing mode.
2. On your device (smartphone, tablet, laptop), enable Bluetooth.
3. Search for available Bluetooth devices and select "PSIER SP06" from the list.
4. Once connected, you will hear a confirmation tone, and the earbuds will be ready for use.

The earbuds will automatically reconnect to the last paired device when removed from the case, if Bluetooth is enabled on the device.

#### Stable connection

Bluetooth 5.3 technology provides the headset with ultra-low latency and an ultra-long connection range of 33 ft.

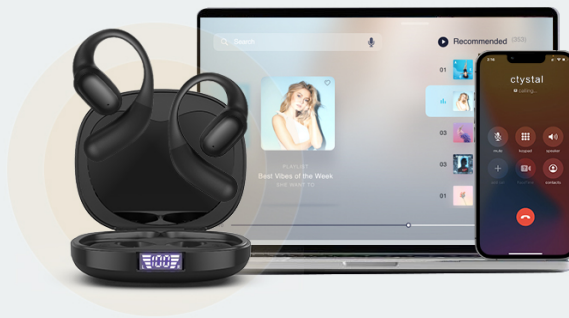

Image: Earbuds connected to multiple devices via Bluetooth 5.3.

## 4. OPERATING INSTRUCTIONS

### 4.1 Smart Touch Controls

The PSIER SP06 earbuds feature intuitive touch controls on each earbud. Refer to the diagram below for specific functions:

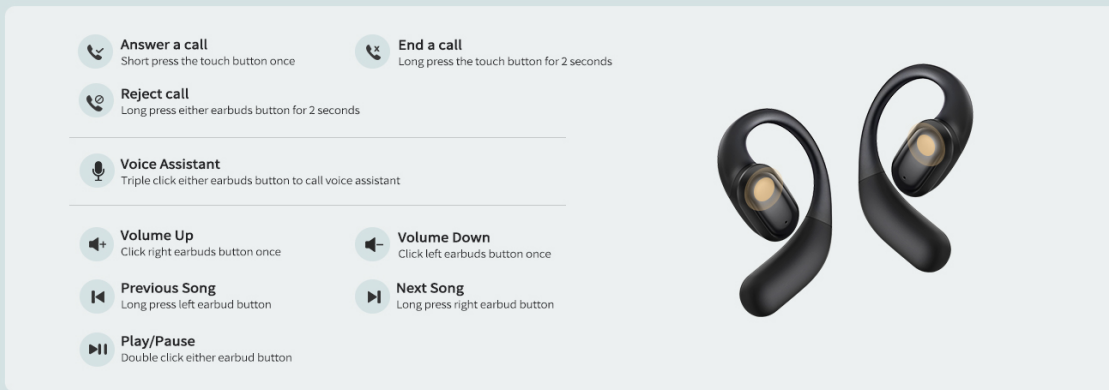

Image: Detailed touch control functions for the earbuds.

- **Answer a call:** Short press the touch button once.
- **End a call:** Long press the touch button for 2 seconds.
- **Reject call:** Long press either earbud button for 2 seconds.
- **Voice Assistant:** Triple click either earbud button.
- **Volume Up:** Click right earbud button once.
- **Volume Down:** Click left earbud button once.
- **Previous Song:** Long press left earbud button.
- **Next Song:** Long press right earbud button.
- **Play/Pause:** Double click either earbud button.

## 4.2 Power On/Off

- **Power On:** Remove earbuds from the charging case. They will power on automatically.
- **Power Off:** Place earbuds back into the charging case. They will power off automatically.

## 5. MAINTENANCE

To ensure the longevity and optimal performance of your PSIER SP06 earbuds, follow these maintenance guidelines:

- **Cleaning:** Use a soft, dry, lint-free cloth to clean the earbuds and charging case. Do not use abrasive cleaners or solvents.
- **Water Resistance:** The earbuds are IPX6 water-resistant, meaning they can withstand sweat and splashes. Do not submerge them in water or expose them to heavy rain. Ensure they are dry before placing them back in the charging case.
- **Storage:** Store the earbuds in their charging case when not in use to protect them from dust and damage. Store in a cool, dry place away from extreme temperatures.
- **Charging:** Use only the provided USB-C cable for charging. Avoid overcharging by disconnecting once fully charged.

## IPX6 Water-Resistant

You can continue to enjoy music during your sweaty workout without any interruptions.



Image: Earbuds are IPX6 water-resistant, suitable for sweaty workouts.

## 6. TROUBLESHOOTING

If you encounter issues with your PSIER SP06 earbuds, refer to the following common solutions:

Problem	Possible Cause	Solution
Earbuds not pairing/connecting	Bluetooth off on device, earbuds not in pairing mode, interference.	Ensure Bluetooth is on. Place earbuds in case, then remove to re-enter pairing mode. Move closer to device. Forget device in Bluetooth settings and re-pair.
No sound or low volume	Volume too low, earbuds not properly seated, device volume low, earbud obstruction.	Increase earbud and device volume. Adjust earbuds for proper fit. Clean any debris from speakers.
Earbuds not charging	Charging cable issue, dirty charging contacts, case battery low.	Check USB-C cable connection. Ensure charging contacts on earbuds and case are clean. Charge the case.
Touch controls unresponsive	Temporary software glitch, dirty touch sensor.	Place earbuds back in case, then remove. Clean the touch sensor area with a dry cloth.
Poor call quality	Microphone obstruction, weak signal, environmental noise.	Ensure microphones are clear. Move to an area with better signal. Reduce background noise.

## 7. SPECIFICATIONS

Feature	Detail
Model Name	SP06
Connectivity Technology	Bluetooth 5.3
Bluetooth Range	33 Feet (10 meters)
Audio Driver Type	Bone Conduction Driver (13mm Aluminized LCD Dome Speakers)
Sensitivity	98 dB
Battery Life (Earbuds)	Up to 10 Hours
Total Battery Life (with Case)	Up to 40 Hours
Charging Time	Approx. 1.5 Hours
Water Resistance Level	IPX6 (Water Resistant)
Control Type	Touch Control, Push Button
Ear Placement	Open Ear
Material	Plastic, Silicone (Earbuds); Hard Plastic (Case)
Item Weight	5.9 ounces
Package Dimensions	4.57 x 3.82 x 2.05 inches

## 8. WARRANTY AND SUPPORT

### 8.1 Warranty Information

The PSIER Open Ear Ear Buds SP06 come with a **12-month warranty** from the date of purchase. This warranty covers manufacturing defects and ensures reliable performance under normal use. Please retain your proof of purchase for warranty claims.

### 8.2 Customer Support

For any questions, technical assistance, or warranty inquiries, please contact PSIER customer support through the retailer's platform or the official PSIER website. Our support team is available to assist you with any issues you may encounter.