

## Gamrombo B0FKB5CCRD

# Gamrombo Wireless Gaming Controller User Manual

Model: B0FKB5CCRD

[Introduction](#) [Setup](#) [Operation](#) [Maintenance](#) [Troubleshooting](#) [Specifications](#) [Warranty & Support](#)

## 1. INTRODUCTION

This manual provides detailed instructions for the Gamrombo Wireless Gaming Controller, designed for an enhanced gaming experience across multiple platforms. It features Hall Effect joysticks, adjustable RGB lighting, trigger stops, macro functions, turbo mode, and dual vibration motors.



Image 1.1: Gamrombo Wireless Gaming Controller (White) with its dedicated 2.4G USB dongle.

## 2. SETUP AND CONNECTIVITY

### 2.1 Compatibility

The Gamrombo Wireless Gaming Controller is compatible with a range of devices:

- PlayStation 5 (PS5) - **Requires included USB adapter and specific PS5 system settings.**
- PlayStation 4 (PS4, PS4 Pro, PS4 Slim)
- PC (Windows 10)
- Nintendo Switch
- Steam
- PlayStation 3 (PS3)
- MAC
- iOS
- Android

**Note:** For PS5 connectivity, the use of the provided USB adapter is mandatory. Without this adapter, the controller will not connect to a PS5 console.



Image 2.1: Multi-platform compatibility of the Gamrombo Wireless Gaming Controller.

## 2.2 Connecting to PlayStation 5 (PS5)

To ensure successful connection to your PS5 console, follow these critical steps:

1. Insert the provided 2.4G USB dongle into an available USB port on your PS5 console.
2. Turn on your PS5 console.
3. Navigate to the PS5 system settings: **Settings > Accessories > Controller (General) > Communication Method > Use USB Cable.**
4. Power cycle your PS5 console after making this setting change.
5. Press the 'P' button on the controller to power it on and initiate pairing with the USB dongle.

This setting change is essential for the controller to function wirelessly with the PS5 via the USB adapter.

## 2.3 Connecting to Other Platforms

For PS4, PC, Switch, Steam, PS3, MAC, iOS, and Android, the controller connects wirelessly via its 2.4GHz receiver (USB dongle) or Bluetooth, depending on the device's capabilities. Refer to your device's specific pairing instructions if Bluetooth is used.

## 3. OPERATION

### 3.1 Controller Layout and Features

The controller features a standard button layout with several enhanced functionalities:

- **Hall Effect Joysticks:** Provide precise, drift-free control and enhanced durability.
- **Precision Control Buttons:** Designed for accurate input.
- **Fast Response Triggers:** Offer quick and responsive feedback.
- **Sensitive Touch Control Panel:** Supports drag-and-drop, sliding touch, and multi-point simultaneous entry for interactive gameplay.



- **6-Axis Motion Sensor:** Built-in accelerometer and gyroscope detect motion, tilt, and rotation for immersive gameplay.
- **8-Way Microswitch D-Pad:** Provides tactile and audible feedback for precise directional inputs.
- **Built-in Speaker and Stereo Headset Jack:** Allows for in-game audio and communication.



Image 3.1: Key control features including Hall Effect joysticks and responsive triggers.



Image 3.2: The sensitive touch control panel supporting various interactive inputs.

### 3.2 Adjustable RGB Lighting Effects

The controller features customizable RGB LED lights with 8 colors and 4 modes:

- **Switching Lighting Colors:** Press and hold the **SET + L3** buttons simultaneously.
- **Switching Lighting Modes:** Press and hold the **SET + R3** buttons simultaneously.
- **Default RGB:** Press the 'P' button to activate the default RGB lighting.
- **Turning Off RGB:** Press and hold the **L3 + R3** buttons for 3 seconds.
- **Adjusting Brightness:** The default brightness is 40%. Press **SET + D-pad Up** to increase brightness, and **SET + D-pad Down** to decrease brightness.

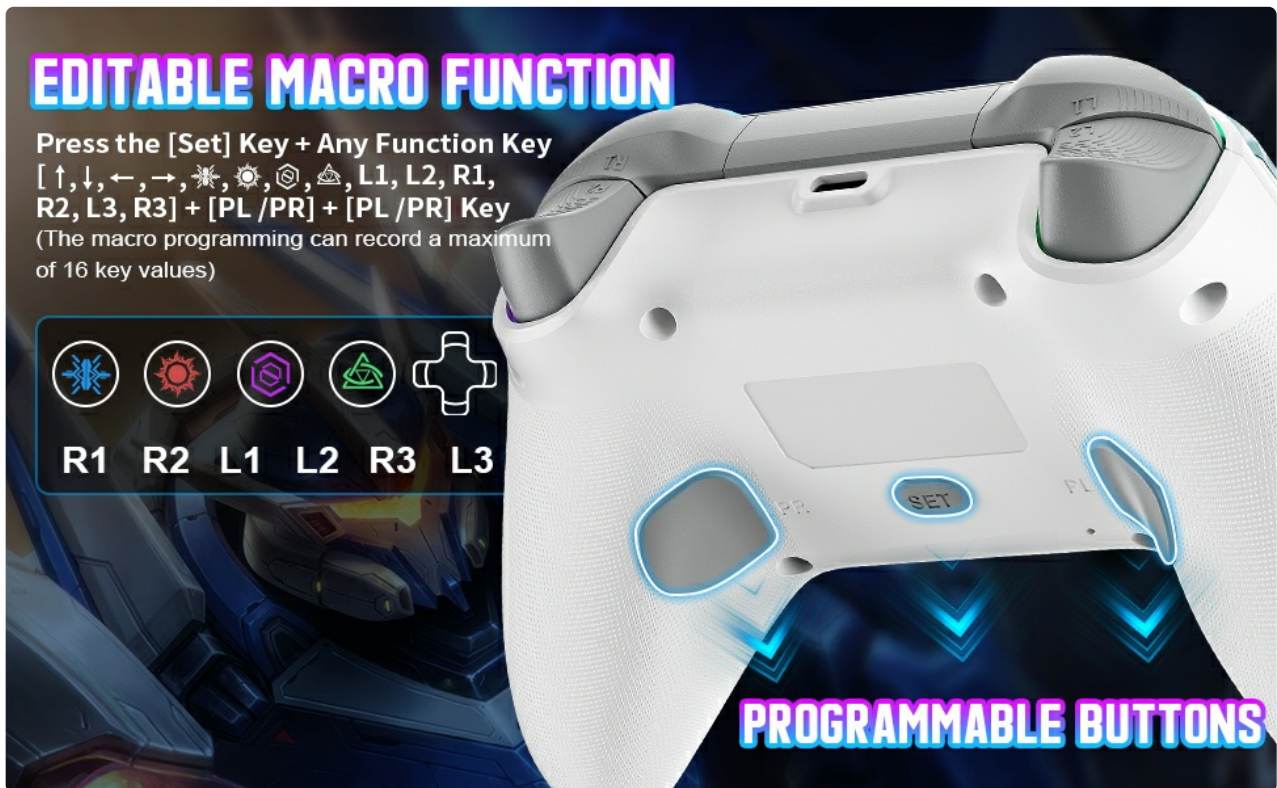

Image 3.3: Instructions for adjusting RGB lighting colors and modes.

### 3.3 Macro Function

The controller supports programmable macro functions, allowing you to assign a sequence of up to 16 key values to a single button.

- **Programming a Macro:** Press the **[SET] Key + Any Function Key** (e.g., D-pad directions, action buttons, L1, L2, R1, R2, L3, R3) + **[PL/PR] Key**.
- The macro programming can record a maximum of 16 key values.



## ERGONOMIC DESIGN FOR PLAYSTATION PLAYERS

On the basis of novel design and improvement, it effectively strengthens your experience of the game

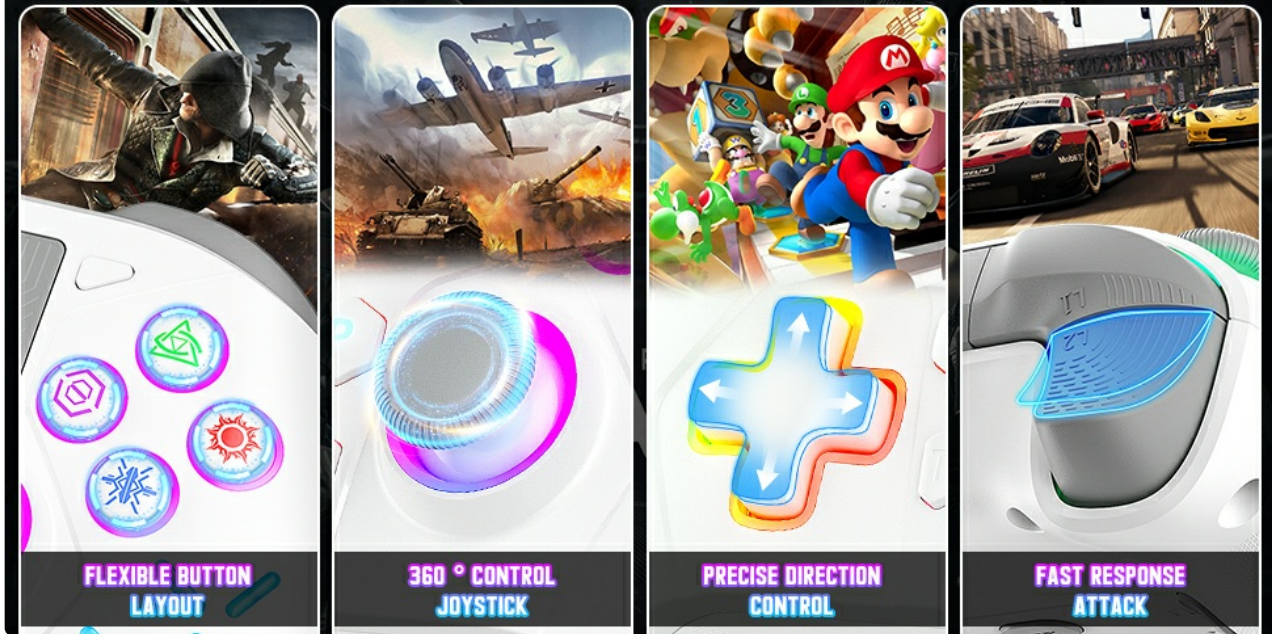

Image 3.4: Guide to programming the macro function on the controller.

### 3.4 Turbo Feature

The unique Turbo feature allows for rapid, repeated input of a button press, providing an advantage in games requiring fast button mashing. Specific activation instructions are typically found in the quick start guide or can be experimented with by holding the Turbo button and the desired action button.

### 3.5 Dual Vibration Motors

Built-in dual vibration motors provide tactile feedback, enhancing immersion and realism during gameplay. The vibration intensity can vary between weak, moderate, and strong, depending on in-game events.





## 4. MAINTENANCE

### 4.1 Battery and Charging

The controller is equipped with a 1200mAh battery, providing over 15 hours of play time in LED mode. Charging is fast and stable via the included Type-C cable, with a full charge typically achieved in 2 hours.

- **Battery Capacity:** 1200mAh
- **Charging Time:** Approximately 2 hours
- **Play Time:** Over 15 hours (in LED mode)
- **Charging Port:** USB Type-C

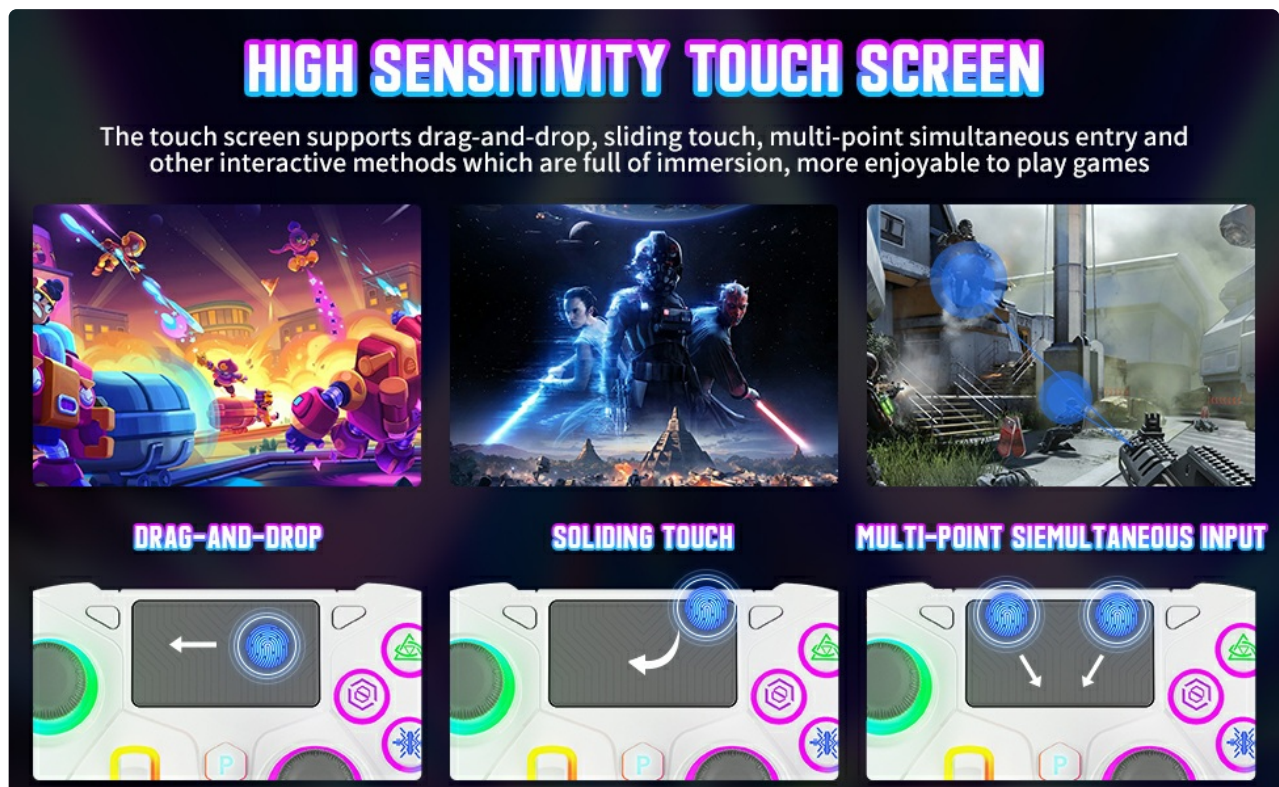

Image 4.1: Battery and charging information for the controller.

### 4.2 Cleaning and Storage

To maintain your controller's performance and appearance:

- Wipe the controller with a soft, dry cloth. Avoid using harsh chemicals or abrasive materials.
- Keep the controller away from extreme temperatures, direct sunlight, and moisture.
- Store in a clean, dry place when not in use.

## 5. TROUBLESHOOTING

### 5.1 Connection Issues with PS5

If the controller fails to connect to your PS5, ensure you have followed the specific PS5 setup instructions:

- Verify the 2.4G USB dongle is securely inserted into the PS5.
- Confirm the PS5 system setting is configured to **Settings > Accessories > Controller (General) >**

**Communication Method > Use USB Cable.**

- Perform a power cycle of your PS5 console after adjusting settings.
- Ensure the controller is powered on by pressing the 'P' button.

**5.2 Controller Unresponsive**

- Check the battery level. If low, connect the controller to a power source using the Type-C cable.
- Ensure the controller is within range of the USB dongle or Bluetooth connection.
- Try resetting the controller (a small reset button may be located on the back; use a pin to press it).

**5.3 Audio Jack Not Functioning**

If you experience issues with the 3.5mm stereo headset jack:

- Ensure your headset is fully plugged into the jack.
- Test the headset with another device to confirm it is working correctly.
- Check in-game or console audio settings to ensure output is directed to the controller's headset jack.

**6. SPECIFICATIONS**

Feature	Detail
ASIN	B0FKB5CCRD
Release Date	August 17, 2025
Package Dimensions	6.81 x 4.72 x 2.83 inches
Item Weight	11.7 ounces
Manufacturer	Gamrombo
Batteries	1 AA battery required (included)
Connectivity	2.4GHz Wireless (USB Dongle), Bluetooth 5.3
Special Features	RGB LED Lights, Hall Effect Joysticks, Trigger Stops, Macro, Turbo, Dual Vibration, 6-Axis Gyro Sensor, Multi-Touch Pad, 3.5mm TRRS Stereo Jack

**7. WARRANTY & SUPPORT**

**7.1 Product Warranty**

For information regarding the product warranty, please refer to the manufacturer's official website or contact their customer support directly. Warranty terms and conditions may vary.

**7.2 Customer Support**

For further assistance, technical support, or inquiries, please visit the official Gamrombo store page on Amazon:  
[Visit the Gamrombo Store](#)



## Related Documents - B0FKB5CCRD

[illegible]