

[manuals.plus](#) /

› [WUBEN](#) /

› [WUBEN X4 EDC Flat Flashlight with RGB Light, 1500 Lumens Mini Flashlight Instruction Manual](#)

WUBEN X4

WUBEN X4 EDC Flat Flashlight Instruction Manual

Model: X4

INTRODUCTION

Thank you for choosing the WUBEN X4 EDC Flat Flashlight. This compact and versatile lighting tool is designed for various applications, offering powerful illumination and multiple functional modes. This manual provides essential information for proper setup, operation, and maintenance to ensure optimal performance and longevity of your device.



Image: The WUBEN X4 EDC Flat Flashlight, showcasing its compact design and dual light sources.

KEY FEATURES

- **Portable Multi-functional Design:** Dual light source with a main light offering up to 1500 lumens and a side light providing warm white and RGB options.
- **Intuitive Controls:** Features a toggle switch for mode selection (lock, side light, main light, moonlight) and a rotary switch for stepless brightness dimming and RGB color control.
- **Tactical Tail Switch:** Integrated switch for instant 1500-lumen main light activation.
- **Magnetic Tail Cap:** Allows for hands-free attachment to metal surfaces.
- **Durable and Lightweight:** Constructed from aluminum, weighing only 137 grams (4.8 oz) with batteries, and measuring 1.5 x 1 x 3.8 inches.
- **IP68 Waterproof Rating:** Built to withstand immersion in water up to 2 meters for 1 hour, and resistant to drops, dust, and rain.
- **Extended Battery Life:** Up to 285 hours of operation with a 3350mAh high-capacity battery, fully rechargeable in 2.5 hours via USB-C.
- **Battery Indicator:** Monitor battery level at any time.

PACKAGE CONTENTS

Ensure all items are present upon unboxing:

- WUBEN X4 Flashlight x 1
- USB-C Charging Cable x 1
- Lanyard x 1
- Belt Clip x 1 (Pre-installed or included separately)
- User Manual x 1

WHAT'S IN THE BOX?

Main Light Mode			
FL1 Standard	Turbo ~ Moon		
	1500 ~ 5 Lumens		
	3 ~ 285 Hours		
	205 Meters		10506 Candelas
Side Light Mode			
FL1 Standard	White light	RGB light	Beacons
	100 ~ 1 Lumens	10 Lumens	10 Lumens
	8 ~ 720 Hours	70 Hours	350 Hours
FL1 Standard	Red-Blue flash	Red-Green flash	Red-Yellow flash
	10 Lumens	10 Lumens	10 Lumens
	185 Hours	185 Hours	185 Hours
	1.0 Meter		
	IP68 (2 meters underwater for 1 hour)		
	91g/3.216oz (without battery) 141g/4.97oz (with battery)		
 (LxWxH)	37.3mmx26.3mmx95.7mm 1.47inx1.04inx3.77in		

Note: Tested under ANSI/NEMA FL1 standards in WUBEN labs using a WUBEN 3400mAh battery. Actual results may vary due to environmental factors and battery differences.



X4 x 1



User Manual x 1



USB-C Cable x 1



Lanyard x 1

Image: Visual representation of the WUBEN X4 flashlight and its included accessories.

SETUP

Battery Installation and Replacement

1. Locate the battery compartment at the tail end of the flashlight.
2. Slide the lock switch to the unlocked position (if applicable) and open the battery cap.
3. Insert the 18650 Lithium-Ion battery, ensuring the positive (+) and negative (-) terminals align correctly with the markings inside the

compartment.

4. Close the battery cap securely and slide the lock switch back to the locked position.

Charging

1. Slide the mode selection switch to the 'Moonlight' position to expose the USB-C charging port.
2. Connect the provided USB-C charging cable to the flashlight's port and a compatible USB power source.
3. The battery indicator lights will show the charging status. A full charge typically takes 2.5 hours.
4. Once charging is complete, return the mode selection switch to the desired position, ensuring the USB-C port is covered for water resistance.

Long-Lasting & Replaceable

For consistent brightness and easy battery swap



720 Hrs
Max Run Time



3400mAh
High Power



Type-C
Charging



One-Touch
Lock



Image: The WUBEN X4 flashlight highlighting its replaceable battery and USB-C charging port.

OPERATING INSTRUCTIONS

Mode Selection (Toggle Switch)

The toggle switch on the side of the flashlight allows you to select between different lighting modes:

- **Lock Mode:** Prevents accidental activation. Ensure the switch is in this position when not in use.
- **Side Light Mode:** Activates the side LED panel for area illumination.
- **Main Light Mode:** Activates the primary front LED for focused beam illumination.
- **Moonlight Mode:** Provides a very low light output, ideal for preserving night vision or discreet use. This position also exposes the USB-C charging port.

Brightness Adjustment (Rotary Switch)

Once a light mode (Main or Side) is selected, use the rotary switch to adjust the brightness steplessly. Rotate clockwise to increase brightness and counter-clockwise to decrease it.

RGB Light Modes (Side Light)

In Side Light Mode, press and hold the rotary switch to cycle through different RGB colors. Rotate the switch to fine-tune the color or select specific flashing patterns (e.g., red-blue flash for emergencies).

Multi-Use Side Light

Adapts to any situation - from soft glow to smart signals



Image: The WUBEN X4 showcasing its multi-use side light with warm white and RGB color options.

Tactical Tail Switch

The integrated tactical tail switch provides quick access to maximum brightness:

- **Instant 1500 Lumens:** Press the tactical tail switch to instantly activate the main light at 1500 lumens, regardless of the current mode (Main Light or Side Light).
- **Momentary On:** Lightly press and hold the tactical switch for momentary high output. Release to turn off.
- **Strobe Mode:** Double-press the tactical switch to activate strobe mode for signaling or self-defense.

Innovative Tactical Switch

Ergonomic side-mounted control for fast, reliable activation—no fumbling, just instant response

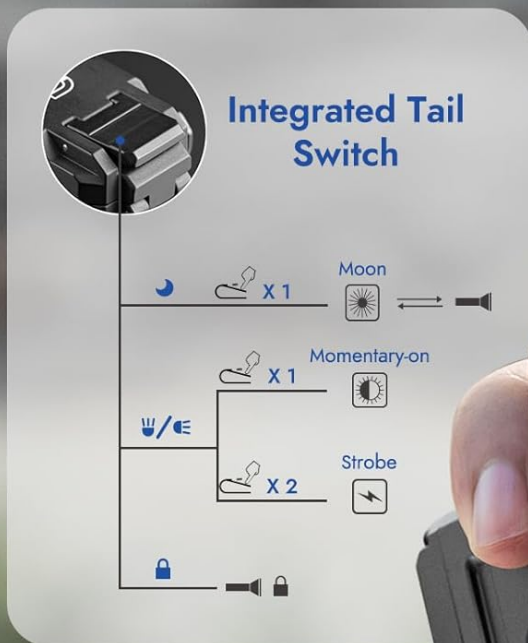

Image: Diagram illustrating the functions of the innovative tactical tail switch on the WUBEN X4.

Magnetic Tail Cap and Clip

The magnetic tail cap allows the flashlight to be securely attached to metal surfaces, providing hands-free illumination. The extended clip offers versatile carrying options, allowing attachment to hats, waistbands, or backpacks.

Video: Demonstration of the WUBEN X4's back clip, lanyard, and magnetic tail features for hands-free use.

MAINTENANCE

- **Cleaning:** Wipe the flashlight body with a soft, damp cloth. Do not use abrasive cleaners or solvents.
- **Battery Care:** Recharge the battery regularly to maintain its lifespan. If storing for an extended period, charge the battery to approximately 50% and store in a cool, dry place.
- **Water Resistance:** Ensure the USB-C port cover is properly sealed when not charging to maintain IP68 water resistance.
- **Storage:** When not using the X4 flashlight, always adjust the slide switch to the locked position to prevent accidental activation and battery drain.

SPECIFICATIONS

Brand	WUBEN
Model	X4
Main Light Output	Up to 1500 Lumens
Side Light Output	1 to 100 Lumens (Warm Light), RGB
Beam Distance	Up to 205 meters
Power Source	Battery Powered (3350mAh Lithium Ion)
Charging Port	USB-C
Charging Time	Approx. 2.5 hours
Max Run Time	Up to 285 hours
Water Resistance	IP68 (Waterproof)
Material	Aluminum
Dimensions	1.5"D x 3.8"W x 1"H
Item Weight	9.9 ounces (0.28 Kilograms)

Durable. Waterproof. Ready.

Metal body, IP68 rated—built to endure drops, dust, and rain







Image: The WUBEN X4 flashlight demonstrating its IP68 waterproof capability.

WARRANTY & SUPPORT

For warranty information, technical support, or any inquiries regarding your WUBEN X4 flashlight, please refer to the official WUBEN website or contact their customer service directly. Keep your purchase receipt for warranty claims.

Visit the [WUBEN Store](#) for more information.

Related Documents - X4

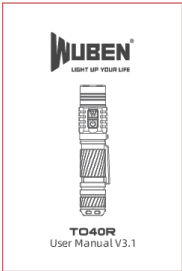
	<p>WUBEN X4 Flashlight User Manual - Operation, Features, and Specifications</p> <p>Comprehensive user manual for the WUBEN X4 flashlight. This guide covers package contents, product components, detailed operation modes (main light, side light, moonlight, turbo, strobe), charging indicators, maintenance, troubleshooting FAQs, warranty policy, and technical specifications.</p>
	<p>WUBEN T101PRO Flashlight User Manual V3.0</p> <p>User manual for the WUBEN T101PRO flashlight, detailing its features, operation, charging, maintenance, and warranty information. Includes product specifications and troubleshooting FAQs.</p>
	<p>Wuben X0 User Manual: Operation, Maintenance, and Warranty</p> <p>Comprehensive user manual for the Wuben X0 EDC angled flashlight, covering product introduction, package contents, specifications, operation, maintenance, troubleshooting, and warranty policy.</p>
	<p>WUBEN H8 LED Flashlight User Manual: Performance and Operation Guide</p> <p>Comprehensive user manual for the WUBEN H8 LED flashlight. Learn about its powerful 1800-lumen output, 1000-meter beam, Outdoor and Tactical modes, charging, maintenance, and specifications. Essential guide for optimal use and care of your WUBEN H8 flashlight.</p>
	<p>WUBEN L60 Flashlight User Manual</p> <p>Comprehensive user manual for the WUBEN L60 flashlight, detailing features, operation, specifications, and maintenance. Includes information on charging, modes, and safety.</p>
	<p>WUBEN TO40R User Manual V3.1</p> <p>Official user manual for the WUBEN TO40R flashlight. Find detailed information on operation, features, specifications, package contents, maintenance, troubleshooting, and warranty policies for this high-performance outdoor LED flashlight.</p>