

Lacidoll LCD-JSQ-J19WA

Lacidoll 16L Smart Ultrasonic Cool Mist Humidifier Instruction Manual

Model: LCD-JSQ-J19WA

1. PRODUCT OVERVIEW

The Lacidoll 16L Smart Ultrasonic Cool Mist Humidifier is designed to provide efficient and customizable humidification for large spaces up to 1500 sq.ft. Featuring a substantial 4.2-gallon (16L) tank, it offers extended operation for up to 48 hours on a single fill. This smart humidifier integrates touch, app, and voice control for convenient management of humidity levels, mist output, and various settings. It includes a built-in humidistat for energy-saving automatic operation, a diffuser tray for essential oils, and safety features like auto-shutoff.



Image 1.1: The Lacidoll 16L Smart Humidifier seamlessly integrated into a modern living space, showcasing its smart WiFi capabilities and extensive coverage.

2. SETUP INSTRUCTIONS

- Unboxing:** Carefully remove all components from the packaging. The power cord, manual, remote control, and extension tubes are stored inside the water tank.
- Assembly:** Place the main unit on a flat, stable surface. Attach the desired extension tube and 360° rotatable nozzle to the top of the humidifier.
- Filling the Water Tank:** The humidifier features a top-fill design. Remove the top cover and pour distilled or purified water directly into the 4.2-gallon (16L) tank. Do not exceed the maximum fill line indicated on the side.
- Power Connection:** Plug the power cord into a standard 120V electrical outlet.

5. **Initial Start-up:** After connecting power, wait for 100-120 seconds for the humidifier to start working properly and detect the water level.



Image 2.1: Visual representation of the humidifier's large 4.2-gallon (16L) capacity, ensuring long operational periods.

Setup Video: Smart Humidifiers for Whole House in Winter

Video 2.1: This video demonstrates the initial setup and mist output of the Lacidoll humidifier, highlighting its effectiveness in dry winter conditions.

3. OPERATING INSTRUCTIONS

The Lacidoll humidifier offers multiple control options for ease of use:

- **Touch Control:** Use the intuitive touch panel on the unit to power on/off, adjust mist volume, set timers, activate sleep mode, customize humidity, and control the UV night light.
- **Remote Control:** A dedicated remote control is included for convenient adjustments from a distance.
- **App Control:** Connect the humidifier to the Smart Life app (supports 2.4G Wi-Fi only) to control all functions from your smartphone, including custom humidity, timers, mist levels, night light, sleep mode, and scheduling.
- **Voice Control:** Compatible with Amazon Alexa and Google Assistant for hands-free operation.

Key Features:

- **Mist Volume:** Choose from 4 speed settings or 3 intermittent modes (30s/60s/90s) to match your needs.
- **Smart Humidistat:** Set your ideal humidity level between 40% and 90%. The humidifier will automatically maintain this level, stopping mist output when the target is reached and restarting when humidity drops.
- **Sleep Mode:** Turns off control panel lights and operates at a quiet 35dB for undisturbed rest.
- **UV Night Light:** Provides gentle illumination and can be turned on/off.



Image 3.1: The humidifier's smart control interface on a mobile app, allowing for precise adjustments and scheduling.

Operating Video: Smart Humidifiers for Whole House with App Control

Video 3.1: This video demonstrates how to control the humidifier using the mobile application, showcasing various settings and features.

4. MAINTENANCE

- **Easy Refill:** The top-fill design allows for easy and spill-free refilling of the water tank without needing to reverse the unit.
- **Cleaning:** The wide opening of the water tank provides easy access for thorough cleaning with a wet cloth. Regular cleaning is recommended to prevent mineral buildup.
- **Water Type:** We recommend using distilled or purified water to prevent clogging of the water pump, especially in areas with hard water.
- **Replaceable Pump:** The unit features a replaceable pump and hose for easy maintenance, particularly if hard water causes clogging.
- **Aroma Diffuser:** The built-in aroma diffuser tray allows you to add essential oils. Clean the tray regularly.

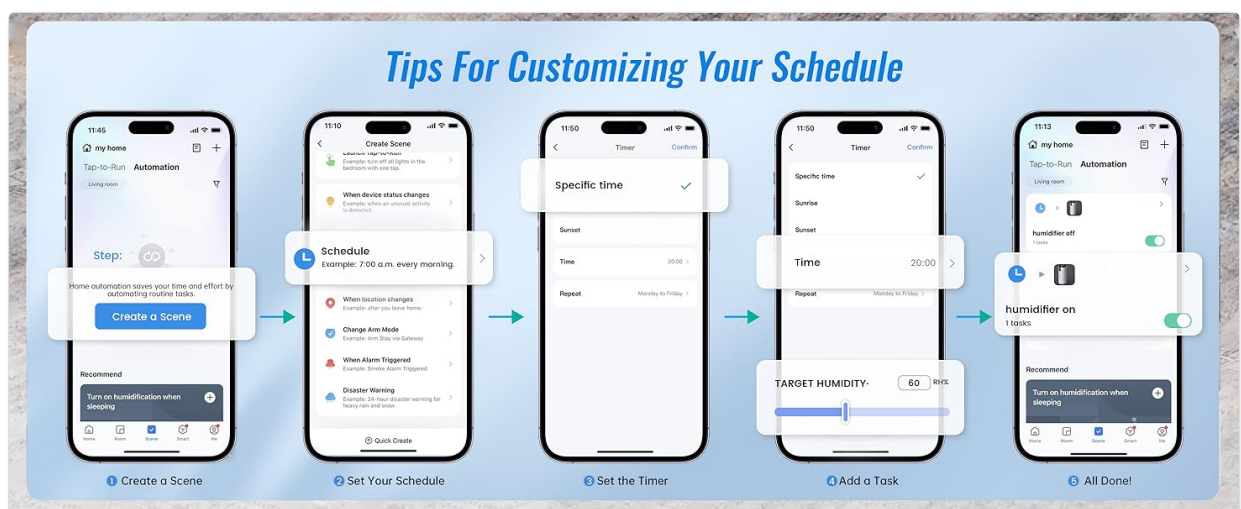

Image 4.1: Illustration of the humidifier's convenient top-fill design and the easily replaceable pump for simplified maintenance.

5. TROUBLESHOOTING

- **Humidifier not producing mist:** Ensure the water tank is filled above the minimum level. Check if the power

cord is securely plugged in. If recently filled, allow 1-2 minutes for the unit to detect water.

- **Red light indicator:** A red light typically indicates low water level. Refill the tank.
- **Inaccurate humidity reading:** The built-in sensor measures ambient humidity with a $\pm 5\%$ error margin. Humidity readings can vary based on the humidifier's immediate environment. For a more accurate room reading, consider placing a separate hygrometer away from the unit.
- **Water pump clogging:** If using hard water, mineral buildup can clog the pump. Use distilled or purified water. If clogging occurs, contact customer support for a replacement pump.
- **Dripping sound from nozzle:** If using the diverter cap on high mist settings, condensation may accumulate and drip. This is normal and drips back into the humidifier.

6. SPECIFICATIONS

Brand	Lacidoll
Model Name	lacidoll whole house humidifier LCD-JSQ-J19WA
Color	White
Capacity	16 Liters (4.2 Gallons)
Floor Area Coverage	Up to 1500 Square Feet
Operation Mode	Ultrasonic Cool Mist
Special Features	Adjustable Humidity Control, Auto Shut Off, Leakproof, Low Water Indicator, Night Light, Diffuser Tray, App/Voice/Remote Control
Voltage	120 Volts
Wattage	50 watts
Item Weight	9.43 Pounds
Product Dimensions	11"D x 11"W x 26"H

7. WARRANTY & SUPPORT

The Lacidoll 16L Smart Humidifier comes with a **30-Day Replacement** policy and a **1-Year Coverage** warranty. Our after-sales team is available 24/7 online to assist with refunds, returns, or technical support. Please contact us if you encounter any issues or require assistance.