



Manuals.plus /

› AWESAFE /

› AWESAFE 1 DIN Car Stereo with 6.36" HD Touchscreen User Manual

AWESAFE 759973262938

AWESAFE 1 DIN Car Stereo with 6.36" HD Touchscreen User Manual

Model: 759973262938

INTRODUCTION

This manual provides detailed instructions for the installation, operation, and maintenance of your AWESAFE 1 DIN Car Stereo. Please read this manual thoroughly before using the product to ensure proper function and safety. Keep this manual for future reference.

WHAT'S IN THE BOX

Upon unpacking, please verify that all the following items are included:

- AWESAFE 1 DIN Car Stereo Unit
- Reversing Camera
- Power Cables and Wiring Harnesses
- Installation Tools
- Microphone
- Disassembly Keys
- User Manual (this document)

Accessoires



Avant



Arrière



Caméra



Câble d'alimentation



Outils d'installation



Microphone



Clé de démontage



Manuel

Figure 1: Included Accessories. This image displays all components typically found in the product packaging, such as the main stereo unit, reversing camera, various cables, installation tools, an external microphone, and disassembly keys.

SETUP AND INSTALLATION

The AWESAFE car stereo is designed for standard 1 DIN vehicle slots. Professional installation is recommended. Ensure the vehicle's power is disconnected before beginning installation.

1. Wiring Connections

Connect the provided wiring harness to the car stereo and then to your vehicle's wiring. Pay close attention to the power, speaker, and accessory connections. If your vehicle's wiring does not conform to the standard ISO, an adapter may be required. Contact customer service if you are unsure.

Diagramme de définition de câble

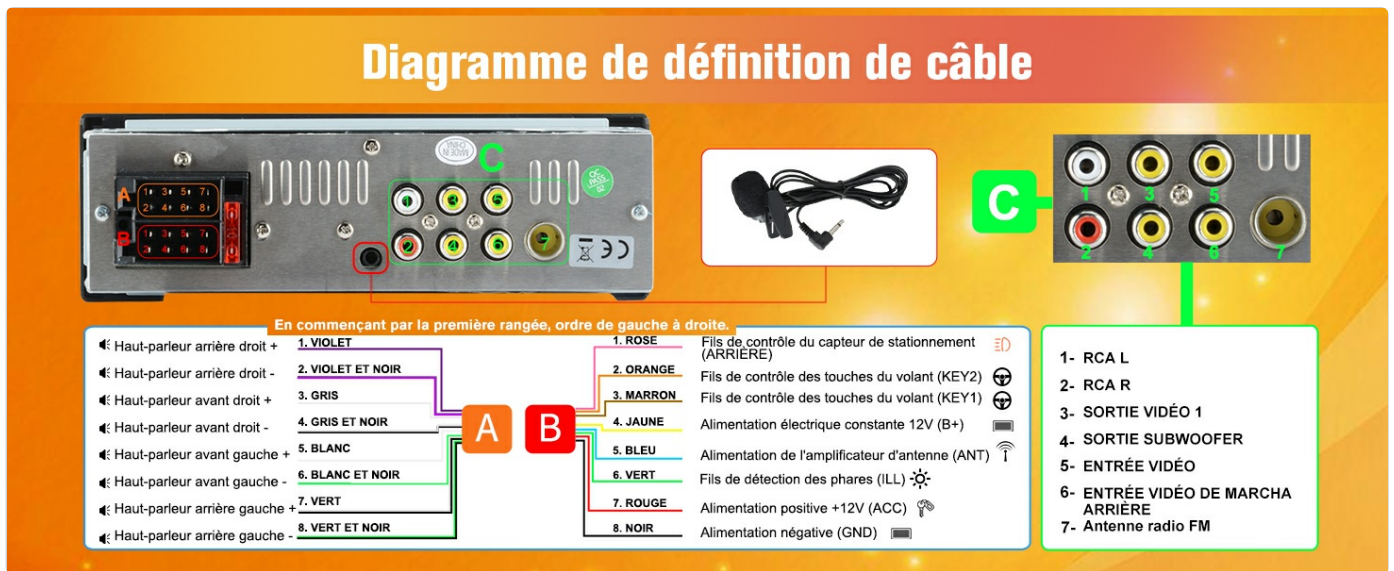

Figure 2: Cable Definition Diagram. This diagram illustrates the various cable connections for the car stereo, including power, speaker outputs, and inputs for accessories like the microphone and reversing camera.

Important Note: Some vehicles may require cutting and extending wires with the provided connectors rather than direct plug-and-play to ensure stable operation and prevent power interruptions.

2. Reversing Camera Installation

The included 720P HD reversing camera provides clear vision. Follow these steps for connection:

1. Connect the camera's video cable to the "Reverse Video Input" on the car stereo.
2. Connect the red wire from the camera's power cable to the vehicle's reverse light positive wire.
3. Connect the black wire from the camera's power cable to the vehicle's reverse light negative wire (ground).
4. Ensure the trigger wire (usually pink or brown) from the stereo's wiring harness is connected to the vehicle's reverse light positive wire. This signals the stereo to switch to the camera view when reverse gear is engaged.

Méthode de connexion de la caméra arrière

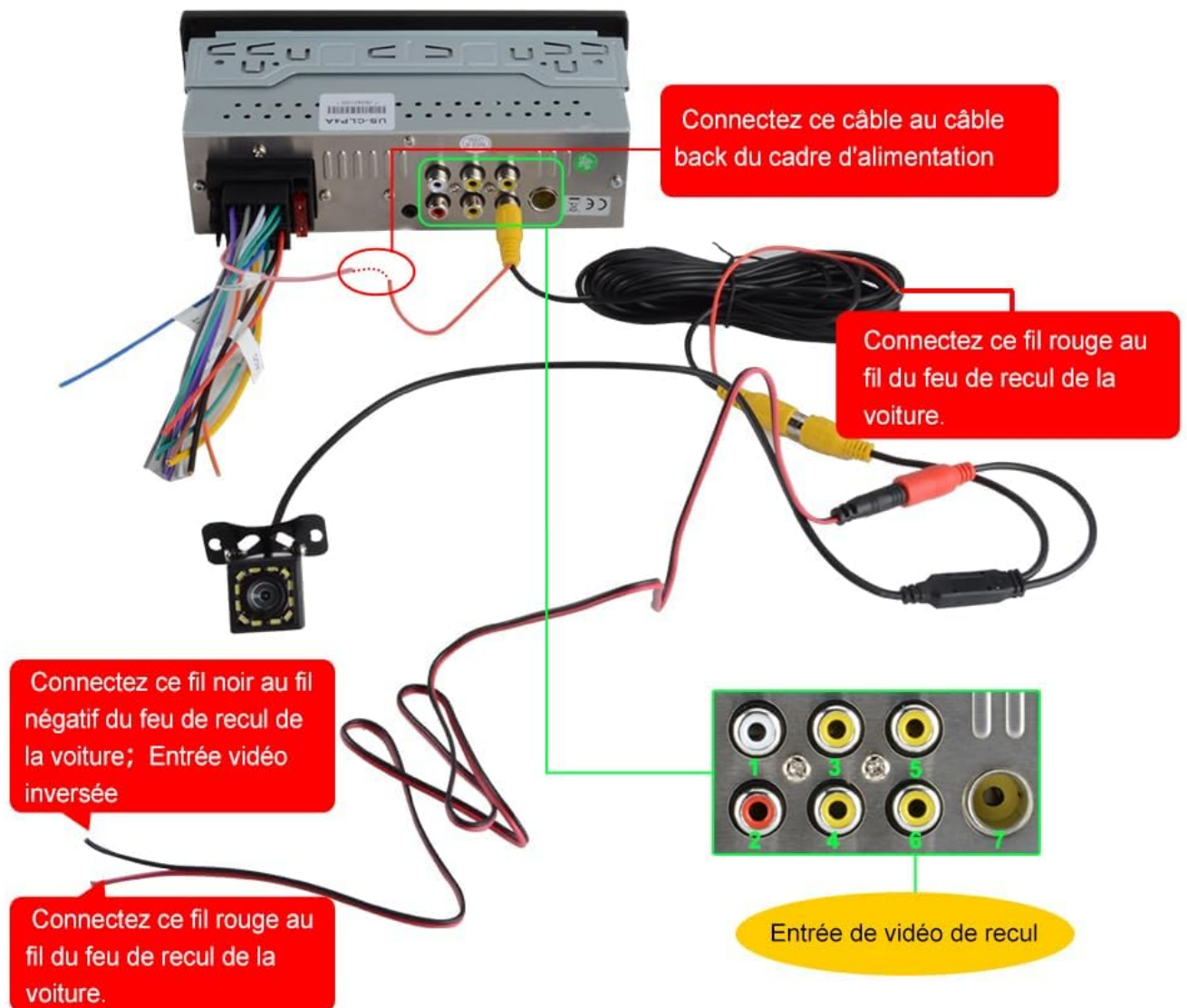

Figure 3: Rear Camera Connection Method. This diagram details the wiring connections for the reversing camera, showing how to connect it to the car stereo's video input and the vehicle's reverse light circuit for automatic activation.



Figure 4: Reversing Camera and Parking Assistance. This image shows the car stereo display when the reversing camera is active, featuring parking guidelines and visual aids for safe maneuvering.

3. Physical Installation

Once wiring is complete, carefully slide the car stereo into the 1 DIN slot. Secure it using the provided mounting brackets and screws. Ensure the screen is positioned correctly and does not obstruct other vehicle controls.



Figure 5: Before and After Installation. This comparison illustrates the transformation from a traditional car radio to the modern AWESAFE touchscreen unit, highlighting the integrated appearance after installation.

OPERATING INSTRUCTIONS

1. Power On/Off and Basic Controls

Press the power button (usually integrated with the volume knob) to turn the unit on or off. Rotate the knob to adjust volume. Use the touchscreen for most other functions.



Figure 6: Front Panel Overview. This image shows the front of the car stereo, highlighting the 6.36-inch touchscreen display, volume knob, USB ports, and microphone input.

2. Wireless CarPlay and Android Auto

Connect your smartphone via Bluetooth and Wi-Fi, or using a USB cable, to access Wireless CarPlay or Android Auto. This allows for navigation, calls, messages, and music playback through the stereo's interface, with voice control via Siri or Google Assistant.

- **Wireless Connection:** Enable Bluetooth and Wi-Fi on your smartphone. Pair your phone with the car stereo via Bluetooth. Once paired, the system will prompt you to connect to CarPlay or Android Auto wirelessly.
- **Wired Connection:** Connect your smartphone to the stereo's USB port using a compatible USB cable. The system will automatically detect and launch CarPlay or Android Auto.

Carplay/Android Auto



Figure 7: CarPlay and Android Auto Connectivity. This image demonstrates the seamless integration of CarPlay and Android Auto, showing the stereo display mirroring smartphone functions for navigation, communication, and entertainment.

Carplay sans fil/filaire

En utilisant ce modèle d'autoradio, vous pouvez profiter de fonctions telles que la navigation, passer des appels, envoyer et recevoir des messages, et écouter de la musique grâce à CarPlay dans votre voiture.



Figure 8: Wireless/Wired CarPlay. This graphic explains how to connect your iPhone to the car stereo for CarPlay functionality, supporting both wireless (Bluetooth + Wi-Fi) and wired (USB) connections.

Android auto sans fil/filaire

En utilisant ce modèle d'autoradio, vous pouvez connecter votre smartphone Android à la système de votre voiture sans effort.



Figure 9: Wireless/Wired Android Auto. This graphic explains how to connect your Android smartphone to the car stereo for Android Auto functionality, supporting both wireless (Bluetooth + Wi-Fi) and wired (USB) connections.

3. Bluetooth 5.0 for Hands-Free Calls and Music

The integrated Bluetooth 5.0 allows for clear hands-free calls and stable audio streaming. Pair your phone with the stereo via Bluetooth settings. The noise-reduction microphone ensures call clarity.

Appels & Musique Bluetooth

Une fois connecté au Bluetooth, vous pouvez également utiliser la fonction d'assistant vocal pour passer des appels et écouter de la musique plus rapidement.



Figure 10: Bluetooth Calls and Music. This image illustrates the car stereo's interface for managing Bluetooth phone calls and streaming music, emphasizing the hands-free capabilities.

Appels & Musique Bluetooth

Une fois connecté au Bluetooth, vous pouvez également utiliser la fonction d'assistant vocal pour passer des appels et écouter de la musique plus rapidement.



Figure 11: Enhanced Bluetooth Experience. This graphic highlights the stereo's ability to handle both phone calls and music playback simultaneously via Bluetooth, with clear audio transmission.

4. FM Radio Operation

Access the FM radio function from the main menu. The frequency range is 87.5 MHz - 108.0 MHz.

- **Tuning:** Use the on-screen arrows or swipe gestures to fine-tune the frequency.
- **Band Selection:** Press the BAND or FM button to switch between FM1, FM2, and FM3 bands.
- **Local/Distant (LOC/DX):** Adjust sensitivity for local or distant stations.

Fonction égaliseur Radio FM

FM : 87,5 MHz - 108,0 MHz

Vous pouvez configurer le son de l'égaliseur selon vos préférences.

1. Boutons de commande pour le son stéréo
2. Bouton de commande pour LOC/DX
3. Appuyez sur le [] Bouton BAND ou bouton FM pour basculer entre FM1~FM3 .

Appui court [] et [] L'icône peut être affinée point par point. Vous pouvez également faire glisser le curseur pointé par la flèche rouge vers la gauche et la droite pour sélectionner directement la fréquence souhaitée.

Figure 12: FM Radio and Equalizer Function. This image displays the FM radio interface, showing frequency selection and the option to access the audio equalizer settings for customized sound.

5. Audio Equalizer

The integrated equalizer offers multiple sound profiles (Rock, Pop, Jazz, Classic) and manual adjustment to tailor the audio output to your preferences. Access the equalizer settings through the audio menu.

6. Steering Wheel Controls

The stereo supports steering wheel controls, allowing you to adjust volume, change tracks, answer/end calls, and more without taking your hands off the wheel. Refer to your vehicle's manual for programming steering wheel controls if necessary.

Commandes au volant

Compatible avec le Commande au volant offre la possibilité de commander le récepteur radio à l'aide des boutons situés sur le volant. Il inclut les fonctions suivantes : régler le volume, changer la musique, répondre/terminer un appel...



Figure 13: Steering Wheel Control Compatibility. This image demonstrates how the car stereo integrates with existing steering wheel controls, allowing for convenient operation of audio and call functions.

Commandes au volant

Compatible avec le Commande au volant offre la possibilité de commander le récepteur radio à l'aide des boutons situés sur le volant. Il inclut les fonctions suivantes : régler le volume, changer la musique, répondre/terminer un appel...



Figure 14: Steering Wheel Control Functions. This graphic highlights the various functions that can be controlled directly from the steering wheel, such as volume adjustment, track skipping, and call management.

MAINTENANCE

- **Screen Cleaning:** Use a soft, lint-free cloth to clean the touchscreen. Do not use abrasive cleaners or solvents.
- **General Cleaning:** Keep the unit free from dust and debris. Use a dry cloth for external surfaces.
- **Software Updates:** Check the manufacturer's website periodically for any available software updates to ensure optimal performance and new features.
- **Avoid Extreme Temperatures:** Do not expose the unit to extreme heat or cold, as this can affect performance and lifespan.

TROUBLESHOOTING

Problem	Possible Cause	Solution
Unit does not power on.	Incorrect wiring; Blown fuse; Vehicle power issue.	Check power connections (ACC, B+). Verify vehicle fuse. Consult a professional installer.
No sound.	Volume too low; Mute activated; Speaker wiring issue.	Increase volume. Check if mute is active. Verify speaker connections.
CarPlay/Android Auto not connecting.	Bluetooth/Wi-Fi off; Incorrect USB cable; Phone compatibility.	Ensure Bluetooth/Wi-Fi is on. Try a different USB cable. Check phone compatibility with CarPlay/Android Auto. Restart phone and stereo.
Reversing camera not displaying.	Incorrect camera wiring; Reverse trigger not connected.	Verify camera power and video connections. Ensure the reverse trigger wire is correctly connected to the vehicle's reverse light.
Screen freezes or restarts.	Software glitch; Power instability.	Perform a soft reset (refer to manual for specific steps). Ensure stable power supply to the unit. If persistent, contact support.

SPECIFICATIONS

Feature	Detail
Brand	AWESAFE
Model Number	759973262938
Display	6.36" HD IPS Touchscreen
Connectivity Technology	Bluetooth 5.0, USB, Wi-Fi
Special Features	Wireless Apple CarPlay, Wireless Android Auto, Integrated Bluetooth
Compatible Devices	Smartphone, iPhone
Auxiliary Input	3.5mm Jack
Audio Output Mode	Stereo
Surround Sound Channel Configuration	5.1
Output Power	45 Watts
Number of Channels	2
Internet Applications	Netflix, YouTube (via connected smartphone)
Control Method	Touch, Voice
Item Dimensions (D x W x H)	8P x 18.9L x 6.3H centimeters
Item Weight	380 Grams
Manufacturer	IBEN STORE
Country of Origin	China

WARRANTY INFORMATION

This AWESAFE product comes with a **2-year warranty** from the date of purchase. This warranty covers manufacturing defects and malfunctions under normal use. It does not cover damage caused by misuse, accidents, unauthorized modifications, or improper installation. Please retain your proof of purchase for warranty claims.

CUSTOMER SUPPORT

If you encounter any issues or have questions regarding your AWESAFE 1 DIN Car Stereo, please contact our customer support team. For the fastest service, have your model number (759973262938) and proof of purchase ready.

- **Online Support:** Visit the official AWESAFE website for FAQs and support resources.
- **Email Support:** Refer to your product packaging or the official website for contact email.

