

HEBECA FT2001

HEBECA FT2001 2-in-1 Rechargeable Nose and Ear Hair Trimmer User Manual

Model: FT2001 | Brand: HEBECA

INTRODUCTION

This manual provides detailed instructions for the safe and effective use of your HEBECA FT2001 2-in-1 Rechargeable Nose and Ear Hair Trimmer. Please read all instructions carefully before first use and retain this manual for future reference.



Image: The HEBECA FT2001 trimmer, showing both the nose/ear trimmer head and the eyebrow/facial hair trimmer head, along with the USB charging cable and travel pouch.

SAFETY INFORMATION

WARNING:

- Do not use the device while it is charging.
- Keep the device away from water sources, except when cleaning the detachable cutter head under running water.
- Improper use may cause skin irritation. Always follow the operating instructions carefully.

PRODUCT COMPONENTS

Your HEBECA FT2001 trimmer package includes the following items:

- HEBECA FT2001 Trimmer Body
- Nose/Ear Hair Trimmer Head

- Eyebrow/Facial Hair Trimmer Head
- USB Charging Cable (Type-C)
- Travel Pouch

SAFETY PITCH DESIGN

Only cut short, not light
Leave suitable nasal hair to protect nasal cavity



Image: A close-up view of the two interchangeable trimmer heads: the conical nose/ear trimmer head and the flat eyebrow/facial hair trimmer head.

SETUP

1. Charging the Device

1. Ensure the trimmer is turned off.
2. Connect the USB Type-C charging cable to the charging port at the bottom of the trimmer.
3. Plug the other end of the USB cable into a compatible USB power source (e.g., computer, adapter, power bank, car charger).
4. The charging indicator light will illuminate during charging. A full charge typically takes approximately 1 hour and provides up to 60 minutes of continuous use.
5. Disconnect the charger once fully charged.

SAFE & PAINLESS TRIMMING

Say Goodbye To Painful Hair Removal

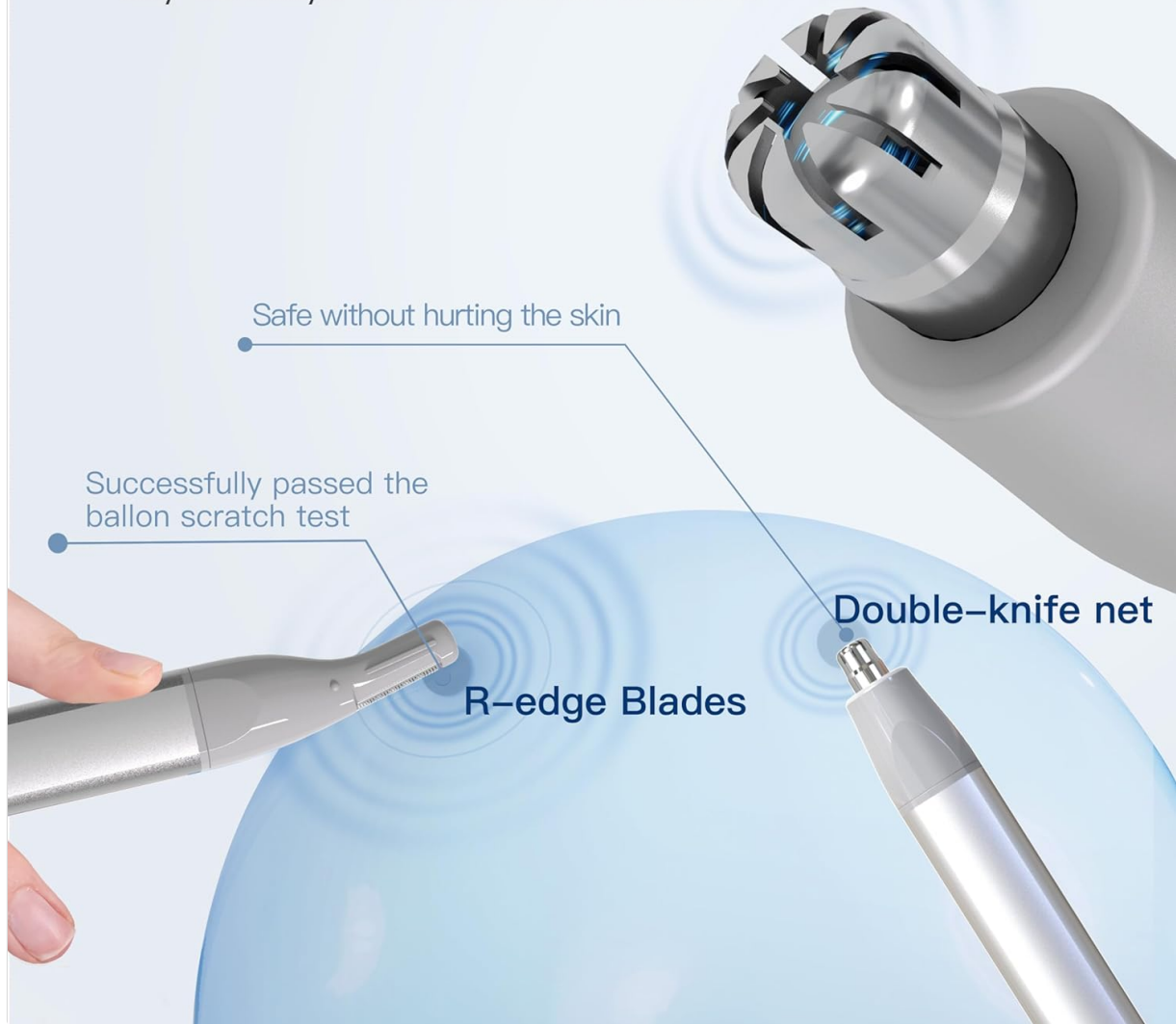

Image: The HEBECA FT2001 trimmer connected via its USB-C port to a charging cable, illustrating the charging process.

2. Attaching Trimmer Heads

1. Ensure the trimmer is turned off.
2. Gently twist and pull the currently attached head to remove it.
3. Align the desired trimmer head (nose/ear or eyebrow/facial hair) with the trimmer body.
4. Push down and twist clockwise until it clicks securely into place.

OPERATING INSTRUCTIONS

General Operation

- To turn on the trimmer, slide the power switch upwards.
- To turn off the trimmer, slide the power switch downwards.

Using the Nose/Ear Hair Trimmer Head

1. Ensure the nose/ear hair trimmer head is securely attached.
2. Gently insert the trimmer tip into your nostril or ear canal.
3. Move the trimmer in a circular motion to trim unwanted hair. Avoid inserting the trimmer too deeply to

prevent injury.

4. The 360° dual-blade system is designed for precise trimming without pulling or nicks.



Image: A man demonstrating the use of the nose hair trimmer head, showing how to gently insert it into the nostril for trimming.

Using the Eyebrow/Facial Hair Trimmer Head

1. Ensure the eyebrow/facial hair trimmer head is securely attached.
2. For eyebrows, use the trimmer to shape and remove stray hairs. Move against the direction of hair growth for best results.
3. For other facial hair (e.g., upper lip, chin), hold the trimmer flat against the skin and move it gently to remove hair.

MULTI-FUNCTIONAL USE



Trim ear hair

Trim nose hair



Trim the eyebrow



Trim beard



Trim chest hair



Trim lip hair



Trim hand hair

Image: An illustration demonstrating the multi-functional use of the trimmer for ear hair, nose hair, and eyebrow trimming.

MAINTENANCE

Cleaning the Trimmer Heads

1. Turn off the trimmer and detach the trimmer head.
2. Rinse the detachable cutter head directly under running water to remove hair clippings.
3. Shake off excess water and allow the head to air dry completely before reattaching or storing.
4. The trimmer body is also waterproof and can be rinsed under running water. Ensure the charging port cover is closed if rinsing the body.



Image: A hand holding the trimmer head under running water, demonstrating its waterproof design for easy cleaning.

Storage

- Store the trimmer and its accessories in the provided travel pouch when not in use.
- Keep the device in a cool, dry place, away from direct sunlight and extreme temperatures.

TROUBLESHOOTING

Problem	Possible Cause	Solution
Trimmer does not turn on.	Battery is depleted.	Charge the trimmer for approximately 1 hour.
Trimmer is not cutting effectively.	Trimmer head is clogged with hair or not properly attached.	Clean the trimmer head thoroughly. Ensure the head is securely attached to the body.
Skin irritation occurs after use.	Improper technique or sensitive skin.	Ensure gentle movements. If irritation persists, discontinue use.

SPECIFICATIONS

Feature	Detail
Model Number	FT2001
Brand	HEBECA
Power Source	Battery Powered (Rechargeable via USB-C)
Battery Type	1 C battery (included)
Charging Time	Approx. 1 hour
Operating Time	Up to 60 minutes (fully charged)
Motor Speed	8,000 RPM
Blade System	360° Dual-Blade (Nose/Ear), R-edge Blades (Eyebrow/Facial)
Waterproof Rating	Yes (detachable heads and body can be rinsed)
Product Dimensions	5.7 x 0.7 x 0.68 inches
Item Weight	2.3 ounces
Manufacturer	SHENZHEN HEBECA TECHNOLOGIES CO.,LTD

WARRANTY AND SUPPORT

For warranty information and customer support, please refer to the documentation included with your product or visit the official HEBECA website. Contact details for the manufacturer, SHENZHEN HEBECA TECHNOLOGIES CO.,LTD, can typically be found on the product packaging or their official online channels.

LEGAL DISCLAIMER

Statements regarding dietary supplements have not been evaluated by the FDA and are not intended to diagnose, treat, cure, or prevent any disease or health condition. This product is intended for personal grooming purposes only.