



Manuals+



[Manuals.plus](#) /

> [Roinvou](#) /

> Roinvou 4+64G Android 15 Car Radio Instruction Manual for Toyota Camry 2006-2011

Roinvou 4+64G Android 15 Car Radio

Roinvou 4+64G Android 15 Car Radio Instruction Manual

FOR TOYOTA CAMRY 2006-2011

1. Introduction

Thank you for choosing the Roinvou 4+64G Android 15 Car Radio. This manual provides detailed instructions for the installation, operation, and maintenance of your new car stereo system. Please read this manual thoroughly before use to ensure proper functionality and safety.

This advanced car radio features a 9-inch high-resolution touchscreen, wireless CarPlay and Android Auto, robust performance with Android 15, and integrated GPS navigation. It is designed to enhance your driving experience with modern connectivity and entertainment options.



Figure 1: Overview of Roinvou Car Radio Features. This image highlights key functionalities such as CarPlay, Android Auto, IPS Touchscreen, 1280x720 resolution, EQ settings, and Bluetooth connectivity.

Your browser does not support the video tag.

Video 1: "More Features of Our Products" - This video provides a visual demonstration of the various features and capabilities of the Roinvou car radio, offering a quick overview of its functionality.

2. Vehicle Compatibility

This Roinvou Android car radio is specifically designed for Toyota Camry models manufactured between 2006 and 2011. It is fully compatible with both factory JBL sound systems and models equipped with original large screens.

To ensure proper fitment, please verify your car's model and production year. If you have any doubts regarding compatibility, please contact customer support with your car's details and a picture of your dashboard.



Figure 2: Toyota Camry 2006-2011 Dashboard Compatibility. This image displays various Toyota Camry dashboard configurations from 2006-2011, indicating which ones are compatible with the Roinvou car radio, including those with JBL systems and large screens.

3. Package Contents

Please check the package for the following items:

- Roinvou Car Stereo (for Toyota Camry)
- 1 x Power Cable
- 1 x Canbus
- 2 x RCA Harness
- 1 x Radio Antenna
- 1 x Radio Adapter Cable
- 1 x GPS Antenna
- 1 x AHD Backup Camera
- 1 x External Microphone
- 1 x Rear Camera Input Cable
- 2 x USB Cable
- 1 x Installation Tool & Accessories

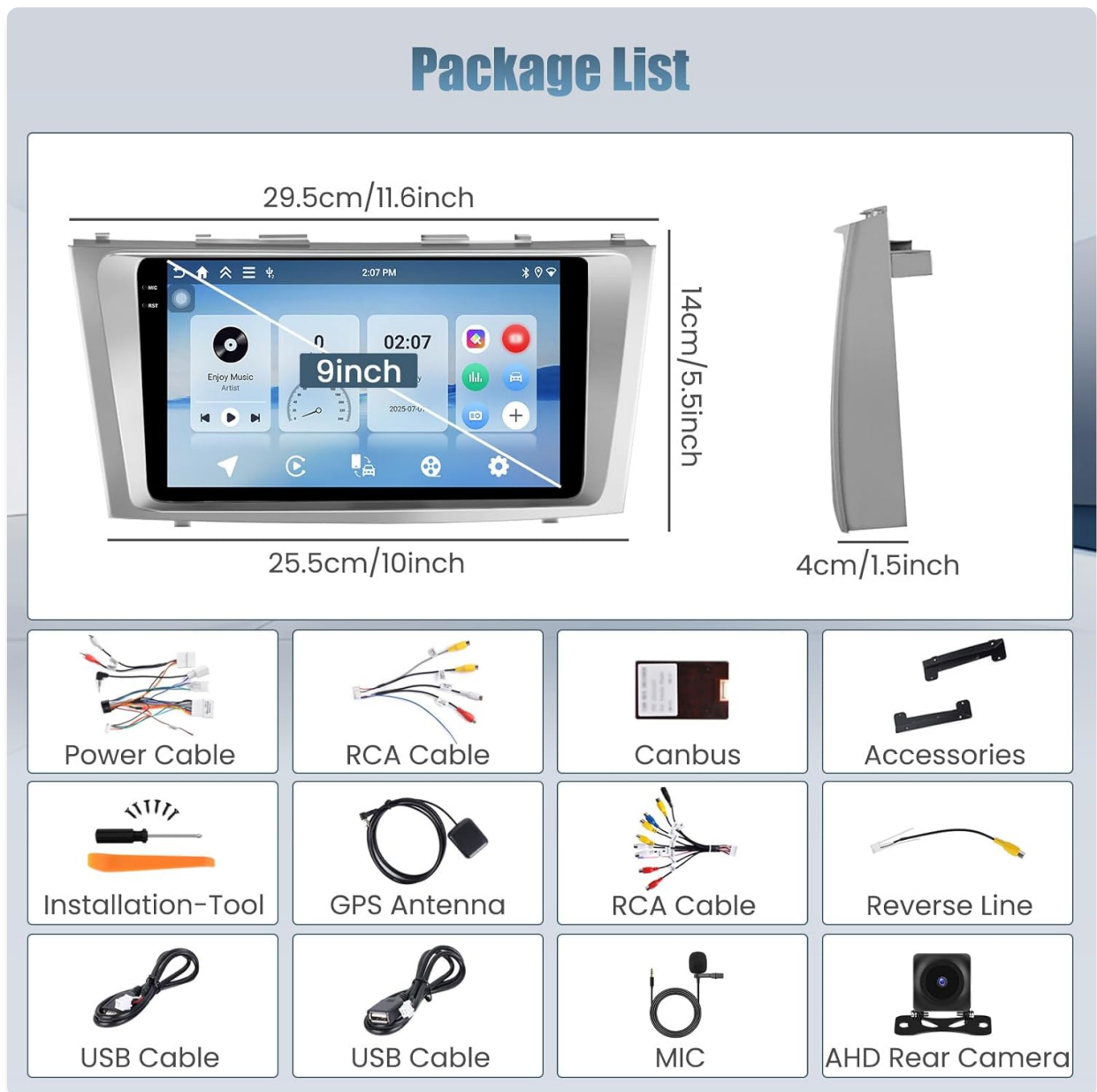

Figure 3: Package Contents. This image visually lists all the components included in the Roinvou car radio package, such as the main unit, various cables, antennas, and installation tools.

4. Setup and Installation

Professional installation is recommended. Ensure the vehicle's power is off before beginning installation.

4.1 Dashboard Panel Removal

Carefully pry out the air vent trim panel and disconnect the emergency light and vehicle status indicator light cables. Then, remove the two fixing screws at the top of the OEM head unit.

Your browser does not support the video tag.

Video 2: "How to install VQU car radio for 06-11 Toyota Camry with JBL" - This video demonstrates the step-by-step process of removing the original car radio and installing the new unit, specifically for Toyota Camry models with JBL sound systems.

Your browser does not support the video tag.

Video 3: "How to install RUICAR radio for Camry 2007-2011" - This video provides an alternative installation guide for the car radio in Toyota Camry models from 2007-2011, detailing the removal and replacement process.

4.2 Center Console Panel Removal

Pry out the center console panel. Shift the gear into 'D' and unscrew the gear shift knob. When lifting the center console panel, carefully disconnect all connecting cables on the back. Remove the two fixing screws at the bottom of the OEM head unit.

4.3 Wiring Connections

Connect the OEM wiring harness to the new unit's power cable. For newer Camry models, connect the steering wheel control cable and the radio antenna cable. For older models, these two cables may not be necessary.

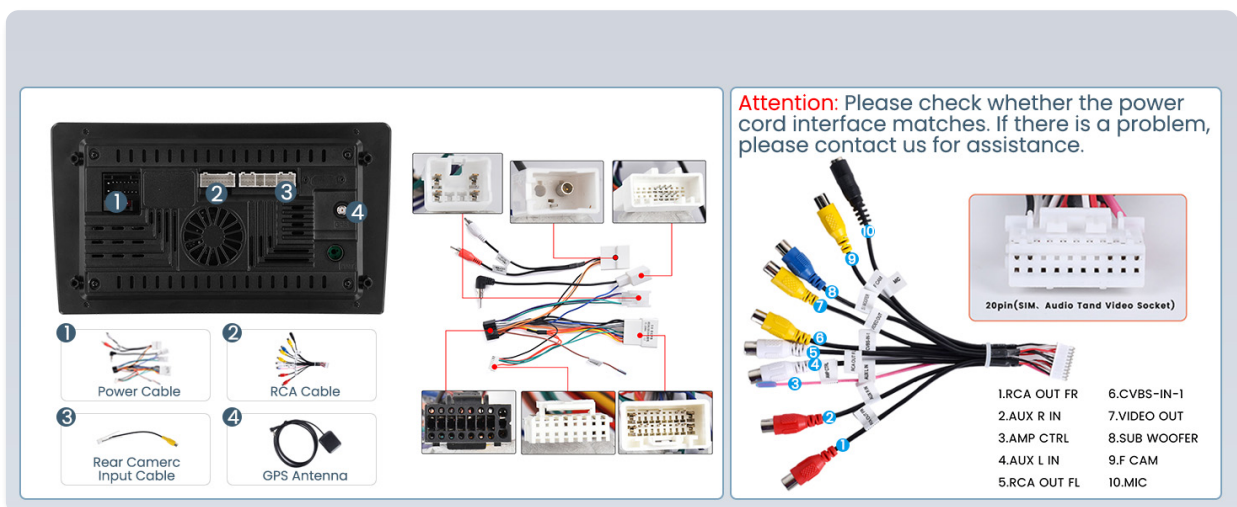

Figure 4: Port Details and Wiring Diagram. This image illustrates the various ports on the back of the car radio and provides a detailed wiring diagram for connecting the power cable, RCA harnesses, and other components.

4.4 Backup Camera Installation

Open the trim panel on the tailgate. Locate the positive wire of the reverse light and connect the red wire of the camera extension cable to it. Route the cable through the license plate light housing into the vehicle interior and connect it to the camera extension cable.

Backup Camera Wiring

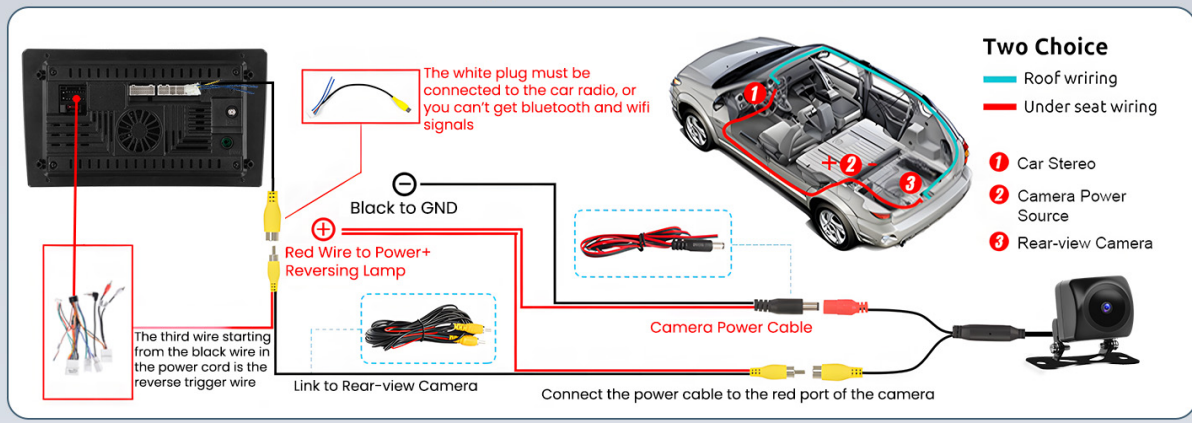

Figure 5: Backup Camera Wiring. This diagram shows how to connect the backup camera, including routing the cable through the vehicle and connecting it to the reverse light's positive pole and the car radio.

5. Operating Instructions

5.1 Wireless CarPlay & Android Auto

Enjoy effortless connectivity by mirroring your iPhone or Android phone seamlessly. Once connected, access navigation, calls, messages, and music directly on the car radio, keeping your hands on the wheel.

Your browser does not support the video tag.

Video 4: "Carplay & Android Auto & Mirror Link Connection Reference" - This video demonstrates the connection process for CarPlay, Android Auto, and Mirror Link, showing how to integrate your smartphone with the car radio.

Wireless Carplay & Android Auto & Mirror Link



Figure 6: Wireless CarPlay & Android Auto. This image illustrates the seamless integration of Wireless CarPlay and Android Auto, allowing access to GPS, music, calls, and messages directly from the car stereo.

5.2 High-Resolution Touchscreen

The 1280x720 In-Cell touchscreen delivers crisp and vibrant visuals for seamless operation. The responsive display ensures a smooth and intuitive user experience for navigation, settings, and multimedia.



Figure 7: Touchscreen Comparison. This image compares the In-Cell touchscreen of the Roinvou unit with other composite screens, highlighting its fast response, true color, and high saturation.

5.3 GPS Navigation

The unit supports BeiDou, GLONASS, GPS, and Galileo satellite navigation systems. You can use pre-installed maps or download your preferred navigation apps from the Play Store.



Figure 8: GPS Navigation. This image illustrates the GPS navigation capabilities, showing both online and offline map usage for accurate routing.

5.4 Audio & Customization

Fine-tune your listening experience with EQ settings and FM/RDS radio. The user-friendly UI supports split-screen functionality, allowing you to multitask with navigation and music simultaneously.



Figure 9: Split Screen Technology & Multiple UI Options. This image demonstrates the split-screen feature, allowing simultaneous use of navigation and music, along with various customizable UI themes.



Figure 10: FM/RDS/EQ. This image shows the interface for FM/RDS radio and EQ settings, allowing users to fine-tune audio and access radio stations.

5.5 Steering Wheel Control (SWC)

The unit is compatible with your vehicle's steering wheel controls for added convenience and safe driving. Refer to the installation video for detailed SWC setup.

Your browser does not support the video tag.

Video 5: "How to get in swc learning" - This video guides users through the process of setting up and learning steering wheel controls for the car radio.



Steering Wheel Control



Figure 11: Steering Wheel Control. This image shows the integration of steering wheel controls for safe and convenient operation of the car radio.

6. Troubleshooting

If you encounter any issues with your Roinvou car radio, please refer to the following resources:

- **Common Issues:** For general troubleshooting, consult the comprehensive guide provided by the manufacturer.
- **Touchscreen Issues:** If you experience problems with the touchscreen, there are specific videos available to help diagnose and resolve these issues.

Your browser does not support the video tag.

Video 6: "XGU Car Navigation System: How to fix touchscreen issues?" - This video provides solutions and guidance for resolving common touchscreen problems encountered with car navigation systems.

Your browser does not support the video tag.

Video 7: "Fixes 90% of Common Issues: Essential Troubleshooting Guide" - This video offers a comprehensive guide to

7. Specifications

- **Brand:** Roinvou
- **Model:** 4+64G Android 15 Car Radio
- **Operating System:** Android 15
- **Processor:** 4-core
- **RAM:** 4GB
- **Storage:** 64GB
- **Screen Size:** 9 Inches
- **Screen Resolution:** 1280 x 720 (In-Cell Touchscreen)
- **Connectivity:** Bluetooth 5.0, 5GHz WiFi, USB
- **Navigation:** GPS, BeiDou, GLONASS, Galileo (North America maps included)
- **Audio Output Mode:** Stereo
- **Special Features:** Wireless CarPlay, Android Auto, Wireless & Wired Mirror Link, FM/RDS, EQ Settings, UI Display, Split Screen, SWC (Steering Wheel Control)
- **Included Accessories:** AHD Backup Camera, External Microphone, Installation Tool

8. Warranty and Support

Your Roinvou car radio comes with a **1-Year Warranty** from the manufacturer.

For any questions, technical assistance, or warranty claims, please contact our customer support team:

- **Amazon Chat:** You can reach us directly through Amazon Chat.
- **Email:** roinvouservices@163.com

Our professional technical team and customer service team are dedicated to ensuring your satisfaction. All messages will be replied to within 24 hours, excluding holidays.

Solving Problems

Step 1

Add to Cart

Buy Now

Ships from Amazon

Sold by Roinvou

Returns 30-day replacement

Support Product support included

See more

Step 2

Have a question for Roinvou?

Ask a question

About Seller

Hello,

♥ Welcome to Roinvou store ♥

Our Advantages:

- Professional Technical Team and Customer Service Team escort your shopping experience.
- If you encounter any difficulties in using the products of our store, you can contact our seller (Roinvou) through the Amazon platform or contact our customer service team by email: roinvouservices@163.com
- All messages will be replied within **24 hours**, regardless of holidays.
- **One Year Warranty**, everything stands in the customer's point of view to provide the best.

See more

Step 3

roinvouservices@163.com

Figure 12: Customer Support. This image provides visual instructions on how to contact customer service via Amazon or email for any issues or questions.

