



Manuals.plus /

› BORNOON /

› BORNOON Shoe Cabinet BRN-090WH2 Instruction Manual

## BORNOON BRN-090WH2

# BORNOON Shoe Cabinet BRN-090WH2 Instruction Manual

Model: BRN-090WH2

## 1. IMPORTANT SAFETY INFORMATION

---

Please read all instructions carefully before assembly and use. Retain this manual for future reference.

- Always assemble the cabinet according to the provided instructions.
- Secure the cabinet to the wall using the anti-tipping wall device to prevent tipping, especially in homes with children or pets. Failure to do so can result in serious injury.
- Do not overload the cabinet beyond its weight limit.
- Keep the area around the cabinet clear to prevent tripping hazards.
- Ensure all connections are tight before use. Periodically check and re-tighten as necessary.

# Security and Stability to Ensure the Safety of Your Family

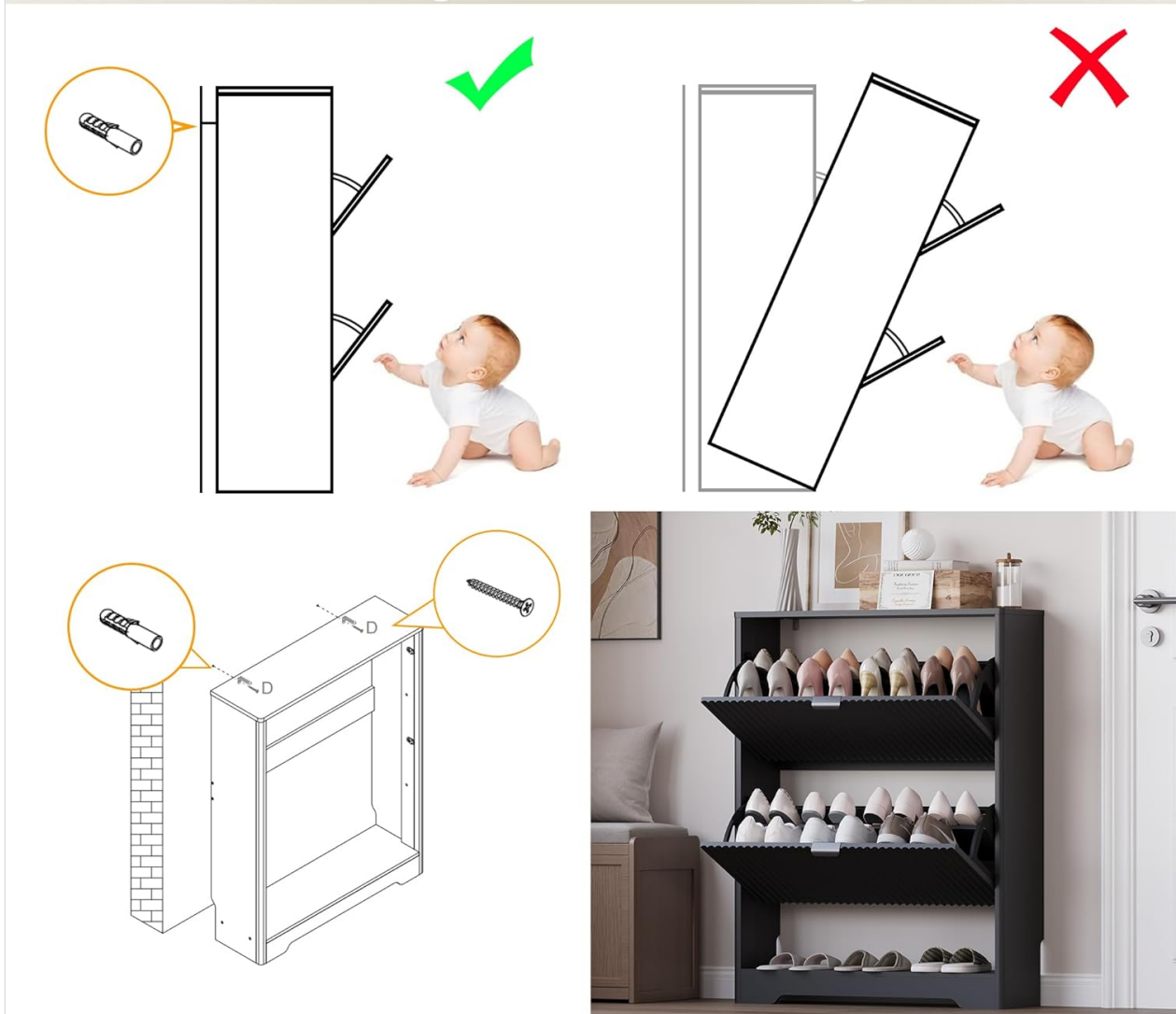

Image: Illustration of the anti-tipping wall device installation, demonstrating correct and incorrect usage to ensure stability and safety, particularly for households with children.

## 2. PRODUCT OVERVIEW

The BORNOON Shoe Cabinet BRN-090WH2 is a freestanding storage solution designed for entryways, closets, or hallways. It features two flip drawers with adjustable shelves and an additional open space at the bottom for frequently used footwear. Its sleek design and fluted cabinet fronts blend functionality with aesthetic appeal.



Image: The BORNOON Shoe Cabinet in an entryway, showcasing its two flip-down drawers filled with various shoes and its top surface used for decorative items.



Image: A full front view of the BORNOON Shoe Cabinet, highlighting its elegant fluted design, two closed flip drawers, and the convenient open storage space at the base.

### 3. PACKAGE CONTENTS

---

Before beginning assembly, ensure all parts are present and undamaged. All components are clearly labeled for easy identification.

- Cabinet panels (top, bottom, sides, back, drawer fronts)
- Flip drawer mechanisms and adjustable shelves
- Hardware pack (screws, dowels, cam locks, anti-tipping device)
- Assembly instructions manual

### 4. ASSEMBLY INSTRUCTIONS

---

Assembly is designed to be straightforward with clear, detailed instructions provided in the included manual. It is recommended to have a second person assist with assembly for stability and ease.

1. **Unpack and Identify Parts:** Carefully remove all components from the packaging. Lay them out on a

clean, soft surface to prevent scratches. Verify all parts against the included parts list.

2. **Assemble the Main Frame:** Follow the step-by-step diagrams in the separate assembly manual to connect the side panels, top, and bottom panels. Ensure all cam locks and screws are securely fastened.
3. **Install Flip Drawer Mechanisms:** Attach the drawer slides and hinges to the cabinet frame and drawer fronts as indicated in the instructions.
4. **Insert Adjustable Shelves:** Place the adjustable shelves into the flip drawers. These can be repositioned later to accommodate different shoe sizes.
5. **Attach Anti-Tipping Device:** For safety, securely attach the anti-tipping device to the top rear of the cabinet and to a wall stud using the provided hardware. This step is crucial to prevent accidental tipping.
6. **Final Checks:** Ensure all connections are tight and the cabinet is stable.

## 5. OPERATING INSTRUCTIONS

---

The BORNOON Shoe Cabinet is designed for convenient shoe storage and organization.

- **Using the Flip Drawers:** Gently pull the handle on each drawer front to tilt the drawer open. Place shoes inside with the toes pointing towards the back of the cabinet. Push the drawer front back until it closes securely.
- **Adjusting Shelves:** The internal shelves within each flip drawer are removable and adjustable. To adjust, simply lift the shelf and reposition it into the desired slots to accommodate different shoe heights (e.g., boots, heels, flats).
- **Bottom Open Space:** The open compartment at the base of the cabinet is ideal for storing frequently used shoes, slippers, or other small items for quick access.

# Flexible Shelf

Adjust to fit different kinds of shoes



✓ Removable Shelves

✓ Adjustable Shelves

Image: Detail showing the flexible shelf feature within the flip drawers, demonstrating how shelves can be removed and adjusted to fit various shoe types and sizes.



Image: The open bottom shelf of the shoe cabinet, providing convenient storage for slippers or other frequently accessed footwear.

## 6. CARE AND MAINTENANCE

---

To maintain the appearance and longevity of your BORNOON Shoe Cabinet, follow these care guidelines:

- **Cleaning:** Wipe surfaces with a soft, damp cloth. Avoid using harsh chemicals, abrasive cleaners, or polishes that may damage the laminated finish.
- **Spills:** Clean up spills immediately to prevent staining or damage to the engineered wood.
- **Placement:** Avoid placing the cabinet in direct sunlight or near heat sources, as this can cause fading or warping.
- **Weight Distribution:** Distribute weight evenly within the drawers and on the top surface to prevent stress on the structure.

## 7. TROUBLESHOOTING

---

If you encounter any issues with your shoe cabinet, please refer to the following general advice:

- **Wobbly Cabinet:** Ensure all screws and cam locks are fully tightened. Verify the cabinet is placed on a level surface. Re-check the anti-tipping device installation.
- **Drawers Not Closing Properly:** Check for any obstructions inside the drawer or along the mechanism. Ensure shoes are properly placed and not overfilling the compartment. Verify that the drawer slides are correctly installed.
- **Missing or Damaged Parts:** If you find any parts missing or damaged during assembly, please contact customer support immediately for free replacements.

## 8. PRODUCT SPECIFICATIONS

Feature	Specification
Brand	BORNOON
Model Name	BRN-090WH2
Color	Black
Product Dimensions (D x W x H)	9.4"D x 30.7"W x 40"H
Material	Engineered Wood
Mounting Type	Freestanding
Number of Drawers	2 (Flip Drawers)
Number of Shelves	1 (Adjustable within each drawer)
Item Weight	59.8 pounds
Special Features	Anti-Tip Safety, Fluted Design, Adjustable Shelves
Assembly Required	Yes



Image: Dimensional diagram of the shoe cabinet, indicating its width, depth, and height for accurate placement and planning.

## 9. WARRANTY AND SUPPORT

BORNOON is committed to providing quality products and customer satisfaction.

- **Free Replacements:** If you need help or require any replacements for missing or damaged parts, our support team is available to assist you. We will provide free replacements to resolve your problem.
- **Contact Support:** For any inquiries, assistance, or to report missing/damaged parts, please contact BORNOON customer support. Refer to your purchase documentation for specific contact details or visit the official BORNOON website.