

Manuals+

[Q & A](#) | [Deep Search](#) | [Upload](#)

manuals.plus /

- > [AIPER](#) /
- > [AIPER IrriSense Smart Irrigation System User Manual](#)

AIPER B0FJDMQZC6

AIPER IrriSense Smart Irrigation System User Manual

Model: B0FJDMQZC6

PRODUCT OVERVIEW

The AIPER IrriSense Smart Irrigation System is designed to provide intelligent and efficient watering for your lawn. It features app control for customized watering zones, schedules, and depths, ensuring your lawn receives optimal hydration while conserving water. Its robust design allows for quick installation and reliable performance.





Figure 1: AIPER IrriSense Smart Irrigation System and companion app.

Key Features:

- **Smart Lawn Irrigation with App Control:** Easily customize watering zones, schedules, and depths via app. Take full control of your irrigation system through WiFi or Bluetooth for automated, hassle-free lawn care right at your fingertips.
- **Wide-Area Coverage:** Operating at 45 PSI water pressure, the system covers up to 4,800 sq. ft. with a 39 ft. spray range. Equipped with EvenRain technology, it simulates natural rainfall, while adaptive re-spray ensures there are no blind spots.
- **Quick & Easy Setup with Durable Design:** Set up your system in just 15 minutes, no planning, digging, or professionals needed. Weighing 10.58 lbs, it's easy to move. Designed with Temperature-resistant materials for long-lasting, reliable performance.
- **Weather-Smart Technology:** Equipped with a built-in rain sensors, this smart irrigation system automatically pauses watering during rainfall. It conserves water and protects your lawn by adjusting watering schedules based on climate.
- **Smart Watering Modes & Real-Time Monitoring:** Switch between Remote Watering, Quick Watering with ease. Monitor watering time, depth, and track historical irrigation history to optimize efficiency and support your lawn's health.

SETUP GUIDE

The AIPER IrriSense system is designed for a quick and easy 15-minute DIY installation. Follow these steps to get your system up and running.

Installation Steps:

1. **Install the locator & fix the equipment:** Place the locator in your desired watering area and secure the IrriSense unit.
2. **Connect the water pipe:** Attach a 5/8" or 3/4" garden hose to the IrriSense unit.
3. **Connect the power supply:** Plug in the DC charger to the unit and a power outlet.
4. **Pair via Bluetooth:** Press and hold the pairing button for 2 seconds to connect to the app.
5. **Start mapping:** Use the app to define your custom watering zones.
6. **Begin sprinkler irrigation:** Once mapped, you can start your automated watering schedule.



Figure 2: 15-Minute DIY Installation Guide.

The system requires a minimum water pressure of 45 PSI for optimal performance and coverage up to 4,800 sq. ft. with a 39 ft. spray range.

OPERATING INSTRUCTIONS

Control your AIPER IrriSense system effortlessly through the dedicated mobile application, available for both iOS and Android devices.

App Control & Customization:

- **Custom Watering Map:** Utilize the app to create precise watering zones for your lawn, ensuring water is only applied where needed.
- **Scheduling:** Set up automated watering schedules based on days, times, and desired water depth.
- **Smart Watering Modes:** Choose between Remote Control Mode for manual water flow adjustments without altering your map, and Instant Watering Mode for quick, on-demand watering.
- **Weather-Smart Technology:** The built-in rain sensor automatically pauses watering during rainfall, preventing overwatering and conserving water. The system can also adjust schedules based on climate data.
- **Real-Time Monitoring:** Track watering time, depth, and review historical irrigation data to optimize efficiency and promote lawn health.

Customizable Watering Zones

Water Only What's Needed, No Waste

Area Coverage Max
4,800 sq. ft.

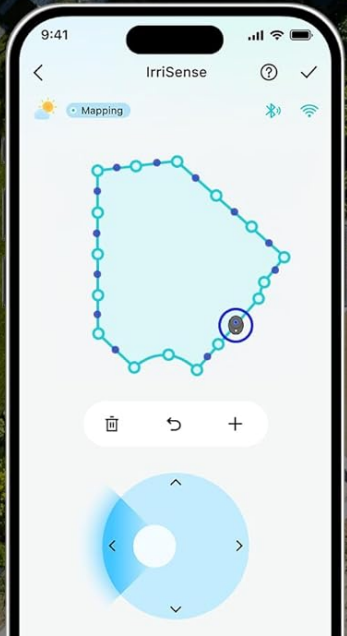

Figure 3: Customizable Watering Zones via App.

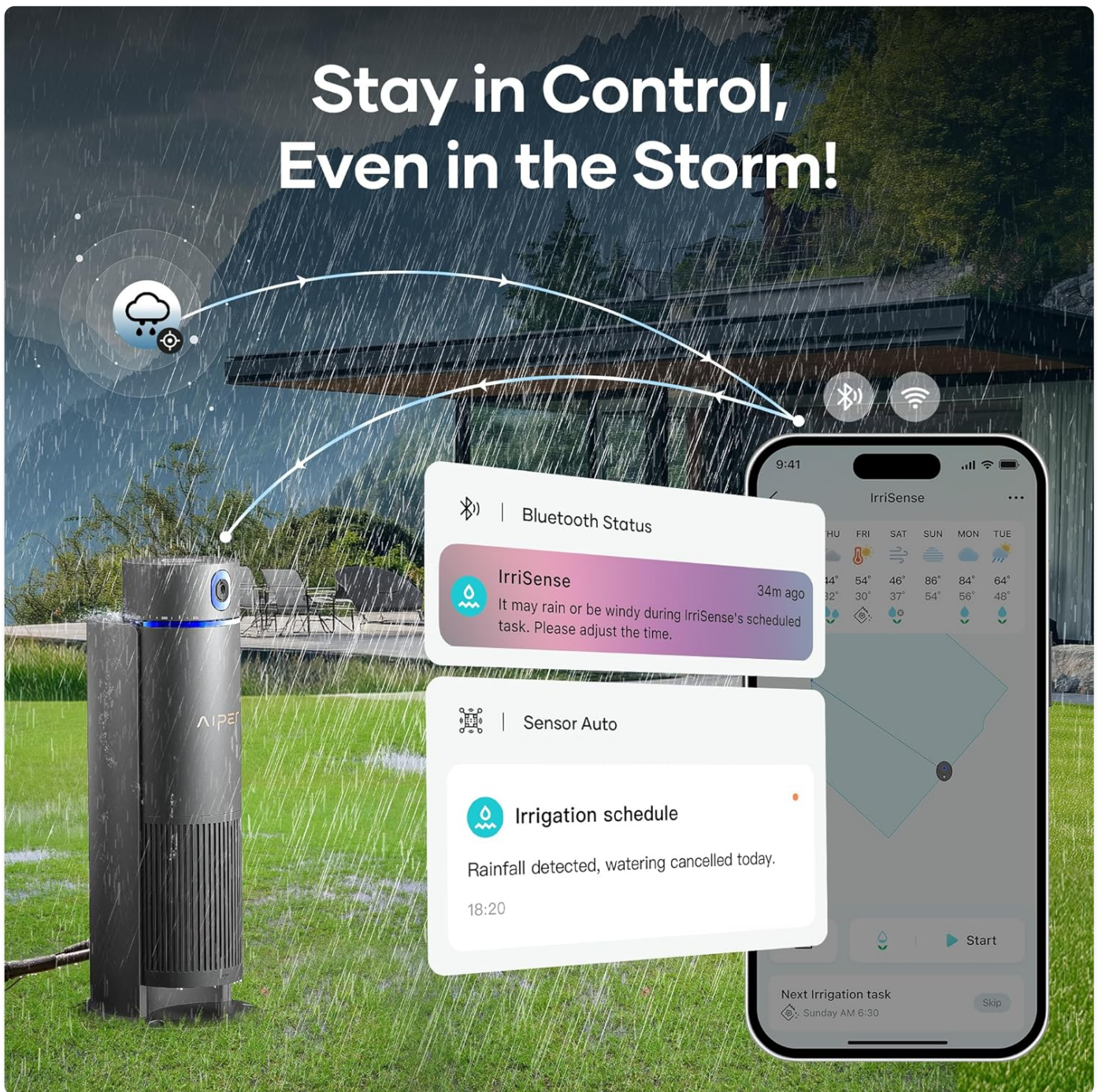

Figure 4: Weather-Smart Technology in action.

MAINTENANCE

Proper maintenance ensures the longevity and optimal performance of your AIPER IrriSense system.

General Care:

- Keep the unit clean from debris and dirt to ensure proper water flow and sensor function.
- The unit is designed with UV-resistant materials for outdoor durability.
- Features an Auto Valve Shutoff to prevent water leakage.
- Equipped with Copper Hose Fittings for corrosion resistance and durability.

Winter Drainage Mode:

To protect your system from freezing temperatures, utilize the Winter Drainage Mode. Refer to the app or detailed user

manual for specific instructions on activating this mode before the first frost.



Figure 5: Designed for Consistent Performance and Durability.

TROUBLESHOOTING

If you encounter issues with your AIPER Irrisense system, consider the following common solutions:

- **No Water Flow:** Ensure the water source is turned on and the hose is properly connected without kinks. Check for sufficient water pressure (minimum 45 PSI).
- **App Connectivity Issues:** Verify your Wi-Fi or Bluetooth connection. Ensure the Irrisense unit is within range and powered on. Try restarting the app or the unit.
- **Incorrect Watering Pattern:** Re-check your mapped zones and settings within the app. Ensure no physical obstructions are blocking the spray.
- **System Not Watering During Rain:** The built-in rain sensor is designed to pause watering during precipitation. This is normal operation. If it's not raining and the system isn't watering, check the sensor for obstructions or debris.
- **Power Issues:** Confirm the power adapter is securely connected to both the unit and a working power outlet.

For more complex issues or persistent problems, please refer to the full user manual or contact AIPER customer support.

SPECIFICATIONS

Feature	Detail
Brand	AIPER
Model	B0FJDMQZC6
Product Dimensions	8.5"L x 10"W x 22"H (21.6 x 25.4 x 55.9 cm)
Item Weight	10 Pounds (4.5 kg)
Color	Grey
Coverage Area	Up to 4,800 sq. ft.
Spray Range	Up to 39 ft. (12m)
Water Pressure Requirement	45 PSI (minimum)
Applicable Hose Size	5/8" or 3/4" Garden Hose
Included Components	Irrigation System (main unit)

WHAT'S IN THE BOX

Upon unboxing your AIPER IrriSense Smart Irrigation System, you should find the following components:



Figure 6: Box Contents.

- 1x IrriSense Unit
- 1x DC Charger
- 1x Extension Cord
- 1x Locator
- 4x Stake Kit

- 1x Hose Quick Connector Kit
- 1x Quick Guide
- 1x User Manual
- 1x Allen Key

WARRANTY AND SUPPORT

AIPER stands behind the quality of its products. For detailed warranty information, including coverage period and terms, please refer to the warranty card included in your product packaging or visit the official AIPER website.

For technical support, troubleshooting assistance, or any inquiries regarding your IrriSense system, please contact AIPER customer service through the contact information provided in your user manual or on the AIPER website. Optional protection plans are also available for extended coverage.