



Manuals.plus /

- › ADORNEVE /
- › ADORNEVE Twin Size Loft Bed with Storage Stairs Instruction Manual

ADORNEVE B0FJDKZJS1

ADORNEVE Twin Size Loft Bed with Storage Stairs Instruction Manual

Model: B0FJDKZJS1

INTRODUCTION

Thank you for choosing the ADORNEVE Twin Size Loft Bed. This manual provides detailed instructions for the assembly, operation, and maintenance of your new loft bed. Please read this manual thoroughly before beginning assembly and retain it for future reference. Ensure all components are present and undamaged before proceeding.



Figure 1: ADORNEVE Twin Size Loft Bed with Storage Stairs, 8 Drawers, and LED Lights.

SETUP AND ASSEMBLY

Assembly of the ADORNEVE Twin Size Loft Bed requires careful attention to detail. It is recommended that two adults perform the assembly. All necessary tools and an installation manual are included. Please follow the step-by-step instructions provided in the separate installation manual for detailed assembly procedures.

Key Assembly Steps:

- Unpack all components and verify against the parts list in the installation manual.
- Assemble the main bed frame structure, ensuring all connections are secure.
- Install the storage stairs, ensuring they are firmly attached and stable.
- Attach the 8 fabric drawers and integrate the 2 open storage shelves.
- Secure the wardrobe section with the hanging rod.
- Install the LED light strips and connect to the power outlet.

- Crucially, install the anti-tipping device to the wall for enhanced stability and safety.

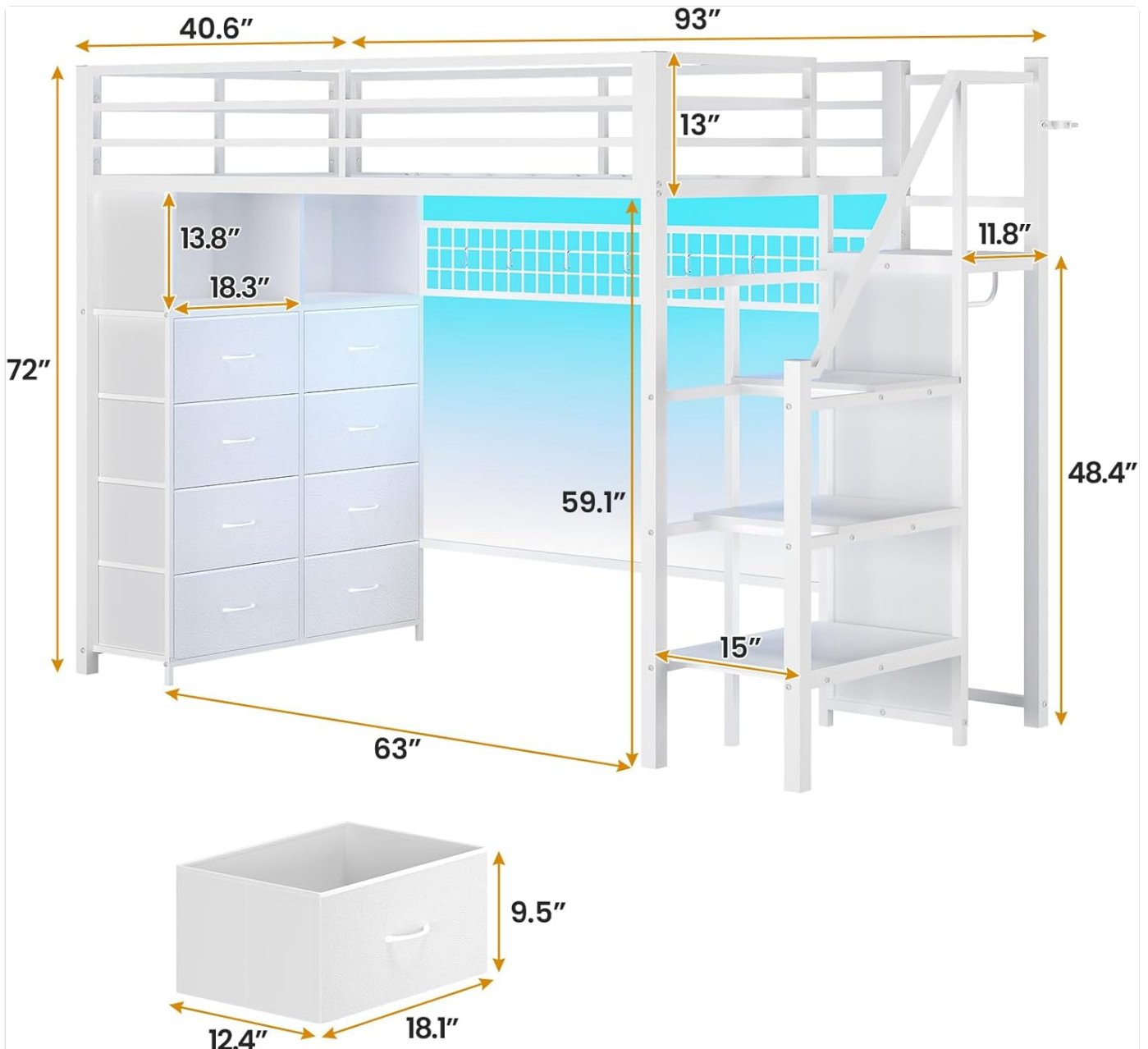

Figure 2: Illustration of the anti-tipping device installation for enhanced safety.

Your browser does not support the video tag.

Video 1: Overview of the ADORNEVE Stairway Twin Size Loft Bed with 8 Drawers, demonstrating key features and assembly aspects.

OPERATING YOUR LOFT BED

The ADORNEVE Twin Size Loft Bed is designed for multi-functional use, providing both a comfortable sleeping area and extensive storage and activity space.

Storage Features:

- **Stairs with Storage:** Each step of the stairway doubles as a spacious compartment, ideal for storing books, toys, and other small items. The wider, more stable steps ensure safe climbing.
- **8 Fabric Drawers:** The integrated dresser features 8 large fabric drawers, perfect for organizing clothes, documents, and various belongings.
- **2 Open Shelves:** Located above the drawers, these shelves provide easy access storage for frequently used items or decorative pieces.

- **Built-in Wardrobe:** An open wardrobe with a hanging rod is included, suitable for hanging school uniforms, jackets, or other garments. A built-in pegboard with 7 hooks offers additional vertical storage.



Figure 3: Detail of the stairs, highlighting the integrated storage compartments within each step.



Safety Guaranteed



13" High Safety Guardrails

Prevent People From Falling

Anti-toppling Device

Protect loft beds from tipping over

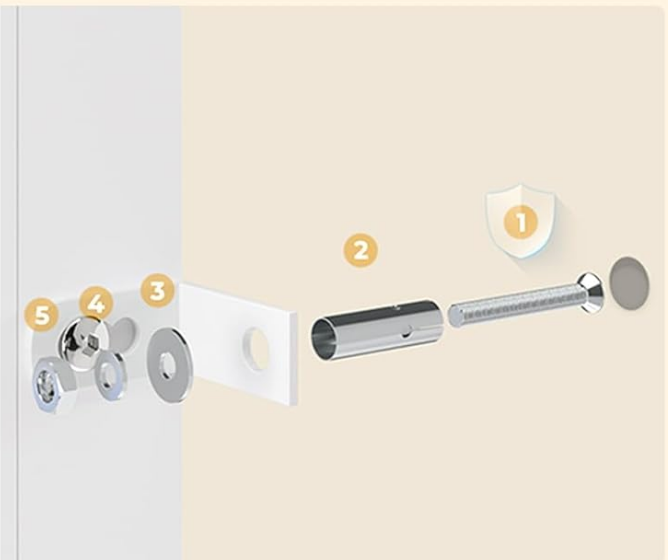

Figure 4: View of the eight large fabric drawers, demonstrating their capacity for organizing various items.



Plenty of Room for customization

Creates versatile space (study& enjoy)

Figure 5: The integrated wardrobe with a hanging rod and adjacent shelves, offering versatile storage solutions.

LED Mood Lighting:

The loft bed features RGB LED lights with over 60,000 color options. These lights can be controlled via a remote or a dedicated mobile application. Functions include music sync, microphone mode, and timing mode, allowing for customizable ambiance for study, play, or relaxation.



Hanging Rod

Wardrobe and Shelves

Provide Enough Storage Space for Cloth, Toys, Boxes

Figure 6: The RGB LED lighting system, showcasing various color options and control methods via remote and mobile app.

Under-Bed Space Utilization:

The generous under-bed space (59.1" height x 63" width) provides ample room for customization. It can accommodate a study desk, a cozy reading nook, or even a mini sofa, maximizing the utility of your living area.

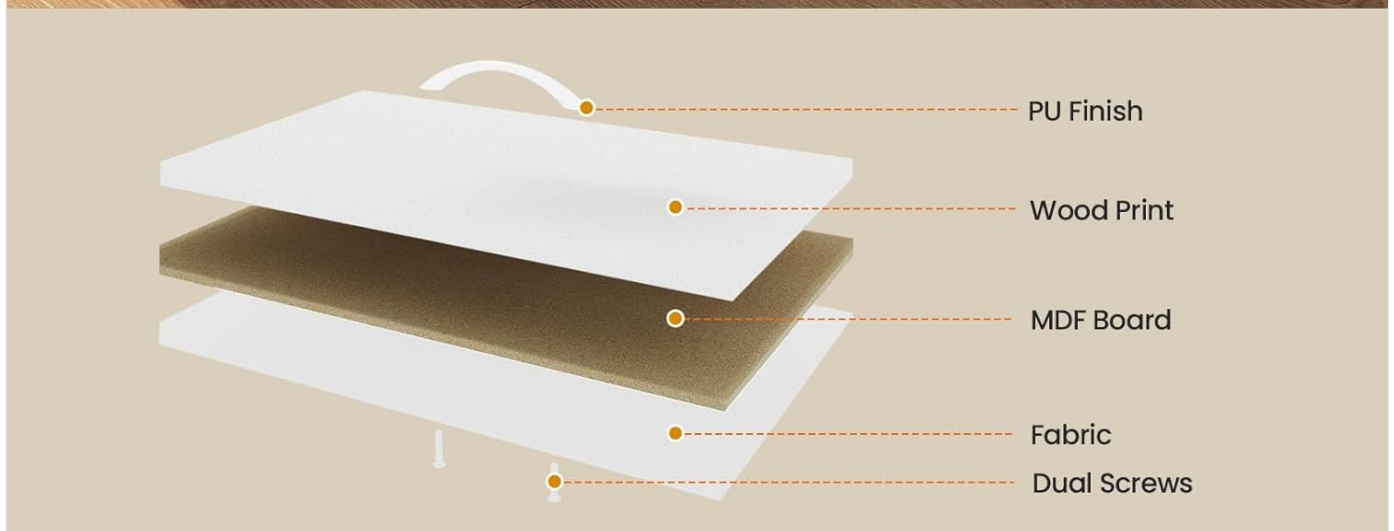
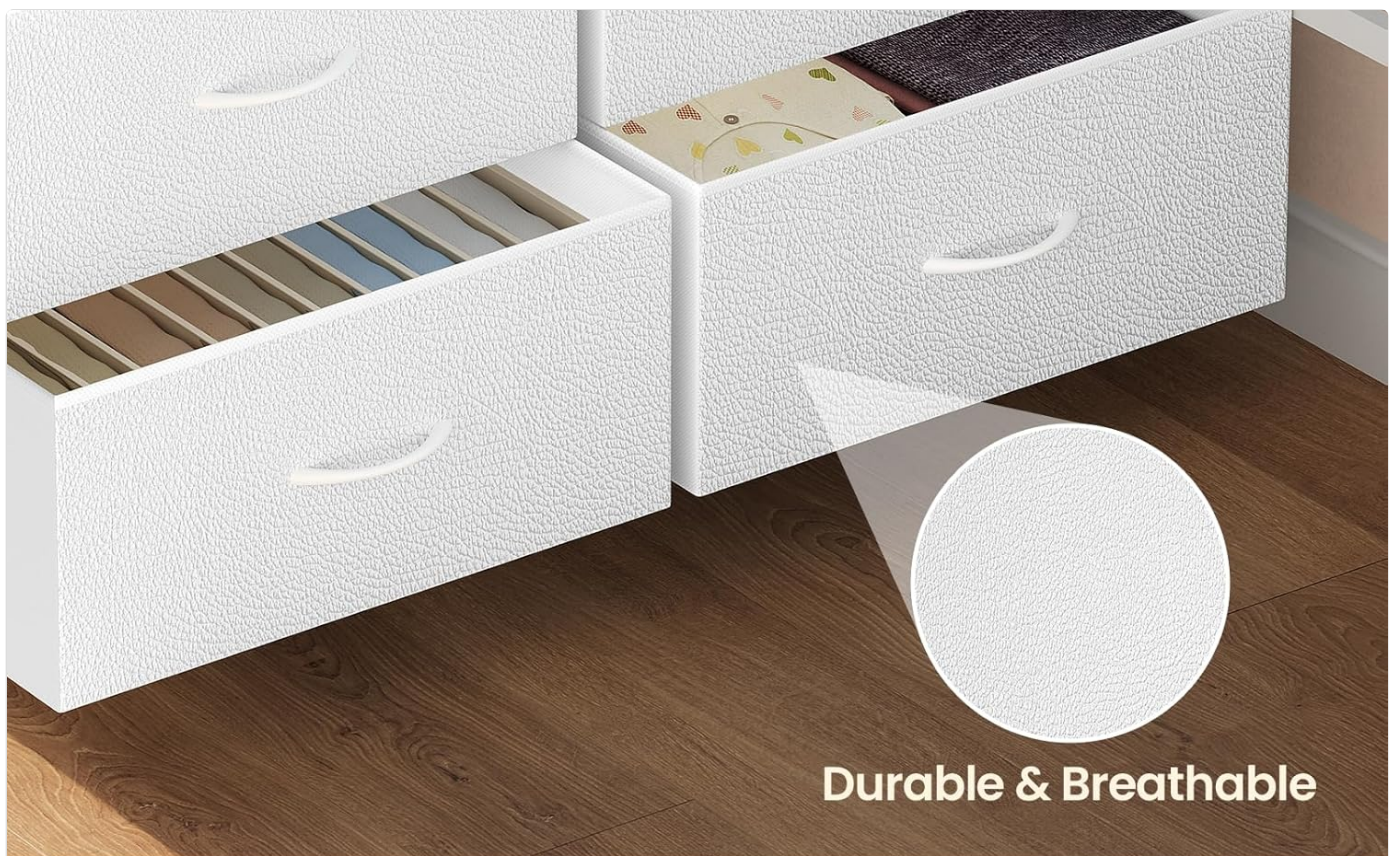

Figure 7: An illustration of the spacious area beneath the loft bed, demonstrating its potential for various uses such as a study area or lounge.

MAINTENANCE

Proper maintenance will ensure the longevity and continued performance of your ADORNEVE Loft Bed.

Cleaning:

- **Metal Frame:** Wipe down the metal frame with a soft, damp cloth. Avoid abrasive cleaners or harsh chemicals that could damage the finish.
- **Fabric Drawers:** The fabric drawers are durable and breathable. For minor spills, spot clean with a mild detergent and water. Allow to air dry completely. Do not machine wash or tumble dry.
- **LED Lights:** Gently wipe the LED strips with a dry, soft cloth. Ensure the power is off before cleaning.

Structural Integrity:

- Periodically check all bolts and screws to ensure they remain tight. Re-tighten as necessary to maintain stability.

- Verify the anti-tipping device remains securely attached to the wall.

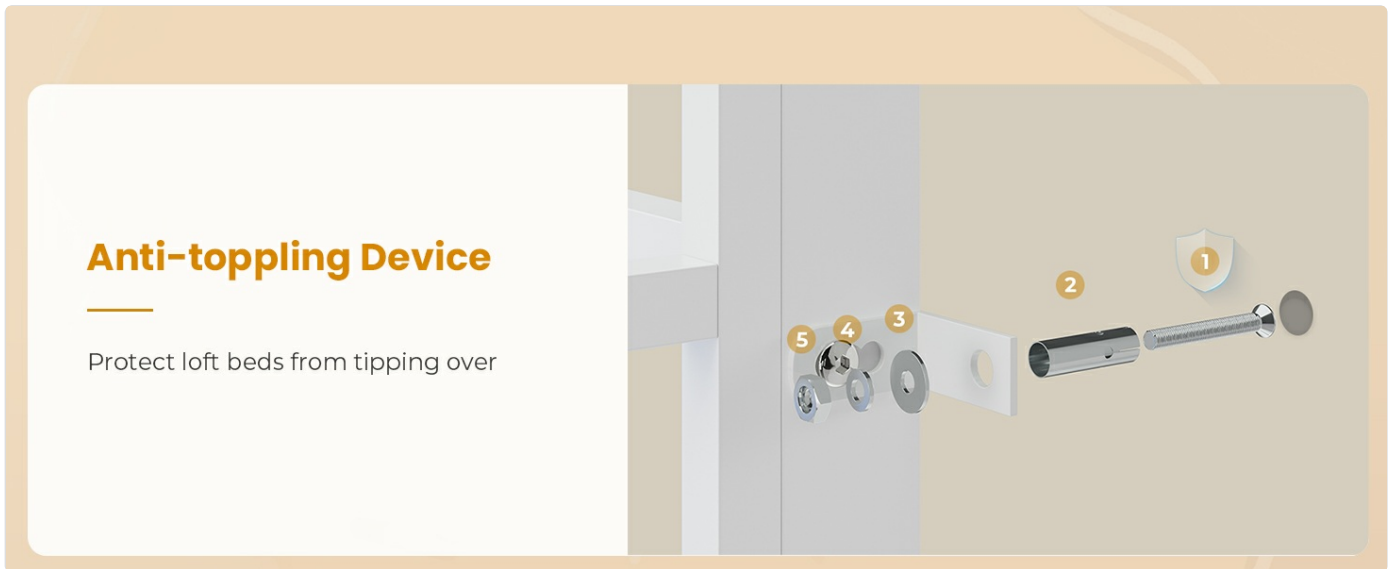

Figure 8: Close-up of the durable and breathable fabric used for the storage drawers.

TROUBLESHOOTING

This section addresses common issues you might encounter with your loft bed.

Problem	Possible Cause	Solution
Bed feels wobbly or unstable.	Loose bolts or screws; Anti-tipping device not installed or loose.	Check and tighten all assembly bolts and screws. Ensure the anti-tipping device is properly installed and secured to a wall stud.
LED lights not working.	Power connection issue; Remote control battery low; App connectivity problem.	Verify the power outlet is functioning and the LED strip is correctly plugged in. Replace remote control batteries. Re-pair the app with the LED lights if necessary.
Drawers do not slide smoothly.	Overloaded drawers; Obstruction in the drawer track.	Reduce the weight in the drawers. Check for any objects obstructing the drawer's movement.

SPECIFICATIONS

Feature	Detail
Brand	ADORNEVE
Model	B0FJDKZJS1
Size	Twin
Product Dimensions	93"L x 40.6"W x 72"H
Color	White
Material	Heavy-duty metal frame, fabric drawers
Weight Capacity	Up to 400 lbs
Recommended Mattress Thickness	4-6 inches
Safety Features	13" H Safety Guardrail, Anti-toppling Device
Included Components	Storage Stairs and 8 Drawer Cabinets, Installation Manual and Easy Assemble Tools, Loft Bed with Guardrails and LED Light
Special Features	Stairway Loft Bed, Dresser (8 Large Fabric Drawers) and 2 Storage Shelves, Wardrobe, LED Lights, Under-bed Space, No Box Spring Needed

WARRANTY AND SUPPORT

For information regarding product warranty, please refer to the warranty card included with your purchase or contact ADORNEVE customer support directly. Keep your proof of purchase for any warranty claims.

If you require further assistance, have questions about assembly, or need to report a missing/damaged part, please contact ADORNEVE customer service through the retailer where the product was purchased or visit the official ADORNEVE website for contact details.