

[Manuals.plus](#) /

> [WONLINK](#) /

> WONLINK AC1200 Outdoor Dual Band WiFi Repeater User Manual (Model WL-AP7202)

WONLINK WL-AP7202

WONLINK AC1200 Outdoor Dual Band WiFi Repeater User Manual

Model: WL-AP7202 | Brand: WONLINK

1. INTRODUCTION

Thank you for choosing the WONLINK AC1200 Outdoor Dual Band WiFi Repeater. This device is designed to extend your wireless network coverage in outdoor environments, providing stable and high-speed internet access. It features dual-band AC1200 technology, Power over Ethernet (PoE) support, and an IP66-rated weatherproof casing for reliable performance in various conditions. This manual provides essential information for proper installation, configuration, and operation of your device.

2. PRODUCT OVERVIEW

The WONLINK AC1200 Outdoor WiFi Repeater is a robust solution for extending your network outdoors. It supports 802.11ac dual-band WiFi, delivering speeds up to 1200 Mbps (300 Mbps on 2.4 GHz and 867 Mbps on 5 GHz). Its IP66-rated enclosure ensures protection against water and dust, making it suitable for gardens, pools, farms, and other outdoor settings. The device is equipped with two high-gain external antennas and a powerful PA+LNA amplifier for stable, long-range coverage.

PUISSANCE DU SIGNAL
RECOMMANDÉ 70%



Choisissez le Bon Emplacement entre la Zone à Faible Signal et le Routeur. Il est Conseillé de Placer l'AP à un Endroit où il Peut Capturer au Moins Trois Barres de Signal WiFi de Votre Routeur (Vous Pouvez le Tester avec un Téléphone Intelligent)

Le Plus Important: Assurez-Vous qu'il N'y A Pas ou Peu d'Obstacles entre Cet AP et Votre Zone à Faible Signal pour Obtenir un Signal MAX



AP



Portée Sans Fil du Routeur



Portée Sans Fil Etendue

Figure 2.1: WONLINK AC1200 Outdoor Dual Band WiFi Repeater.

Présentation du Produit

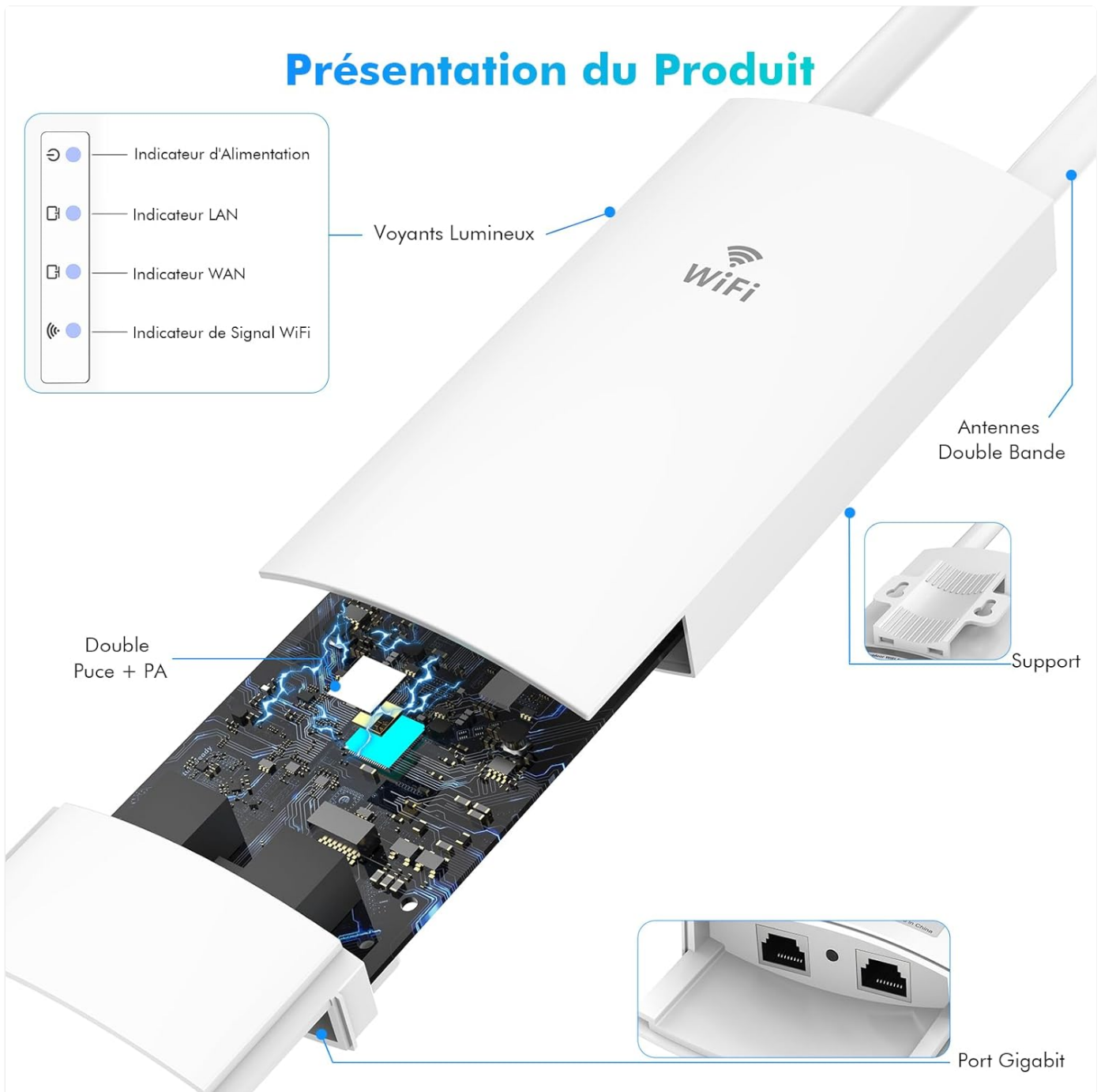

Figure 2.2: Product Presentation with LED Indicators and Gigabit Ports.

Key Features:

- **High-Speed AC1200 Dual-Band WiFi:** Up to 1200 Mbps (2.4 GHz/300 Mbps, 5 GHz/867 Mbps) for smooth streaming and gaming.
- **IP66 Weatherproof Design:** Ensures stable operation in rain, snow, wind, and extreme temperatures.
- **PoE (Power over Ethernet) Support:** Simplifies installation in areas without power outlets using a standard Ethernet cable. Includes a 48V PoE adapter.
- **Dual Gigabit Ethernet Ports:** 1000 Mbps LAN/WAN ports, backward compatible with 10/100 Mbps.
- **Multiple Operating Modes:** Supports Repeater, Access Point (AP), Router, and Bridge modes to suit various network needs.
- **Long-Range Coverage:** Two high-gain external antennas and PA+LNA amplifier eliminate dead zones.

3. PACKAGE CONTENTS

Please verify that all items are present in your package:

- 1 x WONLINK Outdoor WiFi Repeater (Model WL-AP7202)
- 1 x 48V Power over Ethernet (PoE) Adapter
- 1 x Ethernet Cable
- 1 x Instruction Manual
- Other mounting accessories (screws, wall plugs, cable ties)

4. SETUP AND INSTALLATION

Follow these steps for proper installation and initial setup of your WONLINK Outdoor WiFi Repeater.

4.1 Choosing an Installation Location

Select a location that is within range of your existing router's WiFi signal, ideally where it can receive at least three bars of WiFi signal. Ensure there are minimal obstacles between the repeater and your router, and between the repeater and the desired coverage area, to maximize signal strength and coverage.



Figure 4.1: Recommended Placement for Optimal Signal.

4.2 Physical Installation

The device supports pole mounting and wall mounting. Use the provided accessories for secure installation.

1. **Attach Antennas:** Screw the two high-gain antennas onto the connectors on top of the repeater unit.
2. **Mounting:** Secure the repeater to a pole or wall using the provided mounting kit. Ensure it is positioned vertically with antennas pointing upwards for best performance.

Prend en Charge le POE Passif et une Installation Extérieure Facile

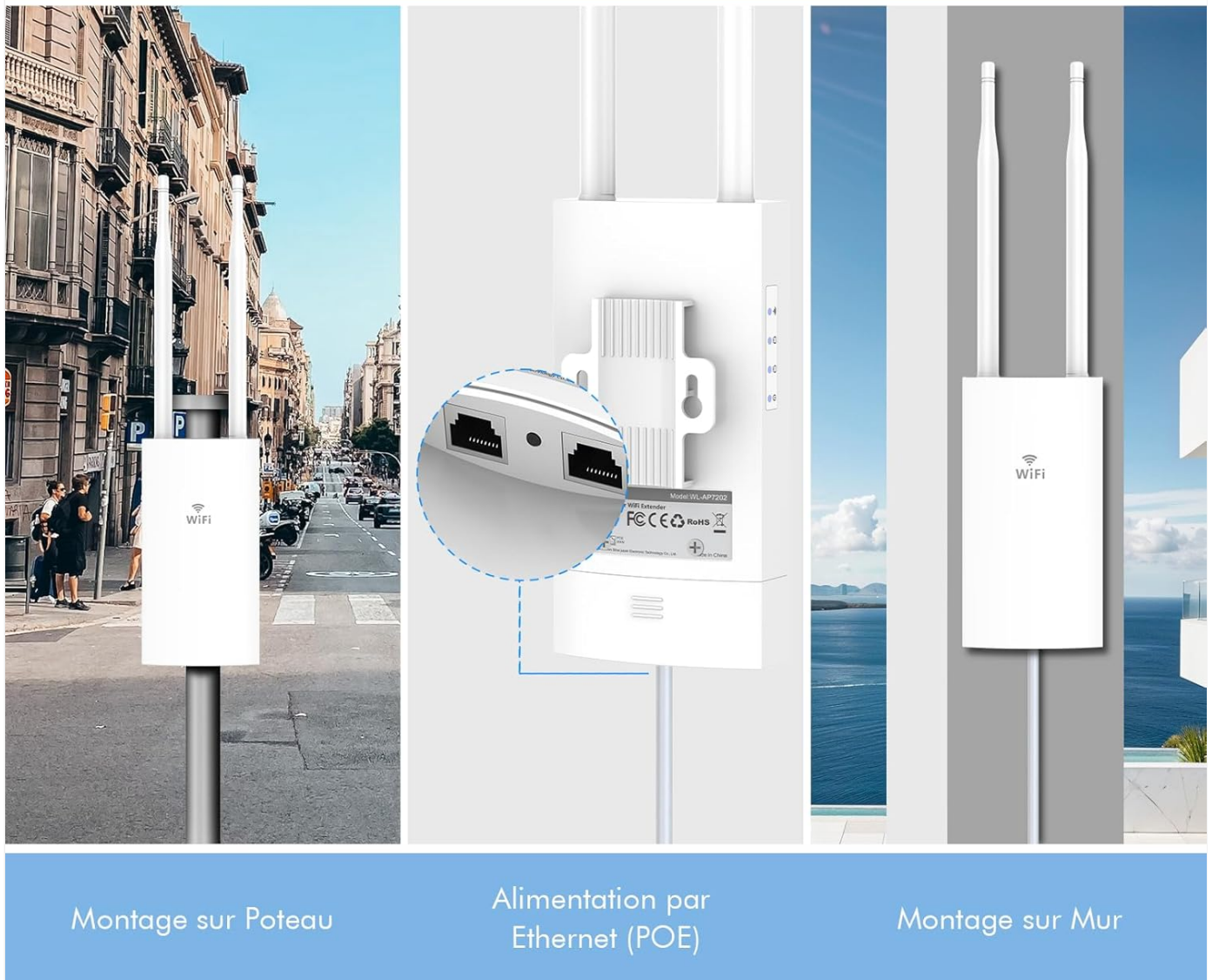

Figure 4.2: Mounting Options (Pole Mount, Wall Mount) and PoE Connection.

4.3 Powering the Device (PoE Connection)

The repeater is powered using the included 48V Power over Ethernet (PoE) adapter.

1. Open the bottom cover of the outdoor access point to access the Ethernet ports.
2. Connect one end of the Ethernet cable (up to 60 meters) to the LAN/WAN port of the repeater.
3. Connect the other end of this Ethernet cable to the 'PoE' port on the 48V PoE adapter.
4. Connect another Ethernet cable from your router or modem to the 'LAN' port on the PoE adapter.
5. Plug the PoE adapter into a standard electrical outlet. The power indicator on the repeater should light up.



Figure 4.3: PoE Connection Diagram.

4.4 Initial Configuration (Access Point Mode Example)

The easiest way to configure the device is by connecting it to a computer via Ethernet.

1. Ensure your computer is connected to the LAN port of the PoE adapter (or directly to the repeater's LAN port if not using PoE for initial setup).
2. Open a web browser and enter the default IP address (refer to the included manual for the exact default IP, typically 192.168.1.1 or 192.168.0.1).
3. Log in with the default username and password (also found in the included manual).
4. Follow the on-screen wizard to select your desired operating mode (e.g., Access Point mode).
5. Configure the WiFi network name (SSID) and password for both 2.4 GHz and 5 GHz bands.
6. Save your settings and restart the device if prompted.

5. OPERATING MODES

The WONLINK AC1200 supports multiple operating modes to adapt to various network requirements:

- **Access Point (AP) Mode:** Converts a wired connection into a wireless network. Ideal for extending an existing wired network wirelessly.
- **Repeater Mode:** Extends the coverage of an existing wireless network by repeating its signal.
- **Router Mode:** Functions as a primary router, creating a new wireless network from a modem connection.
- **Bridge Mode:** Connects two or more wired networks wirelessly.

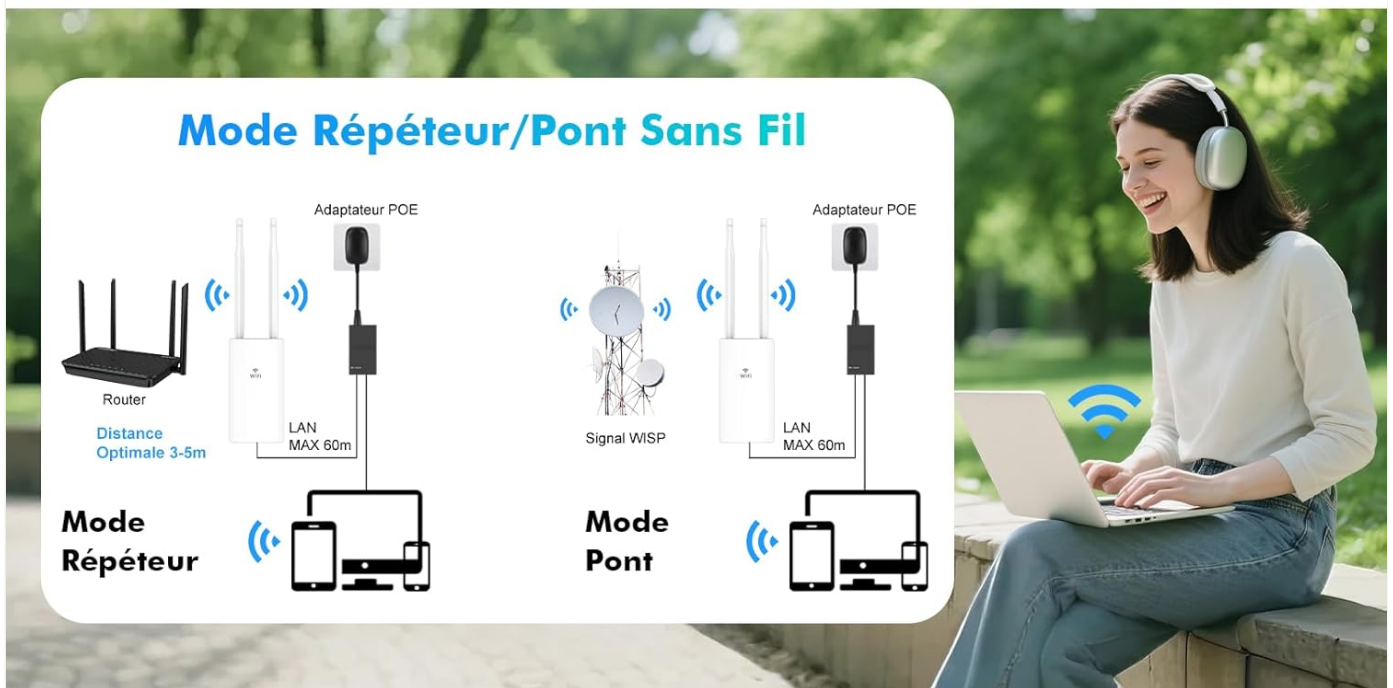
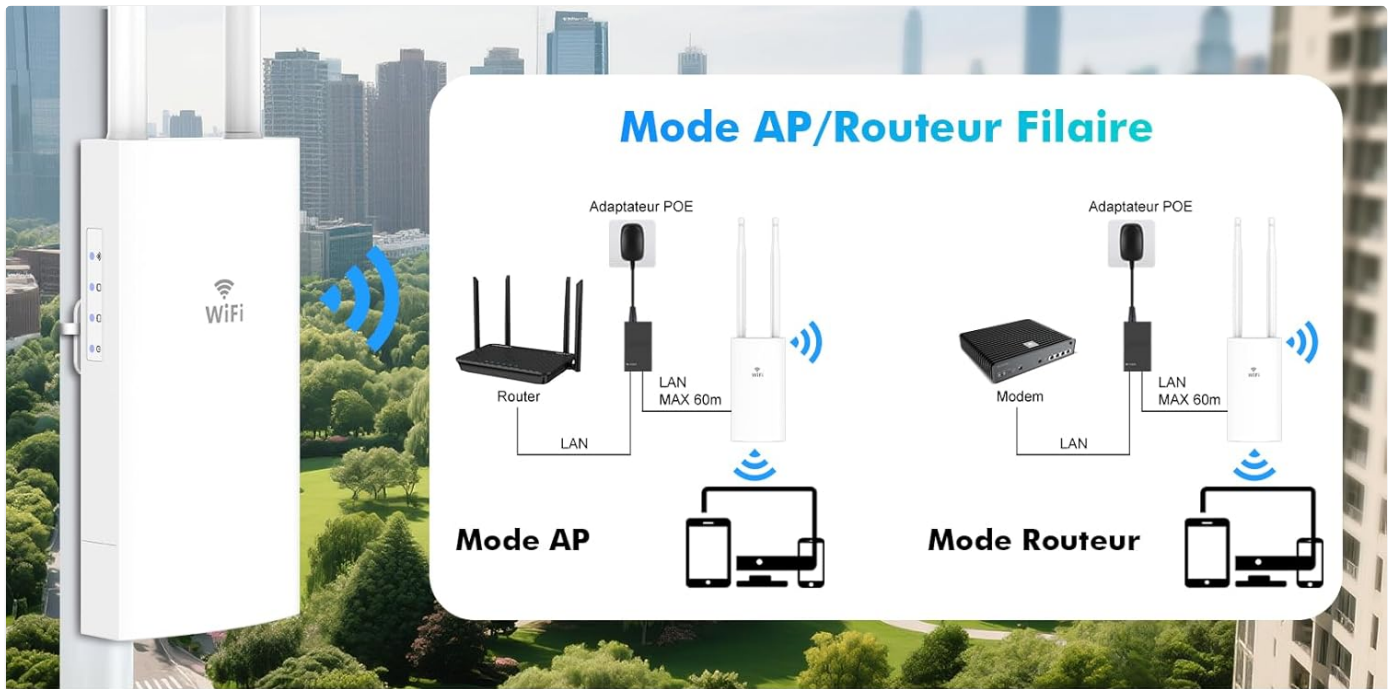

Figure 5.1: Multiple Operating Modes.

5.1 Dual Band Operation

The device operates on both 2.4 GHz and 5 GHz frequency bands simultaneously.

- **2.4 GHz Band:** Offers wider coverage and better penetration through walls, suitable for general internet use and older devices. Speed up to 300 Mbps.
- **5 GHz Band:** Provides higher speeds and less interference, ideal for high-bandwidth activities like HD streaming and online gaming. Speed up to 867 Mbps.

Extendeur WiFi Extérieur à Double Bande 1200Mbps

2,4 GHz (300Mbps)
Moins d'Interférences et Vitesse Plus Rapide

5,8 GHz (867Mbps)
Forte Compatibilité, Distance de Transmission Plus Longue et Meilleure Pénétration

WiFi

4K, TV, Game, Music, e, Mail

Figure 5.2: Dual Band Speed and Applications.

6. MAINTENANCE

To ensure optimal performance and longevity of your outdoor WiFi repeater, follow these maintenance guidelines:

- **Regular Cleaning:** Periodically wipe the exterior of the device with a soft, damp cloth to remove dust and dirt. Do not use harsh chemicals or abrasive cleaners.
- **Firmware Updates:** Check the WONLINK official website for available firmware updates. Keeping the firmware updated ensures the best performance, security, and compatibility.
- **Cable Inspection:** Regularly inspect the Ethernet cables and connections for any signs of wear, damage, or corrosion. Replace damaged cables immediately.
- **Environmental Protection:** Although the device is IP66 rated, avoid direct exposure to extreme weather conditions if possible, such as prolonged heavy rain or direct lightning strikes.
- **Restarting:** If you experience network issues, try restarting the device by unplugging the PoE adapter from the power source for 10 seconds and then plugging it back in.

7. TROUBLESHOOTING

If you encounter issues with your WONLINK Outdoor WiFi Repeater, refer to the following common problems and solutions:

Problem	Possible Cause	Solution
No power/LEDs off	PoE adapter not connected or faulty. Power outlet issue.	Ensure the PoE adapter is securely plugged into a working power outlet and connected correctly to the repeater. Check the power outlet with another device.
No internet connection	Incorrect configuration. Router issue. Ethernet cable problem.	Verify the repeater's configuration (AP, Repeater, Router mode). Check if your main router has internet access. Inspect Ethernet cables for damage. Try restarting both the router and the repeater.
Weak WiFi signal or dead zones persist	Poor placement. Interference.	Relocate the repeater to a more central position between your router and the desired coverage area. Ensure minimal physical obstructions. Avoid placing near large metal objects or other signal-emitting devices.
Cannot access configuration page	Incorrect IP address. Network settings on PC.	Ensure your computer is connected to the repeater via Ethernet. Verify the repeater's IP address (check manual or network settings). Temporarily set your computer's IP to static within the same subnet as the repeater.
Slow speeds on 5 GHz band	Distance from device. Obstructions.	The 5 GHz band has shorter range and is more susceptible to obstructions. Move closer to the repeater or ensure a clear line of sight.

If the problem persists after trying these solutions, please contact WONLINK customer support for further assistance.

8. SPECIFICATIONS

Feature	Detail
Brand	WONLINK
Model Number	WL-AP7202
Wireless Standard	802.11a/b/g/n/ac
Data Transfer Rate	1200 Mbps (2.4 GHz: 300 Mbps, 5 GHz: 867 Mbps)
Frequency Band	Dual Band (2.4 GHz, 5 GHz)
Ethernet Ports	2 x Gigabit Ethernet (LAN/WAN)
PoE Support	Yes, 802.3af (48V PoE adapter included)
Weatherproof Rating	IP66

Feature	Detail
Antennas	2 x High-Gain External Antennas
Operating Modes	Repeater, Access Point, Router, Bridge
Compatible Devices	Personal Computers, Smartphones, Tablets, Smart TVs
Color	White

9. WARRANTY AND SUPPORT

9.1 Manufacturer's Warranty

This WONLINK product comes with a **1-year manufacturer's warranty** from the date of purchase. This warranty covers defects in materials and workmanship under normal use. It does not cover damage caused by misuse, accidents, unauthorized modifications, or external causes such as power surges or natural disasters.

9.2 Technical Support

For technical assistance, troubleshooting, or warranty claims, please contact WONLINK customer support. We are committed to providing online technical support to ensure your satisfaction with our product.

Please refer to the contact information provided on the WONLINK official website or your purchase documentation for the most up-to-date support channels.

