

LoraTap BA202W-V3

LoraTap Smart Wi-Fi Light Bulb Socket Adapter (Model BA202W-V3) User Manual

Your guide to smart lighting control

1. INTRODUCTION

The LoraTap Smart Wi-Fi Light Bulb Socket Adapter transforms any standard light bulb into a smart, controllable device. This adapter allows you to manage your lighting remotely via a smartphone application, voice commands through smart assistants like Amazon Alexa and Google Assistant, and set automated schedules. It is designed for E26/E27 bulb bases and supports various bulb types up to 60W.



Image 1.1: The LoraTap Smart Wi-Fi Light Bulb Socket Adapter shown with a smartphone, illustrating app control capabilities.

2. PRODUCT FEATURES

- **Voice Control:** Compatible with Amazon Alexa and Google Assistant for hands-free operation.
- **App Control:** Manage lights from anywhere using the Smart Life app (2.4GHz Wi-Fi required, no hub needed).
- **Group Management:** Group multiple adapters to control them simultaneously with a single tap.
- **Timer & Automation:** Set schedules, countdowns, and custom scenes for automatic light operation.
- **60W Power & Heat Resistance:** Supports bulbs up to 60W (Incandescent, LED, CFL) with a heat-resistant design for stable performance.
- **Easy Installation:** Screws into E26/E27 sockets in minutes without special tools or an electrician.
- **Compact Design:** 3.4-inch height fits most lampshades.

Easy Installation

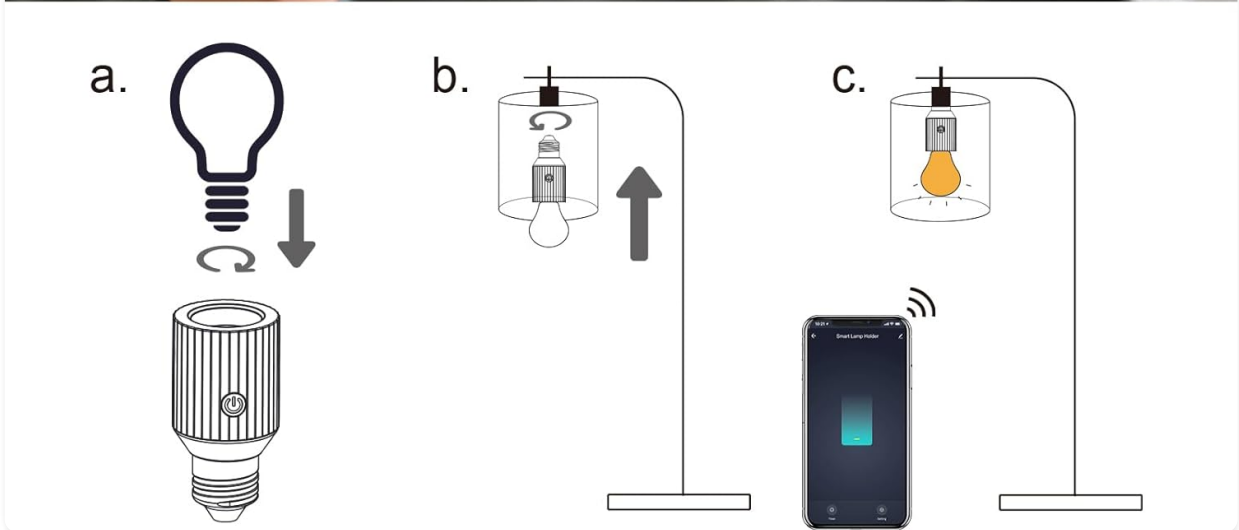

Image 2.1: Comparison illustrating the LoraTap adapter's 60W universal compatibility and enhanced durability features.

3. PACKAGE CONTENTS

- LoraTap Smart Wi-Fi Light Bulb Socket Adapter(s)
- User Manual

4. SETUP AND INSTALLATION

4.1 Physical Installation

1. Ensure the power to the light fixture is turned off at the switch or circuit breaker.
2. Screw the LoraTap Smart Wi-Fi Light Bulb Socket Adapter into your existing E26/E27 light fixture.
3. Screw your light bulb (Incandescent, LED, or CFL, up to 60W) into the LoraTap adapter.
4. Restore power to the light fixture.

Our Advantages	Other Products
<div data-bbox="365 241 603 689"></div> <div data-bbox="311 716 742 862"><h2>60W Universal ✓</h2></div> <div data-bbox="220 891 762 1120"><ul style="list-style-type: none">• 400 °F Rated• Impact-Resistant• BPA-Free• Incandescent-Compatible</div> <div data-bbox="207 1153 774 1272"><div></div><div>PPSU-GF20 High-Temp Composite</div></div>	<div data-bbox="906 387 1305 734"></div> <div data-bbox="970 784 1257 884"><h2>30W</h2></div> <div data-bbox="885 929 1343 1025"><p>- Not Compatible with Incandescent Bulbs</p></div>

Image 4.1: Step-by-step illustration of the physical installation process for the smart socket adapter.

4.2 App Download and Pairing

1. Download the "Smart Life" app from the Apple App Store or Google Play Store.
2. Register or log in to your Smart Life account.
3. Ensure your smartphone is connected to a 2.4GHz Wi-Fi network. The adapter does not support 5GHz Wi-Fi.
4. Open the Smart Life app, tap '+' to add a device, and follow the in-app instructions to pair your LoraTap adapter. The adapter will typically blink rapidly when in pairing mode.

4.3 Wi-Fi Signal Strength

For optimal performance, ensure the LoraTap adapter is installed within approximately 33 feet (10 meters) of your Wi-Fi router to maintain a strong and stable signal connection.



Image 4.2: Visual guide for maintaining a good Wi-Fi signal between the router and the smart socket adapter.

5. OPERATING INSTRUCTIONS

5.1 App Control

Once paired, you can control your light bulb from anywhere using the Smart Life app. Tap the device icon to turn the light on or off. The app also provides real-time feedback on the light's status.

APP Control



Works with
Smart Life

Works with
Tuya

Available on the
iPhone App Store

Available on the
Android App Store

Image 5.1: Demonstrating app control of the smart light bulb socket adapter.

Device Sharing

No matter where family members are, they can control the lights through the APP.



Image 5.2: Real-time feedback feature, allowing users to monitor light status remotely.

5.2 Voice Control

Integrate your LoraTap adapter with Amazon Alexa or Google Assistant for voice commands. Link the Smart Life skill/action in your smart assistant's app. Then, use commands like "Alexa, turn on the bedroom light" or "Hey Google, turn off the lamp."



Image 5.3: Example of using voice commands with Alexa or Google Assistant to control lighting.

5.3 Timer and Schedule

Set custom schedules and timers within the Smart Life app to automate your lighting. You can schedule lights to turn on/off at specific times, at sunrise/sunset, or after a countdown.

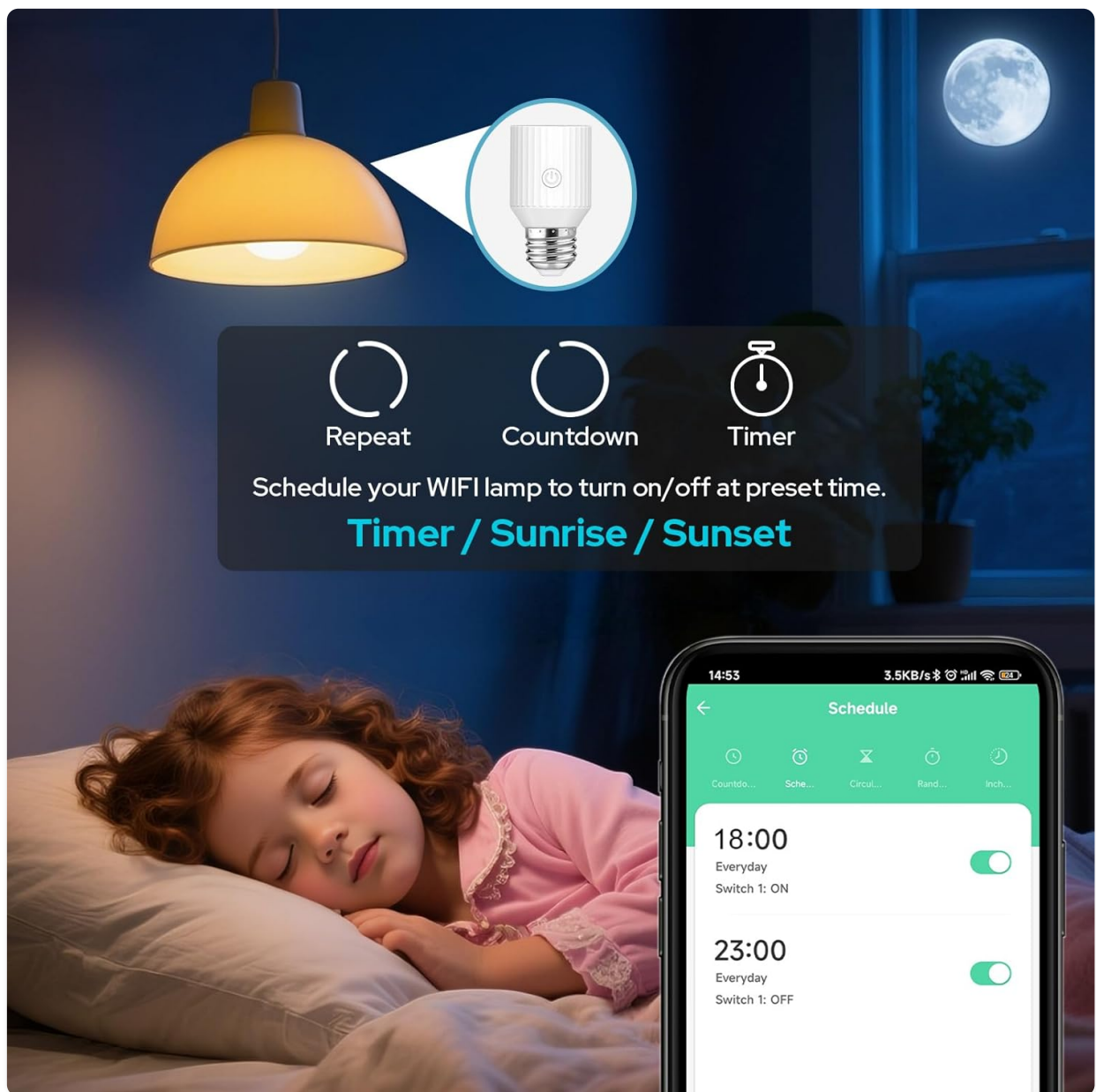

Image 5.4: Setting up timers and schedules for automated lighting control.

5.4 Group Management and Device Sharing

In the Smart Life app, you can create groups to control multiple LoraTap adapters simultaneously. Additionally, you can share control of your devices with family members, allowing everyone in the household to manage the smart lighting.

The installation location of the device should be within 33 ft of the Wi-Fi router to ensure a good Wi-Fi signal.

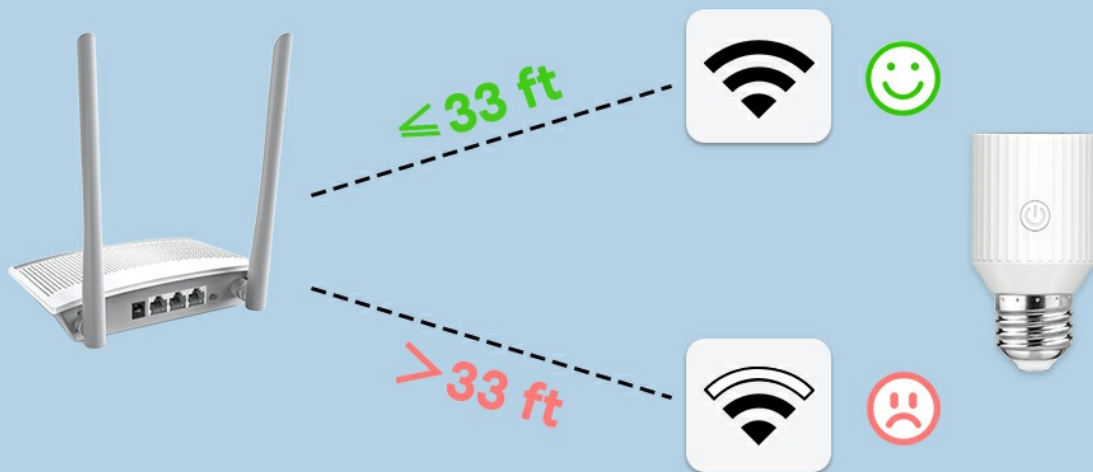

Image 5.5: Device sharing feature, enabling multiple users to control the smart socket adapter.

5.5 Restart Status Settings

Configure the restart status of your LoraTap adapter in the Smart Life app. You can choose for the light to be ON, OFF, or remember its last status after a power outage, preventing unnecessary energy consumption.

Please check the lamp base size and fixture compatibility



Please confirm the lamp-base size before purchasing to avoid the incompatibility issues shown below.

[Collision Risk]
Lamp too tall
hits bracket



[Lampshade Won't Close]
Size exceeds lamp depth

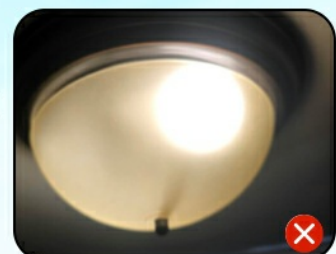

Image 5.6: Setting the device's restart status after a power interruption.

5.6 Product Video

Your browser does not support the video tag.

Video 5.1: This video demonstrates the LoraTap Smart Wi-Fi Light Bulb Socket Adapter's app control and voice control functionalities, showing how to turn lights on and off using a smartphone and an Alexa device.

6. COMPATIBILITY

The LoraTap Smart Wi-Fi Light Bulb Socket Adapter is designed for broad compatibility with various bulb types and standard E26/E27 sockets. Please review the following details to ensure proper fit and function:

6.1 Supported Bulb Types and Wattage

- **Bulb Types:** Incandescent, LED, CFL, Fluorescent Lamp.
- **Maximum Wattage:** 60 Watts.

6.2 Socket and Fixture Compatibility

The adapter is compatible with E26 and E27 bulb bases. It adds approximately 2.3 inches to the height of your light fixture. Ensure your lamp or fixture has sufficient space to accommodate this added length to avoid collision or obstruction of lampshades.

Please Confirm Compatibility

Check lamp holder fit, measure light fixture size before buying.

Added length to the light fixture: 2.3 in

1.7 in

1.1 in

3.4 in

E26 Base

Max. Power: 60W

Incandescent

LED

Fluorescent Lamp

CFL

Dimmer Light

Enclosed Narrow Lighting Fixtures

E12 bulb

E14 bulb

Image 6.1: Detailed compatibility information, including dimensions and supported/unsupported bulb types and fixtures.



Image 6.2: Visual examples of potential incompatibility issues with certain lamp bases and fixtures.

6.3 Incompatibilities

- Not compatible with dimmable bulbs.
- Not suitable for E12 or E14 bulb bases.
- May not fit in enclosed narrow lighting fixtures due to its dimensions.

7. TROUBLESHOOTING

- **Device Not Pairing:** Ensure your Wi-Fi network is 2.4GHz. Check that the adapter is within range of your router (preferably within 33 feet). Reset the adapter by turning the light switch on/off multiple times until the bulb blinks rapidly, indicating pairing mode.
- **Voice Control Not Working:** Verify that the Smart Life skill/action is correctly linked in your Amazon Alexa or Google Assistant app. Ensure the device name in the Smart Life app matches the name you are using for voice commands.
- **Intermittent Connection:** A weak Wi-Fi signal can cause connection issues. Try moving the adapter closer to the router or consider a Wi-Fi extender.
- **Light Not Responding:** Check if the physical light switch is in the 'ON' position. The smart adapter requires continuous power to function.

8. SPECIFICATIONS





Specification	Detail
Brand	LoraTap
Model Name	Light bulb socket
Item Model Number	BA202W-V3
Bulb Base	E26 / E27
Wattage	60 Watts (Max)
Voltage	100-120 Volts (AC)
Frequency	60 Hertz

Specification	Detail
Light Type Compatibility	CFL, Fluorescent Lamp, Incandescent, LED
Control Method	App, Voice
Wireless Connectivity	2.4GHz Wi-Fi (Not 5GHz compatible)
Material	Acrylonitrile Butadiene Styrene (ABS)
Product Dimensions	1.7"W x 3.4"H
Item Weight	4.6 ounces
Indoor/Outdoor Usage	Indoor
Certifications	FCC, RoHS

9. WARRANTY AND SUPPORT

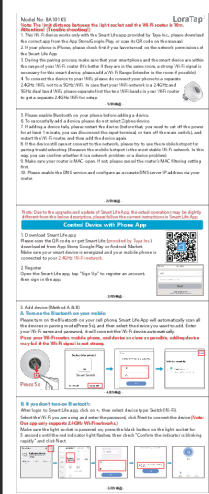
For warranty information, technical support, or further assistance, please refer to the contact details provided with your product packaging or visit the official LoraTap website. Keep your purchase receipt for warranty claims.

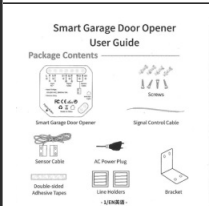
Related Documents - BA202W-V3

 <p>Model No. BA101KS This User Guide provides the information you need to install and use the LoraTap BA101KS Smart Wi-Fi LED Light Bulb Socket Adapter. It includes instructions for installation, app control, and troubleshooting. The guide is available in English and Spanish.</p>	<p>LoraTap BA101KS Smart Wi-Fi Light Socket User Guide</p> <p>Comprehensive user guide for the LoraTap BA101KS Smart Wi-Fi LED Light Bulb Socket Adapter, covering setup, app control, troubleshooting, and specifications.</p>
 <p>Guía del usuario del Módulo Tapacortinas Este manual de usuario proporciona información sobre la instalación, el control de la aplicación y la solución de problemas del Módulo Tapacortinas. El manual está disponible en español.</p>	<p>LoraTap Smart Curtain Switch User Manual</p> <p>User manual for the LoraTap Smart Curtain Switch, detailing installation, app control via Smart Life, and troubleshooting for Wi-Fi connected electric blinds and curtains.</p>
 <p>Smart Garage Door Opener User Guide Package Contents: Smart Garage Door Opener, Signal Receiver, Sensor Cable, AC Power Plug, Adhesive Tape, LoraTap, Bracket.</p>	<p>Smart Garage Door Opener User Guide and Installation Instructions</p> <p>Comprehensive user guide for the LoraTap Smart Garage Door Opener, covering package contents, installation, app integration with Smart Life and Tuya, Wi-Fi setup, sensor mounting, wiring, and voice control via Amazon Alexa and Google Home.</p>
 <p>Wireless Socket User Guide This guide provides instructions for installing and using the LoraTap Wireless Socket. It includes information on package contents, installation, app control, and troubleshooting.</p>	<p>Loratap Wireless Socket User Guide - SP511Q2-US-V3, SP512Q2-US-V3</p> <p>User guide for the LoraTap Wireless Socket models SP511Q2-US-V3 and SP512Q2-US-V3. Includes installation, pairing, troubleshooting, and technical specifications.</p>



[LoraTap SC420W-EU Smart Curtain Switch Installation Guide](#)

Detailed installation instructions for the LoraTap SC420W-EU Smart Curtain Switch, compatible with Tuya Smart Life, Google Home, and Alexa voice assistants for controlling roller shutter electric motors.

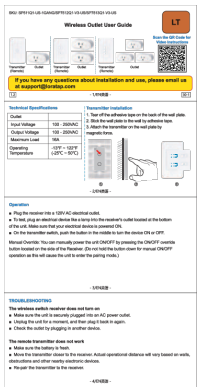

[Loratap Wireless Outlet User Guide: Installation, Operation, and Troubleshooting](#)

Comprehensive user guide for Loratap wireless outlets (models SP511Q1, SP7512Q1, SP7513Q1). Learn about installation, operation, pairing, troubleshooting, and safety warnings for your smart home devices.