

Manuals+

[Q & A](#) | [Deep Search](#) | [Upload](#)

[manuals.plus](#) /

› [suptek](#) /

› [suptek Single Monitor Wall Mount \(Model B0FHVH6PLY\) Instruction Manual](#)

suptek B0FHVH6PLY

suptek Single Monitor Wall Mount Instruction Manual

Model: B0FHVH6PLY

INTRODUCTION

Thank you for choosing the suptek Single Monitor Wall Mount. This manual provides detailed instructions for the safe and efficient installation, operation, and maintenance of your new monitor arm. Please read this manual thoroughly before installation and keep it for future reference.

This wall mount is designed to securely hold a single monitor, freeing up desk space and allowing for ergonomic adjustments to enhance your viewing comfort and productivity.

SAFETY INFORMATION

WARNING: Improper installation may result in property damage or personal injury. If you do not understand these instructions, or have doubts about the safety of the installation, please contact a qualified installer.

- Do not exceed the maximum load capacity of 19.8 lbs (9 kg).
- Ensure the mounting surface (wall) can safely support the combined weight of the mount and the monitor.
- Always use a stud finder to locate wood studs for secure mounting. For concrete or brick walls, use appropriate anchors (included). Do not mount into drywall alone.
- Keep children away from moving parts.
- Check all connections regularly to ensure they remain secure.
- This product is intended for indoor use only.

PACKAGE CONTENTS

Please verify that all components are present and undamaged before installation. If any parts are missing or defective, contact customer support.

- Monitor Arm Assembly
- Wall Plate
- VESA Plate
- Hardware Kit (screws, washers, spacers, wall anchors)
- Hex Keys

SPECIFICATIONS

Feature	Detail
Brand	suptek
Model	B0FHVH6PLY
Compatible Screen Size	17 to 32 inches
Weight Capacity	4.4 - 19.8 lbs (2 - 9 kg)
VESA Compatibility	75x75mm, 100x100mm
Tilt Angle	±80°
Swivel Angle	±90°
Rotation	360°
Maximum Extension	20.47 inches (52 cm)
Height Adjustment Range	12.59 inches (32 cm)
Material	Alloy Steel
Color	White

Will This Mount Fit Your Monitor?

VESA Pattern

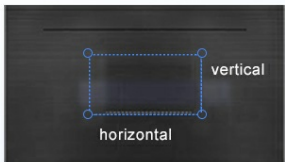

Min: 75x75 mm
Max: 100x100 mm

Max Load



19.8LBS

Monitor Size

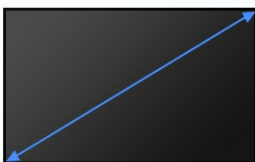

13-32"

Wall Types



Wood Stud
Concrete Wall
Brick Wall

Image: Compatibility details including VESA 75x75mm and 100x100mm, max load 19.8 lbs, monitor size 13-32 inches, and compatible wall types (Wood Stud, Concrete Wall, Brick Wall).

SETUP AND INSTALLATION

Follow these steps carefully to install your monitor wall mount.

Step 1: Choose Mounting Location and Wall Type

Select a location on your wall that is structurally sound and can support the weight of the mount and your monitor. Use a stud finder to locate a wood stud for optimal security. For concrete or brick walls, ensure you use the appropriate wall anchors provided.

Easy Installation

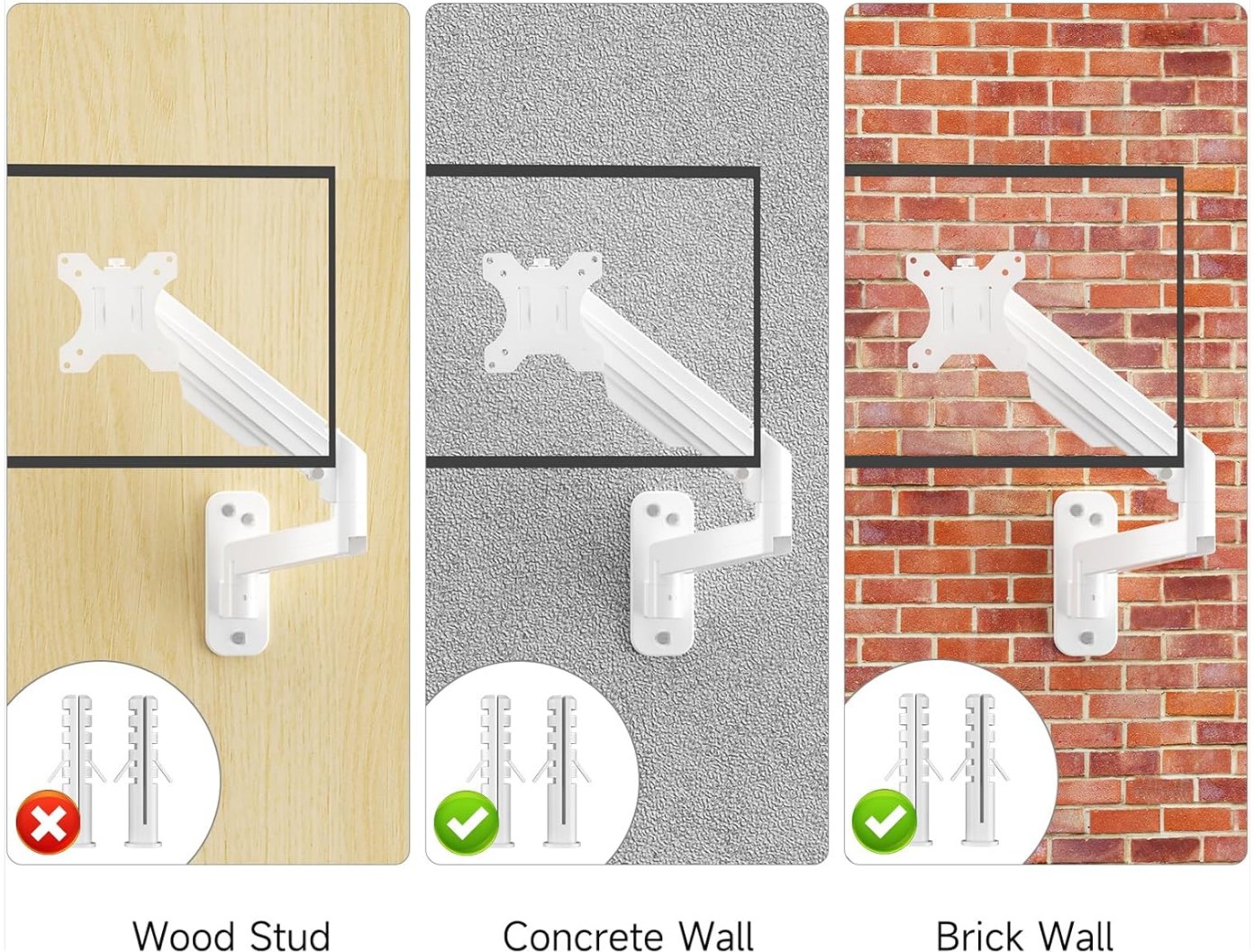

Image: Wall mount installation compatibility with Wood Stud (requires specific method), Concrete Wall, and Brick Wall.

Step 2: Attach VESA Plate to Monitor

1. Carefully place your monitor face down on a soft, clean surface to prevent scratches.
2. Identify the VESA mounting holes on the back of your monitor (75x75mm or 100x100mm).
3. Select the correct screws (M4 or M5) and washers from the hardware kit that fit your monitor's VESA holes. If the screws are too long, use the provided spacers.
4. Attach the VESA plate to the back of your monitor using the selected screws and washers. Do not overtighten.

Step 3: Mount Wall Plate to Wall

1. Hold the wall plate against the wall at your desired mounting height. Use a level to ensure it is straight.
2. Mark the drilling locations through the holes on the wall plate.
3. **For Wood Studs:** Drill pilot holes (recommended size in manual) into the center of the stud. Secure the wall plate

using the lag bolts provided.

4. **For Concrete/Brick Walls:** Drill pilot holes (recommended size in manual) and insert the plastic wall anchors. Then secure the wall plate using the lag bolts.
5. Ensure the wall plate is firmly and securely attached to the wall.

Step 4: Attach Monitor Arm to Wall Plate

Slide the monitor arm assembly onto the wall plate. Ensure it clicks securely into place. There may be a locking screw or mechanism to further secure it; refer to the detailed diagram in the included printed manual.

Step 5: Attach Monitor to Arm

Carefully slide the monitor (with the attached VESA plate) onto the VESA head of the monitor arm. Secure it with the locking screw or mechanism, typically located on the top or side of the VESA head.



Image: Fully installed suptek Single Monitor Wall Mount with a monitor attached.

Adjusting Gas Spring Tension

The gas spring mechanism allows for smooth height adjustment. The tension needs to be adjusted to match your monitor's weight for optimal performance. Use the provided hex key to adjust the tension screw located on the arm.

- **Turn Clockwise (+):** For lighter monitors, to increase tension and prevent the monitor from dropping.
- **Turn Counter-Clockwise (-):** For heavier monitors, to decrease tension and allow the monitor to move down easily.

Adjust until the monitor stays at any desired height when released.



Image: Gas spring tension adjustment points and directions for lighter/heavier monitors.

Full Motion Adjustments

The monitor arm offers a wide range of motion for ergonomic positioning:

- **Tilt:** Adjust the monitor screen $\pm 80^\circ$ up or down to reduce glare and optimize viewing angles.
- **Swivel:** Rotate the monitor $\pm 90^\circ$ left or right to share your screen or change viewing direction.

- **Rotation:** Rotate the monitor 360° from landscape to portrait orientation.
- **Extension/Retraction:** The arm extends up to 20.47 inches (52 cm) and retracts to save space.
- **Height Adjustment:** The gas spring allows for smooth vertical movement within a 12.59-inch (32 cm) range.

Full Motion

Find an optimal ergonomic position

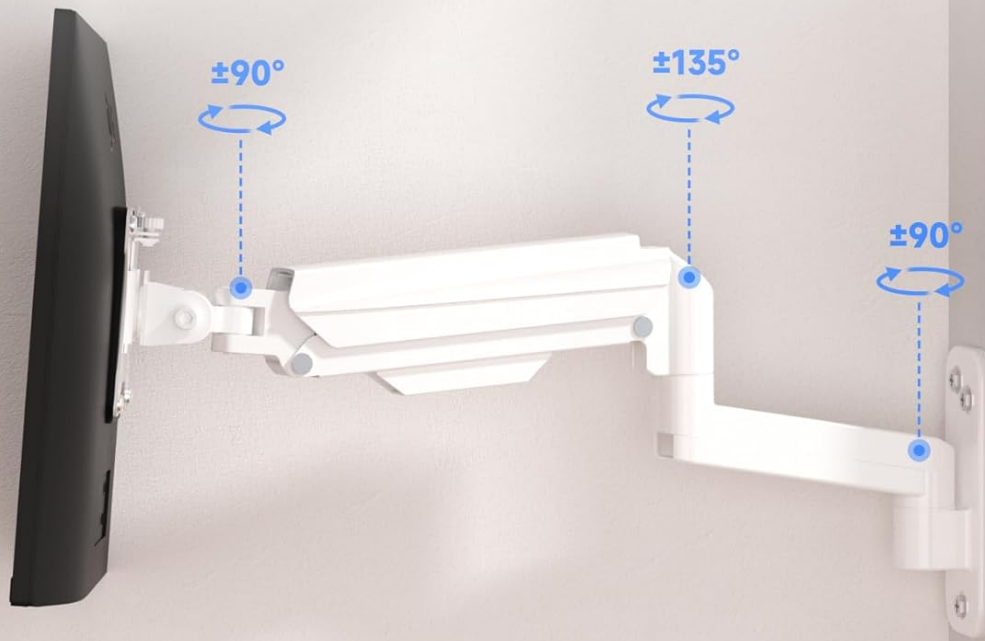

Tilt: **±90°**

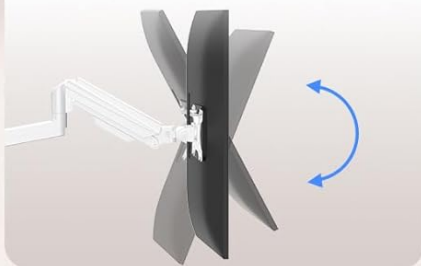

Swivel: **180°**



Rotation: **360°**

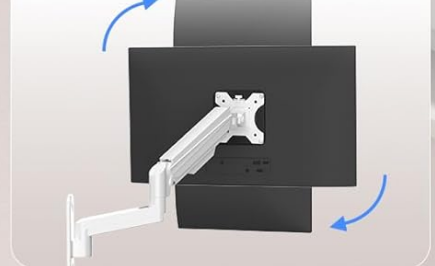

Image: Full motion capabilities including tilt, swivel, and 360° rotation.

Arm Extension and Retraction

Max extension:

<<<< 20.47" >>>>



Image: Arm extension and retraction, showing a maximum extension of 20.47 inches.

Enjoy Eye-Level Comfort



Image: Height adjustment range of 12.59 inches for eye-level comfort.

Cable Management

The monitor arm features integrated cable management clips or channels to keep your cables organized and out of sight. Route your monitor's power and video cables through these channels for a clean and tidy workspace.

MAINTENANCE

- Periodically check all screws and connections to ensure they are tight and secure.
- Clean the mount with a soft, damp cloth. Avoid abrasive cleaners or solvents.
- Do not attempt to disassemble the gas spring mechanism.

TROUBLESHOOTING

Problem	Possible Cause	Solution
Monitor sags or drops	Gas spring tension is too low for monitor weight.	Increase gas spring tension by turning the adjustment screw clockwise.
Monitor is difficult to push down or stays too high	Gas spring tension is too high for monitor weight.	Decrease gas spring tension by turning the adjustment screw counter-clockwise.
Mount feels unstable	Wall plate not securely fastened; screws loose.	Re-check all mounting screws on the wall plate and tighten them. Ensure proper wall type and anchors were used.
Monitor does not fit VESA plate	Incorrect VESA pattern or screw size.	Verify your monitor's VESA pattern (75x75mm or 100x100mm). Ensure you are using the correct M4 or M5 screws and spacers.

WARRANTY AND SUPPORT

For warranty information or technical support, please refer to the warranty card included with your product or visit the official suptek website. If you have any questions or require assistance, do not hesitate to contact suptek customer service.

Contact Information: Please refer to the packaging or suptek's official website for the most current contact details.

