

Manuals+

[Q & A](#) | [Deep Search](#) | [Upload](#)

manuals.plus /

› [WONLINK](#) /

› [WONLINK AC1200 Outdoor Access Point User Manual](#)

WONLINK WL-AP7202-US

WONLINK AC1200 Outdoor Access Point User Manual

Model: WL-AP7202-US

Brand: WONLINK

1. PRODUCT OVERVIEW

The WONLINK AC1200 Outdoor Access Point is a robust and versatile networking device designed to provide stable and extended Wi-Fi coverage in outdoor environments. Featuring IP66 weatherproofing, dual-band AC1200 speeds, and long-range capabilities, it is ideal for various applications requiring reliable outdoor wireless connectivity.



Figure 1: WONLINK AC1200 Outdoor Access Point

2. KEY FEATURES

- **IP66 All-Weather Outdoor Work:** Designed to withstand extreme weather conditions including high winds, sandstorms, and heavy rain, ensuring continuous and reliable Wi-Fi coverage. The IP66 rating and durable ABS housing provide robust protection.
- **AC1200 Dual-Band WiFi:** Delivers combined wireless speeds of up to 1200Mbps (867 Mbps on 5GHz and 300 Mbps on 2.4GHz). A high-performance triple-chip system ensures stable, high-speed Wi-Fi with seamless roaming, supporting over 120 devices simultaneously.
- **2*5 dBi Long-Range Coverage:** Equipped with a dedicated PA module on both 5GHz and 2.4GHz frequencies and two high-gain 5 dBi antennas, extending Wi-Fi coverage up to 650 feet for 360° all-directional coverage.
- **Gigabit Port & PoE Support:** Features a high-speed Gigabit Ethernet port (WAN*1 & LAN*1) for lag-free wired connections. Supports 802.3 af/at Power over Ethernet (PoE) for flexible installation and reduced cable clutter, enabling single-cable power and data transmission.

- **Multiple Installation Modes & Functions:** Supports flexible deployment with pole-mount and wall-mount installation options. Operates in four versatile modes: Bridge, AP (Access Point), Router, and Repeater, adapting to various network requirements.



Figure 2: Weatherproof Capabilities

3. PACKAGE CONTENTS

Verify that all items are present in your package:

- 1x AC1200 Outdoor WiFi Extender
- 1x Operation Instructions (this manual)
- 1x RJ-45 Network Cable
- 1x POE Power Adapter
- 2x Fixing screws + 1x Fixed ties (for mounting)

4. SETUP AND INSTALLATION

4.1 Initial Connection

1. **Power Connection:** Connect the POE Power Adapter to a power outlet.
2. **Ethernet Connection:** Connect one end of the RJ-45 Network Cable to the "POE" port on the POE Power Adapter and the other end to the "POE WAN" port on the Outdoor WiFi Extender.
3. **Computer Connection (for initial setup):** Connect a second RJ-45 Network Cable from the "LAN" port on the POE Power Adapter to your computer's Ethernet port.
4. **Access Web Interface:** Open a web browser on your computer and enter the default IP address (refer to the included quick start guide or product label for the exact IP, commonly 192.168.1.1 or similar) to access the device's configuration page. Follow the on-screen wizard for initial setup.

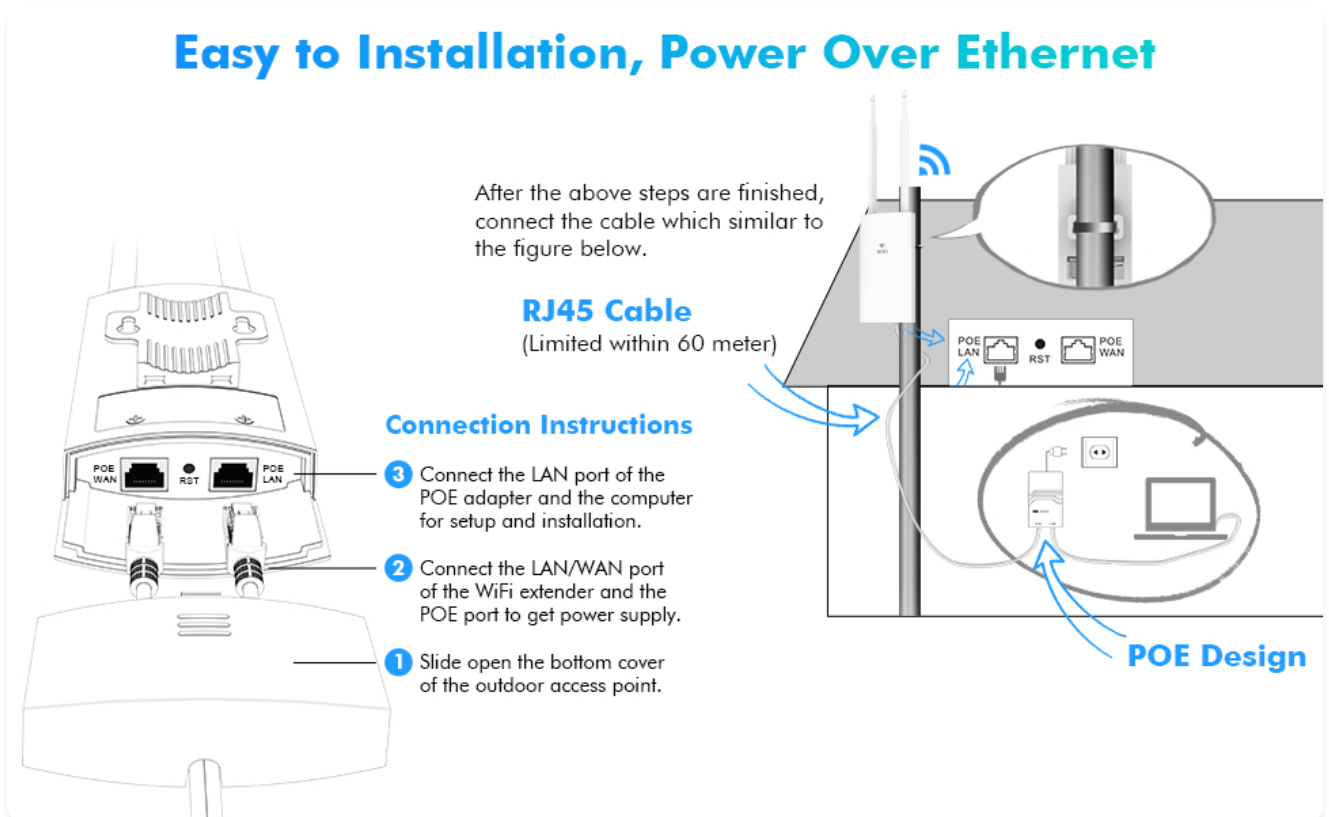

Figure 3: PoE Connection and Setup Diagram

4.2 Physical Installation

The device supports both pole-mount and wall-mount installations.

- **Pole Mounting:** Use the provided fixed ties to secure the extender to a pole. Ensure the pole is stable and provides a clear line of sight to the desired coverage area.
- **Wall Mounting:** Use the provided fixing screws to mount the extender securely to a wall. Choose a location that is structurally sound and allows for optimal signal propagation.

Supports Passive POE & Easy Outdoor Installation

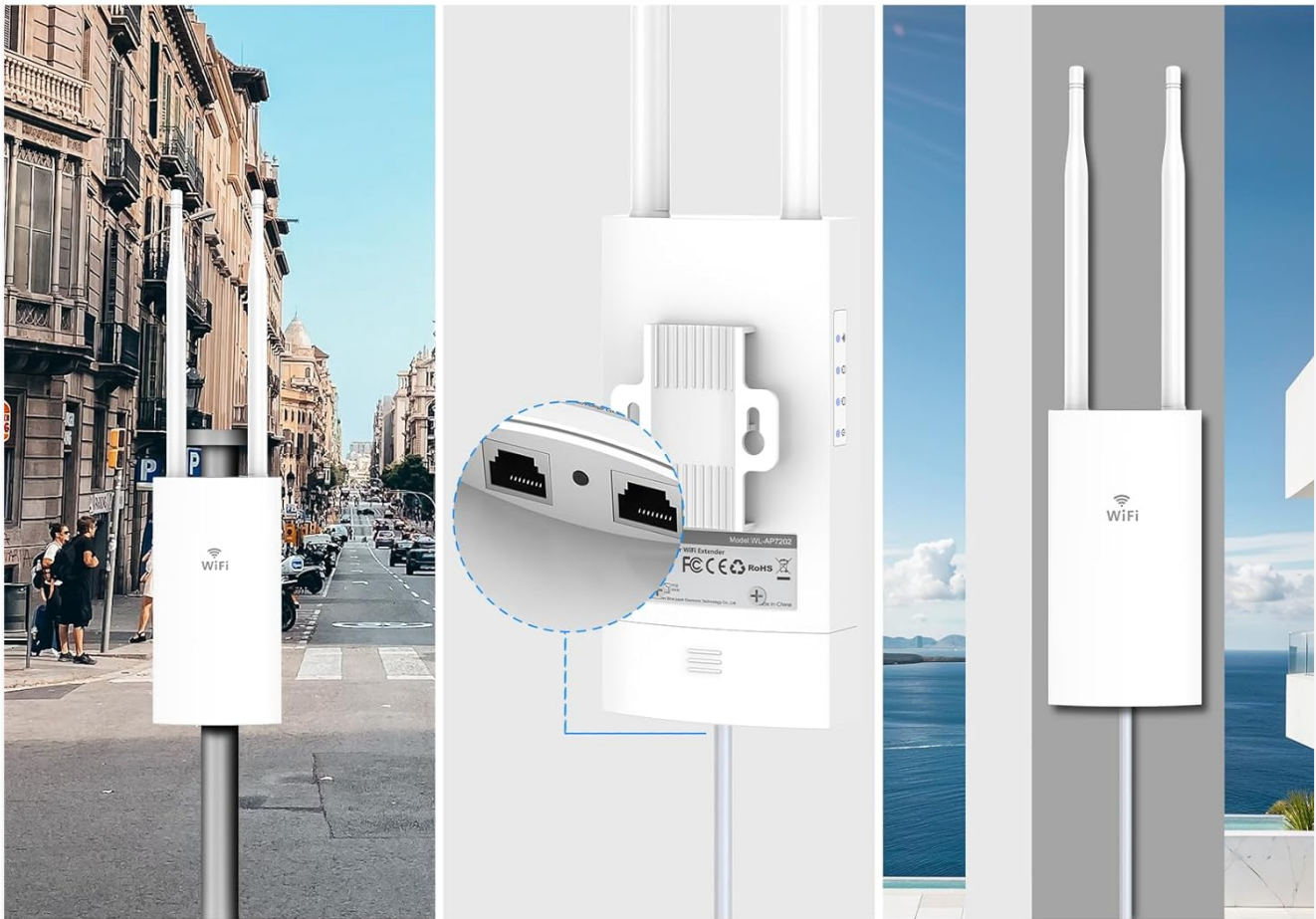

Pole Mounting

Power Over
Ethernet (POE)

Wall Mounting

Figure 4: Flexible Installation Options

For optimal performance, ensure minimal obstacles between the access point and the weak signal destination. A recommended signal strength of over 70% is ideal, which can be tested using a smartphone.

**RECOMMENDED SIGNAL
STRENGTH 70%**



Choose the right place between the weak signal area and the Router. Suggest put AP on the place which can get at least three bar WiFi signal of your router (You can test by the smart phone)

Most Important: Ensure no or fewer obstacle between this AP and your weak signal destination to get a MAX signal



Figure 5: Optimal Placement for Signal Strength

5. OPERATING MODES

The WONLINK AC1200 supports four primary operating modes to suit various networking needs:

- **AP (Access Point) Mode:** In this mode, the device connects to an existing wired network (e.g., from a router or modem) and broadcasts a wireless signal, allowing wireless devices to connect to the network. It extends the coverage of your existing wired network wirelessly.
- **Router Mode:** The device acts as a primary router, connecting to an internet source (e.g., a modem) and providing both wired and wireless network access to connected devices. It manages IP addresses and network traffic.
- **Repeater Mode:** This mode extends the range of an existing wireless network. The device connects wirelessly to an existing Wi-Fi signal and re-broadcasts it, effectively boosting the signal strength and coverage area.
- **Bridge Mode:** In bridge mode, the device connects two separate wired networks wirelessly, acting as a wireless bridge. This is useful for connecting devices in different locations without running long Ethernet cables.

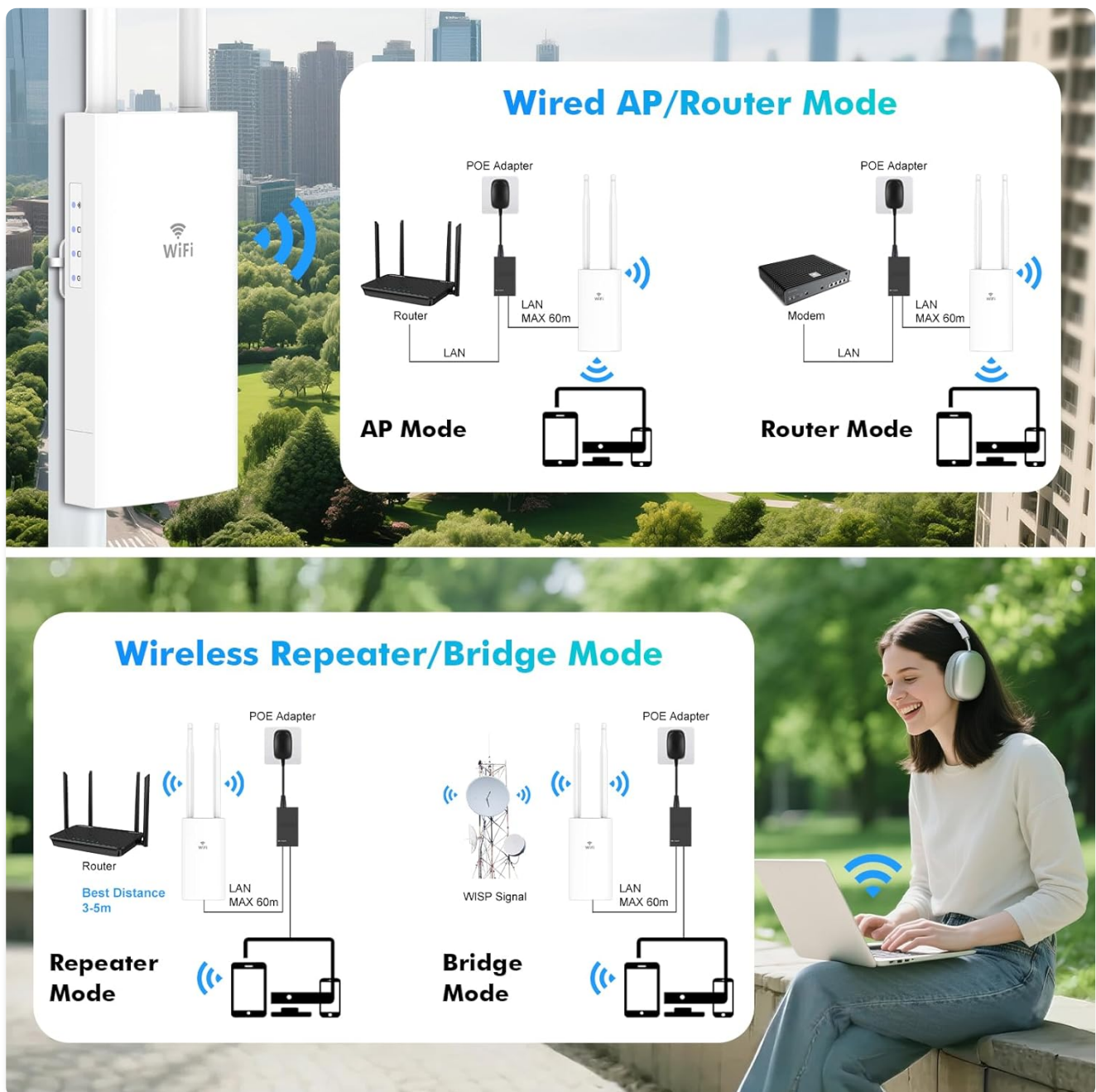

Figure 6: Operating Mode Configurations

6. MAINTENANCE

To ensure optimal performance and longevity of your WONLINK Outdoor Access Point, consider the following maintenance tips:

- **Regular Cleaning:** Periodically wipe the exterior of the device with a soft, damp cloth to remove dust and dirt. Ensure the device is powered off before cleaning. Do not use harsh chemicals or abrasive cleaners.
- **Firmware Updates:** Check the WONLINK official website regularly for firmware updates. Keeping the firmware updated ensures the best performance, security, and compatibility. Follow the instructions provided with the firmware update carefully.
- **Inspect Cables and Connections:** Periodically check all cable connections (Ethernet, power) to ensure they are secure and free from damage.
- **Environmental Check:** While the device is weatherproof, ensure its mounting location remains stable and free from

excessive debris buildup that could obstruct ventilation or signal.

7. TROUBLESHOOTING

Problem	Possible Cause	Solution
No Wi-Fi signal or weak signal.	Incorrect placement, power issue, or configuration error.	Ensure the device is powered on and the POE adapter is functioning. Relocate the access point to a central location with fewer obstructions. Verify the operating mode (AP, Repeater) is correctly configured for your network. Check antenna connections if removable.
Cannot access the web management interface.	Incorrect IP address, network configuration, or cable issue.	Ensure your computer is directly connected to the POE adapter's LAN port. Verify your computer's IP settings are set to obtain an IP address automatically (DHCP) or configured with a static IP in the same subnet as the device. Try the default IP address (check product label or quick start guide). Reset the device to factory defaults (refer to the reset procedure in the quick start guide).
Slow Wi-Fi speeds.	Interference, network congestion, or outdated firmware.	Change Wi-Fi channels to avoid interference from neighboring networks. Ensure the device is operating in dual-band mode and clients are connecting to the appropriate band (5GHz for higher speeds). Limit the number of connected devices or bandwidth-intensive activities. Update the device firmware to the latest version.

8. PRODUCT SPECIFICATIONS

Attribute	Detail
Model Number	WL-AP7202-US
Brand	WONLINK
Wireless Standard	802.11ac
Frequency Band Class	Dual-Band (2.4 GHz & 5 GHz)
Max Wireless Speed	1200 Mbps (300 Mbps on 2.4GHz, 867 Mbps on 5GHz)

Attribute	Detail
Antennas	2 x 5 dBi High-Gain Antennas
Ports	Gigabit Ethernet (WAN*1 & LAN*1)
PoE Support	802.3 af/at PoE
Weatherproof Rating	IP66
Special Features	Access Point Mode, Weatherproof, Windproof, Triple-Chip System
Recommended Uses	Outdoor WiFi Coverage (Farm, Garden, Garage, Backyard, Mall, Community, Street)
Compatible Devices	Laptop, Personal Computer, Smart Television, Smartphone
Color	White
Item Weight	1.14 pounds
Package Dimensions	9.06 x 7.28 x 1.97 inches

9. WARRANTY AND SUPPORT

WONLINK provides professional technical support to assist you with any questions or issues regarding your AC1200 Outdoor Access Point.

For after-sales support, please contact us via email:

wonlinkservice@163.com

Please refer to your purchase documentation for specific warranty terms and conditions.

© 2025 WONLINK. All rights reserved.
This manual is subject to change without notice.

Related Documents - WL-AP7202-US

<div data-bbox="188 96 245 112" data-label="Text"><p>WONLINK</p></div> <div data-bbox="153 170 274 199" data-label="Text"><p>Wireless AP Quick Installation Guide</p></div> <div data-bbox="129 338 300 365" data-label="Image"></div>	<div data-bbox="341 291 887 320" data-label="Section-Header"><p>WONLINK Wireless AP Quick Installation Guide</p></div> <div data-bbox="341 331 1458 400" data-label="Text"><p>Quick installation guide for the WONLINK Wireless AP, detailing setup for AP, Bridge, Router, and Repeater modes. Includes network configuration steps and FCC compliance information.</p></div>
	<div data-bbox="341 1205 1083 1234" data-label="Section-Header"><p>WONLINK WiFi Extender AC1200 User Manual and Setup Guide</p></div> <div data-bbox="341 1245 1422 1314" data-label="Text"><p>Comprehensive guide for setting up and using the WONLINK WiFi Extender AC1200, including features, modes, and troubleshooting.</p></div>

	<p>WONLINK WL-NE3502 WiFi Extender: 1200Mbps Dual Band WiFi Booster Setup Guide</p> <p>User guide for the WONLINK WL-NE3502 WiFi Extender, a 1200Mbps dual-band WiFi booster and repeater. Includes setup instructions, features, and specifications for enhanced wireless network coverage.</p>
	<p>WONLINK WL-NE3503 WiFi Extender/Repeater Quick Installation Guide</p> <p>This guide provides step-by-step instructions for installing and configuring the WONLINK WL-NE3503 WiFi Extender/Repeater, including setup, troubleshooting tips, and important safety and regulatory information.</p>

[WONLINK AX1800 WiFi 6 Extender: Quick Installation Guide](#)

A concise guide to setting up your WONLINK AX1800 WiFi 6 Extender for improved home network coverage. Learn placement, connection, and configuration steps.

<div><div>WONLINK</div><div>Quick Installation Guide</div><div><div>Repeater M0305498 Version 1.0.0</div></div></div>	<div>WONLINK Repeater Quick Installation Guide</div> <div>Comprehensive quick installation guide for the WONLINK Repeater (Model M0305498), covering setup, working modes, Mesh networking, and troubleshooting.</div>