

## POWTREE V10

# POWTREE 7000mAh 25.2V Replacement Battery for Dyson V10 SV12 Series Vacuum Cleaner Instruction Manual

Model: V10 | Brand: POWTREE

## 1. INTRODUCTION

This manual provides essential instructions for the safe and effective use, installation, and maintenance of your POWTREE 7000mAh 25.2V Li-ion replacement battery for Dyson V10 and SV12 series vacuum cleaners. Please read this manual thoroughly before installation and use.

## 2. SAFETY INFORMATION

- Do not disassemble, crush, or puncture the battery.
- Avoid exposing the battery to high temperatures (above 60°C/140°F) or direct sunlight.
- Do not short-circuit the battery terminals.
- Keep the battery away from water or other liquids.
- Store the battery in a cool, dry place when not in use.
- Dispose of used batteries according to local regulations. Do not dispose of with household waste.
- Use only the original Dyson charger or a compatible charger designed for V10/SV12 batteries.
- If the battery shows signs of damage, overheating, or leakage, discontinue use immediately.



*Image: The POWTREE V10 replacement battery features multiple safety protections, including overcharge, overvoltage, short circuit, and overcurrent protection, indicated by CE, FC, and RoHS certifications.*

### 3. PACKAGE CONTENTS

Verify that all items are present in the package:

- 1 x POWTREE 7000mAh 25.2V Replacement Battery
- 1 x Screwdriver
- 3 x Screws
- 1 x Post Filter
- 1 x Battery Protection Cap



*Image: The complete package includes the replacement battery, a screwdriver, three screws, a post filter, and a battery protection cap for a comprehensive replacement solution.*

## 4. INSTALLATION INSTRUCTIONS

Follow these steps to replace the battery in your Dyson V10 or SV12 series vacuum cleaner:

1. **Power Off:** Ensure your Dyson vacuum cleaner is turned off and unplugged from any charging source.
2. **Locate Battery:** The battery is typically located at the bottom of the main unit handle.
3. **Remove Screws:** Use the provided screwdriver to remove the screws securing the old battery. There are usually two screws: one near the charging port and another behind the pull-out washable filter.
4. **Detach Old Battery:** Carefully slide the old battery out of its housing.
5. **Install New Battery:** Align the POWTREE replacement battery with the vacuum cleaner's battery slot. Ensure the connectors are properly seated.
6. **Secure New Battery:** Use the provided new screws to fasten the replacement battery securely into place. Do not overtighten.
7. **Install Post Filter:** If replacing the post filter, remove the old filter by twisting it counter-clockwise and

then insert the new filter, twisting clockwise to secure it.

8. **Initial Charge:** It is recommended to fully charge the new battery before its first use.



Image: This diagram illustrates the components included in the package, which are essential for the battery replacement process.



Image: Visual guide demonstrating the simple steps to install and clean the included post filter, ensuring optimal vacuum performance.

## 5. OPERATING INSTRUCTIONS

### 5.1 Charging the Battery

- The POWTREE replacement battery is designed to be compatible with your original Dyson V10/SV12 charger and charging stand.
- Connect the vacuum cleaner to its charging station or directly to the charger.
- The LED indicators on the battery will illuminate to show the charging status. A full charge is indicated when all LEDs are solid.
- Avoid leaving the battery on the charger for extended periods after it is fully charged to prolong its lifespan.

### 5.2 Battery Indicators

The battery features LED indicators to display the remaining charge level and charging status. Refer to your Dyson vacuum cleaner's original manual for specific indicator patterns, as they typically reflect the battery status.



## SAFE AND TRUSTWORTHY

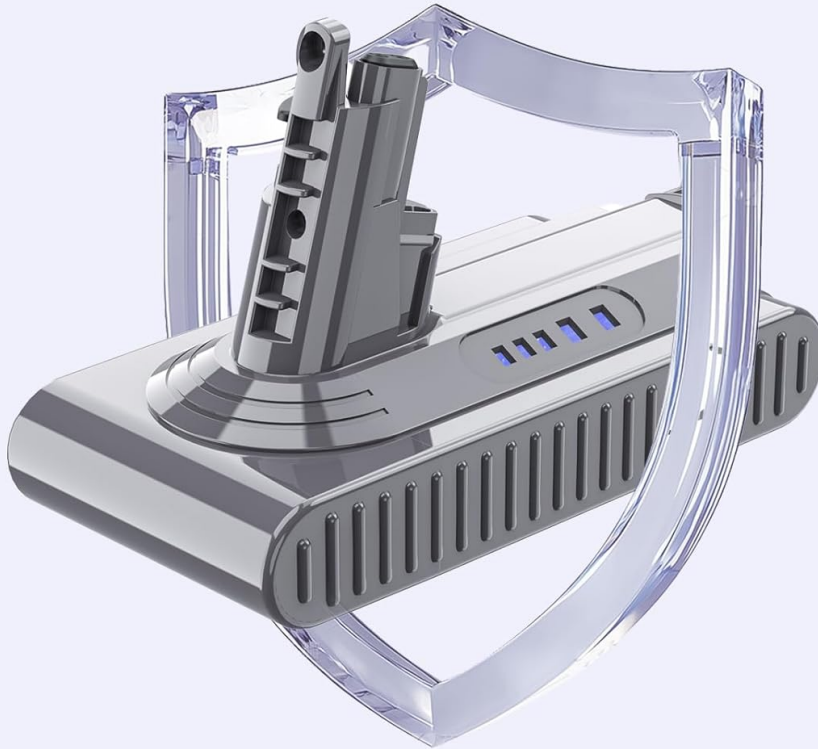

Overcharge  
protection



Overvoltage  
protection



Overvoltage  
protection



Short circuit  
protection



Overcurrent  
Protection

*Image: Detailed view of the battery's design, highlighting the charging port, LED indicators for charge status, and the control button.*

## 6. MAINTENANCE

### 6.1 Battery Care

- For optimal performance, fully charge the battery before each use.
- If the vacuum cleaner will not be used for an extended period, store the battery at approximately 50% charge in a cool, dry place.
- Avoid completely draining the battery frequently, as this can reduce its overall lifespan.

### 6.2 Filter Maintenance

The included post filter is washable and reusable. Regular cleaning of the filter is crucial for maintaining optimal suction power and battery efficiency.

1. **Remove Filter:** Twist the post filter counter-clockwise to detach it from the vacuum cleaner.
2. **Wash:** Rinse the filter under cold running water until the water runs clear. Do not use detergents.
3. **Dry:** Allow the filter to air dry completely for at least 24 hours before reinserting it. Ensure it is thoroughly dry to prevent damage to the motor.
4. **Reinstall:** Once dry, reinsert the filter by twisting it clockwise until secure.

## 7. TROUBLESHOOTING

Problem	Possible Cause	Solution
Battery not charging	Charger not connected properly; Faulty charger; Battery issue	Ensure charger is securely connected. Try a different outlet. If problem persists, contact support.
Short runtime	Filter clogged; Battery not fully charged; Battery degradation	Clean the filter. Ensure battery is fully charged. If battery is old, consider replacement.
Vacuum cleaner not turning on	Battery not installed correctly; Battery completely drained; Safety cutoff activated	Reinstall battery, ensuring secure connection. Charge battery. Check for obstructions in the vacuum.

If you encounter issues not listed here or if the suggested solutions do not resolve the problem, please contact POWTREE customer support for assistance.

## 8. SPECIFICATIONS

Feature	Detail
Model	V10
Voltage	25.2V
Capacity	7000mAh
Battery Type	Lithium Ion
Watt-hour	1176.4Wh
Compatibility	Dyson V10 Allergy, Cyclone V10 Animal, V10 Absolute, V10 Motorhead, V10 Motorhead Origin, V10 Total Clean+, SV12 Series
Certifications	CE, FCC, ROHS
Package Dimensions	7.56 x 5.67 x 3.9 inches
Item Weight	1.43 pounds

# PRODUCT PARAMETERS

Professional Replacement for Dyson V10 SV12  
Handheld Cordless Vacuum Cleaner Batteries

Type

**Li-ion**

Voltage

**25.2V**

Capacity

**7000mAh**

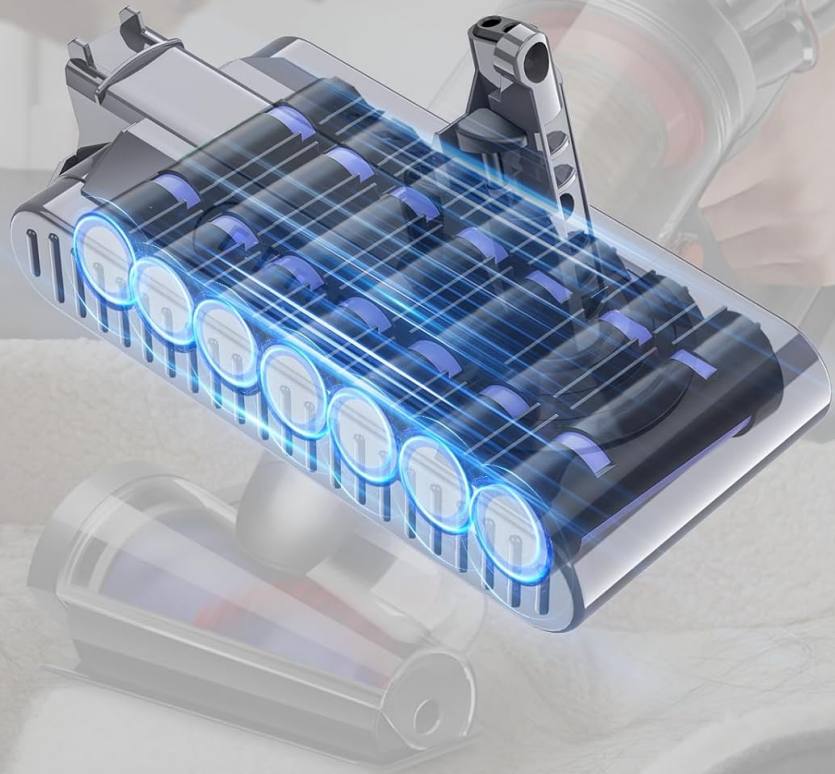

Image: Key product parameters are displayed, confirming the battery type as Li-ion, voltage at 25.2V, and a capacity of 7000mAh.

# PERFECT COMPATIBILITY



**V10 Series**



**SV12 Series**



Image: This visual confirms the battery's compatibility with Dyson V10 and SV12 series vacuum cleaners, including models like V10 Animal, V10 Absolute, and V10 Motorhead.

## 9. WARRANTY AND SUPPORT

POWTREE provides a **12-month warranty** for this V10 replacement battery. For any questions, concerns, or technical assistance, please contact our professional customer support team. We offer 24-hour online support to ensure your satisfaction.

For support, please refer to the contact information provided with your purchase or visit the official POWTREE store on Amazon.

## Related Documents - V10



### [V10 Bluetooth Intercom Quick Instruction Manual](#)

Learn how to operate your V10 Bluetooth intercom with this quick instruction manual. Includes details on phone features, music control, power management, pairing, and important safety notes for the Y10Host model.



	<p><a href="#">V10 Motorcycle Helmet Headset Quick Start Guide</a></p> <p>Concise instructions for setting up and operating the V10 motorcycle helmet headset, covering power, pairing, music, and call functions, with detailed button operations and safety information.</p>
	<p><a href="#">V10 Motorcycle Bluetooth Headset Quick Start Guide</a></p> <p>Concise guide to operating the V10 motorcycle Bluetooth headset, covering power, music, calls, pairing, and charging. Learn how to use your V10 for safe and convenient communication on the road.</p>
	<p><a href="#">Lachy DYV10AL Sweeper Battery User Manual</a></p> <p>Instruction manual for the Lachy DYV10AL sweeper battery, a replacement Li-ion battery for Dyson V10 series vacuum cleaners. Includes specifications, installation instructions, charging indicator guide, safety notes, and frequently asked questions.</p>
	<p><a href="#">Dyson Cyclone V10 Operating Manual and Safety Guide</a></p> <p>Comprehensive operating manual and safety instructions for the Dyson Cyclone V10 vacuum cleaner, covering assembly, usage, maintenance, troubleshooting, and warranty information.</p>
	<p><a href="#">Dyson Cyclone V10 Operating Manual and Safety Instructions</a></p> <p>Comprehensive operating manual and safety instructions for the Dyson Cyclone V10 vacuum cleaner, covering assembly, usage, maintenance, troubleshooting, and warranty information.</p>