

Pasapair QHA-15W-WIFI

Pasapair Electric Patio Heater Instruction Manual

Model: QHA-15W-WIFI

1. IMPORTANT SAFETY INSTRUCTIONS

Read all instructions carefully before using this appliance. Failure to follow these instructions may result in fire, electric shock, injury, or property damage. Keep this manual for future reference.

- **Electrical Safety:** Ensure the power supply matches the voltage specified on the heater's rating label. Do not operate the heater with a damaged cord or plug. Do not run the power cord under carpeting or cover it with throw rugs, runners, or similar coverings. Arrange the cord away from traffic areas where it will not be tripped over.
- **Placement:** Maintain a minimum clearance of 0.5 meters (19.7 inches) from the wall and 2.4 meters (94.5 inches) from the floor. Do not install the heater directly above or below an electrical outlet. Do not place the heater near flammable materials such as furniture, pillows, bedding, papers, clothes, and curtains.
- **"DO NOT COVER":** Never cover the heater. Covering the heater can lead to overheating and fire.
- **Water Resistance:** This heater is IP65 water resistant, making it suitable for outdoor use. However, do not immerse the heater in water or expose it to direct high-pressure water jets.
- **Overheat Protection:** The heater is equipped with a built-in safety protection system that automatically shuts off the unit if it overheats. If this occurs, unplug the heater, allow it to cool down, and then plug it back in.
- **Child Lock:** The heater includes a child lock function for enhanced safety, preventing unintended operation.
- **Supervision:** Close supervision is necessary when any appliance is used by or near children or individuals with reduced physical, sensory, or mental capabilities.

2. PRODUCT OVERVIEW

The Pasapair Electric Patio Heater (Model QHA-15W-WIFI) is a smart infrared heater designed for both indoor and outdoor wall-mounted use. It features app control, a 24-hour timer, and four heating modes, providing efficient and quiet warmth.

2.1 Components

- Infrared Heating Element
- Control Panel with LED Display
- Wall Mounting Brackets
- Remote Control
- Power Cord

2.2 Key Features

- **Smart APP Control:** Manage heating functions and timing via a mobile application.
- **4 Heating Modes:** Offers various heat settings for different comfort levels.
- **3-Second Fast Heating:** Utilizes carbon infrared technology for rapid warmth.
- **24-Hour Timer:** Schedule operation for convenience and energy saving.
- **Quiet Operation:** Designed for minimal noise, suitable for bedrooms.
- **Wall-Mounted Design:** Space-saving and provides focused warmth.
- **IP65 Water Resistant:** Certified for protection against dust and water jets, suitable for outdoor environments.
- **CSA Certified:** Ensures product safety and quality standards.
- **Child Lock Function:** Prevents accidental changes to settings.



Image 2.1: Pasapair Electric Patio Heater with included remote control and a smartphone displaying the control app.

Carbon Infrared Technology

Warm up your space with fast heating.



Image 2.2: Detail of the heater highlighting its 3-second fast heating capability and four distinct power settings.

High-Definition LED Display with Remote Control

Designed with an operation timer.



24-hour
Timer



Remote
Control

Image 2.3: The heater's high-definition LED display and remote control functionality.

3. SETUP AND INSTALLATION

This heater is designed for wall mounting. Follow these steps for proper installation.

3.1 Unpacking

Carefully remove the heater and all accessories from the packaging. Inspect for any damage. Retain packaging for future storage or transport.

3.2 Wall Mounting

1. Choose a suitable location on a solid wall, ensuring the minimum clearance requirements are met

(0.5m from wall, 2.4m from floor). The heater should not face vertically to the floor.

2. Use the provided mounting brackets as a template to mark the drilling points on the wall.
3. Drill holes and insert wall plugs if necessary. Secure the mounting brackets to the wall using the screws.
4. Carefully attach the heater to the mounted brackets, ensuring it is securely fastened.

Easy to Install

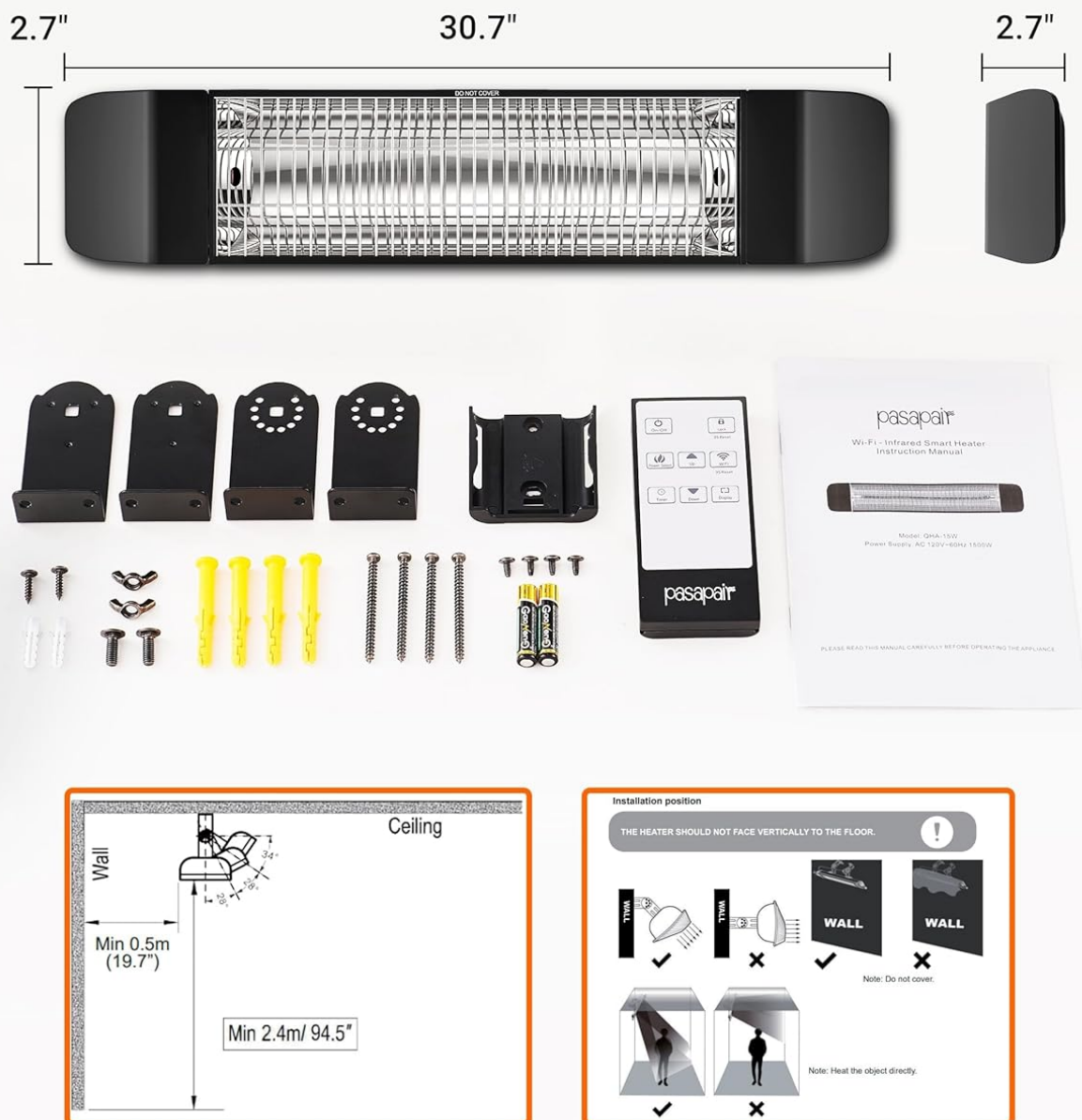

Image 3.1: Heater dimensions, included mounting hardware, and critical installation guidelines for wall placement.

3.3 Power Connection

Plug the power cord into a grounded electrical outlet. Ensure the outlet meets the heater's power requirements.

3.4 App Pairing (Smart Life APP)

1. Download the 'Smart Life' app from your smartphone's app store.
2. Register or log in to your Smart Life account.
3. Follow the in-app instructions to add a new device. Ensure your heater is powered on and your phone is connected to a 2.4GHz Wi-Fi network (5GHz networks are not supported).
4. The app will guide you through the pairing process. Once connected, you can control the heater remotely.

4. OPERATING INSTRUCTIONS

The Pasapair Electric Patio Heater can be operated using the included remote control or the Smart Life mobile application.

4.1 Power On/Off

Press the power button on the heater's control panel, the remote control, or through the Smart Life app to turn the heater on or off.

4.2 Heating Modes

The heater offers four heating modes (P1, P2, P3, P4) corresponding to different power levels (150W, 550W, 850W, 1500W). Select the desired mode using the remote control or the app.

4.3 24-Hour Timer

Set a timer for automatic shutdown using the remote control or the Smart Life app. This allows you to schedule the heater to turn off after a specified duration (e.g., 1 hour, 2 hours).

4.4 Child Lock Function

Activate the child lock via the remote control or app to prevent accidental changes to settings, ensuring safety around children.

APP Control from Anywhere

Turn on the heater before arriving home.



Image 4.1: Remote control of the heater via the Smart Life app, allowing pre-heating before arrival.

Video 4.1: Demonstration of the Pasapair Smart Infrared Heater's APP control and 24-hour timer functions, showcasing remote operation and scheduling capabilities.

4.5 Indoor and Outdoor Use

The heater's IP65 rating makes it suitable for both indoor and outdoor environments, such as patios, garages, and living spaces. Its quiet operation also makes it ideal for bedrooms.



Image 4.2: The heater's versatility for both indoor living spaces and outdoor patio areas.

Quietly Warm Up Cold Nights

Enjoy your warm and comfortable sleeping.



Image 4.3: The heater providing quiet warmth in a bedroom setting, ensuring comfortable sleep.

Wide Angle Heat Dissipation

If your garage space is larger and the ambient temperature is lower we recommend that you buy more than one.



Image 4.4: The heater effectively distributing heat in a garage environment, suitable for spaces up to 162 sq. ft.

IP65 Water Resistant

Suitable for any outdoor conditions.



Waterproof
IP65



CSA
Certification

Image 4.5: The heater operating on an outdoor patio during rainfall, demonstrating its IP65 water-resistant design.

5. MAINTENANCE AND CLEANING

Regular maintenance ensures optimal performance and longevity of your heater.

- **Before Cleaning:** Always unplug the heater from the power outlet and allow it to cool completely before cleaning.
- **Exterior Cleaning:** Wipe the exterior surfaces with a soft, damp cloth. Do not use abrasive cleaners, solvents, or harsh chemicals, as these can damage the finish.
- **Dust Removal:** Use a soft brush or vacuum cleaner with a brush attachment to gently remove dust from the grilles and heating elements.

- **Storage:** If storing the heater for an extended period, clean it thoroughly and store it in a cool, dry place, preferably in its original packaging.

6. TROUBLESHOOTING

If you encounter issues with your Pasapair Electric Patio Heater, refer to the following common problems and solutions:

Problem	Possible Cause	Solution
Heater does not turn on.	No power supply. Overheat protection activated.	Check if the power cord is securely plugged in and the outlet is functional. Reset the circuit breaker if necessary. Unplug the heater, allow it to cool for 10-15 minutes, then plug it back in.
No heat output.	Incorrect heating mode selected. Heater is in standby mode.	Ensure a heating mode (P1-P4) is selected, not just powered on. Verify the heater is not in standby.
Remote control not working.	Dead batteries. Obstruction between remote and heater.	Replace the batteries in the remote control. Ensure a clear line of sight to the heater's receiver.
App control not connecting.	Incorrect Wi-Fi network (5GHz). Heater not in pairing mode.	Ensure your phone and heater are connected to a 2.4GHz Wi-Fi network. Refer to the app pairing instructions in Section 3.4 to re-enter pairing mode.

If the problem persists after attempting these solutions, please contact customer support.

7. SPECIFICATIONS

Feature	Specification
Brand	Pasapair
Model Number	QHA-15W-WIFI
Product Dimensions	2.7"D x 30.7"W x 6.3"H
Item Weight	11 pounds
Mounting Type	Wall Mount
Special Features	Remote Control, APP Control, 24H Timer
Form Factor	Cabinet
Indoor/Outdoor Usage	Indoor and Outdoor (IP65 Certified)

Feature	Specification
Certifications	CSA Certified, IP65 Water Resistant

8. WARRANTY AND SUPPORT

For warranty information or technical support, please refer to the warranty card included with your product or contact Pasapair customer service. Keep your purchase receipt as proof of purchase.

Customer Service Contact: Refer to the contact information provided in your product packaging or visit the official Pasapair website.