

TWW95

Generic TWW95-95 Quart Dual Zone Portable Car Refrigerator User Manual

Model: TWW95

1. INTRODUCTION

Thank you for choosing the Generic TWW95-95 Quart Dual Zone Portable Car Refrigerator. This appliance is designed for versatile use, offering both refrigeration and freezing capabilities with individual temperature control in its dual compartments. It is suitable for automotive and household applications, making it ideal for road trips, camping, and other outdoor activities. Please read this manual thoroughly before operation to ensure proper use, maintenance, and safety.

Key features of your TWW95 refrigerator include:

- **Dual Compartments:** Independent temperature control for each zone, ranging from -4°F to 68°F (-20°C to 20°C).
- **Portable Design:** Equipped with large wheels and a heavy-duty telescopic handle for easy transport.
- **Flexible Power Options:** Compatible with 12V/24V DC for vehicles and 100-240V AC for household use.
- **Battery Protection System:** Three-level system to prevent vehicle battery drain.
- **Durable Construction:** Shock-resistant design suitable for various terrains, safe for operation at angles less than 45 degrees.
- **Convenient Features:** Reversible/detachable door, drainage plugs, LED interior lights, and a digital display for temperature control.

2. SAFETY INFORMATION

Please observe the following safety precautions to prevent injury and damage to the appliance:

- Ensure the power supply voltage matches the specifications of the refrigerator.
- Do not operate the appliance if the power cord is damaged. Contact qualified service personnel for repair.
- Keep the ventilation openings clear of obstructions.
- Do not use electrical appliances inside the refrigerator unless they are recommended by the manufacturer.
- Avoid placing the refrigerator in direct sunlight or near heat sources.

- Do not immerse the refrigerator in water or expose it to heavy rain.
- Always disconnect the power supply before cleaning or performing maintenance.
- This appliance is not intended for use by persons (including children) with reduced physical, sensory or mental capabilities, or lack of experience and knowledge, unless they have been given supervision or instruction concerning use of the appliance by a person responsible for their safety.

3. PRODUCT OVERVIEW

Familiarize yourself with the components and features of your portable refrigerator.

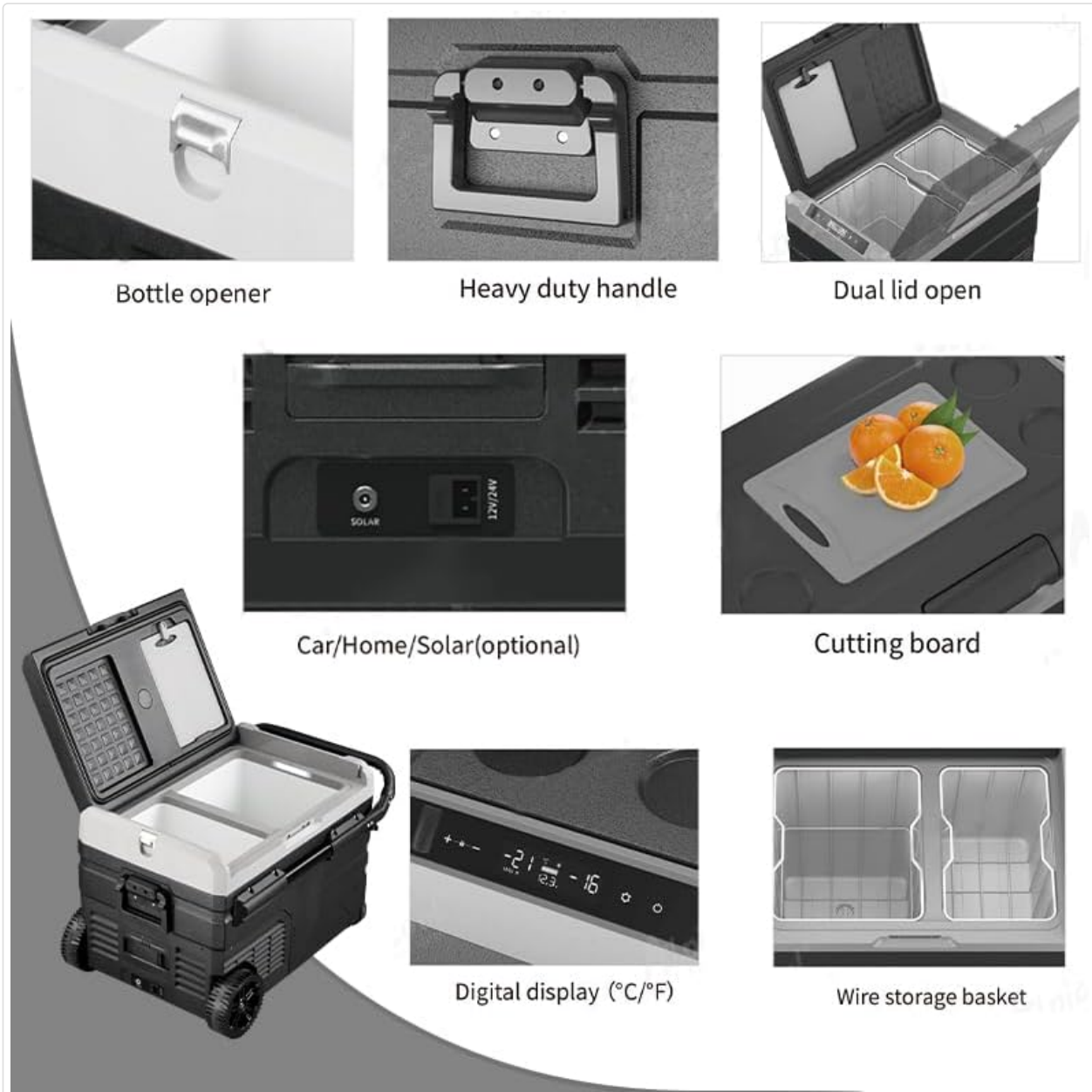

Figure 3.1: Key Features and Components. This image highlights the integrated bottle opener, robust handles, dual-opening lids, versatile power input options (12V/24V DC, AC, and optional solar), a built-in cutting board, a digital temperature display, and internal wire storage baskets.



Figure 3.2: Side View with Portability Features. This image displays the refrigerator from the side, emphasizing its large, durable wheels and the extendable telescopic handle designed for easy transport. A separate wire storage basket is also shown, indicating an included accessory.



Non-slip Handle

EASY TO CARRY

Figure 3.3: Easy Portability with Non-slip Handle. This image shows a user effortlessly pulling the portable refrigerator across uneven terrain, demonstrating the effectiveness of its non-slip telescopic handle for convenient transportation.

ANTI-VIBRAZIONE ANTI-SCALINAMENTO

Incline Operation up to 45° Off Level in Short Time.



Figure 3.4: Anti-Vibration and Incline Operation. This diagram illustrates the refrigerator's robust design, highlighting its ability to operate safely and maintain stability even when inclined up to 45 degrees, making it suitable for rough road conditions.



Figure 3.5: Low Noise Operation. This image demonstrates the refrigerator's quiet operation, indicating a noise level below 45dB, which is comparable to a whisper and significantly quieter than normal conversation or car driving sounds.

4. SETUP

4.1 Unpacking

1. Carefully remove the refrigerator from its packaging.
2. Remove all packing materials, including any protective films or tapes.
3. Inspect the appliance for any signs of damage. If damaged, do not operate and contact your retailer.

4.2 Initial Placement

- Place the refrigerator on a flat, stable surface.
- Ensure there is adequate ventilation around the unit (at least 10 cm clearance on all sides).
- Avoid placing it in direct sunlight or near heat-emitting appliances.

4.3 Power Connection

The refrigerator can be powered by either DC (12V/24V) or AC (100-240V).

- **DC Power (Vehicle):** Connect the DC power cord to the refrigerator's DC input port and then to your vehicle's 12V/24V power outlet (cigarette lighter socket).
- **AC Power (Household):** Connect the AC power cord with the adapter to the refrigerator's AC input port and then to a standard household power outlet.

4.4 What's in the Box

The package typically includes:

- Car Refrigerator (TWW95-95 Quart) x1
- DC Power cord x1
- AC Power cord with adapter x1
- User Manual x1
- Inner Basket x1

5. OPERATING INSTRUCTIONS

5.1 Powering On/Off

Press and hold the power button on the digital control panel to turn the refrigerator on or off.

5.2 Temperature Control (Dual Zone)

The TWW95 features dual compartments with individual temperature control. The digital display allows you to set the desired temperature for each zone.

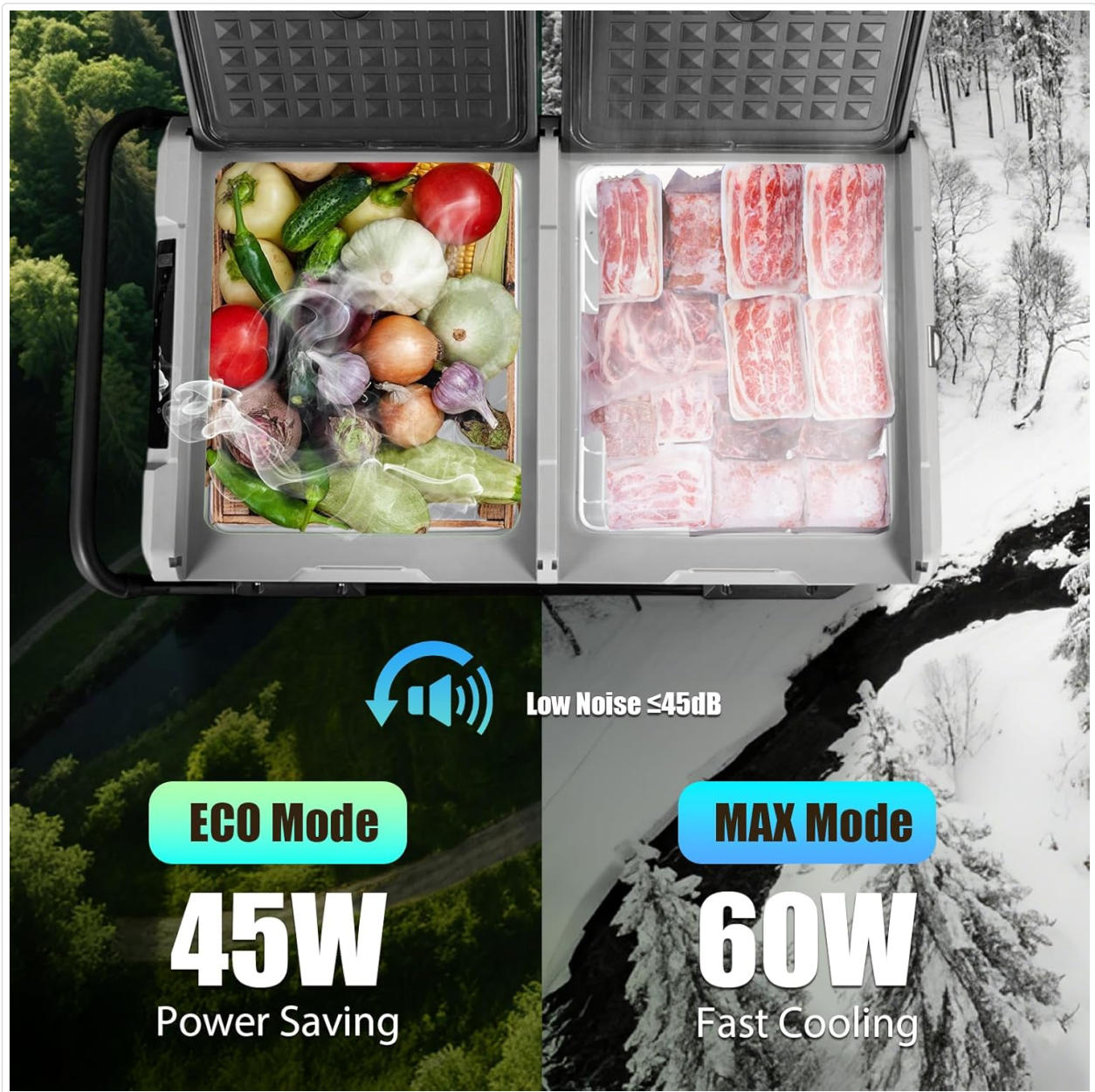

Figure 5.1: Dual Compartments and Cooling Modes. This image shows the two distinct compartments, one set for refrigeration (vegetables) and the other for freezing (meat), along with indicators for ECO (45W, power saving) and MAX (60W, fast cooling) modes.



DUAL-ZONE LARGE-CAPACITY STORAGE

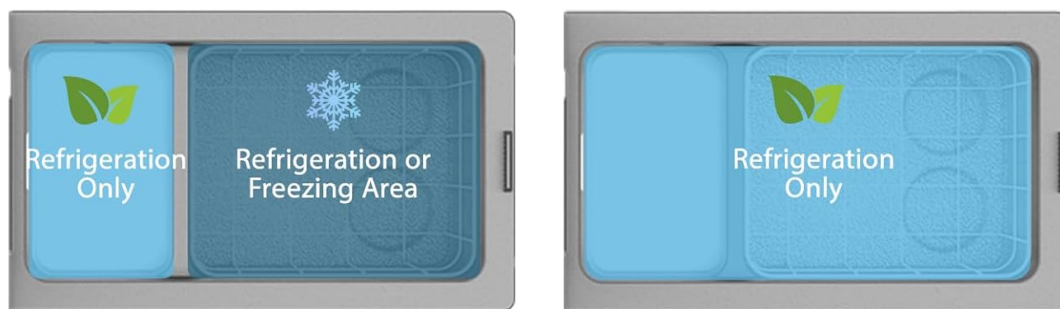

Figure 5.2: Dual Zone Storage Configurations. This diagram explains how the dual zones can be configured: either both zones set for refrigeration, or one zone for freezing and the other for refrigeration, providing flexible storage options.

- Use the '+' and '-' buttons on the control panel to adjust the temperature for each compartment.
- The display will show the current temperature and the set temperature.
- The refrigerator will automatically adjust to maintain the set temperature.

5.3 Operating Modes (ECO/MAX)

Your refrigerator offers two operating modes:

- **ECO Mode (45W):** Energy-saving mode for efficient operation when fast cooling is not required.
- **MAX Mode (60W):** Provides rapid cooling for quicker temperature reduction.

Switch between modes using the designated button on the control panel.

5.4 Battery Protection System

The refrigerator features a three-level battery protection system to prevent your vehicle's battery from draining completely. You can select the desired protection level (High, Medium, Low) via the control panel settings. Refer to the detailed instructions in the full manual for specific steps on adjusting this setting.

5.5 Reversible/Detachable Door

The refrigerator door can be reversed or detached for flexible opening and easier cleaning. Consult the full manual for detailed instructions on how to safely reverse or detach the door.

6. MAINTENANCE

6.1 Cleaning

- Always disconnect the power before cleaning.
- Clean the interior and exterior surfaces with a damp cloth and mild detergent.
- Do not use abrasive cleaners or harsh chemicals.
- Ensure the drainage plugs are clear to allow for easy cleaning and defrosting.
- The removable door design facilitates thorough cleaning of the interior compartments.

6.2 Storage

When storing the refrigerator for an extended period:

- Ensure the unit is clean and dry.
- Leave the lid slightly ajar to prevent odors and mold growth.
- Store in a dry, well-ventilated area, away from direct sunlight and extreme temperatures.

7. TROUBLESHOOTING

If you encounter issues with your refrigerator, refer to the table below for common problems and solutions.

Problem	Possible Cause	Solution
Refrigerator does not turn on	No power supply; Damaged power cord; Blown fuse in vehicle	Check power connection; Replace power cord; Check/replace vehicle fuse
Not cooling sufficiently	Temperature setting too high; Poor ventilation; Excessive contents; Door not sealed properly	Adjust temperature; Ensure proper clearance; Reduce contents; Check door seal
Excessive noise	Unit not level; Fan obstruction	Place on a level surface; Clear any obstructions from fan area
Digital display not working	Power issue; Control panel malfunction	Check power; Contact customer support

If the problem persists after attempting these solutions, please contact customer support.

8. SPECIFICATIONS

Detailed technical specifications for the TWW95-95 Quart model:

95QT/90.2L CAPACITY



x126
12 oz
(355ml)

or



x82
16.9 oz
(500ml)

or



x45
25 oz
(750ml)

*All data are measured manually, please allow a certain degree of error



Internal Dimensions

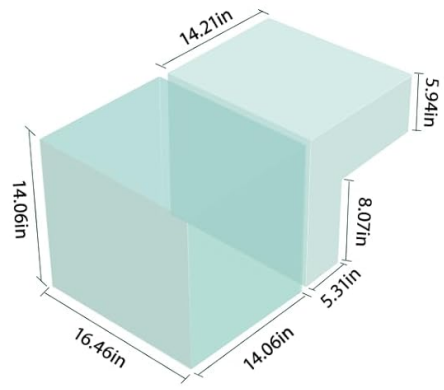

Dimensions: INCH

Figure 8.1: Capacity and Dimensions. This image provides a visual representation of the refrigerator's external measurements (39.57 inches length, 18.31 inches width, 22.48 inches height) and internal compartment dimensions, alongside its 95 Quart (90.2 Liter) capacity, indicating how many 12oz cans, 16.9oz bottles, or 25oz bottles it can hold.

Feature	Specification
Model	TWW95
Capacity	95 Quart (90 Liters)
Cooling Range	-4°F to 68°F (-20°C to 20°C)
Power Input (DC)	12V / 24V
Power Input (AC)	100-240V
Current (DC)	6.0A / 3.0A
Current (AC)	1.5A - 0.7A
Average Power Consumption	80W
Product Dimensions (L x W x H)	39.57 x 18.31 x 22.48 inches (100.5 x 46.5 x 57.1 cm)
Item Weight	64.81 pounds (29.4 kg)

Feature	Specification
Installation Type	Freestanding
Defrost System	Manual
Door Hinges	Reversible
Number of Doors	1
Special Feature	Portable

9. WARRANTY AND SUPPORT

9.1 Warranty Information

This product comes with a standard manufacturer's warranty. Please refer to the warranty card included in your package or contact your retailer for specific warranty terms and conditions. Keep your purchase receipt as proof of purchase for warranty claims.

9.2 Customer Support

For technical assistance, troubleshooting beyond this manual, or warranty inquiries, please contact the retailer or manufacturer's customer support. Contact information can typically be found on the product packaging or the retailer's website.