

Manuals+

[Q & A](#) | [Deep Search](#) | [Upload](#)

DUSONLAP SU8

DUSONLAP SU8 Sleep Earbuds User Manual

Model: SU8

INTRODUCTION



Image: DUSONLAP SU8 Sleep Earbuds in their charging case, showcasing their compact design and digital display.

Welcome to the DUSONLAP SU8 Sleep Earbuds user manual. These lightweight, in-ear headphones are designed to provide a comfortable and immersive audio experience, particularly for sleep and relaxation. Featuring advanced Bluetooth 5.4 technology, they offer stable connectivity and superior sound quality. This manual will guide you through the setup, operation, maintenance, and troubleshooting of your new earbuds to ensure optimal performance and a peaceful listening experience.

WHAT'S IN THE BOX

What's in the box?

- SU8 Sleep Earbuds x2
- SU8 Charging Case x1
- USB-C Charging Cable x1
- User Guide x1



Image: A visual representation of all items included in the DUSONLAP SU8 Sleep Earbuds package, including the earbuds, charging case, USB-C cable, and user guide.

Upon opening your DUSONLAP SU8 Sleep Earbuds package, please verify that all the following components are included:

- SU8 Sleep Earbuds x 2 (Left and Right)
- SU8 Charging Case x 1
- USB-C Charging Cable x 1
- User Manual x 1

PRODUCT OVERVIEW



Image: An illustration highlighting key design features of the SU8 earbuds, including Bluetooth 5.4, battery life, lightweight design, ergonomic fit, sleep mode, and removable ear caps.

The DUSONLAP SU8 Sleep Earbuds are engineered for comfort and performance, especially during extended wear or sleep. Key features include:

- **Ultra-Lightweight Design:** Each earbud weighs approximately 3.0 grams, ensuring minimal pressure and maximum comfort, even for side sleepers.

- **Bluetooth 5.4 Technology:** Provides a fast, stable, and seamless wireless connection with low latency, ensuring synchronized audio and video.
- **Ergonomic Fit:** Designed to fit snugly and securely within the ear canal, reducing discomfort and improving passive noise isolation.
- **Sleep Mode:** A unique feature that effectively reduces ambient noise without disruptive beeping or low battery alarms, promoting peaceful sleep.
- **Intuitive Touch Controls:** Easily manage music playback, calls, volume, and activate voice assistant with simple touch gestures.
- **Extended Battery Life:** Up to 5-7 hours of listening time on a single charge, with the charging case providing an additional 40 hours of battery life.

SETUP

1. Charging the Earbuds and Case



Image: Visual guide to the SU8 earbuds' battery life, showing the charging case's digital power display and individual earbud charging indicators.

1. **Initial Charge:** Before first use, fully charge both the earbuds and the charging case. Place the earbuds into the charging case.
2. **Charge Case:** Connect the provided USB-C charging cable to the charging port on the case and plug the other end into a USB power source (e.g., wall adapter, computer USB port).
3. **Charging Indicators:** The digital LED display on the charging case will show the battery percentage. The earbuds will have individual charging indicators (L/R) within the case.
4. **Full Charge:** Charging is complete when the case display shows 100% and the earbud indicators turn off or show full.

2. Pairing with Your Device

One Step Pairing

It will automatically connect when the lid is opened.



Image: The SU8 earbuds in their open charging case next to a smartphone displaying the Bluetooth pairing screen, showing "SU8 Connected audio".

1. **Power On:** Open the lid of the charging case. The earbuds will automatically power on and enter pairing mode.
2. **Activate Bluetooth:** On your device (smartphone, tablet, computer), go to your Bluetooth settings and ensure Bluetooth is enabled.
3. **Select "SU8":** In the list of available Bluetooth devices, select "SU8".
4. **Connection Confirmation:** Once connected, your device will show "SU8 Connected" or similar. The earbuds will automatically connect to the last paired device when the case lid is opened.

3. Wearing the Earbuds

How to Wear SU8 Sleep Earbuds

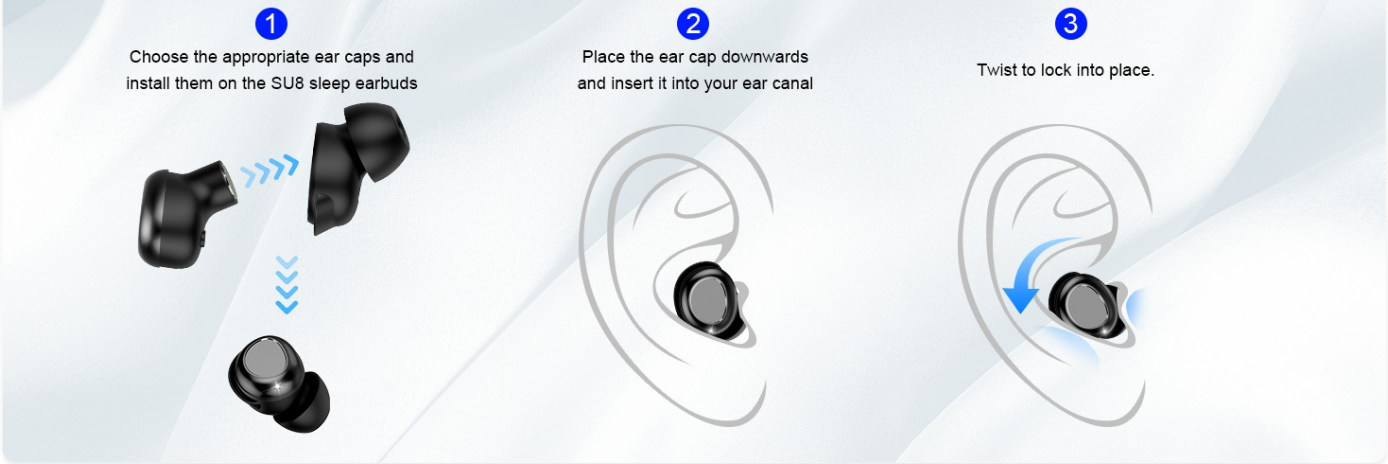

Image: A three-step visual guide demonstrating how to wear the SU8 earbuds: 1) choose appropriate ear caps, 2) insert ear cap downwards into ear canal, and 3) twist to lock into place.

For optimal sound quality, comfort, and noise isolation, proper fit is essential:

- 1. **Choose Ear Caps:** Select the ear caps that best fit your ear canal. The SU8 comes with various sizes to ensure a snug and comfortable seal.
- 2. **Insert Earbud:** Gently insert the earbud into your ear canal with the ear cap pointing downwards.
- 3. **Twist to Secure:** Lightly twist the earbud to lock it into place, ensuring a secure and comfortable fit. The earbud should feel stable and not easily fall out.

OPERATING INSTRUCTIONS

Touch Controls

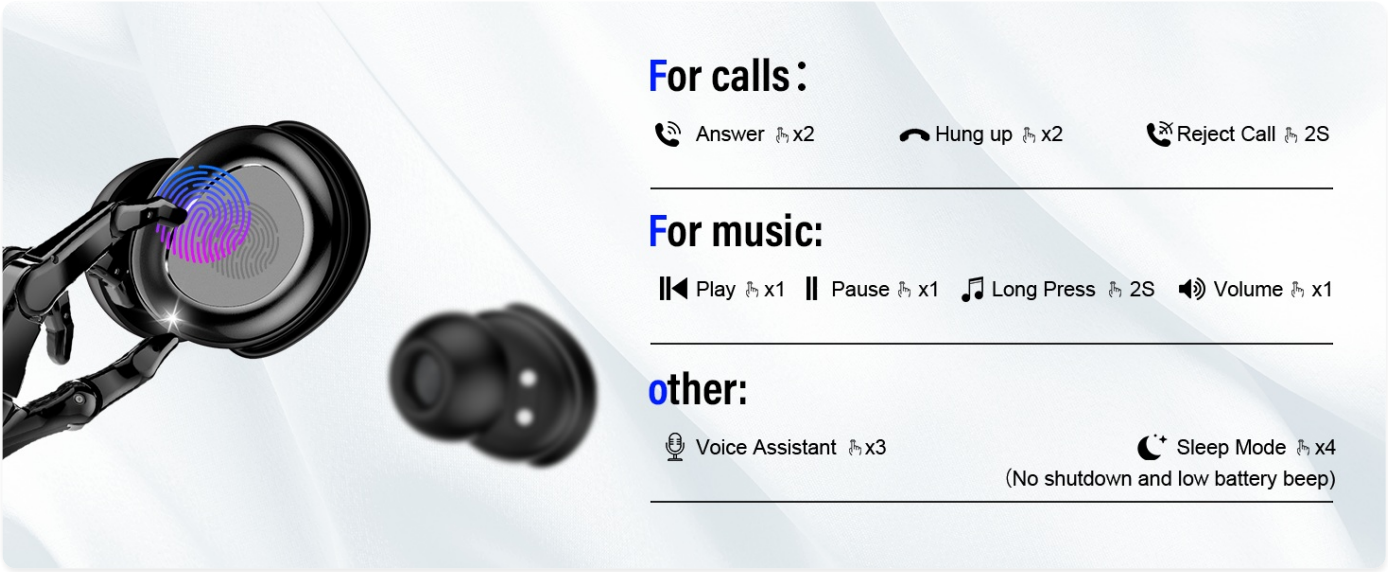

Image: A detailed diagram illustrating the touch control functions for calls, music playback, volume adjustment, voice assistant activation, and sleep mode on the SU8 earbuds.

The DUSONLAP SU8 Sleep Earbuds feature intuitive touch controls on each earbud. Refer to the table below for specific functions:

Action	Function
Tap x1 (Left/Right)	Play/Pause Music
Tap x2 (Left/Right)	Answer/End Call
Long Press 2S (Right)	Volume +
Long Press 2S (Left)	Volume -
Tap x3 (Left/Right)	Activate Voice Assistant
Tap x4 (Left/Right)	Toggle Sleep Mode (No shutdown and low battery beep)
Long Press 2S (during incoming call)	Reject Call

Sleep Mode

Manage your Sleep

It will automatically connect when the lid is opened.



Image: A person sleeping peacefully with the SU8 earbuds, accompanied by icons indicating Sleep Mode, No Power Off Alarm, and No Low Battery Alarm.

The SU8 Sleep Earbuds feature a dedicated Sleep Mode designed for uninterrupted rest. When activated (Tap x4), this mode ensures:

- **No Beeping:** Eliminates any disruptive beeps, including low battery warnings or power-off notifications, allowing for continuous audio playback.
- **Enhanced Noise Reduction:** Optimizes the earbuds' passive noise blocking capabilities to create a quieter environment for sleep or focus.

MAINTENANCE

Proper maintenance ensures the longevity and optimal performance of your DUSONLAP SU8 Sleep Earbuds.

- **Cleaning:**

- Regularly clean the earbuds and charging case with a soft, dry, lint-free cloth.
 - For earwax or debris in the ear tips/grilles, use a small, soft brush or cotton swab lightly dampened with isopropyl alcohol. Ensure no liquid enters the earbud openings.
 - Do not use abrasive cleaners, solvents, or harsh chemicals.
- **Storage:**
 - When not in use, always store the earbuds in their charging case to protect them and keep them charged.
 - Store in a cool, dry place, away from extreme temperatures, humidity, and direct sunlight.
- **Battery Care:**
 - Avoid fully depleting the battery frequently. Charge them regularly.
 - If storing for an extended period, charge the case and earbuds to about 50% every few months to prevent battery degradation.

TROUBLESHOOTING

If you encounter any issues with your DUSONLAP SU8 Sleep Earbuds, please refer to the common troubleshooting steps below:

Problem	Possible Solution
Earbuds not pairing/connecting.	<ul style="list-style-type: none"> ◦ Ensure earbuds are charged. ◦ Place earbuds back in the case, close the lid, wait 5 seconds, then open again. ◦ Turn off and on Bluetooth on your device. ◦ Forget "SU8" from your device's Bluetooth list and try pairing again. ◦ Ensure earbuds are within 10-12 meters of your device.
Only one earbud is working.	<ul style="list-style-type: none"> ◦ Ensure both earbuds are charged. ◦ Place both earbuds back in the charging case, close the lid, and then open it again. This often re-syncs them. ◦ Clean the charging contacts on both earbuds and inside the case.
No sound or low volume.	<ul style="list-style-type: none"> ◦ Increase volume on both your device and the earbuds (using touch controls). ◦ Ensure earbuds are properly connected to your device. ◦ Clean any debris from the earbud grilles. ◦ Try playing different audio sources.
Charging case not charging.	<ul style="list-style-type: none"> ◦ Ensure the USB-C cable is securely connected to both the case and the power source. ◦ Try a different USB-C cable or power adapter. ◦ Check if the power source is working.

SPECIFICATIONS

Below are the technical specifications for the DUSONLAP SU8 Sleep Earbuds:

Feature	Detail
Model Name	SU8
Brand	DUSONLAP
Connectivity Technology	Wireless (Bluetooth 5.4)
Ear Placement	In Ear
Form Factor	In Ear
Item Weight	2.89 ounces (approx. 3.0g per earbud)
Battery Life (Earbuds)	5-7 hours (listening time)
Battery Life (with Charging Case)	Up to 47 hours total (40 hours from case)
Charging Port	USB-C
Included Components	Earbuds, Charging Case, USB-C Cable, User Manual

WARRANTY AND SUPPORT

DUSONLAP products are manufactured to the highest quality standards. For information regarding warranty coverage, please refer to the warranty card included in your product packaging or visit the official DUSONLAP website. If you require further assistance, have questions, or encounter issues not covered in this manual, please contact DUSONLAP Customer Support through the contact information provided on our official website or your purchase platform.