

## dgtenk MA377

# DGTenk Android MP3 Player MA377 User Manual

Model: MA377 | Brand: DGTenk

## 1. INTRODUCTION

---

This manual provides detailed instructions for the DGTenk Android MP3 Player, model MA377. It covers device setup, operational procedures, maintenance guidelines, and troubleshooting tips to ensure optimal performance and user experience. This device features a 4-inch touch screen, 160GB storage (32GB ROM + 128GB card), Wi-Fi, Bluetooth 5.0, and parental control functionalities, running on Android 11 OS.



Image 1.1: Front view of the DGTenk Android MP3 Player MA377.

## 2. WHAT'S IN THE BOX

---

Verify that all items are present in the package before proceeding with setup.

- DGTenk Android MP3 Player (MA377)
- Protective Case
- USB Cable (for charging and data transfer)
- Protective Film

# Google Mobile Services Certified

Original Android 14 | Google Play Store | Family Link  
Parental Controls | Find My Device

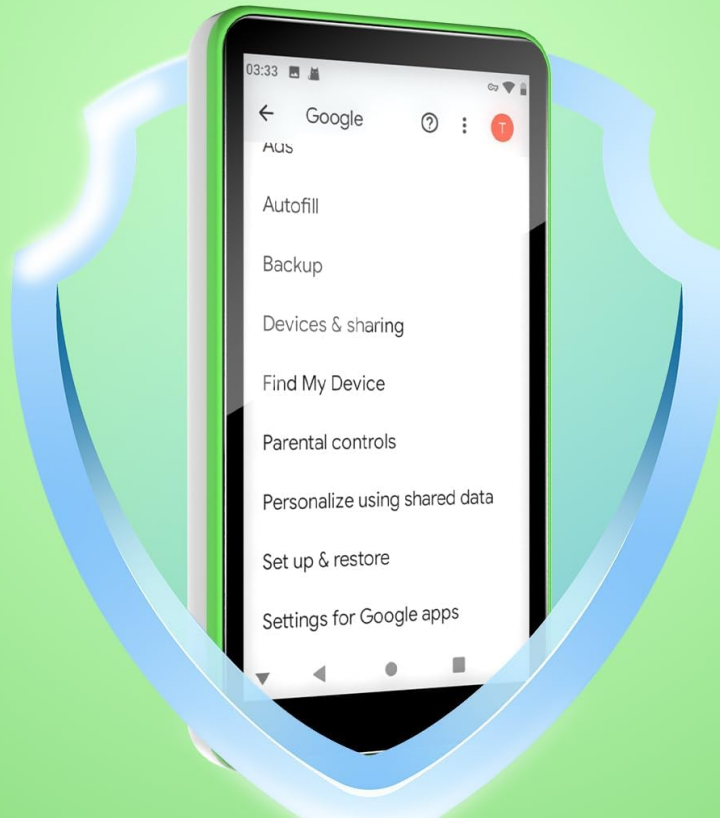

Image 2.1: Package contents including the MP3 player, protective case, USB cable, and protective film.

## 3. SETUP GUIDE

---

### 3.1 Charging the Device

Before initial use, fully charge the MP3 player. Connect the provided USB cable to the device's USB-C port and the other end to a compatible USB power adapter (not included) or a computer's USB port. The device features a 2000mAh battery, providing approximately 10 hours of audio playback or 5 hours of video playback. A full charge typically takes about 60 minutes.

### 3.2 Powering On/Off

- **To Power On:** Press and hold the power button located on the side of the device until the screen illuminates.
- **To Power Off:** Press and hold the power button, then select 'Power Off' from the on-screen options.

### 3.3 Initial Setup and Wi-Fi Connection

Upon first power-on, follow the on-screen prompts to complete the initial Android setup. This includes selecting your language, region, and connecting to a Wi-Fi network.

1. From the home screen, tap the 'Settings' icon.
2. Select 'Network & Internet'.
3. Toggle Wi-Fi 'On'.
4. Select your desired Wi-Fi network from the list.
5. Enter the network password if prompted, then tap 'Connect'.

### 3.4 Google Account and Parental Controls

The device is Google Mobile Services (GMS) certified, allowing access to the Google Play Store and Family Link parental controls. It is recommended to set up a Google account and configure parental controls for safe usage.

1. Go to 'Settings' > 'Accounts'.
2. Add your Google account or create a new one.
3. To set up parental controls, navigate to 'Settings' > 'Digital Wellbeing & Parental Controls' or use the Google Family Link app on a parent's device.
4. Configure app blocking, screen time limits, and content filtering as needed.



Image 3.1: Screenshot showing Google Mobile Services certification and parental control settings menu.

## 4. OPERATING INSTRUCTIONS

### 4.1 Navigating the Interface

The device features a 4-inch HD touchscreen. Swipe left/right to navigate between home screens, swipe down from the top for notifications and quick settings, and use the on-screen navigation buttons (Back, Home, Recent Apps) at the bottom.

### 4.2 Music and Video Playback

The device supports various audio and video formats and comes with pre-installed apps like Spotify and YouTube Music. You can also download other media players from the Google Play Store.

- **Streaming:** Open pre-installed apps like Spotify or YouTube Music, or download others like Netflix, and log in to stream content over Wi-Fi.
- **Offline Playback:** Transfer music and videos to the device's 160GB internal storage (32GB ROM + 128GB card) via USB or download content within streaming apps for offline access.

# Original Android 14

## Google Mobile Services Certified

### Q:What is GMS(Google Mobile Services)?

A:GMS (Google Mobile Services) is a specialized toolset for advanced Android device usage containing many applications and APIs for Android device manufacturers. GMS certified devices need a Google account sign in to access all related apps and efficiently manage data and operations.

### Pros of GMS devices

- 1.Easy access - A GMS device can easily access all of Google's apps and services.
- 2.Trusted Sources of App Installs - Google Play Store is a well-known and trusted platform for users to download Android apps.
- 3.Enhanced user experience - Most Android users are habitual users of Google services like Gmail and Google Drive. So, they get a familiar user experience with GMS devices, and it also offers uniformity and support for all GMS devices.
- 4.System updates - GMS ensures timely updates of OS and apps installed.

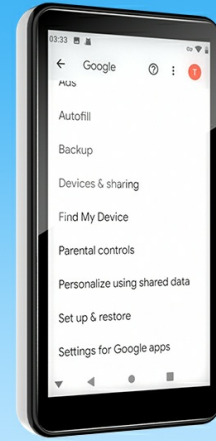

Image 4.1: Display of pre-installed applications including Spotify, YouTube, and Google Play Store.

## 4.3 Bluetooth Connectivity

Connect Bluetooth headphones, speakers, or other compatible devices using Bluetooth 5.0.

1. Go to 'Settings' > 'Connected devices' > 'Bluetooth'.
2. Toggle Bluetooth 'On'.
3. Ensure your Bluetooth accessory is in pairing mode.
4. Select the accessory from the list of available devices to pair.

## 4.4 Downloading Apps from Google Play Store

Access millions of apps, games, music, and books through the Google Play Store.

1. Tap the 'Play Store' icon on the home screen.
2. Search for the desired app.
3. Tap 'Install' to download and install the app.

## 5. MAINTENANCE

---

### 5.1 Cleaning the Device

Use a soft, lint-free cloth to clean the screen and body of the MP3 player. Avoid using abrasive cleaners or solvents, which can damage the device's finish or screen coating.

### 5.2 Battery Care

- Avoid exposing the device to extreme temperatures.
- Do not allow the battery to fully discharge for extended periods.
- Use only the provided USB cable for charging.

### 5.3 Software Updates

Periodically check for software updates to ensure optimal performance and security. Go to 'Settings' > 'System' > 'System update'.

## 6. TROUBLESHOOTING

---

Problem	Possible Cause	Solution
Device does not power on	Low battery; software glitch	Charge the device for at least 30 minutes. If still unresponsive, perform a force restart by holding the power button for 10-15 seconds.
Cannot connect to Wi-Fi	Incorrect password; router issue; Wi-Fi disabled	Verify Wi-Fi password. Restart your Wi-Fi router. Ensure Wi-Fi is enabled in device settings.
Apps crashing or freezing	Insufficient memory; app conflict; outdated app	Close background apps. Clear app cache/data (Settings > Apps). Update the app or the device software.
Bluetooth device not pairing	Device not in pairing mode; interference	Ensure Bluetooth accessory is in pairing mode. Move closer to the accessory. Toggle Bluetooth off and on on the MP3 player.
Slow performance	Too many apps running; low storage	Close unused apps. Clear cache. Delete unnecessary files or apps to free up storage.

## 7. SPECIFICATIONS

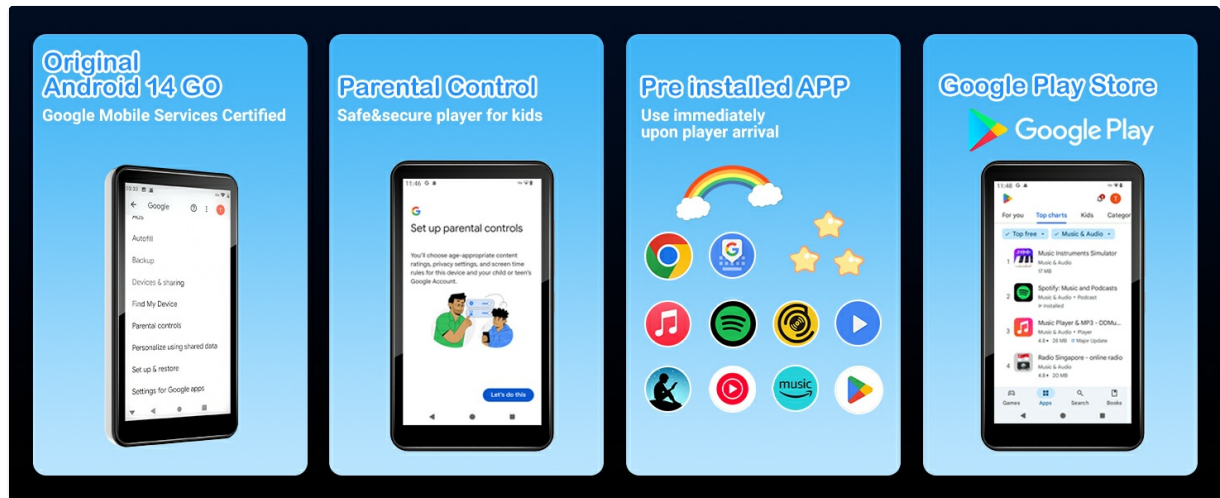

Image 7.1: Visual representation of the internal hardware, highlighting CPU, RAM, and ROM.

Feature	Detail
Model Number	MA377
Operating System	Android 11
Processor	MTK 8-core 2.0GHz CPU
RAM	3GB LPDDR4
Internal Storage (ROM)	32GB
Expandable Storage	128GB Micro SD card included (Total 160GB)

