

SKYRC MC5000

SKYRC MC5000 Cylindrical Battery Charger and Analyzer User Manual

Model: MC5000 | Brand: SKYRC

1. INTRODUCTION

The SKYRC MC5000 is an advanced cylindrical battery charger and analyzer designed for comprehensive battery management. This device provides precise control and analysis capabilities for a wide range of battery types and sizes, catering to both enthusiasts and professionals.

Key features include four independent charging slots, support for over 44 battery sizes and 10+ chemistries, multiple operating modes, high-precision voltage accuracy, internal resistance measurement, Bluetooth connectivity for app control, and robust safety protections.



Image 1.1: The SKYRC MC5000 Cylindrical Battery Charger and Analyzer with batteries inserted, displaying operational data on its screen.

2. SAFETY INSTRUCTIONS

To ensure safe operation and prevent damage to the device or batteries, please adhere to the following safety guidelines:

- Read this entire manual before using the charger.
- Use only the specified power adapter (PD 3.0 65W USB-C) to power the device.
- Ensure proper ventilation during operation. Do not cover the charger or block its cooling vents.
- Only charge battery types and sizes supported by the MC5000. Attempting to charge incompatible batteries may result in damage or injury.

- Do not short-circuit the battery slots or connect batteries with reversed polarity.
- Keep the charger away from water, moisture, and flammable materials.
- Always supervise the charging process, especially when charging new or unfamiliar battery types.
- If the charger emits smoke, unusual odors, or excessive heat, immediately disconnect it from the power source and remove batteries.
- Keep out of reach of children.

3. SETUP

3.1 Unboxing and Inspection

Carefully remove the MC5000 charger and all accessories from its packaging. Inspect the device for any signs of damage. If any damage is found, do not use the charger and contact your retailer.

3.2 Connecting Power

1. Connect a compatible PD 3.0 65W USB-C power adapter (not included) to the USB-C input port on the MC5000.
2. Plug the power adapter into a suitable wall outlet.
3. The charger's 2.8-inch full-color LCD display will illuminate, indicating it is powered on and ready for use.

3.3 Initial Interface Overview

The MC5000 features a 2.8-inch full-color LCD and a scroll wheel for navigation. The display shows real-time information for each of the four independent battery slots.



Image 3.1: Detailed view of the MC5000's LCD screen, illustrating the charge setting menu for a Li-ion battery.

3.4 Bluetooth Connectivity and App Control

The MC5000 can be controlled and monitored via the SkyCharger app, available for Android and iOS devices.

1. Download the "SkyCharger" app from your device's app store.
2. Enable Bluetooth on your smartphone or tablet.
3. Open the SkyCharger app and follow the on-screen instructions to pair with your MC5000 charger.
4. Once connected, you can monitor charging status, adjust settings, and view detailed battery data from your mobile device.



Image 3.2: The MC5000 charger shown alongside a smartphone running the SkyCharger application, demonstrating remote monitoring capabilities.

4. OPERATING MODES

The MC5000 offers six distinct operating modes to manage your cylindrical batteries effectively. Use the scroll wheel on the device or the SkyCharger app to select and configure these modes for each independent slot.

- **Charge:** This mode charges the battery to its full capacity. You can set the charge current and target voltage based on the battery chemistry.
- **Storage:** Charges or discharges the battery to a specific voltage level, typically around 3.8V for Li-ion batteries, which is ideal for long-term storage to preserve battery health.

- **Discharge:** Discharges the battery to a user-defined voltage or until a specified capacity is removed. Useful for testing actual capacity or preparing batteries for storage.
- **Cycle:** Performs a sequence of charge and discharge cycles to measure battery capacity and improve performance. You can configure the number of cycles and charge/discharge parameters.
- **Refresh:** Designed to rejuvenate older NiMH/NiCd batteries by repeatedly discharging and charging them to break down memory effect and restore capacity.
- **Break-in:** A specialized mode for new batteries, particularly NiMH/NiCd, to condition them for optimal performance by performing a slow charge followed by a discharge and then a full charge.



Image 4.1: The MC5000 demonstrating its compatibility with multiple battery chemistries, including Li-ion, NiMH, LiFePO₄, and Na-ion.

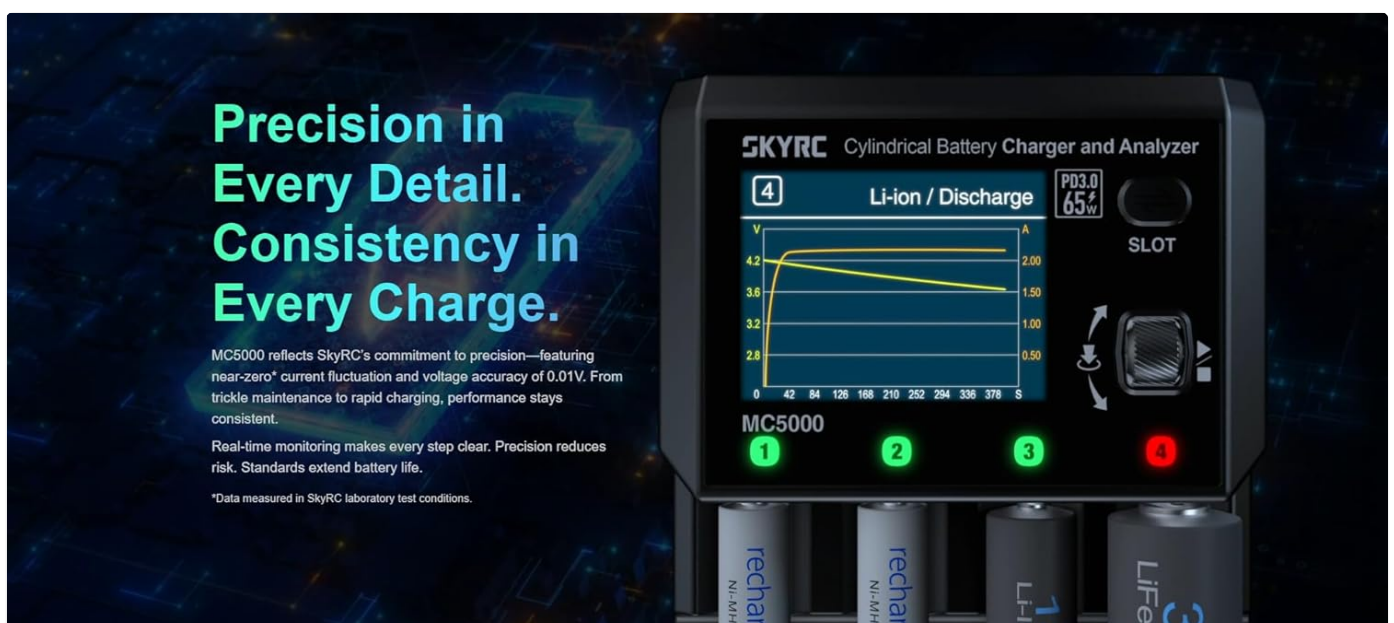

Image 4.2: The MC5000's display presenting a real-time discharge curve for a Li-ion battery, highlighting its analytical capabilities.

5. MAINTENANCE

5.1 Cleaning

To maintain optimal performance and longevity of your MC5000 charger:

- Ensure the charger is disconnected from power before cleaning.
- Use a soft, dry cloth to wipe the exterior of the device.
- Do not use abrasive cleaners, solvents, or immerse the device in water.
- Periodically check the battery slots and cooling vents for dust or debris and gently remove them using a soft brush or compressed air.

5.2 Storage

When not in use, store the MC5000 in a cool, dry place, away from direct sunlight and extreme temperatures. Ensure no batteries are left in the slots during storage.

6. TROUBLESHOOTING

This section addresses common issues you might encounter with your MC5000 charger.

Problem	Possible Cause	Solution
Charger does not power on.	No power, incorrect power adapter, faulty cable.	Ensure the PD 3.0 65W USB-C power adapter is correctly connected and functioning. Try a different USB-C cable or power source.
Battery not charging/discharging.	Incorrect battery type selected, poor contact, battery fault.	Verify the battery type and settings in the chosen operating mode. Ensure the battery is properly seated in the slot. Check battery health.
"Capacity Limit" error during Refresh/Discharge.	Battery capacity setting is too low for the actual battery.	Increase the battery capacity setting in the charger's menu or via the app. It is often recommended to set the capacity 20% higher than the nominal capacity for certain operations.
Bluetooth connection issues.	Bluetooth off, app not paired, interference.	Ensure Bluetooth is enabled on your mobile device. Restart the SkyCharger app and the MC5000. Re-pair the devices if necessary.
Charger feels warm/fans are running.	Normal operation, high current charging/discharging.	This is normal, especially during high-current operations. The smart triple-fan cooling system is designed to manage heat. Ensure vents are not blocked.



Image 6.1: The MC5000 and its companion app displaying the "Break-in" mode in progress for four batteries, indicating detailed status for each slot.

7. SPECIFICATIONS

Model	MC5000
Brand	SKYRC
Product Dimensions	7.4 x 4.8 x 2.5 inches (18.8 x 12.2 x 6.35 cm)
Item Weight	1.5 pounds (0.68 kg)
Supported Battery Chemistries	Li-ion, Li-ion HV, LiFePO4, NiMH, NiCd, NiZn, RAM, LTO, Na-ion
Supported Battery Sizes	44+ cylindrical sizes (e.g., AAA, AA, 18650, 21700, 32650)
Number of Slots	4 independent slots
Max Charging Current	Up to 5A per slot
Max Discharging Current	Up to 2A per slot

Operating Modes	Charge, Storage, Discharge, Cycle, Refresh, Break-in
Voltage Accuracy	±10mV
Display	2.8-inch full-color LCD
Connectivity	Bluetooth (SkyCharger app for Android and iOS)
Cooling System	Smart triple-fan cooling
Output Port	PD 3.0 65W USB-C (for external devices)
Safety Protections	Overcharge, Overheat, Short-circuit protection
Certification	FCC

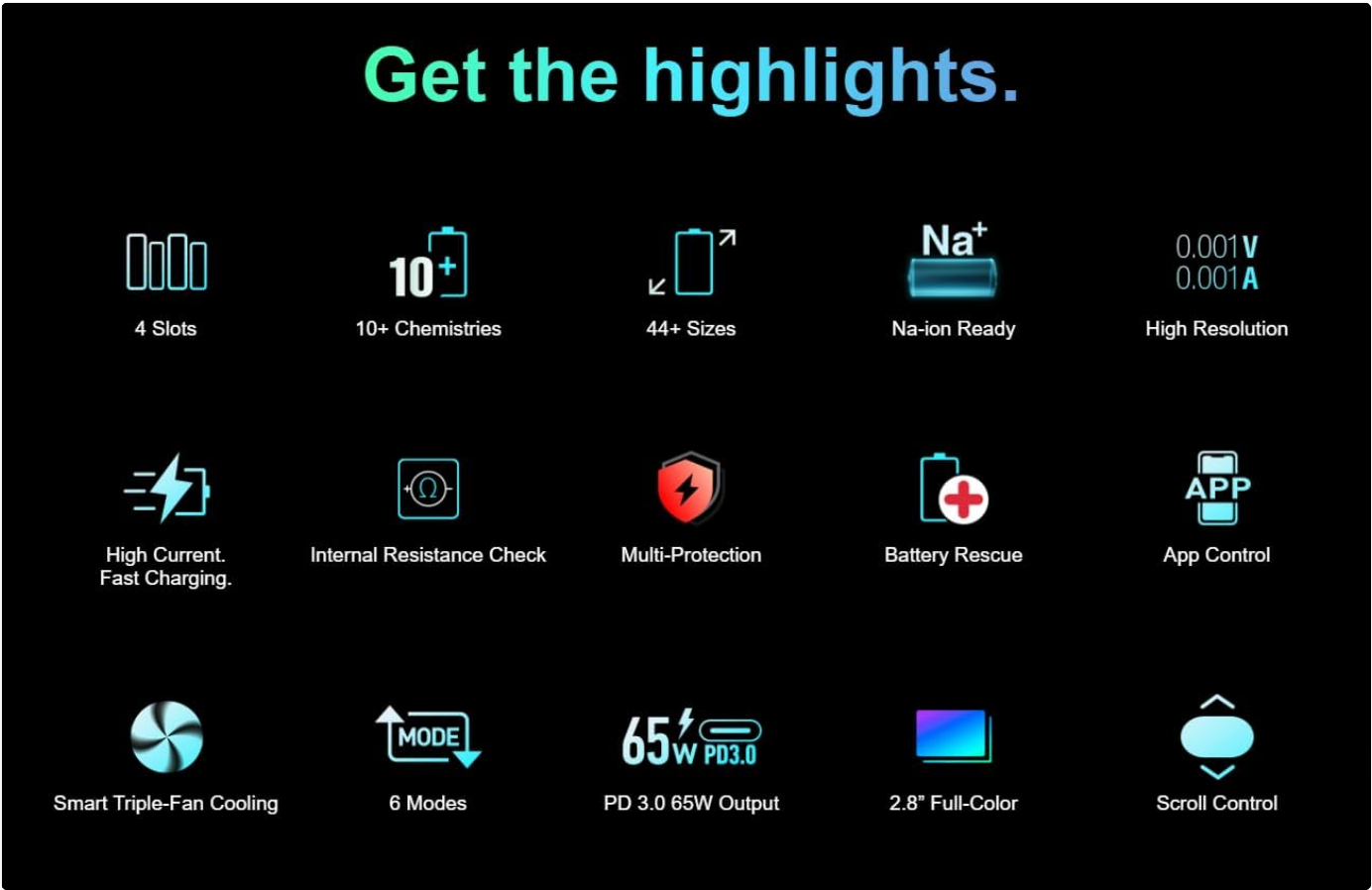
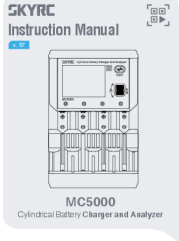
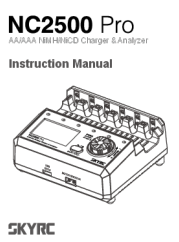

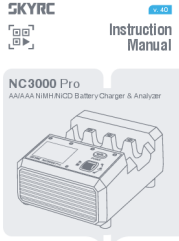
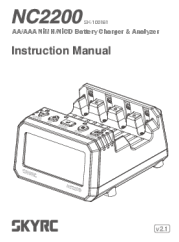



Image 7.1: An infographic summarizing the main features of the MC5000, including 4 slots, 10+ chemistries, 44+ sizes, and high resolution.

8. WARRANTY AND SUPPORT

For information regarding warranty coverage, technical support, or service, please refer to the official SKYRC website or contact your authorized retailer. Keep your purchase receipt as proof of purchase for warranty claims.



 <p>SKYRC Instruction Manual MC5000 Cylindrical Battery Charger and Analyzer</p>	<p>SkyRC MC5000 Cylindrical Battery Charger and Analyzer Instruction Manual</p> <p>This manual provides comprehensive instructions for the SkyRC MC5000 Cylindrical Battery Charger and Analyzer, covering features, operation, specifications, battery knowledge, and troubleshooting.</p>
 <p>NC2500 Pro AA/AAA NiMH/NiCD Charger & Analyzer Instruction Manual SKYRC</p>	<p>SKYRC NC2500 Pro: AA/AAA NiMH/NiCD Battery Charger & Analyzer Instruction Manual</p> <p>Comprehensive instruction manual for the SKYRC NC2500 Pro, a six-channel charger and analyzer for AA/AAA NiMH/NiCD batteries. Learn about its four working modes (Charge, Discharge, Refresh, Break-in), specifications, features, and operation for optimal battery care.</p>
 <p>NC2200 AA/AAA NiMH/NiCD Battery Charger & Analyzer 使用说明书 SKYRC</p>	<p>SKYRC NC2200 Battery Charger & Analyzer Instruction Manual</p> <p>A comprehensive guide to the SKYRC NC2200 battery charger and analyzer, detailing its features, operating modes, safety precautions, specifications, and mobile app connectivity for AA/AAA NiMH/NiCD batteries.</p>
 <p>SKYRC Instruction Manual NC3000 Pro AA/AAA NiMH/NiCD Battery Charger & Analyzer</p>	<p>SkyRC NC3000 Pro: AA/AAA NiMH/NiCD Battery Charger & Analyzer Instruction Manual</p> <p>Comprehensive instruction manual for the SkyRC NC3000 Pro, a versatile AA/AAA NiMH/NiCD battery charger and analyzer supporting QC2.0/QC/PD3.0, multiple charging modes, and Bluetooth app control. Learn about specifications, operation, battery knowledge, and troubleshooting.</p>
 <p>NC2200 AA/AAA NiMH/NiCD Battery Charger & Analyzer Instruction Manual SKYRC</p>	<p>SkyRC NC2200 AA/AAA NiMH/NiCD Battery Charger & Analyzer Instruction Manual</p> <p>Comprehensive instruction manual for the SkyRC NC2200 AA/AAA NiMH/NiCD Battery Charger & Analyzer, detailing features, specifications, operating modes, safety precautions, app connectivity, and warranty information.</p>
 <p>T100 AC Dual Balance Ladegerät Bedienungsanleitung SKYRC</p>	<p>SkyRC T100 AC Dual Balance Ladegerät Bedienungsanleitung</p> <p>Die Bedienungsanleitung für das SkyRC T100 AC Dual Balance Ladegerät. Enthält Informationen zu Funktionen, Sicherheitshinweisen, Bedienung verschiedener Akkutypen und technische Daten.</p>

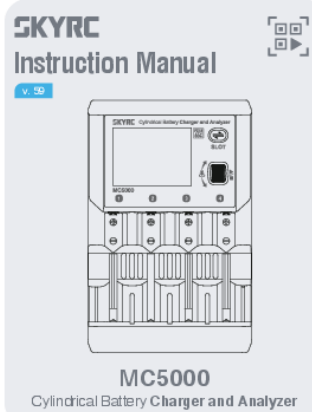

[\[pdf\]](#) User Manual Specifications Declaration of Conformity Warranty

MC5000 100214 Instruction Manual V 59 racing cars content files Sheets 59 |||

Instruction Manual v. 59 **MC5000** Cylindrical Battery Charger and Analyzer - 1 -
Contents Introduction 01 Features 01 Getting to know **MC5000** 02 Warning 03
Specifications 04 Battery Knowledge 06 Battery Voltage 07 Power and Battery
Connection 08 Charging Operation 09 Working Mode ...

lang:en score:53 filesize: 593 K page_count: 24 document date: 2025-06-24



lang:de score:50 filesize: 653.54 K page_count: 24 document date: 2025-06-24

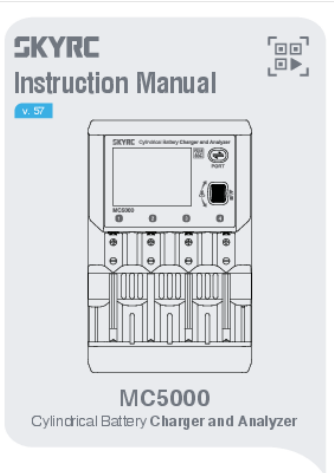

[SkyRC MC5000 Cylindrical Battery Charger and Analyzer Instruction Manual](#)

This manual provides comprehensive instructions for the SkyRC MC5000 Cylindrical Battery Charger and Analyzer, covering features, operation, specifications, battery knowledge, and troubleshooting.

lang:en score:34 filesize: 595.8 K page_count: 24 document date: 2025-03-14