

Manuals+

[Q & A](#) | [Deep Search](#) | [Upload](#)

[manuals.plus](#) /

> [Hapippofa](#) /

> [Hapippofa Home Security System Wireless WiFi DIY Alarm System \(Model A105F-US\) Instruction Manual](#)

Hapippofa A105F-US

Hapippofa Home Security System Wireless WiFi DIY Alarm System (Model A105F-US)

Instruction Manual

1. INTRODUCTION

This manual provides detailed instructions for the installation, operation, and maintenance of your Hapippofa Wireless WiFi DIY Home Security System, Model A105F-US. Please read this manual thoroughly before using the system to ensure proper functionality and safety. This system is designed to provide comprehensive home protection with easy setup and smart control features.



Image: Overview of the Hapippofa Home Security System components.

2. PACKAGE CONTENTS

Verify that all components are present in your package:

- 1 x Alarm Host
- 10 x Door Sensors
- 5 x Infrared Motion Detectors

- 3 x Remote Controls
- 3 x RFID Cards
- 1 x Panic Button
- 1 x Emergency Siren
- Mounting screws/adhesive tape
- Instruction Manual (this document)

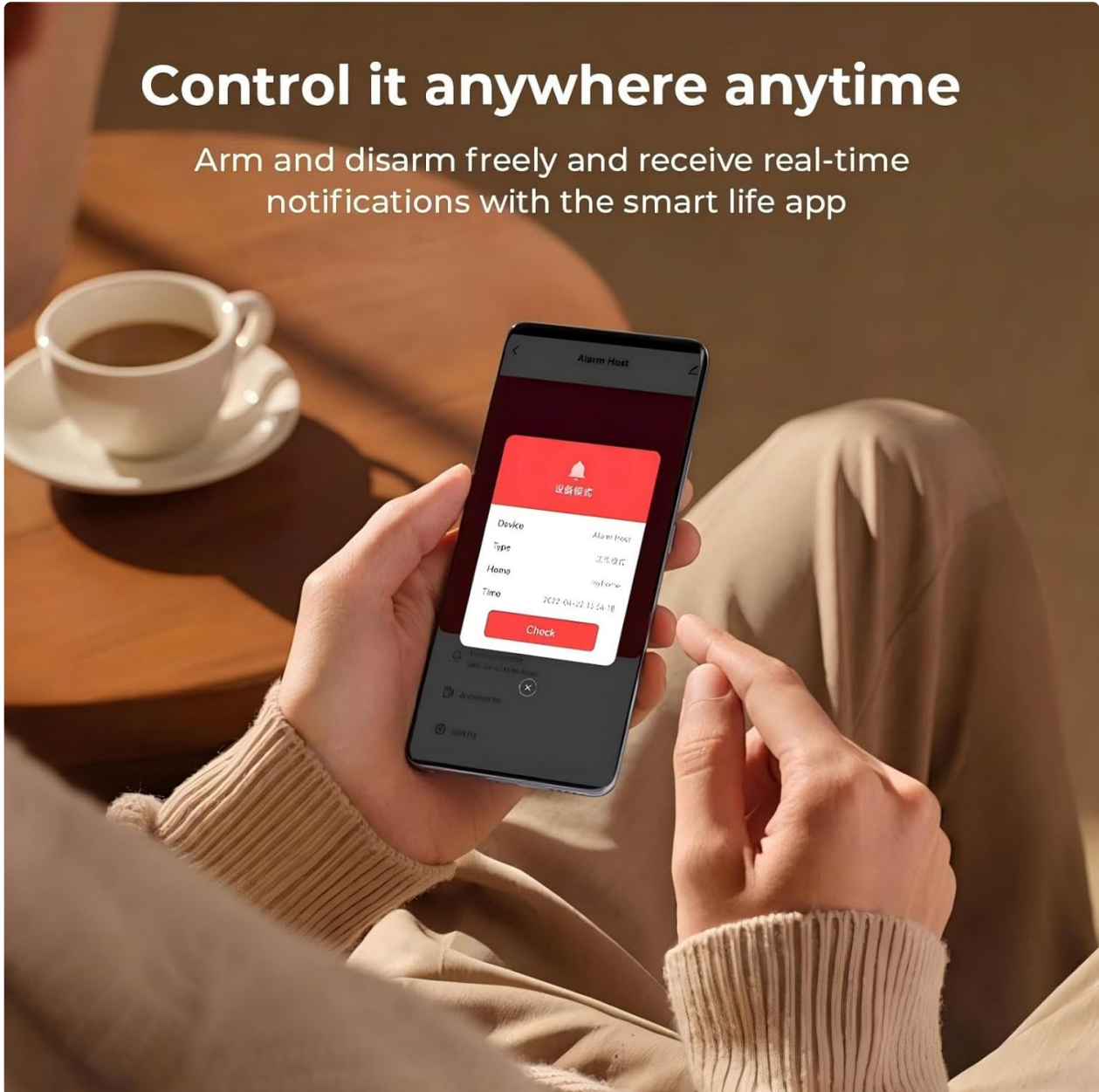

Image: All included components of the security system.

3. SETUP AND INSTALLATION

The Hapippofa Home Security System is designed for easy DIY installation without professional assistance. Each accessory includes necessary mounting hardware (screws or adhesive tape).

3.1. Alarm Host Placement

Place the alarm host in a central location within your home, ensuring it has a stable Wi-Fi connection and is easily accessible for operation.

3.2. Door/Window Sensor Installation

Install door sensors on doors and windows. Ensure the two parts of the sensor are aligned and within 1 cm of each other when the door/window is closed. Use the provided adhesive tape or screws for secure mounting.

Let Every Corner of Your House Protected

You Can Install This Alarm System to Every Corner of Your Home by Need, and Give the House 360° Protection.



Image: Door sensor installation and real-time status display in the mobile application.

3.3. Motion Detector Installation

Mount infrared motion detectors in areas where intruders are likely to pass, such as hallways or living rooms. Position them to cover the desired detection area without obstructions. Avoid placing them near heat sources or direct sunlight.

3.4. Siren Placement

Install the emergency siren in a location where its sound can be heard clearly throughout the property, both indoors and outdoors if applicable.

3.5. App Installation and Pairing

Download the Smart Life (Tuya) app from your smartphone's app store. Follow the in-app instructions to pair the alarm host with your Wi-Fi network and your account. Once the host is paired, you can add and configure all other sensors and devices within the app.

An alarm host can be paired with one app account and then shared with multiple family members for common management.

4. OPERATING INSTRUCTIONS

4.1. Arming and Disarming the System

The system can be armed or disarmed using the remote controls, RFID cards, the alarm host keypad, or through the Smart Life app.

- **Arm:** Activates all sensors. Any triggered sensor will initiate an alarm.
- **Disarm:** Deactivates the alarm system, allowing free movement within the protected area.

- **Home Arm (Stay Arm):** Activates perimeter sensors (e.g., door/window sensors) while allowing movement within the home (motion detectors are typically bypassed).

4.2. App Control and Alerts

The Smart Life app allows you to control your security system remotely, receive real-time notifications, and manage settings.

- Receive push notifications directly to your smartphone when motion is detected or sensors are triggered.
- View the real-time status of door sensors (open/closed) within the app.
- Edit the names of individual door/motion sensors for easier identification and management of different rooms.

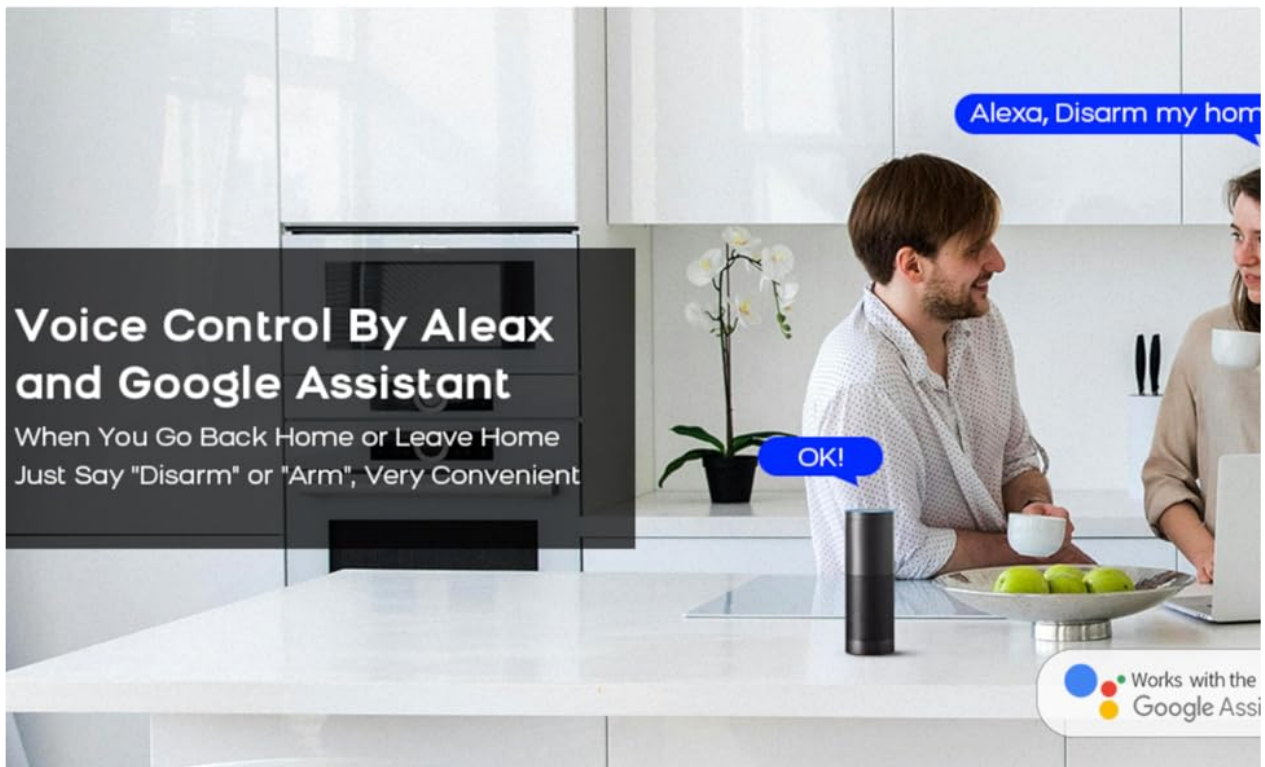
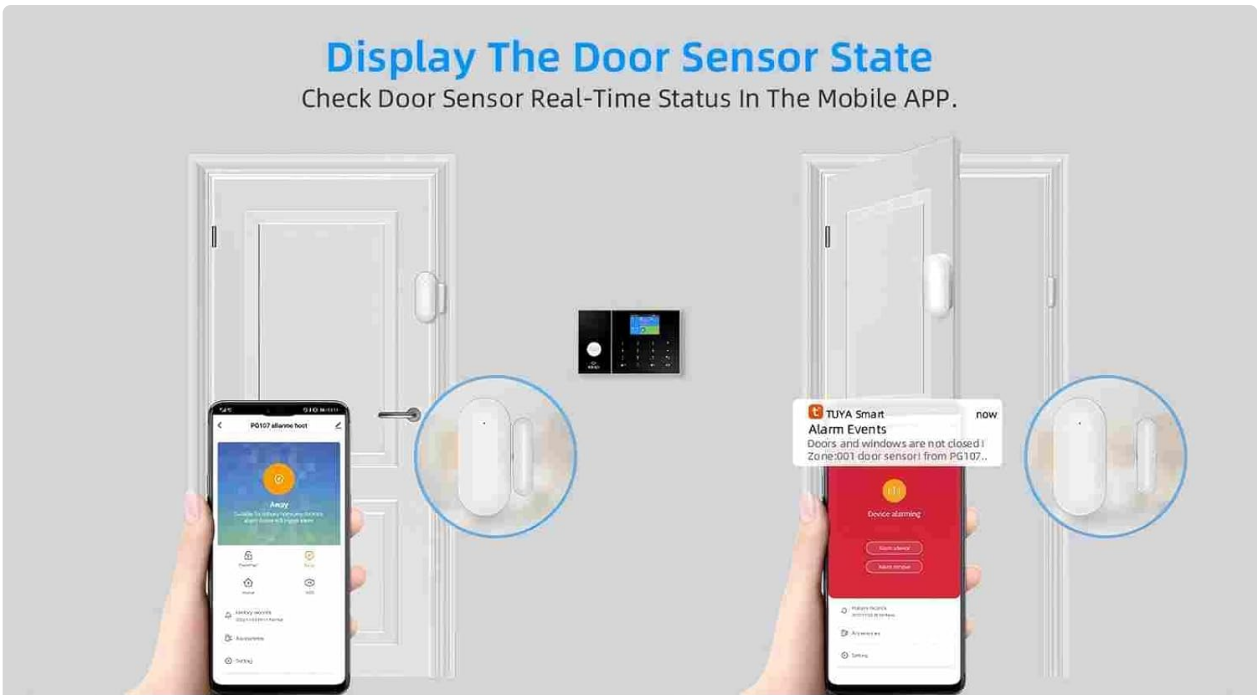

Image: Real-time alarm notifications received on a smartphone via the Smart Life app.

Display The Door Sensor State

Check Door Sensor Real-Time Status In The Mobile APP.



Edit Name Of The Door/Motion Sensor

Easy Edit The Name Of Each Door/Motion Sensor To Facilitate Our Management Of Each Room.

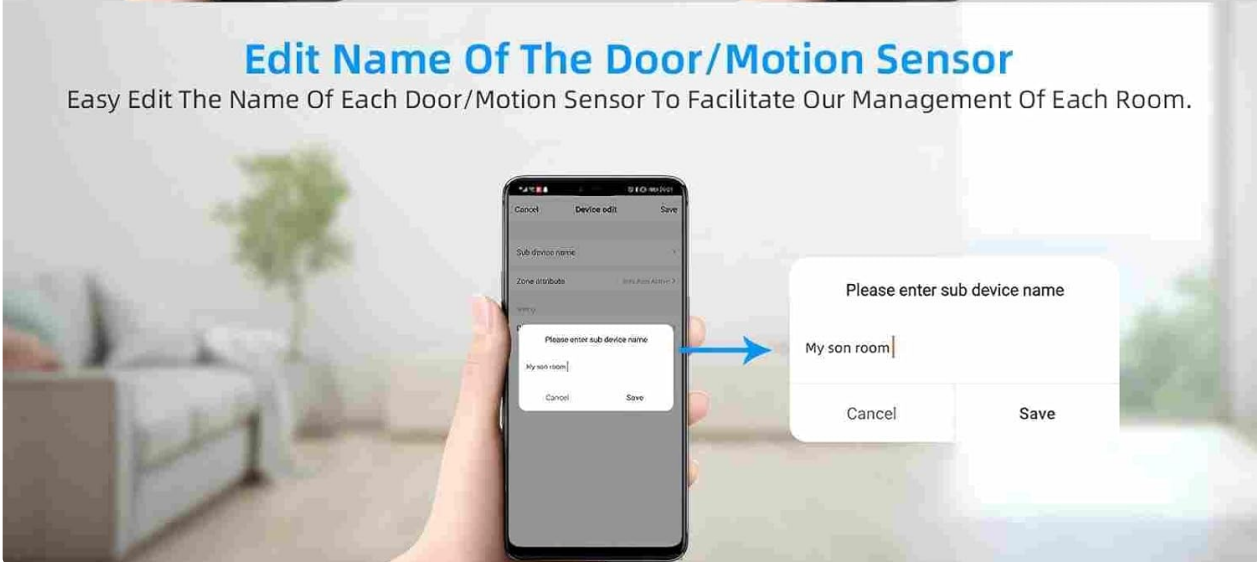

Image: App interface for checking door sensor status and editing sensor names.

4.3. Voice Control (Alexa and Google Assistant)

The system is compatible with Alexa and Google Assistant. You can arm or disarm your system using voice commands. For example, "Alexa, disarm my home" or "OK Google, arm the security system."

4.4. Scheduling Arm/Disarm Times

You can set up automatic arming and disarming schedules through the app to align with your daily routine, saving time and effort.

- Example: Automatically disarm at 07:00 when waking up, arm at 08:00 when leaving home, disarm at 18:00 upon returning, and arm at 22:00 for sleeping.

APP Alert Message Push

When Someone Try to Entry House, the Door Sensor and PIR Detector is Activated, You Will get Phone Message and Call, In Addition, APP Will Push Alert



Image: Examples of scheduled arming and disarming based on daily activities.

5. MAINTENANCE

5.1. Battery Replacement for Sensors

The wireless sensors (door sensors, motion detectors) are battery-powered. The system will notify you via the app when a sensor's battery is low. Replace batteries promptly to ensure continuous protection.

- **Door Sensors:** Typically use CR2032 coin cell batteries.
- **Motion Detectors:** Typically use AA or AAA batteries.

Refer to the specific sensor's compartment for battery type and replacement instructions. Ensure correct polarity when inserting new batteries.

MONITORING SCHEDULE

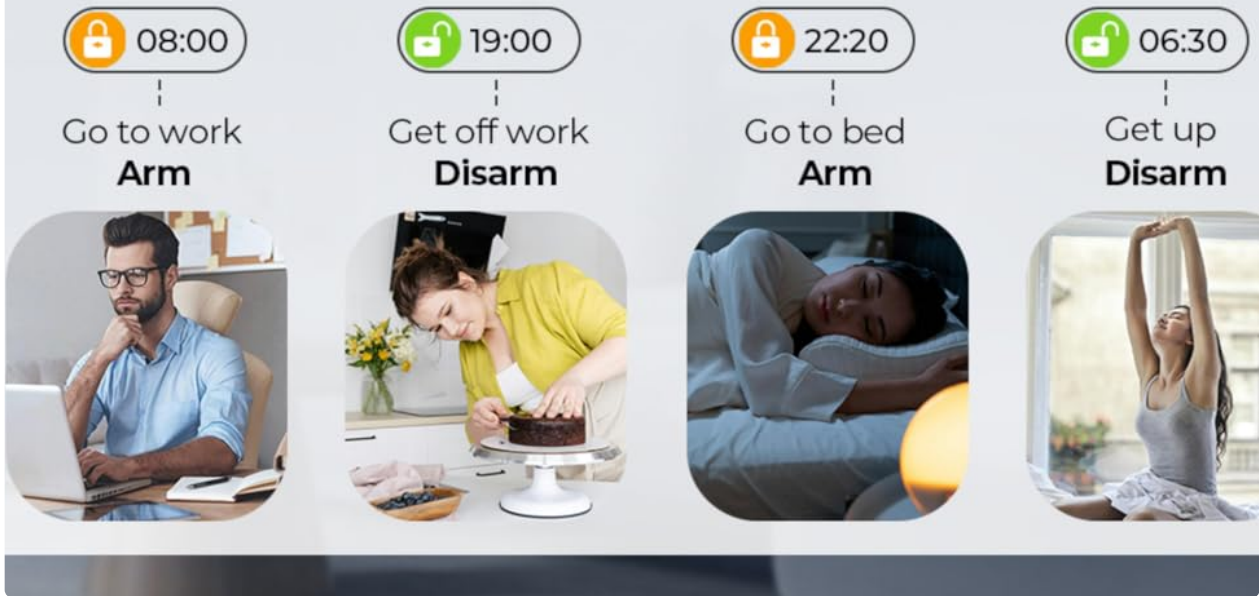

Image: Notification for low battery on wireless sensors.

6. TROUBLESHOOTING

If you encounter issues with your Hapippofa Home Security System, refer to the following common problems and solutions:

- **System not connecting to Wi-Fi:** Ensure your Wi-Fi network is 2.4GHz, the password is correct, and the alarm host is within range of your router. Restart both the router and the alarm host.
- **Sensors not triggering alarm:** Check sensor battery levels in the app. Ensure sensors are properly installed and aligned (for door/window sensors). Verify that the system is armed.
- **App notifications not received:** Check your smartphone's notification settings for the Smart Life app. Ensure the app has necessary permissions and your phone has an active internet connection.
- **False alarms:** Adjust motion detector sensitivity if available. Ensure motion detectors are not placed near vents, windows, or areas with pets that might trigger them.
- **Remote control not working:** Replace the remote control battery. Ensure you are within range of the alarm host.

For further assistance, please contact customer support.

7. SPECIFICATIONS

Feature	Detail
Brand	Hapippofa
Model Number	A105F-US
Power Source	Battery Powered (Alarm Host includes 1 Lithium Polymer battery)
Compatible Devices	Smartphone, WiFi Networks, Alexa, Google Assistant

Connectivity Technology	Wireless
Installation Type	DIY
Alert Type	Audio and Visual (Siren), App Notifications, Phone Calls
Item Weight	Approximately 1.69 pounds (total system)
Control Method	App, Remote Control, Keypad, RFID Card, Voice Control
Maximum Range	100 Feet (wireless sensor range)
Battery Life (Sensors)	Up to 3 years (depending on usage)
Noise Level (Siren)	85 Decibels
Sensor Technology	Door/Window Contact, Motion Detection (PIR), RFID

8. WARRANTY AND SUPPORT

Hapippofa is committed to providing quality products and customer satisfaction. While specific warranty details are not provided in this manual, please retain your proof of purchase for any warranty claims.

For technical support, troubleshooting assistance, or any questions regarding your Hapippofa Home Security System, please contact our customer service team. We are dedicated to providing satisfactory solutions. Contact information can typically be found on the product packaging or the official Hapippofa website.