



[Manuals.plus](#) /

> [MekedeTech](#) /

> MekedeTech DUDUAUTO DUDU7 Car Stereo Head Unit Instruction Manual

MekedeTech DUDU7

MekedeTech DUDUAUTO DUDU7 Car Stereo Head Unit

Instruction Manual

1. INTRODUCTION

This manual provides essential information for the installation, operation, and maintenance of your MekedeTech DUDUAUTO DUDU7 Android Touch Screen Car Stereo Head Unit. Please read this manual thoroughly before using the product to ensure proper function and to prevent damage.

The DUDUAUTO DUDU7 is an advanced 14.6-inch single DIN car stereo featuring Android 13, a powerful 8-core UIS7870 processor, 12GB RAM, and 256GB ROM. It supports wireless CarPlay and Android Auto, dual-band GPS, and includes a built-in 360-degree camera chip for enhanced vehicle awareness.

2. PACKAGE CONTENTS

Verify that all items listed below are included in your package. If any items are missing or damaged, please contact your vendor.

Package Contents



Head unit * 1



Power Cable



Metal Brackets * 2



Disassembly Tools



9 /10inch Frame

DUDU6 DUDU7



MIC



RCA Cable



Reversing camera



USB Plug * 3



Fakra
4G Antenna



Fakra
GPS Antenna
(For DUDU7 only)



Fakra
GPS Antenna
(For DUDU6 only)

DUDU4 DUDU5



MIC



RCA Cable



Reversing camera



USB Plug * 3
(For DUDU5 only)



USB Plug * 2
(For DUDU4 only)



4G Antenna



GPS Antenna

DUDU3



MIC



RCA Cable



Reversing camera



USB Plug * 2



4G Antenna



GPS Antenna

Figure 2.1: Package Contents for DUDUAUTO DUDU7

- Head Unit (1)
- Power Cable (1)
- Metal Brackets (2)
- Disassembly Tools (Set)
- 9/10 inch Frame (1)
- Microphone (1)
- RCA Cable (1)
- Reversing Camera Cable (1)
- USB Plug (3) (USB 3.2 GEN1*1 (TYPE-C), USB 2.0*3)
- Fakra 4G Antenna (1)
- Fakra GPS Antenna (1)

3. SETUP AND INSTALLATION

Installation of the DUDUAUTO DUDU7 head unit requires technical knowledge and should ideally be performed by a qualified professional. Incorrect installation can lead to damage to the unit or your vehicle's electrical system.

3.1 Pre-Installation Checks

- Ensure the vehicle's ignition is off and the battery is disconnected before starting installation.
- Confirm compatibility with your vehicle's dashboard and wiring harness. Vehicle-specific plate trim covers and CANBUS boxes may be required and are sold separately.
- Review the wiring diagram provided with the unit for correct connections.

3.2 Basic Installation Steps

1. **Remove Existing Head Unit:** Carefully remove your vehicle's existing stereo system using the provided disassembly tools.
2. **Connect Wiring:** Connect the power cable, RCA cables, USB cables, GPS antenna, 4G antenna, and reversing camera cable to the DUDUAUTO DUDU7 unit. Ensure all connections are secure.
3. **Mount the Unit:** Use the metal brackets and the 9/10 inch frame to secure the head unit into the dashboard opening.
4. **Reconnect Battery:** Once all connections are made and the unit is securely mounted, reconnect the vehicle's battery.
5. **Initial Power On:** Turn on the vehicle's ignition and power on the head unit. Follow any on-screen prompts for initial setup.

3.3 Antenna Placement

- **GPS Antenna:** For optimal signal reception, place the GPS antenna on the dashboard or under the windshield with a clear view of the sky. Avoid placing it near metal obstructions.
- **4G Antenna:** Position the 4G antenna in an area with good cellular signal, typically away from other electronic devices that might cause interference.

4. OPERATING INSTRUCTIONS

The DUDUAUTO DUDU7 operates on Android 13 with a custom DUDU OS interface, offering intuitive control and extensive features.

4.1 System Overview (DUDU OS)



We've evolved from feature-heavy complexity to focus on intuitive, streamlined operation while maintaining powerful functionality.

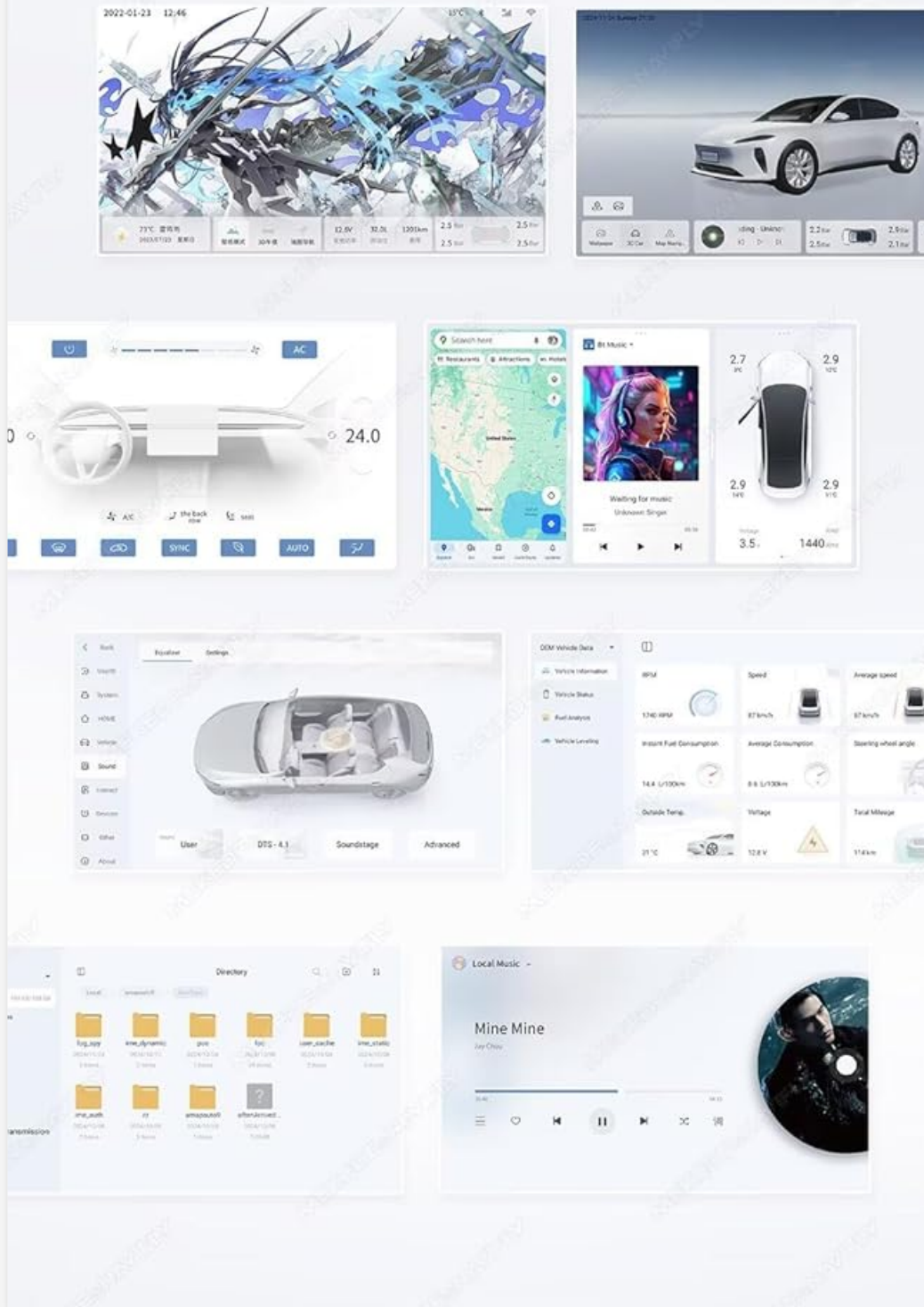
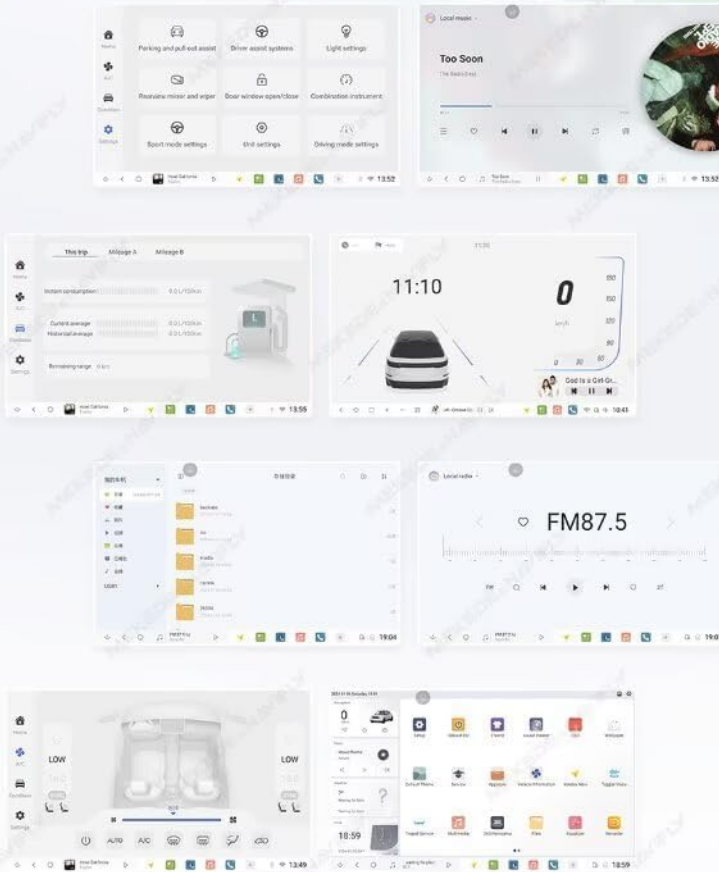

Figure 4.1: DUDU OS 3.5 Interface

DUDU OS 3.0

New custom dynamic wallpaper



Daytime

light mode

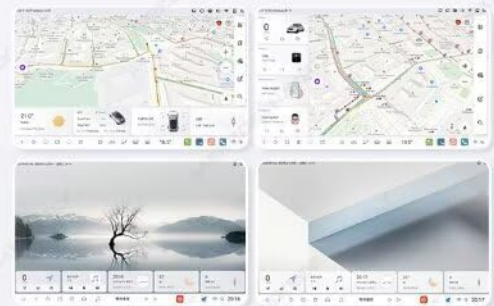

dark mode

Night



Figure 4.2: DUDU OS 3.0 Interface with Custom Dynamic Wallpaper

- **Touchscreen Interface:** Navigate through menus and applications using the 14.6-inch high-resolution touchscreen.
- **Home Screen:** Customize your home screen with widgets and shortcuts for frequently used functions.
- **Settings:** Access system settings for display, sound, network, and vehicle integration.
- **Voice Control:** Utilize voice commands for hands-free operation of various functions.

4.2 Wireless CarPlay and Android Auto

The DUDUAUTO DUDU7 supports both wireless CarPlay for iPhone users and wireless Android Auto for Android device users.

1. **Enable Bluetooth/Wi-Fi:** Ensure Bluetooth and Wi-Fi are enabled on your smartphone.
2. **Pair Device:** On the head unit, navigate to the CarPlay/Android Auto application. Follow the on-screen instructions to pair your smartphone via Bluetooth.
3. **Automatic Connection:** Once paired, your device should automatically connect to CarPlay or Android Auto when the head unit is powered on.

4.3 Bluetooth 5.0 Connectivity

The unit features a Qualcomm 3031 Bluetooth 5.0 chip for stable and high-quality audio streaming and hands-free calling.

- **Pairing:** Go to the Bluetooth settings on the head unit, enable Bluetooth, and search for available devices. Select your smartphone from the list and confirm the pairing code.
- **Hands-Free Calling:** Make and receive calls directly from the head unit. The digital noise-canceling microphone ensures clear communication.
- **Audio Streaming:** Stream music and other audio from your paired device to the car stereo.

4.4 GPS Navigation

Equipped with a dual-band 6-mode GPS chip (L1+L5), the DUDUAUTO DUDU7 provides precise and fast navigation.

- **Navigation Apps:** Use pre-installed navigation applications or download your preferred apps from the Google Play Store.
- **Accuracy:** The dual-frequency technology offers lane-level navigation precision within 1 meter.

4.5 Audio Features

Experience enhanced audio quality with the integrated DSP and amplifier.

Choosing reputation audio chip

in an industry-wide

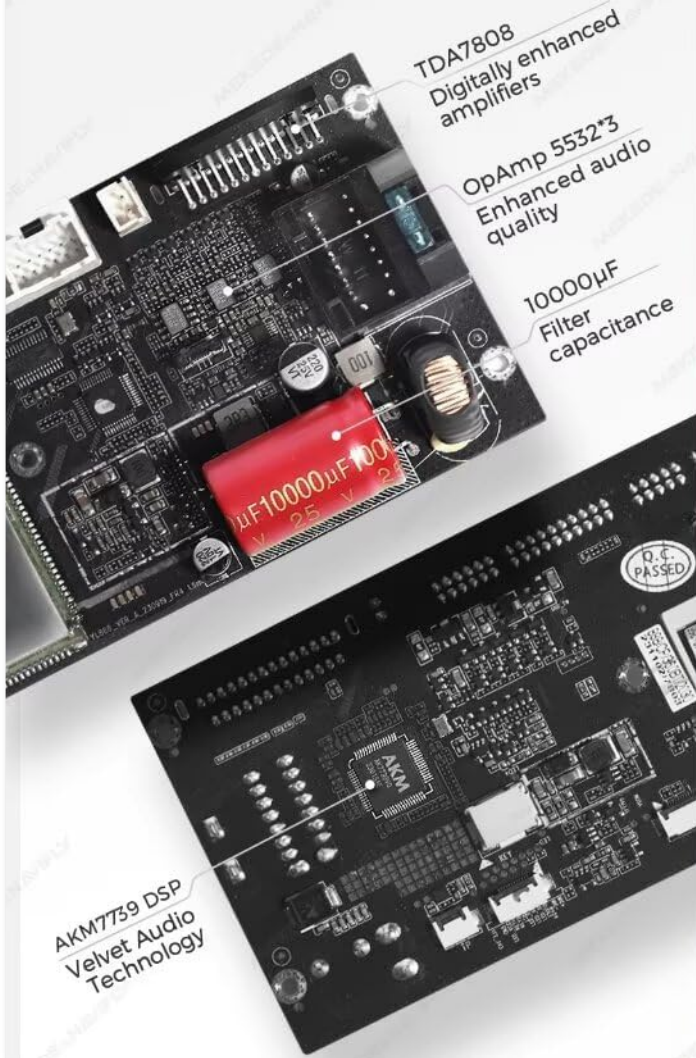

AKM7739 DSP Velvet Audio Technology

Support "VELVET SOUND" +DTS5.1 panoramic sound+ sound correction system, reproduces a natural, comfortable, sense of presence acoustic experience.



VELVET SOUND



VELVET SOUND - AKM advanced audio processing technology, based on the original sound reproduction product concept, explores the limits of audio technology, and presents all sound details without reservation, creating a "like, immersive" sound world.

Figure 4.3: AKM7739 DSP Velvet Audio Technology

- **DSP (Digital Sound Processor):** The AKM7739 Velvet Audio Technology DSP allows for fine-tuning of audio settings, including equalization, sound staging, and surround sound effects.
- **Power Amplifier:** The TDA7808 Digital AB type power amplifier delivers clear and powerful audio output.
- **Audio Outputs:** The unit provides Optical, Coaxial, and RCA 5.1 Channel Outputs for flexible audio system integration.

4.6 360 Camera Support

The DUDUAUTO DUDU7 includes a built-in 360 panoramic chip, supporting 360-degree camera systems for comprehensive vehicle surroundings view.

- **Camera Connection:** Connect compatible 360-degree cameras to the designated inputs.
- **Display:** View the 360-degree camera feed on the 14.6-inch display, assisting with parking and maneuvering.

4.7 USB Connectivity

The unit features multiple USB ports for connecting external devices.

- **USB 3.2 GEN1 (Type-C):** One high-speed Type-C port for fast data transfer.
- **USB 2.0:** Three standard USB 2.0 ports for connecting USB drives, charging devices, or other peripherals.

5. MAINTENANCE

Proper maintenance ensures the longevity and optimal performance of your DUDUAUTO DUDU7 head unit.

- **Screen Cleaning:** Use a soft, lint-free cloth specifically designed for electronics to clean the touchscreen. Do not use abrasive cleaners or solvents.
- **Software Updates:** Periodically check for and install software updates to ensure the system runs efficiently and has the latest features and security patches.
- **Avoid Extreme Temperatures:** Do not expose the unit to extreme temperatures, direct sunlight for prolonged periods, or high humidity.
- **Ventilation:** Ensure the unit's ventilation openings are not blocked to prevent overheating.

6. TROUBLESHOOTING

If you encounter issues with your DUDUAUTO DUDU7, refer to the following common problems and solutions.

Problem	Possible Cause	Solution
Unit does not power on	Loose power connection, blown fuse, vehicle battery issue	Check power cable connections. Inspect vehicle fuses. Ensure vehicle battery is charged.
No sound output	Volume too low, incorrect audio source, speaker wiring issue	Increase volume. Select correct audio source. Check speaker connections.
GPS signal lost or inaccurate	GPS antenna obstruction, poor antenna placement	Ensure GPS antenna has a clear view of the sky. Reposition antenna if necessary.
Bluetooth device won't pair	Bluetooth not enabled, device out of range, interference	Ensure Bluetooth is enabled on both devices. Bring devices closer. Restart both devices.
CarPlay/Android Auto not connecting	Incorrect settings, Wi-Fi/Bluetooth issues, phone compatibility	Verify CarPlay/Android Auto settings on both unit and phone. Ensure Wi-Fi and Bluetooth are active. Check phone compatibility.
Touchscreen unresponsive	System freeze, software glitch	Restart the unit (refer to manual for reset procedure if available). If issue persists, contact support.

If the problem persists after attempting these solutions, please contact MekedeTech customer support.

7. SPECIFICATIONS

The following table details the technical specifications of the MekedeTech DUDUAUTO DUDU7 head unit.

--	--

	DUDU4	DUDU5	DUDU6	DUDU7
RAM/ROM	4+32GB	4+64GB	6+64GB 8+128GB 8+256GB	6+64GB 12+256GB 8+128GB 12+512GB
CPU	8-Core UIS8581A	8-Core UIS7862	8-Core UIS7862S Customized verison A55 2.0Ghz 12nm process	8-Core UIS7870 Customized verison A76 2.7Ghz 6nm process
Memory type	emmc 5.1			UFS 3.1 Read data 1700M+
GPS	3 mode L1 B1 E1			Dual Band 6 mode L1 L5 B1 B2a E1 E5a
MIC	Condenser MIC			Digital noise cancelling MIC
USB interface	USB 2.0*3			Type-C USB 3.2 Gen1*1 USB 2.0*3
Power amplifier	TDA7838	TDA7851	TDA7850	TDA7808 Digital enhanced Class AB power amplifier
DSP	AK7604	AK7604	AKM7738	AKM7739 Velvet audio technology
Amp	/	/	2582*3	5532*3 Enhanced audio signal
Android version	Android 10 API=29			Android 13 API=33
car machine system	DUDU OS			
Audio output	RCA2.1 channel output	Fiber + coaxial RCA2.1 channel output	Fiber + coaxial RCA5.1 channel output	
BT chip	BT5.0		BT5.0 Qualcomm 3031 supports the aptx HD protocol	
Filter capacitance	6800µF		10000µF	
Screen	In-cell Screen		9.5" / 10.36" / 11.5" :2K 2000*1200 13" : 1920*1200	
CP/AA	Support wired + wireless Car-play / Android AUTO			
Network	4G Lte external card slot + WIFI			
Radio	TDA4755		TDA7708	
Voice Control	DUDU4 / 5 requires the purchase of voice control software to be supported.		Support voice control function	

Supporting accessories (optional)

DVR, front + rear view camera, TPMS, BT SWC, etc.

Note: Accessories are not included and are purchased separately. For more customization needs, please contact mekede&navifly.

Figure 7.1: DUDU Series Model Comparison (DUDU7 highlighted)

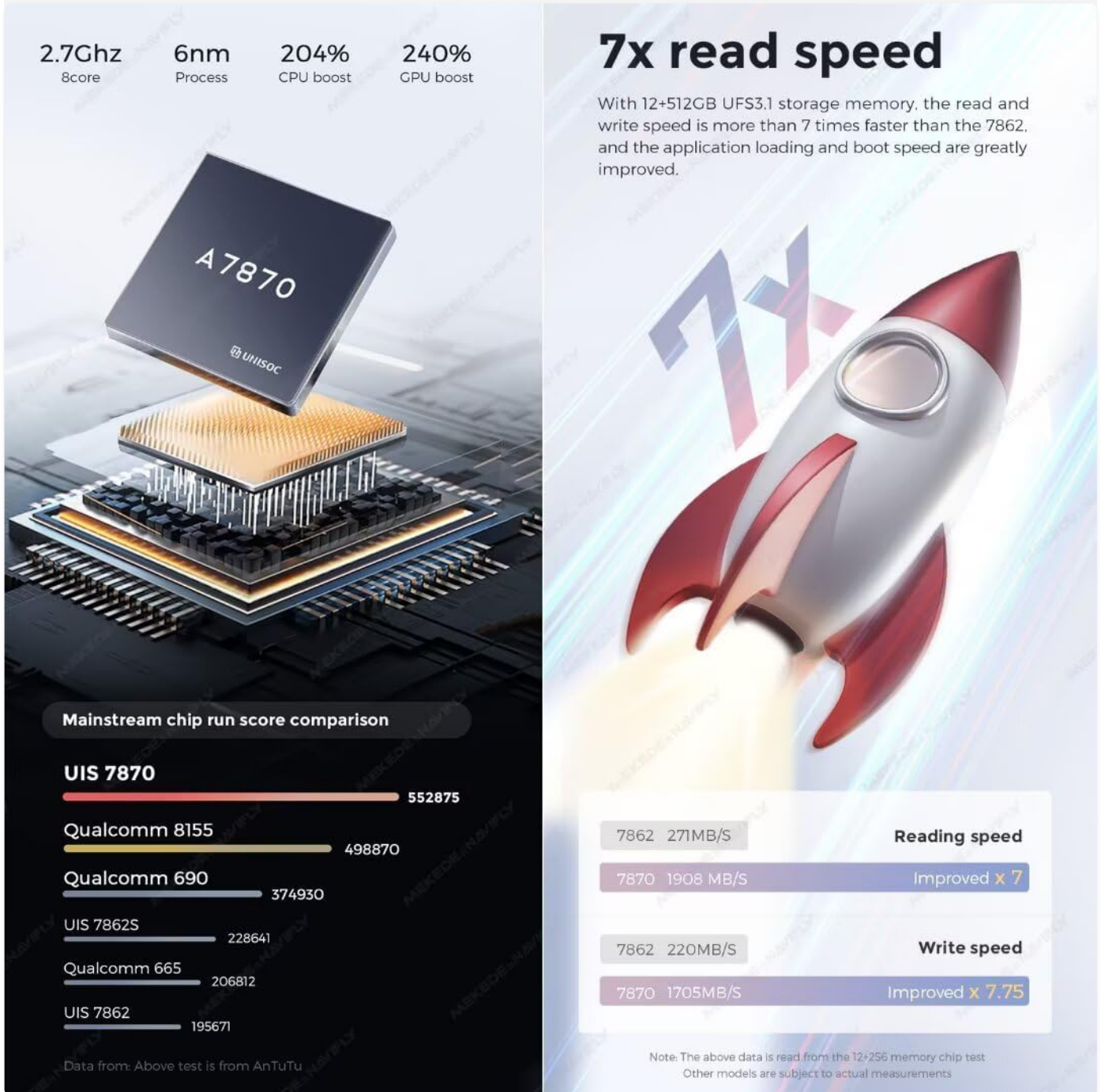

Figure 7.2: UIS7870 CPU Performance and UFS 3.1 Read Speed

Feature	Specification
Model Number	DUDU7
Operating System	Android 13
CPU	8 Core UIS7870 (A76 2.7Ghz, 6nm processor)

Feature	Specification
RAM	12GB
ROM	256GB (UFS 3.1, Read data 1700M+)
Display Size	14.6 inch
Display Resolution	1920x1200
GPS	Dual Band 6 mode (L1 L5 B1 B2a E1 E5a)
Microphone	Digital Noise Cancellation Microphone
USB Ports	USB 3.2 GEN1*1 (Type-C), USB 2.0*3
Power Amplifier	TDA7808 Digital AB type
DSP	AKM7739 Velvet Audio Technology
Bluetooth Chip	Qualcomm 3031 (Supports aptx HD protocol, BT5.0)
Audio Output	Optical + Coaxial, RCA 5.1 Channel Outputs
WiFi Type	802.11a/b/g/n/ac (Support 5G WIFI)
Radio IC	TDA7708
Work Voltage	9V~16V
CarPlay/Android Auto	Wired and Wireless Support
360 Panorama	Built-in 360 panoramic chip
Connectivity Technology	Wireless (4G)
Control Method	Touch, Buttons, Keyboard, Microphone
Manufacturer	Shenzhen Mekede Technology Co.,Ltd

8. WARRANTY INFORMATION

The MekedeTech DUDUAUTO DUDU7 head unit comes with a **1-Year Warranty** from the date of purchase. This warranty covers manufacturing defects and malfunctions under normal use.

The warranty does not cover damage caused by:

- Improper installation or wiring.
- Accidental damage, misuse, abuse, or neglect.
- Unauthorized repairs or modifications.
- Operating the unit outside of its specified environmental conditions.

Please retain your proof of purchase for warranty claims.

9. CUSTOMER SUPPORT

For technical assistance, troubleshooting beyond this manual, or warranty inquiries, please contact MekedeTech

customer support.

- **Manufacturer:** Shenzhen Mekede Technology Co.,Ltd
- **Seller:** Mecedetech
- **Online Support:** Refer to the official MekedeTech website or your purchase platform for contact details and support resources.