

## COSLUS C51

# COSLUS Portable Water Flosser C51 Instruction Manual

Model: C51 | Brand: COSLUS

## 1. INTRODUCTION

The COSLUS Portable Water Flosser C51 is designed to enhance your daily oral hygiene routine. This compact and lightweight device offers advanced cleaning capabilities with its versatile modes and pressure settings, making it suitable for various dental needs, including orthodontic care and sensitive gums. Its portable design with built-in nozzle storage ensures convenience for both home use and travel.



Image: The COSLUS Portable Water Flosser C51 showcasing its compact design and built-in nozzle storage, making it ideal for travel.

Video: An overview of the COSLUS Portable Water Flosser C51, demonstrating its design and key features.

## 2. WHAT'S IN THE BOX

Your COSLUS Portable Water Flosser C51 package includes the following items:

- COSLUS Portable Water Flosser Unit
- Standard Jet Tips (2 included)
- Orthodontic Tip (1 included)
- Tongue Scraper Tip (1 included)
- USB Charging Cable
- User Manual

## Upgraded Portability: Built-In Jets Storage

30%  
lighter than others

Convenient  
Storage  
for 2 Nozzles



Image: The COSLUS Portable Water Flosser C51 unit displayed with its various interchangeable nozzles and USB charging cable.

### 3. SETUP

Follow these steps to prepare your water flosser for first use:

1. **Charge the Device:** Before initial use, fully charge the water flosser using the provided USB cable. Ensure the device is dry before charging.
2. **Install Nozzle:** Select your desired nozzle tip. Insert the tip into the hole on the top of the flosser unit until it clicks securely into place. Ensure there is no gap between the nozzle and the unit.

3. **Fill Water Tank:** Detach the 300ML water tank from the main unit. Open the wide-mouth cap and fill the tank with lukewarm water (below 40°C). Reattach the tank securely to the main unit.

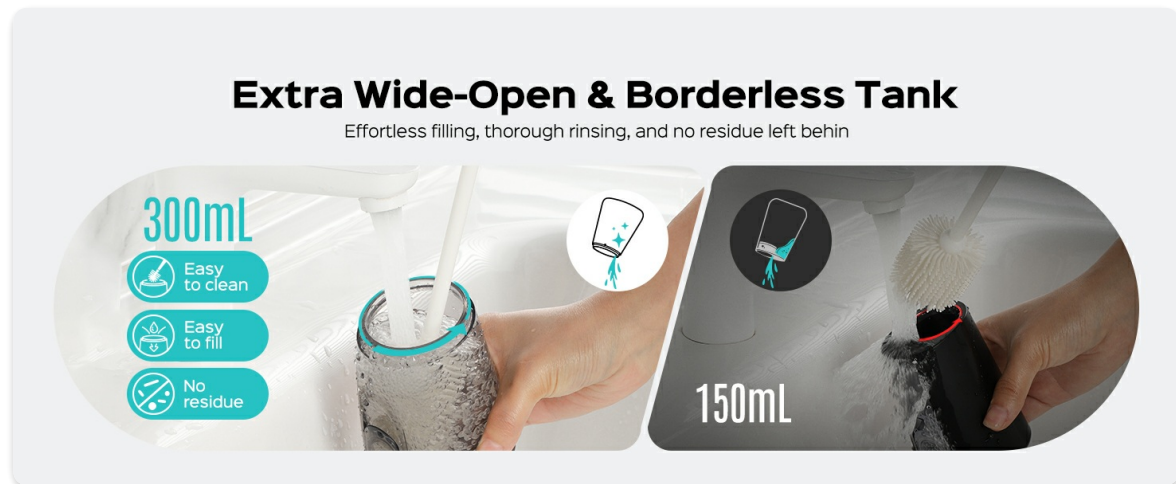

Image: Visual guide illustrating the steps for inserting the nozzle, adding water, selecting a mode, adjusting pressure, and proper flossing angle.

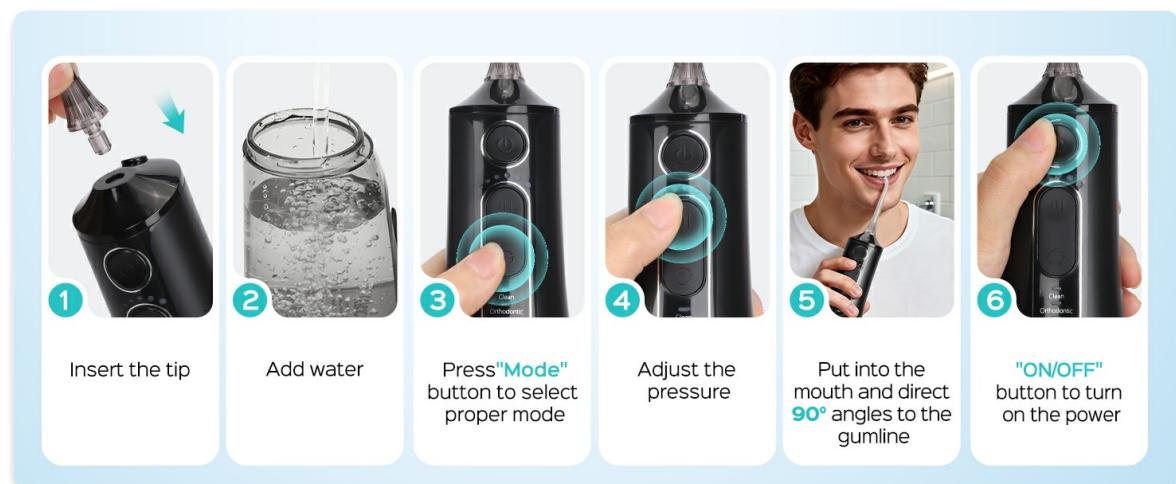

Image: The travel-friendly design of the COSLUS C51, highlighting its built-in nozzle storage for convenience and hygiene.

## 4. OPERATING INSTRUCTIONS

To begin your oral care routine, follow these operating steps:

1. **Power On/Off:** Press the ON/OFF button to turn the device on. Press it again to turn it off.
2. **Select Mode:** Press the 'Mode' button to cycle through the available cleaning modes: Clean, Orthodontic, and Jet. The indicator lights will show the selected mode.
3. **Adjust Pressure:** Use the pressure adjustment button (usually indicated by up/down arrows or intensity levels) to select one of the 6 pressure settings. Start with a lower setting for sensitive gums or first-time use and gradually increase as comfortable.
4. **Proper Technique:** Lean over a sink and place the nozzle tip into your mouth, directing the water stream at a 90-degree angle to your gumline. Keep your mouth slightly open to allow water to flow into the sink.

5. **Flossing:** Guide the water stream along your gumline and between your teeth, pausing briefly between each tooth. For the Jet mode, press the power button to clean and release to stop, allowing for precise control and minimal splashing.



**Reliable, Safe,  
and Effective**

"For optimal oral health, I recommend this water flosser. Its upgrade 18 personalized settings provide a personalized, gentle clean essential for gum health."

Image: A detailed view of the COSLUS Water Flosser C51's control panel, showing the ON/OFF, Mode selection, and pressure indicator lights.

## 5. MODES AND PRESSURE SETTINGS

The COSLUS C51 offers 3 distinct cleaning modes and 6 pressure settings to cater to diverse oral care needs:

- **Clean Mode:** Effectively removes debris between teeth and along the gums. Ideal for daily cleaning.
- **Orthodontic Mode:** Gentle yet thorough cleaning around braces, bridges, and other dental work.
- **Jet Mode:** Provides precise control for instant cleaning. Press the power button to activate the jet and release to pause, minimizing splashing.

The 6 pressure settings (gears) allow for personalized intensity, from gentle (Level 1-2, suitable for



children and sensitive gums) to powerful (Level 5-6, for experienced users and deep cleaning). This 3x6 design offers 18 custom combinations for your family's oral health.

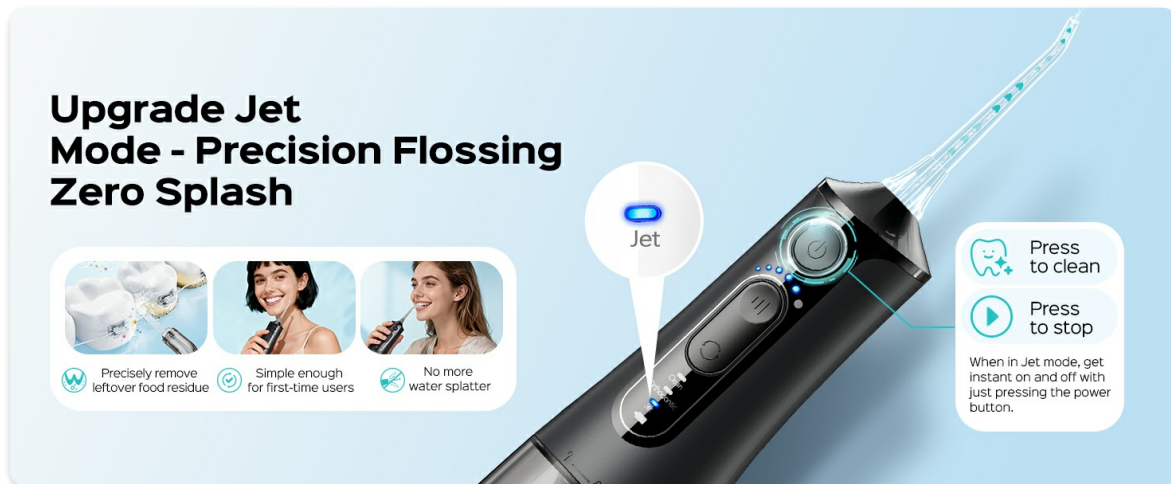

Image: An illustration detailing the three cleaning modes (Clean, Orthodontic, Jet) and six pressure settings, indicating suitability for various age groups and needs.

### Exclusive Top Quality

After three years of dedicated development, we present the Portable Water Flosser Pro—engineered to deliver a personalized and effective clean for a consistently healthier smile. We are confident its tailored design will elevate your daily routine, offering unmatched cleanliness and comfort for improved oral health.

- **Tailored Cleaning with 18 Adjustments:** Choose from 3 cleaning modes and 6 pressure levels to customize your rinse for a gentle or deep clean—ideal for sensitive gums, braces, or everyday freshness.
- **Organized & Portable Nozzle Storage:** The portable compartment can hold two nozzles to ensure cleanliness - whether at home or on the go, it can be kept clean, dry, and ready for use.
- **Effortless-Fill Large Water Tank:** The wide-top, detachable 300mL tank fills quickly, cleans easily for a complete rinse without refills.

Image: A visual comparison highlighting the precision and reduced splashing of the upgraded Jet Mode compared to other water flossers.

Video: A short preview demonstrating the different modes and pressure settings of the COSLUS Portable Water Flosser C51.

## 6. NOZZLE TYPES AND USAGE

The COSLUS C51 comes with a variety of nozzles to address specific oral care needs:

- **Standard Jet Tip:** For daily deep cleaning between teeth and below the gumline.
- **Orthodontic Tip:** Designed for effective cleaning around braces, bridges, and crowns.
- **Tongue Scraper Tip:** Helps remove bacteria and food debris from the tongue for fresher breath.

All nozzles feature a 360° rotatable tip, allowing you to easily reach all areas of your mouth for a comprehensive clean.

# IPX7 Waterproof Safe for Shower Use

Allows you to enjoy oral care  
anytime in the shower



Water  
Washable

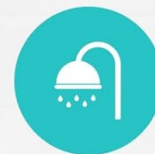

Shower  
Available



Image: The family nozzle set, including a Standard Jet Tip for daily cleaning, an Orthodontic Tip for braces, and a Tongue Scraper for fresh breath.

## Built-In Nozzle Storage - No More Lost or Messy Tips

Keep your tips tidy, dry, and ready to use



ours  
Keep dry & clean  
Organized storage

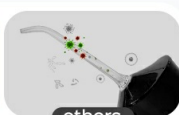

others  
Stays damp & unclean  
Difficult to store



Image: A visual representation of the water flosser effectively removing dental plaque from teeth and around orthodontic appliances.



## 7. MAINTENANCE AND CLEANING

Proper maintenance ensures the longevity and hygiene of your COSLUS Water Flosser:

- **Cleaning the Water Tank:** The 300ML water tank features an extra-wide, borderless opening for easy filling and thorough cleaning. After each use, detach the tank and rinse it thoroughly with water. Its smooth, seamless interior prevents residue buildup.
- **Nozzle Storage:** The device includes built-in nozzle storage, keeping two nozzles securely inside the compact body. This design ensures nozzles remain organized, dry, and ready for use without requiring extra cases.
- **General Cleaning:** Wipe the main unit with a soft, damp cloth as needed. Do not submerge the main unit in water for extended periods.

### Precisely Clean for Healthier Gums and Teeth

Gentle yet powerful cleaning for every smile



Tooth Gaps



Tongue



Braces



Back Molar





After Before

Image: A comparison demonstrating the ease of filling and cleaning the COSLUS C51's extra wide-open water tank versus a traditional narrow tank.

### Designed to Attack Dental Plaque



0.6mm  
Water column



1400-1800  
Pulsations per minute



30-140PSI  
Adjustable pressure





Shop now

Image: The built-in nozzle storage feature of the COSLUS C51, ensuring tips are kept tidy, dry, and readily accessible.

## 8. TROUBLESHOOTING

If you encounter any issues with your COSLUS Portable Water Flosser C51, please refer to the following general troubleshooting tips:

- **No Water Flow:** Ensure the water tank is properly filled and securely attached. Check if the nozzle tip is correctly installed and not clogged.
- **Device Not Turning On:** Verify that the device is fully charged. If the battery is low, connect it to the USB charging cable.
- **Weak Water Pressure:** Check the selected pressure setting and increase it if necessary. Ensure the water tank is not empty.
- **Leaking:** Confirm that the water tank is correctly attached and the nozzle tip is firmly in place.

For persistent issues, please contact COSLUS customer support.

## 9. SPECIFICATIONS

| Feature             | Detail  |
|---------------------|---|
| Item Model Number   | C51   |
| Product Dimensions  | 3.22 x 2.68 x 8.5 inches  |
| Item Weight         | 11.64 ounces  |
| Water Tank Capacity | 300ML   |
| Power Source        | Battery Powered (1 A battery included)  |
| Special Features    | Built-In Nozzle Storage, Rechargeable Battery, Non-Slip Grip, Compact for Travel, Adjustable Modes with Jet Mode, Multi-User Households, Detachable Easy-Fill Tank, 360° Rotating Tip, Customizable Cleaning, Lightweight & Noiseless, Orthodontic & Gum Care Nozzles, Auto-Mode Memory |
| Product Benefits    | Gum Health, Prevents Bad Breath, Prevents Cavities, Removes Plaque  |
| Waterproof Rating   | IPX7  |

## 10. SAFETY INFORMATION



Please read all safety instructions before using the COSLUS Portable Water Flosser C51:

- **Waterproof Design:** The device is IPX7 waterproof, making it safe for use in the shower. However, ensure the charging port cover is securely closed when exposed to water.
- **Charging:** Do not charge the device in wet environments. Always ensure the device and charging cable are dry before connecting.
- **Water Temperature:** Use lukewarm water (below 40°C) to avoid discomfort or damage to the device.
- **First-Time Users/Sensitive Gums:** Start with the lowest pressure setting (Level 1-2) to allow your gums to adapt and prevent bleeding.
- **Legal Disclaimer:** Statements regarding dietary supplements have not been evaluated by the FDA and are not intended to diagnose, treat, cure, or prevent any disease or health condition.

## Extra Wide Mouth & Borderless Design

Easy filling, quick cleaning, zero residue



|  |                            |   |
|--|----------------------------|---|
|  | Easy to clean and fill     | ↑ |
|  | Easy-Empty Stay-Dry Design | ↑ |
|  | 300ml(10oz)                | ↑ |

|  |                         |  |
|--|-------------------------|--|
|  | Hard to clean and fill  |  |
|  | Traps water hard to dry |  |
|  | 150ml(10oz)             |  |

Image: A woman using the COSLUS Water Flosser C51 in the shower, illustrating its IPX7 waterproof capability for convenient oral care.

## 11. WARRANTY AND SUPPORT

The COSLUS Portable Water Flosser C51 is built to last, with a typical lifespan of up to 3 years with regular use. For any questions, technical support, or warranty claims, please refer to the contact information provided in your product packaging or visit the official COSLUS website. Our customer service team is available to assist you.