

EONON UX7-U

Eonon UX7 Car Stereo User Manual

Model: UX7-U

1. INTRODUCTION

Thank you for choosing the Eonon UX7 Car Stereo. This manual provides detailed instructions for the installation, setup, and operation of your new car stereo. Please read this manual thoroughly before using the product to ensure proper functionality and safety.

The Eonon UX7 is a 7-inch double DIN car stereo featuring the latest Android 14 system, a QLED touchscreen, and advanced connectivity options like Wireless CarPlay and Android Auto. It is designed to enhance your in-car entertainment and navigation experience.

2. PRODUCT OVERVIEW AND FEATURES

2.1 Key Features

- **Android 14 System:** Built-in with the latest Android 14 system for superior performance and energy efficiency.
- **7-inch QLED Touchscreen:** 1024*600 HD resolution QLED display providing vivid colors and wide viewing angles.
- **Wireless CarPlay & Android Auto:** Seamless integration with your smartphone for navigation, music, calls, and messages.
- **Fast Type-C PD/QC Charging:** Equipped with a high-speed Type-C port for efficient device charging.
- **Digital Sound Processor (DSP):** Built-in DSP with 48-band graphic equalizer and six preset EQ modes for optimized audio experience.
- **Steering Wheel Control:** Supports analog SWC signal for convenient control.
- **Bluetooth 5.4:** For hands-free calls, contact synchronization, and high-quality music streaming.
- **OTA Updates:** Over-the-air firmware updates to fix software issues and enhance security.
- **Screen Mirroring:** Mirror apps from your phone onto the car stereo display.

2.2 Product Components



Figure 2.2.1: Front view of the Eonon UX7 Car Stereo, showing the 7-inch QLED touchscreen display with various app icons, volume knob, and USB/AUX ports.

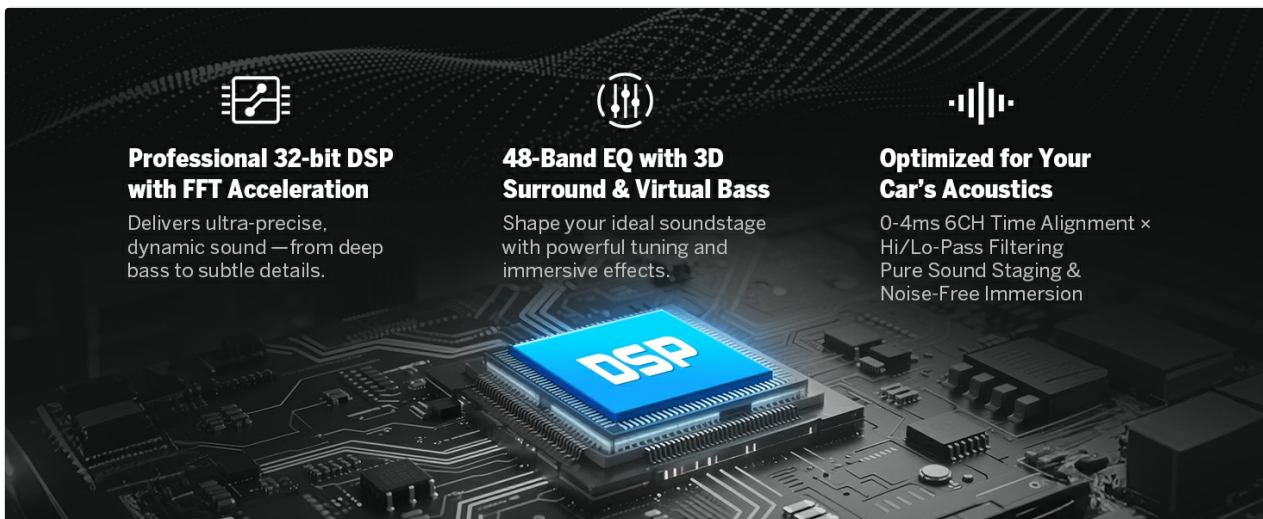

Figure 2.2.2: Diagram illustrating the internal components of the Eonon X7 series, including the ST 4x45W Amp, Wi-Fi 6 & Bluetooth 5.4 Module, Silicon Labs Si4755 Tuner, Samsung & Micron Memory, and Rockchip processor on a 4-layer automotive PCB.

DON'T BE FOOLED, VERIFY THE TRUTH!

Download "Fake Device Test"

Android version Processor Memory(RAM) Storage(ROM)

FALSE

Figure 2.2.3: Image highlighting the DSP features of the Eonon UX7, including professional 32-bit DSP with FFT Acceleration, 48-Band EQ with 3D Surround & Virtual Bass, and optimization for car acoustics.

3. INSTALLATION GUIDE

The Eonon UX7 is a double DIN car stereo. Ensure your vehicle's dashboard opening is compatible with the specified dimensions. If not, additional accessories may be required.

3.1 Applicable Models and Dimensions

The UX7 features a 7-inch adjustable panel that supports vertical movement and angle adjustments. It is designed for double DIN car stereo installations.

- **Compatible Mounting Size:** Width from 170-178 mm (6.69-7.01 inches), height from 96-100 mm (3.78-3.94 inches).
- **ISO Power Cord:** If your original car radio has an ISO power cord, direct installation is possible.
- **Single DIN Incompatibility:** This unit will not fit if your factory car radio is single DIN.



Figure 3.1.1: Diagram showing the compatible dimensions for the Eonon UX7 installation (170-178mm width, 96-100mm height) and illustrating that it is a double DIN unit, not suitable for single DIN openings.

If your car's center console dimensions do not match the specified range, an extra installation kit (not included) will be required. You may need to search for "Car make & model & year + ISO harness" or "Car make & model & year + 2 din kit" online to find suitable accessories.



Figure 3.1.2: Visual guide demonstrating when an installation kit is needed for the Eonon UX7, showing examples of compatible and incompatible dashboard sizes and the importance of an ISO harness.

3.2 Wiring Diagram

Refer to the following diagram for proper wiring connections. Ensure all connections are secure before powering on the unit.



Figure 3.2.1: Detailed wiring diagram for the Eonon UX7, labeling various ports such as ISO Port, Illumination Wire, SWC Wires, Reverse Trigger Wire, GND Wire, AMP, Audio Outputs, AUX Audio Inputs, External Microphone, Video Input, Front Camera Input, Subwoofer Output, Center Audio Out, USB Ports, Backup Camera Input, Brake Shift Control, GPS Antenna, ANT, WiFi Antenna, and Bluetooth Antenna.

Wiring Connections Legend

No.	Connection	No.	Connection
1.	ISO Port	16.	Center Audio Out
2.	Illumination Wire	17.	Audio Output RL
3.	SWC Wire 1	18.	Audio Output RR
4.	Reverse Trigger Wire	19.	RX/TX Input
5.	SWC Wire 2	20.	USB Port for CarPlay
6.	GND Wire	21.	USB Port

No.	Connection	No.	Connection
7.	AMP	22.	USB Port
8.	Audio Output FR	23.	GND Wire
9.	Audio Output FL	24.	Backup Camera Input
10.	AUX Audio In R	25.	Brake Shift Control
11.	AUX Audio In L	26.	GPS Antenna
12.	External Microphone	27.	ANT
13.	Video Input	28.	WiFi Antenna
14.	Front Camera Input	29.	Bluetooth Antenna
15.	Subwoofer Output		

4. INITIAL SETUP AND CONNECTIVITY

4.1 User-Focused Panel Design

The UX7 features an intuitive panel design for ease of use.

- **Volume Knob:** Easily and intuitively adjust the volume.
- **USB Ports:** Charge your phone or transfer music and movies.
- **AUX Input:** Connect external audio devices.

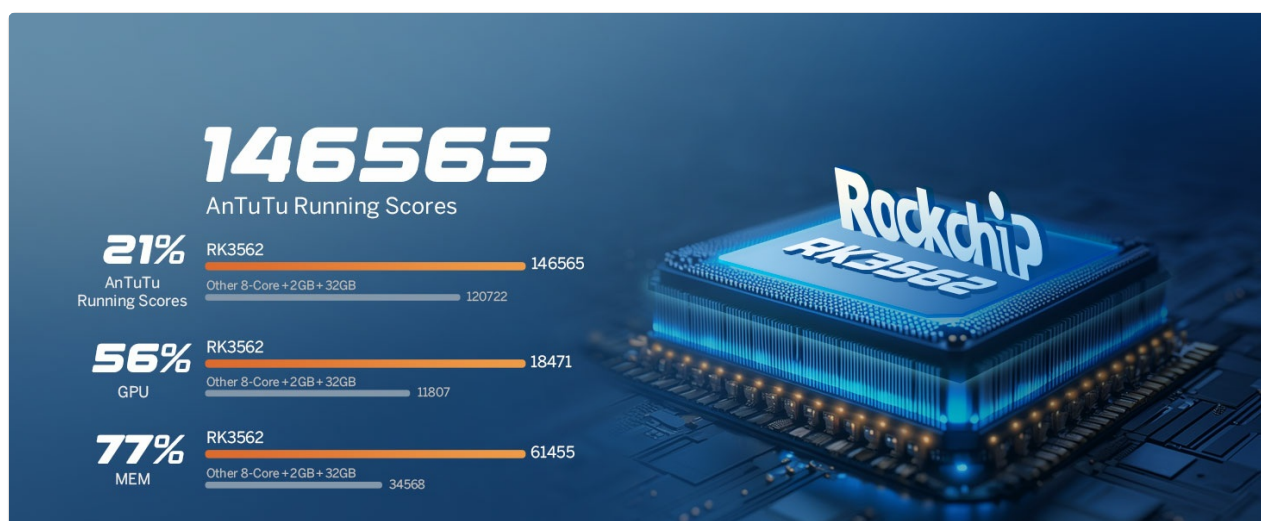

Figure 4.1.1: Illustration of the Eonon UX7's user-focused panel design, highlighting the volume knob, USB ports, and AUX input for easy access and control.

4.2 Wireless CarPlay Connection

1. Click the **Zlink5** app on the car stereo.
2. Turn on the **WiFi** and **Bluetooth** of your iPhone.
3. Find 'EONON' in your phone's Bluetooth device list and pair it.

- Once connected, tap 'Use CarPlay' and wait a few seconds to complete the connection.

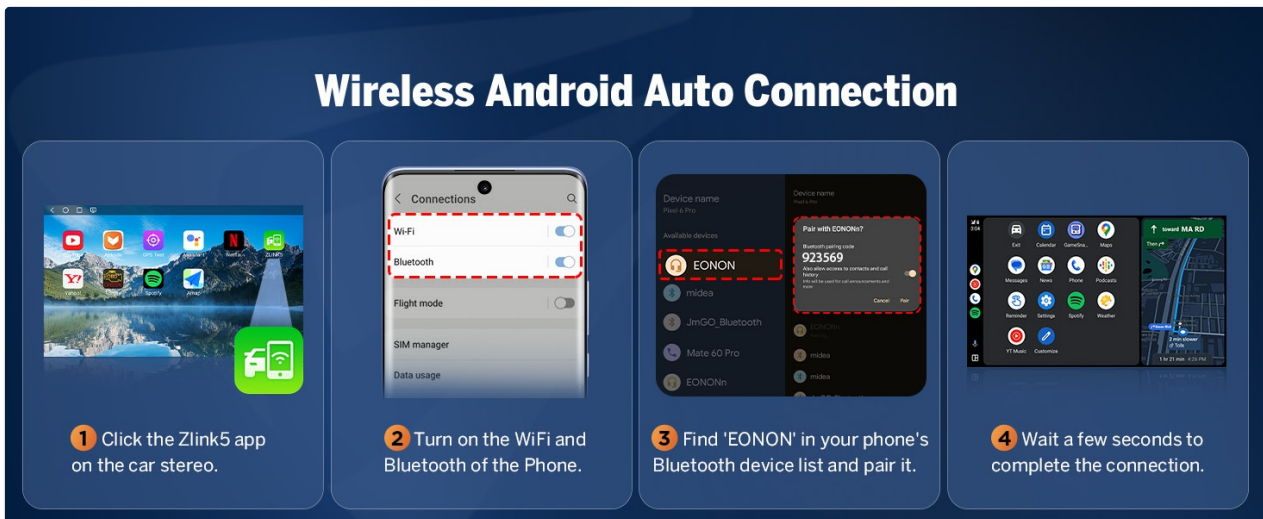

Figure 4.2.1: Step-by-step guide for connecting Wireless Apple CarPlay to the Eonon UX7, showing the Zlink5 app, iPhone WiFi/Bluetooth settings, Bluetooth pairing, and the final CarPlay interface.

4.3 Wireless Android Auto Connection

- Click the **Zlink5** app on the car stereo.
- Turn on the **WiFi** and **Bluetooth** of your Android phone.
- Find 'EONON' in your phone's Bluetooth device list and pair it.
- Wait a few seconds to complete the connection.

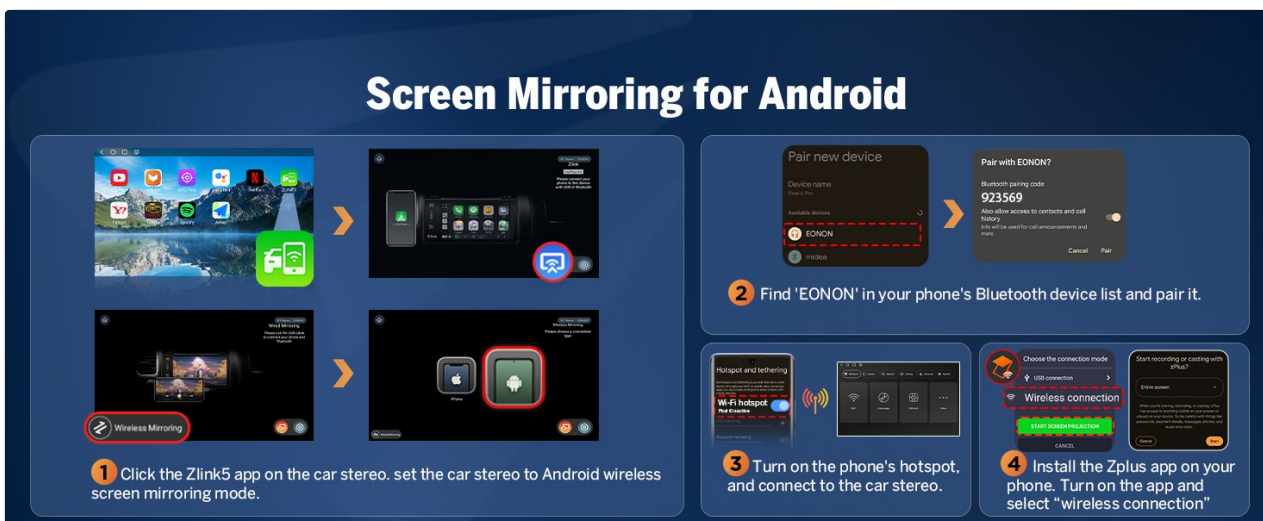

Figure 4.3.1: Step-by-step guide for connecting Wireless Android Auto to the Eonon UX7, showing the Zlink5 app, Android phone WiFi/Bluetooth settings, Bluetooth pairing, and the final Android Auto interface.

4.4 Screen Mirroring

The UX7 supports screen mirroring for both iOS and Android devices.

4.4.1 Screen Mirroring for iOS

- Click the **Zlink5** app on the car stereo. Set the car stereo to iPhone wireless screen mirroring mode.
- Turn on the iPhone hotspot and connect to the car stereo.
- Turn on the iPhone screen mirroring function and select "zj-airplay".

Applicable Models

The panel of the UX7 is removable and can be directly installed on the dashboard **within the specified size range as follows.**

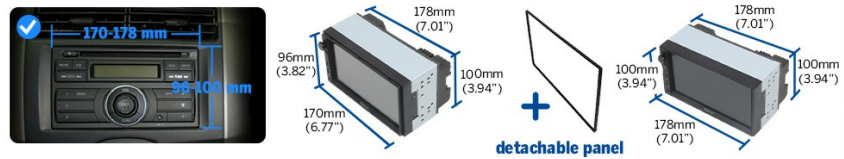

UX7 is a double din car stereo, and it won't fit your car if your factory car radio is single din.



Figure 4.4.1: Instructions for setting up screen mirroring from an iOS device to the Eonon UX7, detailing the Zlink5 app, iPhone hotspot connection, and AirPlay selection.

4.4.2 Screen Mirroring for Android

1. Click the **Zlink5** app on the car stereo. Set the car stereo to Android wireless screen mirroring mode.
2. Find 'EONON' in your phone's Bluetooth device list and pair it.
3. Turn on the phone's hotspot and connect to the car stereo.
4. Install the Zplus app on your phone. Turn on the app and select "wireless connection".

If your car dashboard size does **NOT** fall within the range of: 170-178 mm(length), 96-100 mm (height), you need an extra installation kit **(not included)** to install the unit.



Please note that the power cable of your factory car radio must have an ISO standard interface, as shown in the left picture. If not, you will need to purchase a compatible ISO wiring harness for installation.

Use these key words to find a proper mounting kit or wire harness for your car online:

Car make & model & year	+	ISO harness	🔍
Car make & model & year	+	2 din kit	🔍

Figure 4.4.2: Instructions for setting up screen mirroring from an Android device to the Eonon UX7, detailing the Zlink5 app, Bluetooth pairing, Android hotspot connection, and Zplus app usage.

4.5 Bluetooth Connectivity

The upgraded built-in Bluetooth system supports hands-free calls, contact synchronization, and music playback.

- Equipped with an external microphone for clear call quality.
- Features an independent Bluetooth module and extra Bluetooth antenna for quick and stable connection with noise reduction.



Figure 4.5.1: Image illustrating the independent Bluetooth module and extra Bluetooth antenna of the Eonon UX7, emphasizing quick and stable connection, noise reduction, crystal-clear call quality, and high-quality Bluetooth music.

5. OPERATION

5.1 Audio Settings and DSP

The built-in DSP and 4*45W max output power provide a rich sound experience. Utilize the 48-band graphic equalizer and six preset EQ modes to customize your audio.

Over-the-air Firmware Update

Keep your car stereo up-to-date through OTA updates. Fix software issues and enhance security with just a few taps.

Note: Android system upgrade is not supported.

Figure 5.1.1: Screenshot of the Eonon UX7's audio equalizer interface, showing the 36-band graphic equalizer and various EQ modes for sound customization.

5.2 Steering Wheel Controls

The unit supports analog Steering Wheel Control (SWC) signals, allowing you to control various functions directly from your steering wheel.



Figure 5.2.1: Image demonstrating the steering wheel control learning interface on the Eonon UX7, allowing users to map functions to their vehicle's steering wheel buttons.

5.3 Display and UI Themes

The 7-inch QLED touch screen offers 1024*600 HD resolution with true-to-life colors. The UX7 Car Radio comes with 3 built-in UI themes that you can choose from.

New 3 Brightness Modes (Light, Dark, and Auto) provide a safer and more comfortable driving experience, especially at night.



Figure 5.3.1: Image showcasing the 7-inch QLED display of the Eonon UX7, highlighting its vivid colors, brightness, and 1080P video playback capability, along with examples of the three customizable UI themes.



Figure 5.3.2: Image demonstrating the customization options for the Eonon UX7's interface, including boot logo, button color, and wallpaper settings.

5.4 Fast Charging

The UX7 is equipped with a high-speed Type-C port that supports PD 3.0 and PPS fast charging, ensuring your devices power up faster and more efficiently on the go.

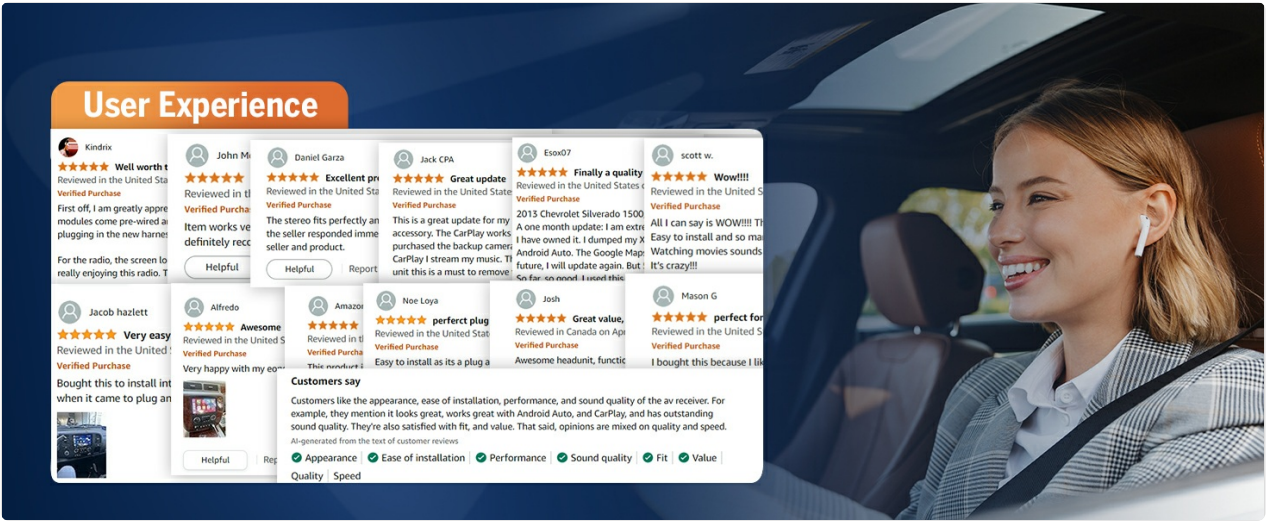

Figure 5.4.1: Image illustrating the fast charging capability of the Eonon UX7 via its Type-C port, supporting PD3.0/PD2.0, QC3.0/QC2.0, FCP/SCP, and AFC protocols.

6. OPTIONAL ACCESSORIES (NOT INCLUDED)

Enhance your Eonon UX7 experience with these compatible accessories:

6.1 Eonon Dashcam (A100)

The UX7 supports the Eonon dashcam (A100) for recording your drives. This accessory is not included with the stereo.

Wiring Diagram

1. ISO Port

2. Illumination Wire

3. SWC Wire 1

4. Reverse Trigger Wire

5. SWC Wire 2

6. GND Wire

7. AMP

8. Audio Output FR

9. Audio Output FL

10. AUX Audio In R

11. AUX Audio In L

12. External Microphone

13. Video Input

14. Front Camera Input

15. Subwoofer Output

16. Center Audio Out

17. Audio Output RL

18. Audio Output RR

19. RX/TX Input

20. USB Port for CarPlay

21. USB Port

22. USB Port

23. GND Wire

24. Backup Camera Input

25. Brake Shift Control

26. GPS Antenna

27. ANT

28. WiFi Antenna

29. Bluetooth Antenna

Figure 6.1.1: Image illustrating the Eonon UX7's compatibility with the A100 Dash Cam, showing its 120° viewing angle and 1280x720 video playback.

6.2 OBD2 Scanner (V0056)

Connect an OBD2 scanner (V0056) to the UX7 for vehicle fault diagnosis and real-time status monitoring. This accessory is not included.

What's in the Box



1
Audio Video
Adapter Cable *1

2
Audio Adapter
Cable *1

3
CarPlay & Android Auto
USB Adapter Cable *1

4
USB Adapter
Cable *1

5
Backup Camera
Video Input Cable *1

6
Power Cable *1

7
GPS Antenna *1

External
Microphone *1

Screw *8

Rotary Knob *1

Spare Fuse *1

User Manual *1

Figure 6.2.1: Image demonstrating the Eonon UX7's support for an OBD2 scanner (V0056), enabling vehicle fault diagnosis and real-time status display.

6.3 DAB+ Box (502)

The UX7 supports the DAB+ box (502) for digital audio broadcasting. This accessory is not included.

7. WHAT'S IN THE BOX

The following items are included with your Eonon UX7 Car Stereo:

- Reversing Camera A0125 *1
- Power Cord *1
- GPS Antenna *1
- USB Adapter Cable *2
- Audio/Video Adapter Cable *2
- Reversing Video Input Cable *1
- 15A Fuse *1
- External Microphone *1
- Instruction Manual *1
- Screws *8
- Small Knob *1

Fast Charging

Equipped with a high-speed Type-C port that supports PD 3.0 and PPS fast charging—ensuring your devices power up faster and more efficiently on the go.

PPS/PD3.0/PD2.0

QC3.0/QC2.0

FCP/SCP

AFC



Figure 7.1.1: Visual representation of all items included in the Eonon UX7 package, such as audio/video adapter cables, USB adapter cables, backup camera video input cable, power cable, GPS antenna, external microphone, screws, rotary knob, spare fuse, and the user manual.

8. SPECIFICATIONS

Feature	Detail
Model Number	UX7-U
Operating System	Android 14
RAM + ROM	3GB RAM + 32GB ROM
Display Size	7 Inch
Display Type	QLED Touch Screen
Resolution	1024*600 HD
Processor	Rockchip Processor (ARM Cortex-A53@2.0GHz)
Audio Output Power	4 * 45W Max
Bluetooth Version	5.4
Connectivity	Bluetooth, USB, Wi-Fi
Special Features	Android Auto, Apple CarPlay, Built-In Bluetooth, DSP, Fast Charging (PD/QC)
Item Weight	4.4 pounds (2 Kilograms)
Package Dimensions	9.06 x 7.87 x 6.3 inches

9. TROUBLESHOOTING

This section provides solutions to common issues you might encounter.

- **No Power:** Ensure all power connections are secure and the fuse is not blown. Check the ISO power cord connection.
- **No Sound:** Verify speaker connections. Check audio settings, including volume levels and EQ settings. Ensure the AMP wire is correctly connected if using an external amplifier.
- **CarPlay/Android Auto Not Connecting:** Double-check WiFi and Bluetooth connections on both the stereo and your phone. Ensure the Zlink5 app is running. For Android, confirm the Zplus app is installed and running.
- **Poor Radio Reception:** Check the antenna connection. Ensure the ANT wire is properly connected.
- **Steering Wheel Controls Not Working:** Ensure the SWC wires are correctly connected. Access the steering wheel control learning function in the settings to re-map buttons.
- **System Slow or Unresponsive:** Close unnecessary background applications. Perform a system restart. Consider checking for Over-the-Air (OTA) firmware updates to improve performance and security. *Note: OTA updates are for firmware, not for Android system upgrades.*



Figure 9.1.1: Image illustrating the Over-the-air (OTA) firmware update feature for the Eonon UX7, which helps fix software issues and enhance security.

10. MAINTENANCE

To ensure the longevity and optimal performance of your Eonon UX7 Car Stereo, follow these maintenance guidelines:

- **Cleaning:** Use a soft, dry cloth to clean the screen and exterior. Avoid abrasive cleaners or solvents that may damage the surface.
- **Software Updates:** Regularly check for and install Over-the-Air (OTA) firmware updates to ensure your device has the latest improvements and security patches.
- **Temperature Control:** Avoid exposing the unit to extreme temperatures, both hot and cold, as this can affect performance and lifespan.

- **Ventilation:** Ensure the unit's ventilation areas are not blocked to prevent overheating.

11. WARRANTY AND SUPPORT

Eonon products come with a standard warranty. Please refer to the warranty card included in your package or visit the official Eonon website for detailed warranty terms and conditions.

For technical support, troubleshooting assistance, or service inquiries, please contact Eonon customer support through their official channels. You can find contact information on the Eonon website or in the included documentation.

Online Resources:

- Eonon Official Website: www.eonon.com
- Eonon Amazon Store: [Visit the EONON Store on Amazon](#)