

Beleeb BLB-KTS-D1315

Beleeb BLB-KTS-D1315 13x15 Inch Drop-In Bar Sink User Manual

Model: BLB-KTS-D1315

1. IMPORTANT SAFETY INFORMATION

Please read all instructions carefully before installation and use. Retain this manual for future reference.

- Ensure all local plumbing and building codes are followed during installation.
- Wear appropriate personal protective equipment (PPE) such as safety glasses and gloves during installation.
- Turn off the main water supply before beginning any plumbing work.
- Handle the sink with care to avoid damage or injury.
- Do not use abrasive cleaners or harsh chemicals on the sink surface, as this may damage the finish.

2. PRODUCT OVERVIEW

The Beleeb BLB-KTS-D1315 is a 13x15 inch drop-in bar sink constructed from 18-gauge stainless steel. It features a 9-inch deep single bowl, designed for versatile use in kitchens, RVs, and bars.

2.1 Key Features

- **Compact Size:** 13x15x9 inch dimensions, ideal for smaller spaces.
- **Durable Construction:** 18-gauge stainless steel with an upgraded millet-grain 3D embossed surface for enhanced scratch resistance.
- **Efficient Drainage:** Slight bottom slope and X-guide design with bottom water grooves for rapid water drainage.
- **Noise Reduction:** 3mm thick rubber padding and special moisture-absorbing coat to reduce noise and prevent condensation.
- **Included Accessories:** Basket strainer, 114mm large-diameter drain, stainless steel bottom grid.

2.2 Components Included

Verify that all components are present before beginning installation.

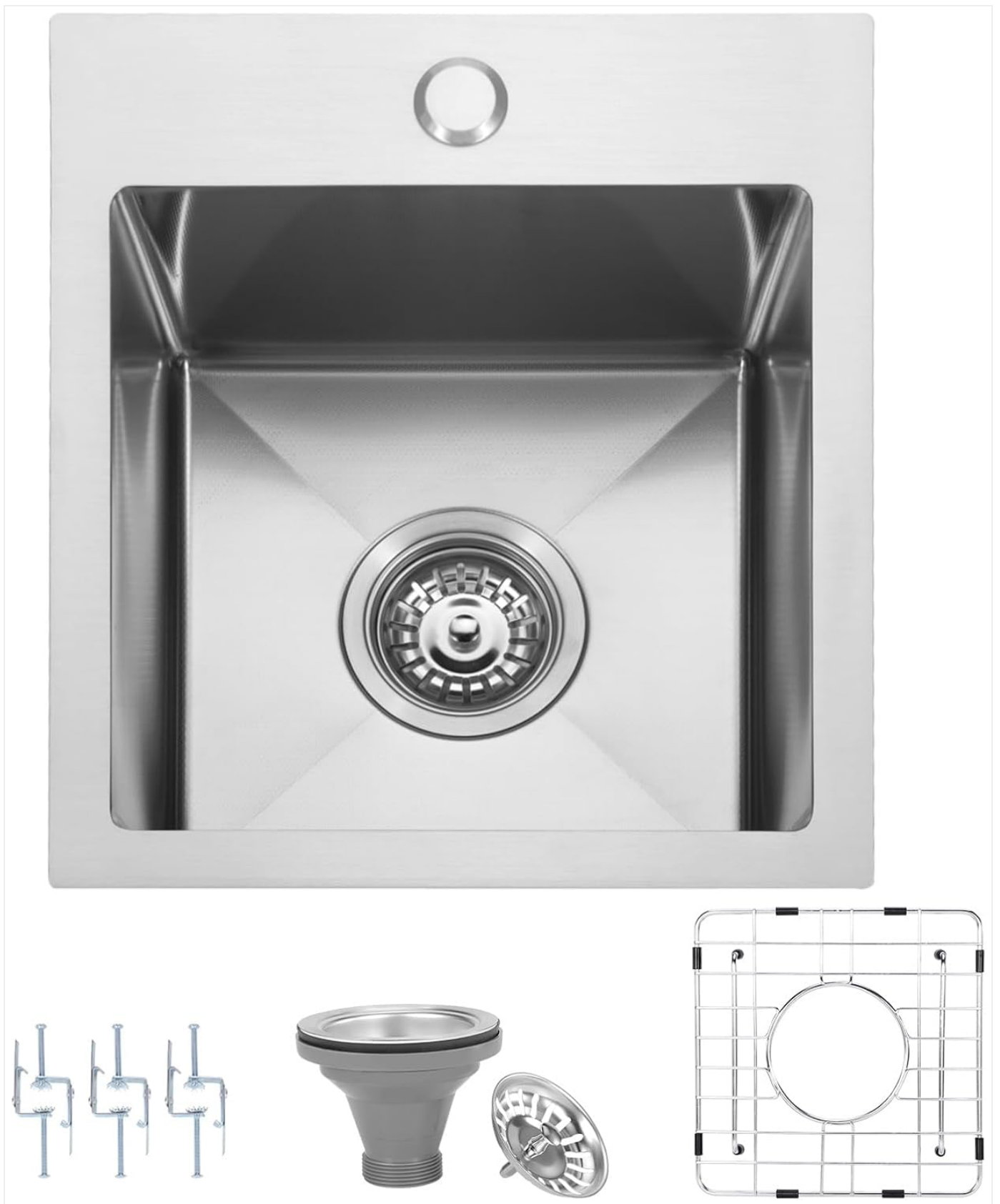

Figure 1: Sink body, mounting clips, drain assembly, and bottom grid.

- Sink Body
- Drainage Grid (Bottom Grid)
- Drain Outlet (Basket Strainer and Drain Assembly)
- Mounting Clips (if applicable for topmount installation)
- Installation Template (usually included for cutout)

3. INSTALLATION INSTRUCTIONS

This section provides general guidelines for top-mount installation. Consult a professional plumber if you are unsure about any steps.

3.1 Tools and Materials Required

- Safety glasses and gloves
- Jigsaw or appropriate cutting tool
- Drill
- Measuring tape and pencil
- Silicone sealant (kitchen and bath grade)
- Adjustable wrench or pliers
- Screwdriver

3.2 Countertop Preparation

1. **Measure and Mark:** Use the provided template (if available) or the sink's dimensions to mark the cutout area on your countertop. Ensure proper clearance from cabinets and walls. The sink exterior dimensions are approximately 13 inches (length) by 15 inches (width).
2. **Cut the Opening:** Carefully cut the marked opening in the countertop using a jigsaw or suitable cutting tool. Ensure the edges are smooth.
3. **Seal Edges:** Apply a waterproof sealant to the raw edges of the countertop cutout to prevent moisture damage.

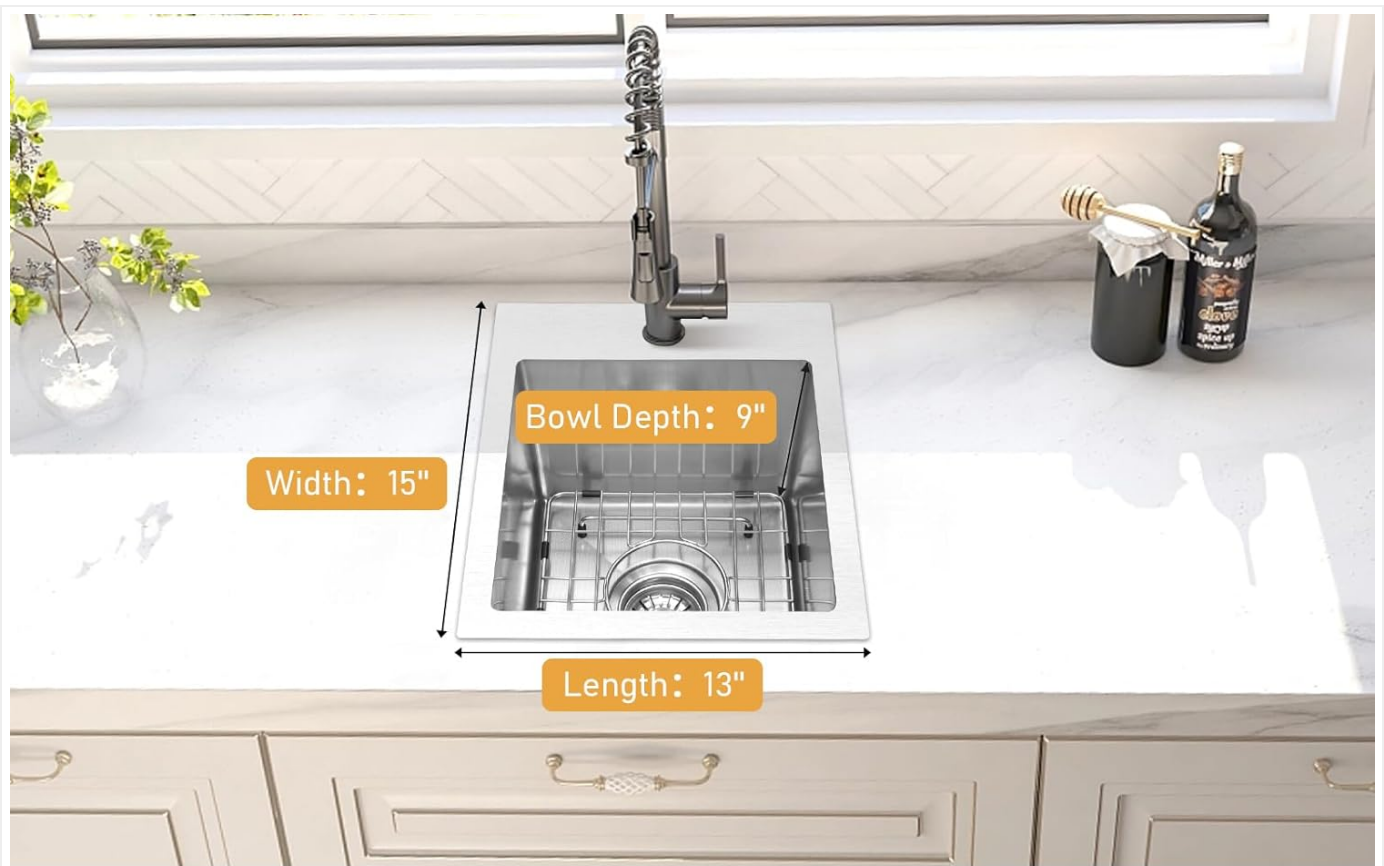

BELEEB 9 INCH Drop-in Sink

Sink Dimensions

13 Inches × 15 Inches × 9 Inches

Bowl Depth: 9"

Drain hole: 4.53"

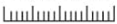
Unit: inch

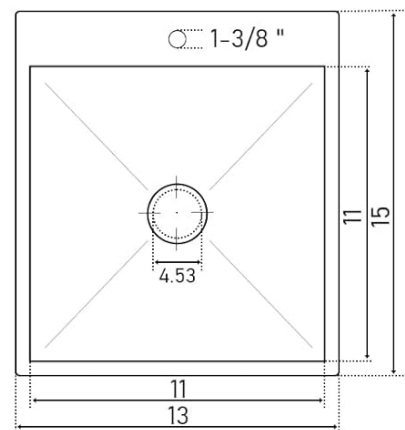

Figure 2: Sink dimensions and recommended cutout for top-mount installation.

3.3 Sink Installation

1. **Install Faucet and Accessories (Optional):** If your sink has pre-drilled holes for a faucet or soap dispenser, install them onto the sink before placing the sink into the countertop opening.
2. **Apply Sealant:** Apply a continuous bead of silicone sealant around the perimeter of the sink's underside rim that will contact the countertop.
3. **Position Sink:** Carefully lower the sink into the countertop opening, ensuring it is properly aligned. Press down firmly to create a seal.
4. **Secure with Clips:** Attach the mounting clips (if provided) to the underside of the sink rim and tighten them against the countertop to secure the sink in place. Do not overtighten.
5. **Wipe Excess Sealant:** Immediately wipe away any excess silicone sealant that squeezes out from under the rim.

3.4 Drain Assembly Installation

1. **Prepare Drain:** Apply plumber's putty or a silicone bead around the flange of the basket strainer.

2. **Insert Drain:** Insert the basket strainer into the sink's drain opening from the top.
3. **Secure from Below:** From underneath the sink, attach the rubber gasket, friction washer, and locknut to the drain body. Tighten securely with an adjustable wrench.
4. **Connect Plumbing:** Connect the drain assembly to your household plumbing system according to local codes. Ensure all connections are watertight.

4. OPERATION

The Beleeb bar sink is designed for straightforward use. Once installed and connected to the water supply and drainage, it functions like any standard kitchen or bar sink.

- **Water Flow:** Use your installed faucet to control water flow and temperature.
- **Drainage:** The sink's sloped bottom and X-guide design facilitate quick water drainage. The included basket strainer prevents large debris from entering the drain.
- **Using Accessories:** The stainless steel bottom grid can be placed in the sink to protect the bottom surface and allow items to air dry.

5. CARE AND MAINTENANCE

Proper care will ensure the longevity and appearance of your stainless steel sink.

5.1 Daily Cleaning

- After each use, rinse the sink thoroughly with water to remove food particles and residue.
- Wipe the sink dry with a soft cloth to prevent water spots, especially in hard water areas.
- Use a mild dish soap and a soft sponge or cloth for general cleaning.

5.2 Avoiding Damage

- **Avoid Abrasives:** Do not use steel wool, abrasive pads, or harsh chemical cleaners (e.g., bleach, ammonia-based products) as they can scratch or stain the stainless steel finish.
- **Prevent Scratches:** While the 3D embossed surface is scratch-resistant, avoid dragging sharp or heavy objects across the sink surface. The included bottom grid helps protect the sink.
- **Heat Protection:** Do not place extremely hot pots or pans directly into the sink without protection, as extreme temperature changes can affect the material over time.
- **Rust Prevention:** Remove any iron-containing objects (e.g., cast iron pans, steel wool fragments) from the sink promptly to prevent rust spots.

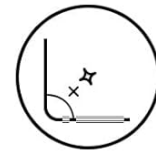

Easy-Clean Structure Design

10 mm radius curved corners for easy cleaning, with an elegant and seamless visual appeal, leaving no dead corners.

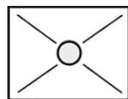

Faster Drainage

The bottom X-guide design rapidly diverts water flow through its cross-channel structure, significantly enhancing kitchen usability and drainage efficiency.

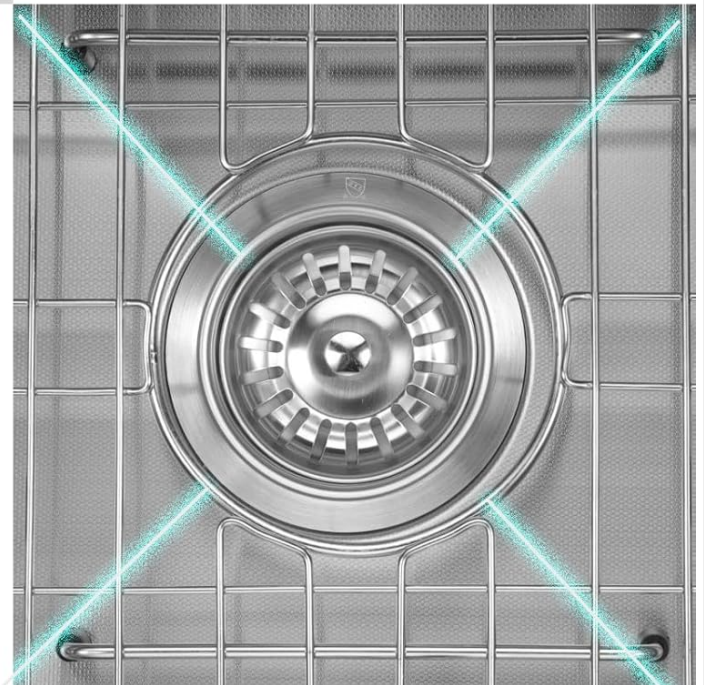

Figure 3: The R10 curved corners and easy-clean structure design facilitate simple maintenance.

6. TROUBLESHOOTING

Problem	Possible Cause	Solution
Water spots or streaks	Hard water deposits; not drying the sink after use.	Wipe the sink dry after each use. For existing spots, use a stainless steel cleaner or a solution of vinegar and water, then rinse and dry.
Slow drainage	Drain clogged with food particles or debris.	Remove the basket strainer and clear any obstructions. Use a drain cleaner if necessary, following product instructions.
Rust spots	Exposure to iron-containing objects or harsh chemicals.	Remove rust spots with a non-abrasive stainless steel cleaner. Prevent by avoiding prolonged contact with iron and harsh chemicals.

Problem	Possible Cause	Solution
Water pooling slightly in the sink bottom	Minor variations in manufacturing or installation.	This is often minimal and does not affect function. Ensure the sink is level during installation. A squeegee can be used to direct water to the drain.

7. PRODUCT SPECIFICATIONS

Feature	Detail
Brand	Beleeb
Model Number	BLB-KTS-D1315
Type	Drop-In Bar Sink / Kitchen Sink
Material	18-Gauge Stainless Steel
Finish	Millet Grain (3D Embossed)
Color	Stainless Steel
Exterior Dimensions (Length x Width x Height)	13 inches x 15 inches x 9 inches
Bowl Depth	9 inches
Drain Type	Grid (Basket Strainer)
Item Weight	14.67 pounds (6.67 kg)
Installation Type	Countertop (Topmount)

8. WARRANTY AND SUPPORT

For warranty information and customer support, please refer to the product packaging or contact Beleeb customer service directly. Keep your purchase receipt as proof of purchase.

For further assistance, visit the official Beleeb store:[Beleeb Store on Amazon](#)

