

## CEM ILDM-150

# CEM ILDM-150 Laser Distance Measure User Manual

Model: ILDM-150

[Introduction](#)   [Features](#)   [Setup](#)   [Operation](#)   [Bluetooth & Warranty & Support](#)  
[App](#)   [Maintenance](#)   [Troubleshooting](#)   [Specifications](#)

## 1. INTRODUCTION

This manual provides detailed instructions for the safe and effective use of the CEM ILDM-150 Laser Distance Measure. The ILDM-150 is a precision instrument designed for accurate distance, area, and volume measurements, featuring Bluetooth connectivity for data transfer and management via the Meterbox Pro application. Please read this manual thoroughly before operating the device to ensure proper functionality and safety.



Figure 1.1: CEM ILDM-150 Laser Distance Measure and included accessories.

## 2. PRODUCT FEATURES

The CEM ILDM-150 Laser Distance Measure offers a range of features designed for efficiency and accuracy:

- **High Accuracy:** Utilizes a Class II Laser with 1mW output, providing accuracy up to  $\pm 1/16$  inch (1.5mm) over a measuring range of up to 229 feet (70 meters).
- **Multiple Measurement Modes:** Supports single distance, continuous measurement, area, volume, and Pythagorean (three-point) calculations.
- **Unit Switching:** Easily switch between meters (M), inches (In), and feet (Ft).
- **Bluetooth 4.0 Connectivity:** Seamlessly transfer measured data to a smartphone or tablet using the Meterbox Pro application for analysis and sharing.
- **Data Storage:** Stores up to 99 groups of measurement data, with manual deletion capability.
- **LCD Backlight:** Large backlit screen for improved visibility in low-light conditions.
- **Mute Setting:** Option to turn the measurement beep on or off for use in quiet environments.

- **Durable Design:** IP54 rated for water and dust resistance, featuring a hard rubber body for enhanced grip and protection.
- **Power Saving:** Automatic shut-down after 150 seconds of inactivity to conserve battery life.
- **Low Battery Indication:** Alerts the user when batteries need replacement.



Figure 2.1: Overview of CEM ILDM-150 key features.

### 3. SAFETY INFORMATION

---

The CEM ILDM-150 is a Class II laser product. Adhere to the following safety guidelines:

- Do not stare directly into the laser beam.
- Do not aim the laser beam at people or animals.
- Avoid using optical instruments (e.g., binoculars, telescopes) to view the laser beam.
- Keep the device out of reach of children.
- Do not attempt to modify or disassemble the device.
- Use only specified batteries.

### 4. GETTING STARTED (SETUP)

---

#### 4.1 Package Contents

Upon opening the package, verify that all items are present:

- CEM ILDM-150 Laser Distance Measure
- 1.5V AAA Batteries (Note: While typically included, please check the packaging upon receipt as specifications may vary.)
- Portable Bag
- User Manual
- Hand Strap
- Package Box

#### 4.2 Battery Installation

The ILDM-150 requires 1.5V AAA batteries for operation.

1. Locate the battery compartment cover on the rear of the device.

2. Slide the cover open in the direction indicated by the arrow.
3. Insert the AAA batteries, ensuring correct polarity (+/-) as marked inside the compartment.
4. Close the battery compartment cover securely.

## 4.3 Powering On/Off

- **To Power On:** Press the **MEAS** button. The display will illuminate.
- **To Power Off:** Press and hold the **CLR/OFF** button for approximately 2 seconds. The device will also automatically shut down after 150 seconds of inactivity.

## 5. OPERATING INSTRUCTIONS

---

### 5.1 Basic Measurement

To perform a single distance measurement:

1. Point the laser at the target surface.
2. Press the **MEAS** button once. The laser will activate.
3. Press the **MEAS** button again to take the measurement. The result will be displayed on the screen.

### 5.2 Unit Switching

To change the measurement unit (M/In/Ft):

- Press the **Unit** button repeatedly until the desired unit is displayed.

### 5.3 Backlight and Mute Settings

- The backlight automatically activates when the device is in use.
- To toggle the measurement beep (mute/unmute), refer to the specific button or menu option in your device's interface, typically indicated by a speaker icon.

### 5.4 Advanced Measurement Modes

The ILDM-150 supports various measurement functions:

- **Area Measurement:** Press the Area/Volume button once. Follow the on-screen prompts to measure length and width. The device will calculate and display the area.
- **Volume Measurement:** Press the Area/Volume button twice. Follow the on-screen prompts to measure length, width, and height. The device will calculate and display the volume.
- **Pythagorean Measurement (Indirect Measurement):** Use this mode to calculate distances indirectly (e.g., height of a building). Press the Pythagorean button. Follow the on-screen prompts to take the required measurements (e.g., hypotenuse and one leg). The device will calculate the unknown side.
- **Continuous Measurement (Tracking):** Press the **MEAS** button and hold it down. The device will continuously measure and display the distance as you move it, showing real-time minimum and maximum values. Release the button to stop.
- **Addition and Subtraction:** After taking a measurement, use the '+' or '-' buttons to add or subtract subsequent measurements from the current total.

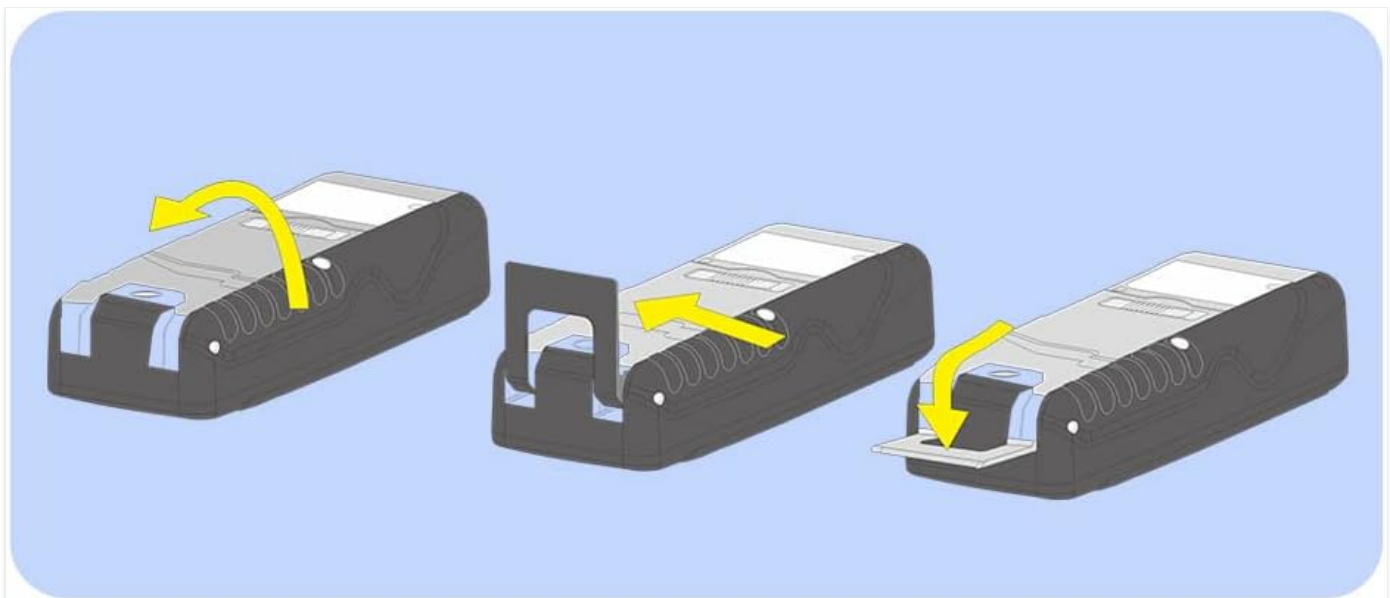

Figure 5.1: Multiple measurement modes supported by the ILDM-150.

## 5.5 Tailstock Function

The multi-functional tailstock allows for measurements from corners or edges, ensuring accuracy when the device cannot be placed flush against a surface.





## Multi-Functional Use Of Tailstock

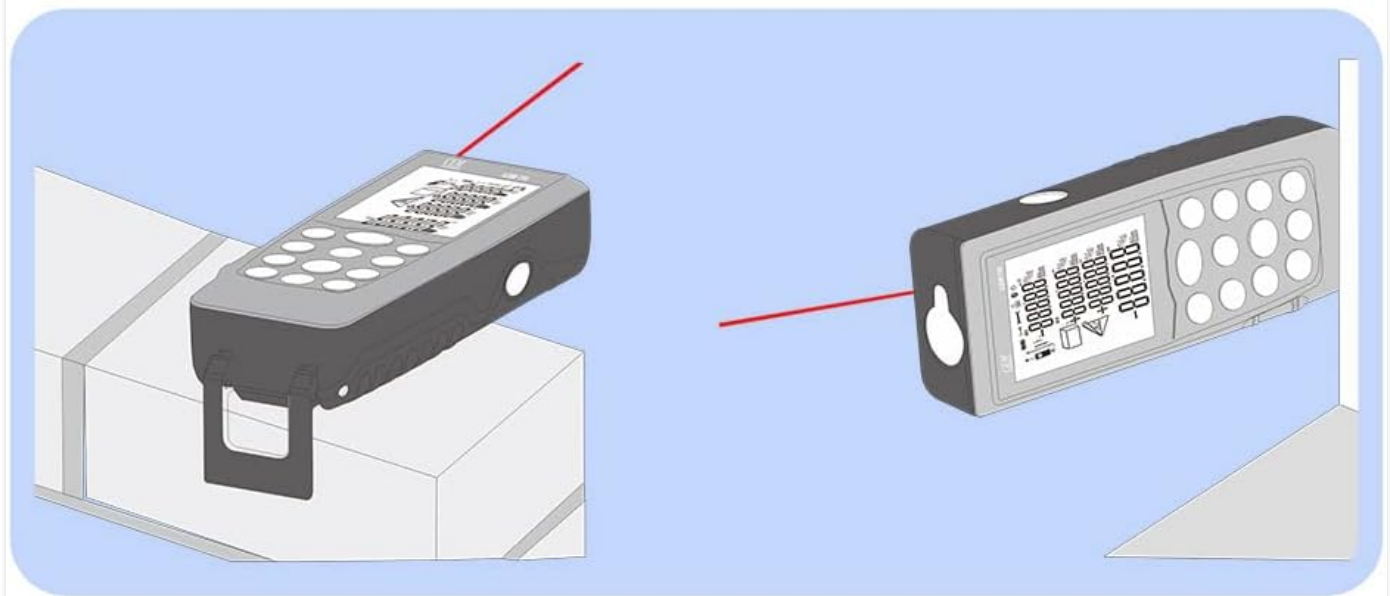

Figure 5.2: Multi-functional use of the tailstock.

## 6. BLUETOOTH CONNECTIVITY & APP

The ILDM-150 features Bluetooth 4.0 for seamless data transfer to your smartphone or tablet via the Meterbox Pro application.

### 6.1 Installing Meterbox Pro

1. Search for "Meterbox Pro" in your device's app store (iOS App Store or Google Play Store).
2. Download and install the application.

### 6.2 Pairing the Device

1. Ensure Bluetooth is enabled on your smartphone/tablet.
2. Power on the ILDM-150.
3. Open the Meterbox Pro application. The app should automatically detect and connect to the ILDM-150.
4. A Bluetooth icon on the ILDM-150's display will indicate a successful connection.

# Bluetooth With Meterbox Pro Support APP

laser distance meter transferring  
the measured data to the smartphone



Meterbox pro



Bluetooth



Figure 6.1: Bluetooth connectivity with Meterbox Pro app.

## 6.3 Data Transfer and Management

Once connected, measurements taken with the ILDM-150 can be transferred to the Meterbox Pro app. The app allows you to:

- View and organize measurement data.
- Create reports or charts.
- Share data via email, social media, or other applications.



Figure 6.2: Convenient data analysis and sharing via Meterbox Pro.

## 6.4 Data Storage on Device

The device can store up to 99 groups of historical data values.

- **Recalling Data:** Use the memory buttons (e.g., up/down arrows) to scroll through stored measurements.
- **Deleting Data:** Press the **CLR** button to manually delete the currently displayed data.



# Date Storage Function

20 Groups of historical data values can be displayed on the screen at the same time



Figure 6.3: On-device data storage and display.

## 7. MAINTENANCE AND CARE

---

Proper maintenance ensures the longevity and accuracy of your ILDM-150.

- **Cleaning:** Use a soft, damp cloth to clean the device. Do not use abrasive cleaners or solvents. Pay special attention to the laser lens, cleaning it gently with a lens cloth if necessary.
- **Storage:** Store the device in its portable bag in a cool, dry place when not in use. Avoid extreme temperatures and direct sunlight.
- **Battery Care:** Remove batteries if the device will not be used for an extended period to prevent leakage.
- **Impact Protection:** While durable, avoid dropping the device or subjecting it to strong impacts.

# Double Injection Molding Machine

IP54 WATERPROOF

DUST PROTECT SPLASH PROOF



Figure 7.1: The ILDM-150 features IP54 water and dust protection.

## 8. TROUBLESHOOTING

If you encounter issues with your CEM ILDM-150, refer to the following table for common problems and solutions:

Problem	Possible Cause	Solution
Device does not power on.	Low or dead batteries; Incorrect battery installation.	Replace batteries; Ensure correct polarity.
Inaccurate measurements.	Laser lens dirty; Unstable measurement surface; Device not held steady; Measurement taken over reflective or transparent surfaces.	Clean laser lens; Ensure stable placement; Use a target plate for difficult surfaces.
Bluetooth connection fails.	Bluetooth off on smartphone; Device out of range; App not running.	Enable Bluetooth; Ensure device is within 10m range; Restart Meterbox Pro app.
Display is dim or unreadable.	Low battery; Extreme temperature.	Replace batteries; Operate within specified temperature range.
Device shuts off unexpectedly.	Auto-off feature activated; Low battery.	This is normal after 150 seconds of inactivity; Replace batteries if low battery indicator is on.

## 9. TECHNICAL SPECIFICATIONS

Detailed specifications for the CEM ILDM-150 Laser Distance Measure:

Specification	Value
Brand	CEM
Model Name	ILDm-150

Specification	Value
Part Number	CEM ILDM-150
Color	black 1
Measuring Range	229 feet or 70 meters
Accuracy	±1/16 inch (1.5mm)
Laser Class	Class II, <1mW
International Protection Rating	IP54 (Waterproof, Dust-proof)
Material	Double Injection Molding Machine, Plastic
Item Weight	203 Grams
Battery Type	Alkaline (AAA)
Auto Shut-off	150 seconds (approx.)
Data Memory	99 groups
Bluetooth Version	4.0
Item Dimensions (L x W x H)	5.31 x 2.09 x 1.18 inches
UPC	887327150034
Manufacturer	Shenzhen Everbest Machinery Industry Co.,Ltd.
Date First Available	July 9, 2018

# Larger Backlight Screen

Large backlit screen for you to  
work in dark environment



Figure 9.1: Dimensions of the ILDM-150.

## 10. WARRANTY AND SUPPORT

---

### 10.1 Warranty Information





The CEM ILDM-150 Laser Distance Measure comes with a **12-month warranty** from the date of purchase. This warranty covers defects in materials and workmanship under normal use. It does not cover damage caused by misuse, accidents, unauthorized modifications, or improper maintenance.

### 10.2 Customer Support

For technical assistance, warranty claims, or further inquiries, please contact CEM customer support through their official website or the contact information provided with your purchase documentation. Please have your model number (ILDM-150) and purchase date ready when contacting support.



Related Documents

	<p><a href="#">CEM iLDM-150 Laser Distance Meter User Manual</a></p> <p>Comprehensive guide for the CEM iLDM-150 Laser Distance Meter, detailing its features, operation for distance, area, and volume measurements, and technical specifications.</p>
	<p><a href="#">CEM LDM-100 Laser Distance Meter User Manual - Operation, Features, and Specifications</a></p> <p>Detailed user manual for the CEM LDM-100 Laser Distance Meter. Learn about its features, functions, safety instructions, technical specifications, and troubleshooting for accurate distance measurements.</p>
	<p><a href="#">CEM LM-50 Laser Distance Meter User Manual</a></p> <p>Comprehensive user manual for the CEM LM-50 Laser Distance Meter, covering safety instructions, operation, measurement functions, technical specifications, and troubleshooting.</p>
<p>CEM Coating Thickness Gauge Pro</p> 	<p><a href="#">CEM Coating Thickness Gauge Pro DT-156H User Manual</a></p> <p>Comprehensive user manual for the CEM Coating Thickness Gauge Pro (DT-156H). Covers general information, features, specifications, operation, calibration, settings, troubleshooting, and more.</p>

Documents - CEM – ILDM-150

[\[pdf\]](#) User Manual Troubleshooting Guide

iLDM 150 v130105      Please read this manual before switching the unit on Important safety information inside Laser Distance Meter User Manual View QM1624 manualMain jaycar co nz medias sys master images 9170428198942 |||

Laser Distance Meter User Manual Please read this manual before switching the unit on. Important safety information inside. Laser Distance Meter User Manual Content

1.Safety Instruction .....4 2.Start-Up . . . . .

.....

lang:en **score:21** filesize: 5.62 M page\_count: 28 document date: 2013-07-09



[\[pdf\]](#)

cem tester Document sans titre manuels solutions files |||

CEM DT-6650/6651/6652 Multifunction Installation Tester Multifunction Installation Tester 6650/6651/6652 rugged Multifunction Installation Tester with 3.5 TFT color LCD display, provides insulation resistance, earth resistance, loop impedance, voltage, RCD, PFG and PSC testing. It is designed wit...

lang:en **score:15** filesize: 7.78 M page\_count: 26 document date: 2014-10-14







[\[pdf\]](#) Specifications Catalog

Product Catalogue DT 8862B 8863B Professional Infra Red Thermometer With Dual Laser  
 SPECIFICATIONS Check the CEM web for detailed specifications Cem 2016 nastocke files  
 Product Catalogue 2016 [www.cem-instruments.in](http://www.cem-instruments.in) Best Quality Products For over 24  
 years, CEM, SHENZHEN EVERBEST MACHINERY INDUSTRY CO. LTD. has been  
 a leading chinese manufacturer specialising in Infrared Thermometers, Digital  
 Multimeters, Clamp-on Meters, Insulation Testers, Electrical Testers, Li...  
 lang:en **score:14** filesize: 9.84 M page\_count: 119 document date: 2016-01-07



[\[pdf\]](#) Catalog

Product CatalogueCEM offers Infrared Thermometers Digital Multimeters Clamp on Meters Insulation  
 Testers Electrical Light Sound Level and moreCEM Catalogue 2016elaso ua vendor CEM 2016 |||  
 Product Catalogue 2016 [www.cem-instruments.in](http://www.cem-instruments.in) Best Quality Products For over 24  
 years, CEM, SHENZHEN EVERBEST MACHINERY INDUSTRY CO. LTD. has been  
 a leading chinese manufacturer specialising in Infrared Thermometers, Digital  
 Multimeters, Clamp-on Meters, Insulation Testers, Electrical Testers, Li...  
 lang:en **score:12** filesize: 9.84 M page\_count: 119 document date: 2016-01-07

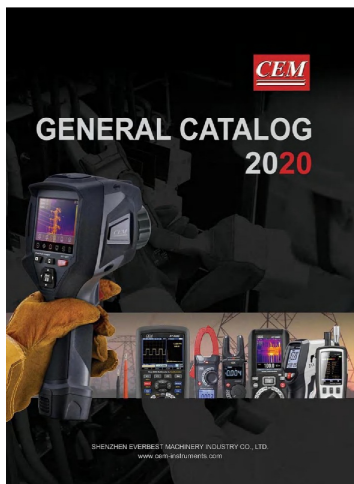

[\[pdf\]](#) Catalog

CEM Catalogue 2020 version Ampe Kim đo Công Suất AC DT 3348 240kW DC 1000A 600V True RMS  
 IMALL imall vn 2021 03 |||  
 ROBUST DURABLE STRONG OVER ANY REQUIREMENTS For over 29 years,  
 CEM, SHENZHEN EVERBEST MACHINERY INDUSTRY CO.,LTD has been a  
 leading Chinese manufacturer specialized in Thermal imager, Infrared Thermometer,  
 Digital Multimeter, Clamp-on Meter, Insulation Tester, Electrical Tester, Light Meter,  
 Soun...  
 lang:en **score:11** filesize: 25.4 M page\_count: 205 document date: 2019-10-08



[\[pdf\]](#) Troubleshooting Guide Guide

Professional Electrical Power Testers b2a879391f67ad79eaa3c3c68174d1c5cb5bc520 775993 emin vn d  
 cdn |||  
 CEM Professional Electrical Power Testers EMC LVD EN: 61326 EN: 61010-1 EN:  
 61010-02-032 EN: 61010-02-033 237 w w w . c e m - i n s t r u m e n t s . c o m E-  
 mail:cemyjmcem-instruments.com CEM Electrical Power Testers Selection Guide  
 Multifunction Installation Tester DT-6650 rugged Multifu...  
 lang:en **score:10** filesize: 21.39 M page\_count: 40 document date: 2021-01-13



[pdf]

содержание Aug 5 2021 · PQ3450 PQ3470 трехфазный анализатор мощности регистратор данных PQ3350 и гармоник 382096 3 х фазный анализатор Kontrolno Izmeritelnoe oborudovanie elec ru files 08 05 |||

4 - 29 44 56 61 65 , 82 RLC 91 98 11 ... ; - 2 3 ; - : 20 ; - ; - Max/min.

PROTEHNOLOGY.RU 170 CEM INSTRUMENTS / FLUKE **ILDM-150** iLDM-150 , . , .

- : 0,05...70 ; - : 1 ; - ; - ; - ...

lang:en **score:10** filesize: 15.78 M page\_count: 114 document date: 2015-08-20



[pdf] Datasheet

Multifunction Installation Tester 6650 6651 6652 rugged with 3 5 TFT color LCD display provides insulation resistance earth loop impedance 4153 1608606985 santatechnology products datasheet |||

CEM DT-6650/6651/6652 Multifunction Installation Tester Multifunction Installation Tester 6650/6651/6652 rugged Multifunction Installation Tester with 3.5 TFT color LCD display, provides insulation resistance, earth resistance, loop impedance, voltage, RCD, PFG and PSC testing. It is designed wit...

lang:en **score:9** filesize: 7.81 M page\_count: 26 document date: 2014-10-14